

<b>SHEET 1</b> <b>LTPP TRAFFIC DATA</b> <b>SUMMARY TRANSMITTAL FORM</b>	*STATE ASSIGNED ID [5101]
	*STATE CODE [40]
	*SHRP SECTION ID [1011]

GPS 1

STATE OR PROVINCE OK COUNTY Muskogee  
 HIGHWAY ROUTE NO. US 69 MILEPOST# 69-51-18 / 3.59  
 NEAREST CITY/TOWN Muskogee NEAREST INTERSECTION US 69 / SH 16  
 FUNCTIONAL CLASS 02 NO. LANES EACH DIRECTION 2 TOTAL NO. LANES 4  
 DIRECTION OF TRAVEL GPS LANE NB DATE OPENED TO TRAF. 10-01-81  
 FIPS COUNTY CODE \_\_\_\_\_ FHWA STATION IDENTIFICATION NO. \_\_\_\_\_  
 HPMS SAMPLE NO. \_\_\_\_\_ HPMS SUBDIVISION NO. \_\_\_\_\_  
 TYPE OF PAVEMENT: AC ☒ PCC \_\_\_\_\_ OTHER \_\_\_\_\_  
 CONTROL OF ACCESS: YES ☒ NO \_\_\_\_\_ MEDIAN: YES ☒ NO \_\_\_\_\_  
 CURRENT SURROUNDING DEVELOPMENT:  
 URBAN \_\_\_\_\_ SUBURBAN \_\_\_\_\_ RURAL ☒  
 HAS INTENSITY OF ROADSIDE DEVELOPMENT INCREASED OVER PAST 10 YEARS?  
 YES \_\_\_\_\_ NO \_\_\_\_\_  
 IF YES, DESCRIBE CHANGES \_\_\_\_\_  
 \_\_\_\_\_  
 \_\_\_\_\_

NOTE: ATTACH ALL RELATED FORMS AND COUNT DATA AND SUBMIT TO THE  
 SHRP REGIONAL OFFICE. ATTACH MAP INDICATING THE LOCATION OF  
 EACH TRAFFIC COUNT, VEHICLE CLASSIFICATION COUNT, OR WEIGHT  
 STATION RELATIVE TO THIS GPS TEST SECTION.

NAME OF PREPARER <u>(DJ) Kenneth Beard</u>	PHONE # <u>405 521-2575</u>
DATE PREPARED <u>Oct 1991</u>	

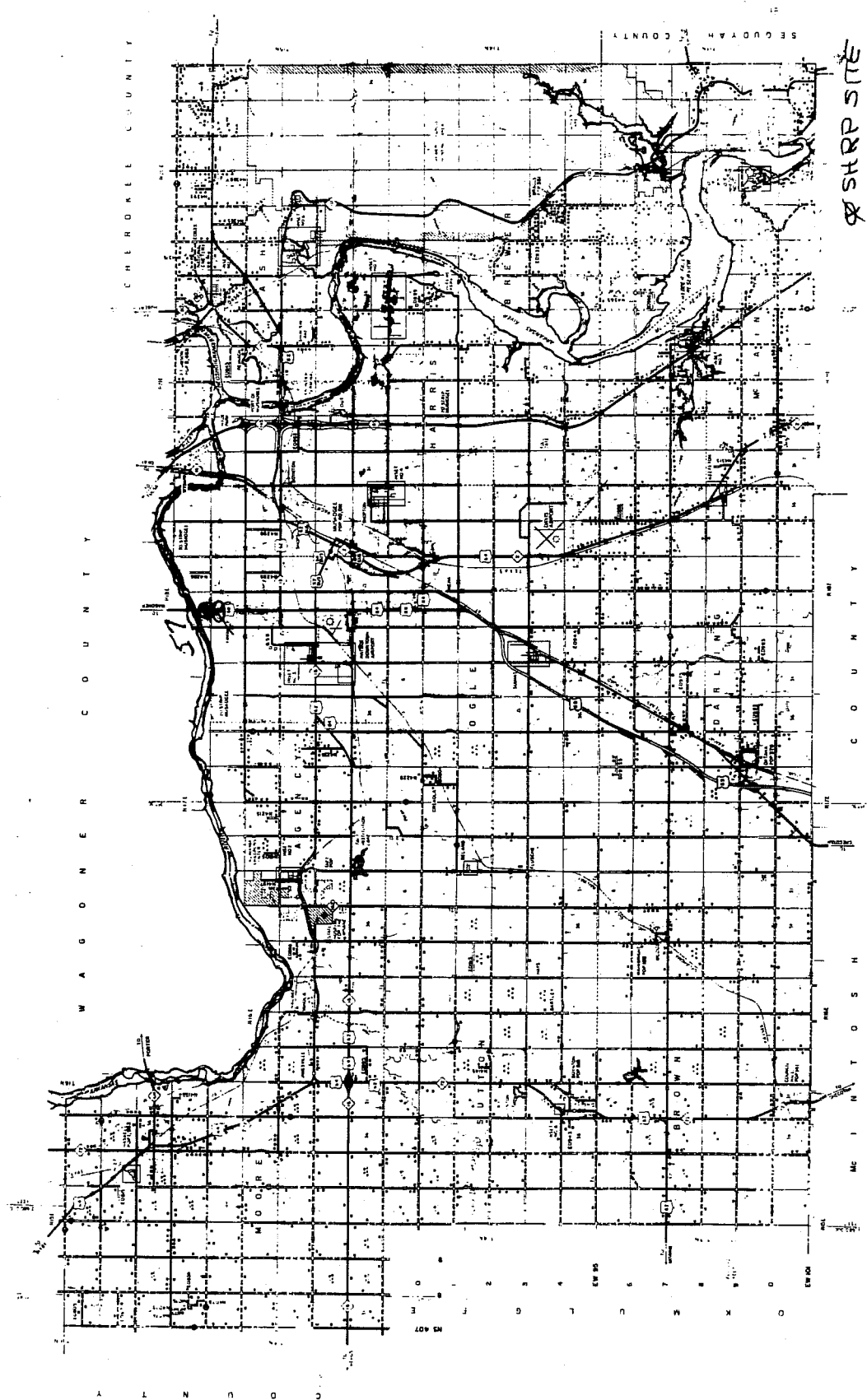

SRP SITE  
401017

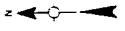

<b>SHEET 2</b>  <b>LTPP TRAFFIC DATA</b>  <b>TRAFFIC VOLUMES AND LOAD ESTIMATES</b>	*STATE ASSIGNED ID [2101]  *STATE CODE [40]  *SHRP SECTION ID [1017]
---	--

To determine Est for 2, 3, 4, 5 - I used '89 data to det. dist., then applied to AADT prev. yrs - MPG

YEAR	1. ESTIMATED TOTAL VEHICLES AADT (TWO-WAY)	2. ESTIMATED TOTAL TRUCK AADT (TWO-WAY)	3. ESTIMATED TOTAL VEHICLES AADT GPS LANE	4. ESTIMATED TOTAL TRUCKS AADT GPS LANE	5. ESTIMATED ESAL'S / YR GPS LANE (1000's)
1989	13500	19% 2565	34.07% 4600	20% 920	80% 736
*1988	13200	2508	4500	900	720
1987	13000	2470	4430	885	708
*1986	12500	2375	4260	852	681
1985	12000	2280	4090	818	654
*1984	11800	2240	4020	804	643
1983	11500	2185	3920	784	627
*1982	11200	2128	3815	763	611
1981	11000	2090	3750	750	600
*1980	11100	2109	3782	756	605
1979	11300	2150	3850	770	616
*1978	11000	2090	3750	750	600
1977	10900	2070	3715	743	594
1976	10000	1900	3407	681	545
1975	9500	1805	3240	647	518
1974	10100	1920	3440	688	551
1973	9400	1786	3200	640	512
1972	10500	1995	3580	716	572
1971	8800	1672	3000	600	480
1970					
1969					
1968					
1967					
1966					
1965					

NAME OF PREPARER _____	PHONE # _____
DATE PREPARED _____	

## SHEET 3

# LTPP TRAFFIC DATA PROCEDURES FOR ESTIMATING ANNUAL AVERAGE VOLUMES AND TOTAL ANNUAL ESALS

\*STATE ASSIGNED ID [ \_ \_ \_ \_ ]

\*STATE CODE [ \_ \_ ]

\*SHRP SECTION ID [ \_ \_ \_ \_ ]

1. Year Applicable 89

## 2. METHOD FOR ESTIMATING AADT

- ☐ Factored a single count taken this year at the GPS site.  
☒ Averaged multiple counts taken this year at the GPS site.  
☐ Averaged and factored multiple counts taken this year at the GPS site.  
☒ Growth factored last year's estimate.  
☒ Estimated based on volume counts at nearby locations.  
☐ Used flow maps.  
☐ Used computerized network analyses.  
☐ Other: \_\_\_\_\_

## 3. METHOD FOR ESTIMATING TRUCK VOLUMES OR PERCENTAGES

- ☒ Used a single count taken this year at the GPS site.  
☐ Factored a single count taken this year at the GPS site.  
☐ Averaged multiple counts taken this year at the GPS site.  
☐ Used system averages from counts taken this year.  
☐ Used count data from nearby sites.  
☐ Used count data taken in earlier years at the GPS site.  
☐ Used system averages taken in earlier years at the GPS site.  
☐ Used computerized network analyses.  
☐ Other: \_\_\_\_\_

## 4. METHOD FOR ESTIMATING AADT BY GPS LANE

- ☒ Based on actual lane count data.  
☐ System distribution factors.  
☐ Other: \_\_\_\_\_

## 5. METHOD FOR ESTIMATING TRUCK AADT IN GPS LANES

- ☒ Based on actual lane count data.  
☐ System distribution factors.  
☐ Other: \_\_\_\_\_

## 6. METHOD FOR ESTIMATING ESAL/VEHICLE

- ☐ ESAL/Truck.  
☒ ESAL/Vehicle class. (no. of classes) 6  
☐ Other: \_\_\_\_\_

3682  
170  
-52

## 7. ESAL ESTIMATES

## (A) Source of Data

- ☐ Weight data collected at GPS site this year.  
☐ Weight data collected at GPS site prior years.  
☐ Weight data from system averages this year.  
☐ Weight data from system averages prior years.  
☐ Weight data from historic W-4 Tables used.  
☐ Other: \_\_\_\_\_

## (B) Weight Scale Type

- ☐ WIM scale.  
☐ Static scale used for enforcement.  
☐ Static scale not used for enforcement.  
☐ Other: \_\_\_\_\_

NAME OF PREPARER \_\_\_\_\_ PHONE # \_\_\_\_\_  
DATE PREPARED \_\_\_\_\_

# LTPP TRAFFIC DATA PROCEDURES FOR ESTIMATING ANNUAL AVERAGE VOLUMES AND TOTAL ANNUAL ESALS

\*STATE ASSIGNED ID [ \_ \_ \_ \_ ]

\*STATE CODE [ 40 ]

\*SHRP SECTION ID [ 1017 ]

1. Year (s) Applicable '71-'88

## 2. METHOD FOR ESTIMATING AADT

- ☐ Factored a single count taken this year at the GPS site.  
☐ Averaged multiple counts taken this year at the GPS site.  
☐ Averaged and factored multiple counts taken this year at the GPS site.  
☐ Growth factored last year's estimate.  
☐ Estimated based on volume counts at nearby locations.  
☐ Used flow maps.  
☐ Used computerized network analyses.  
☒ Other: Backcalc from '89 data

## 3. METHOD FOR ESTIMATING TRUCK VOLUMES OR PERCENTAGES

- ☐ Used a single count taken this year at the GPS site.  
☐ Factored a single count taken this year at the GPS site.  
☐ Averaged multiple counts taken this year at the GPS site.  
☐ Used system averages from counts taken this year.  
☐ Used count data from nearby sites.  
☐ Used count data taken in earlier years at the GPS site.  
☐ Used system averages taken in earlier years at the GPS site.  
☐ Used computerized network analyses.  
☒ Other: Backcalc from '89 data

## 4. METHOD FOR ESTIMATING AADT BY GPS LANE

- ☐ Based on actual lane count data.  
☐ System distribution factors.  
☒ Other: Backcalc from '89 data

## 5. METHOD FOR ESTIMATING TRUCK AADT IN GPS LANES

- ☐ Based on actual lane count data.  
☐ System distribution factors.  
☒ Other: Backcalc from '89 data

## 6. METHOD FOR ESTIMATING ESAL/VEHICLE

- ☐ ESAL/Truck.  
☐ ESAL/Vehicle class, (no. of classes) \_\_\_\_\_  
☒ Other: Backcalc from '89 data

## 7. ESAL ESTIMATES

## (A) Source of Data

- ☐ Weight data collected at GPS site this year.  
☐ Weight data collected at GPS site prior years.  
☐ Weight data from system averages this year.  
☐ Weight data from system averages prior years.  
☐ Weight data from historic W-4 Tables used.  
☒ Other: Backcalc from '89 data

## (B) Weight Scale Type

- ☐ WIM scale.  
☐ Static scale used for enforcement.  
☐ Static scale not used for enforcement.  
☒ Other: none

NAME OF PREPARER MTB

PHONE # \_\_\_\_\_

DATE PREPARED 4/9/92

<b>SHEET 5</b>  <b>LTPP TRAFFIC DATA</b>  <b>VEHICLE CLASSIFICATION DATA</b> <b>FHWA 13-CLASS SYSTEM</b>	*STATE ASSIGNED ID [ <u>5101</u> ] *STATE CODE [ <u>   </u> ] *SHRP SECTION ID [ <u>1017</u> ]
---	--

HIGHWAY RT. NO. (THIS COUNT) US 69 MILEPOST# (THIS COUNT) 3.59

LOCATION (THIS COUNT) GPS SITE FUNCTIONAL CLASS 02  
 BEGINNING DATE 12-3-90 2p-10p ENDING DATE 12-10-90 6a-2p  
 BEGINNING TIME 6 AM ENDING TIME 10 PM DURATION (HRS) 16

TYPE OF COUNT: MANUAL ☒ AUTOMATED ☐ NO. OF LANES COUNTED 4

TYPE OF EQUIP.: AVC PERM. ☐ AVC PORT. ☐ WIM PERM. ☐ WIM PORT. ☐

EQUIPMENT NAME / MODEL # VISUAL

TOTAL NO. OF VEHICLES CLASSIFIED 11475 # TRUCKS 2080 % TRUCKS 18.1 %  
35.38

NO. OF TRUCKS IN GPS LANE 736 % OF TRUCKS IN GPS LANE 19.2 %  
35.38

VEHICLE CLASSIFICATION METHOD: FHWA ☐ OTHER ☐ # BINS    

NOTE: IF THIS COUNT DOES NOT USE THE FHWA 13-BIN CLASSIFICATION SYSTEM USE SHEET 6. PLEASE DESCRIBE ON AN ATTACHED PAGE THE VEHICLE CLASSIFICATION SYSTEM USED BY THE AGENCY AND COMPLETE SHEET 7 DESCRIBING HOW THE SHA WOULD EXPAND OR COLLAPSE THE USER CLASSIFICATION SYSTEM TO CORRESPOND WITH THE FHWA 13 CLASSES.

VEHICLE CLASSES	TOTAL NUMBER OF VEHICLES TWO-WAY	TOTAL NUMBER OF VEHICLES GPS DIRECTION	TOTAL NUMBER OF VEHICLES GPS LANE
1. FHWA CLASSES 1-3 (Cars, Motorcycles, Vans)	<u>9365</u>	<u>4620</u>	<u>3094</u>
2. FHWA CLASS 4 (Buses)	<u>33</u>	<u>18</u>	<u>14</u>
3. FHWA CLASS 5 (Two Axle, 6-Tire, SU Truck)	<u>322</u>	<u>151</u>	<u>116</u>
4. FHWA CLASS 6 (3 AXLE SU TRUCK)	<u>20</u>	<u>14</u>	<u>13</u>
5. FHWA CLASS 7 (4 or more Axle SU Truck)	<u>0</u>	<u>0</u>	<u>0</u>
6. FHWA CLASS 8 (4 or less axle 1-Trlr.Truck)	<u>32</u>	<u>17</u>	<u>17</u>
7. FHWA CLASS 9 (5 Axle, 1-Trlr.Truck)	<u>1704</u>	<u>880</u>	<u>581</u>
8. FHWA CLASS 10 (6 or more Axle, 1-Trlr.Truck)	<u>0</u>	<u>0</u>	<u>0</u>
9. FHWA CLASS 11 (5 or less Axle, Multi-Trlr.Truck)	<u>0</u>	<u>0</u>	<u>0</u>
10. FHWA CLASS 12 (6 Axle, Multi-Trlr.Truck)	<u>0</u>	<u>0</u>	<u>0</u>
11. FHWA CLASS 13 (7 or more Axle, Multi-Trlr.Truck)	<u>0</u>	<u>0</u>	<u>0</u>
12. OTHER VEHICLES	<u>0</u>	<u>0</u>	<u>0</u>
<b>GRAND TOTAL</b>	<u>11475</u>	<u>5686</u>	<u>3834</u>

NAME OF PREPARER <u>D)</u>	PHONE # <u>   </u>
DATE PREPARED <u>10-31-91</u>	