

Product Information



MT-D5S Door Station



SPECIFICATIONS

Power Supply	DC 24V
Power Consumption	Standby 1W, working status 8W
Wiring	2 wire (non-polarity)
Installation	Surface & Flush mounting optional
Unlock Power output	12V DC, 250 mA
Unlock timing	1 ~ 25s
Operating Temperature	-20℃ ~ + 55℃
Dimension	360(H)× 130(W)× 52(D)mm 14.2 (H)× 5.1 (W)× 2.0(D)in
Embedded Dimension	350(H)× 110(W)× 33(D)mm 13.7 (H)× 4.3 (W)× 1.3(D)in

PARTS AND FUNCTIONS

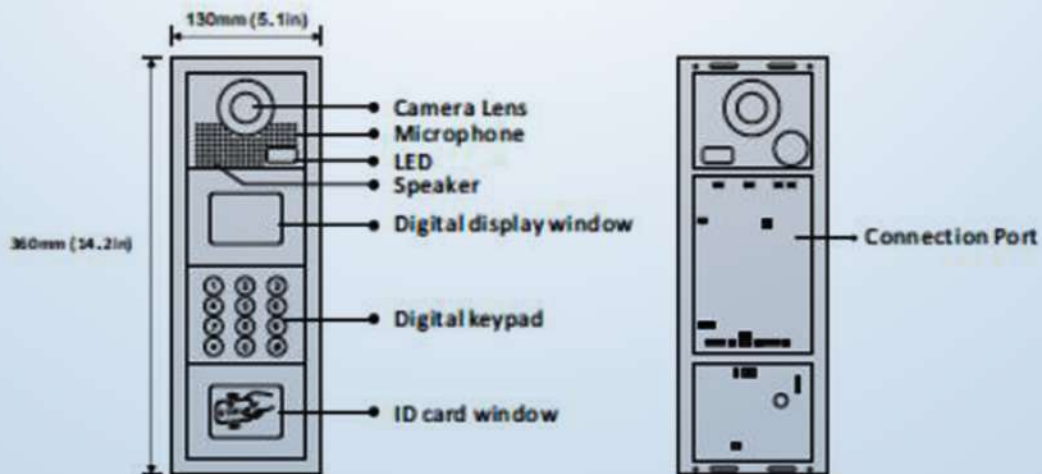

INSTALLATION

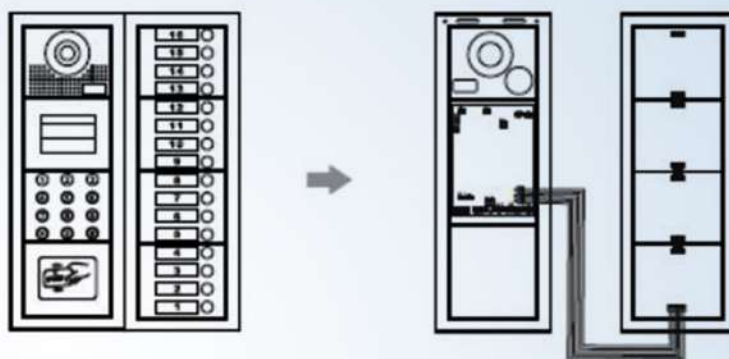
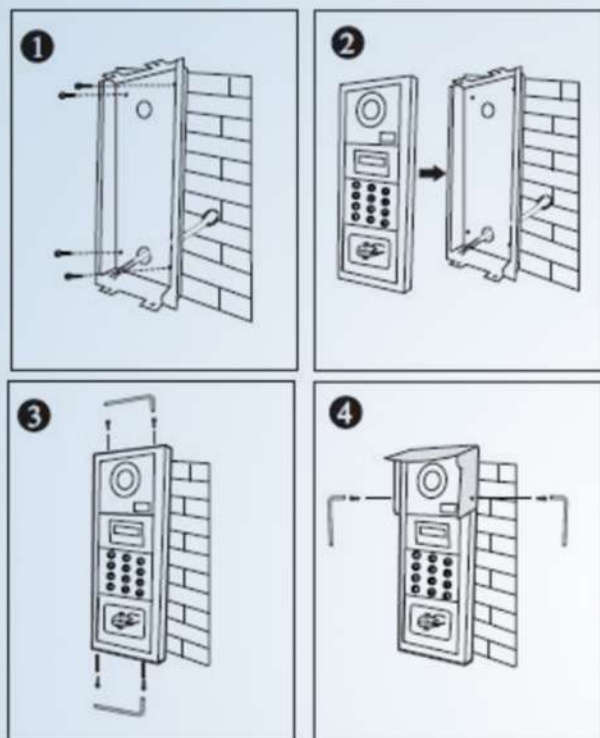

Installation with expanding panel

TERMINAL DESCRIPTION

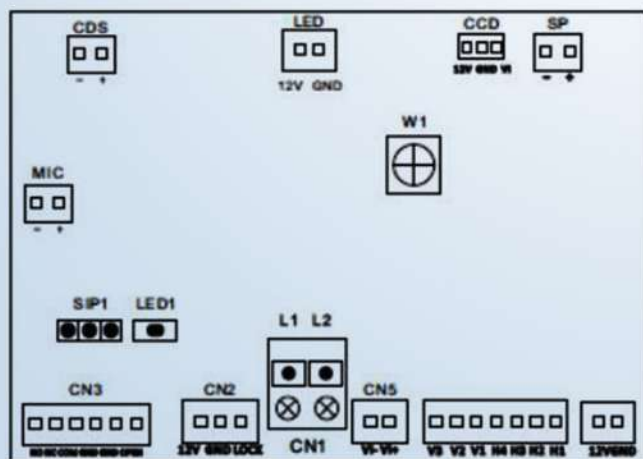

MIC: Microphone connection port
CN3: Unlock connection part
W1: Volume adjustor
LED: Night vision light connection port
CCD: Camera module connection port
SP: Speaker connection port
CN1: (L1, L2) non-polarity bus line
CN5: Extra camera connection port
CN2: Card reader module connection port

SYSTEM CONNECTION

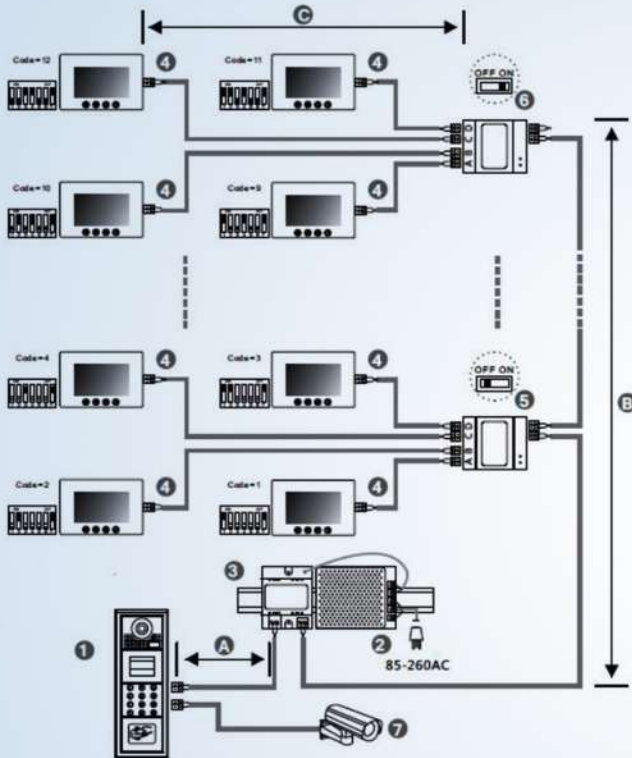

[1]: Door station.

[2]: Power supply, MUST be installed side by side with Power Separator.

[3]: Power Separator, MUST be installed side by side with Power supply.

[4]: Monitor, each one with an unique User Code, note that all the bit-6 is the line-terminal switch, set the last monitor to ON, otherwise set OFF.

[5]: Video distributor set switch to OFF unless at the end of the line.

[6]: Video distributor set switch to ON at the end of the line.

[7]: Extra camera.

When monitor quantity < 20

Cable usage	A	B	C
Parallel cable 2×0.75mm ²	60	60	30
Parallel cable 2×1mm ²	80	80	40

When monitor quantity > 20

Cable usage	A	B	C
Parallel cable 2×1mm ²	60	60	30
Parallel cable 2×1.5mm ²	80	80	40

DOOR STATION SETTING UP

The admin password is 1234, * means confirm, # means back or cancel, 00* means save and exit.

How to change admin password?

1* -> 1234 -> 04* -> 00* -> Input 4 digits new admin password -> * -> #00*

Public unlock password

[1].How to set public password?

1* -> 1234 -> 04* -> 33* -> Input 4 digits password -> * -> #00*

[2].How to turn on/off public password function?

1* -> 1234 -> 06* -> (Input 8 ON / Input 4 OFF) -> * -> 00*

[3].How to use the public password to open the door?

Private unlock password

[1].How to set private password?

1* -> 1234 -> 04* -> monitor ID -> * -> Input 4 digits password -> * -> #00*

[2].How to turn on/off the private unlock password?

1* -> 1234 -> 05* -> (Input 8 ON / Input 4 OFF) -> * -> #00*

[3].How to use the private unlock password?

8* -> monitor ID -> * -> 4 digits password

[4].How to change the private unlock password?

4* -> monitor ID -> * -> old password -> * -> new password -> * -> #

How to set the unlock time?

1* -> 1234 -> 02* -> Input 3 digits unlock number -> * -> 00*

Electrical lock input 001-003 , Other lock input 000-250

1 S = 10, for example, 5S = 050 , 10S = 100

How to set door station ID? (When there's multi door station in the system)

1* -> 1234 -> 10* -> Input Door Station ID 1~8 -> * -> 00*

How to restore factory setting? (It takes about 10 seconds to restore to factory setting)

1* -> 1234 -> 03* -> 1234 (Wait 10 seconds) -> 00*

How to turn on/off extra camera?

1* -> 1234 -> 11* -> (Input 8 ON / Input 4 OFF) -> * -> 00*

How to input the user's name?

1* -> 1234 -> 08* -> Input monitor ID

-> * -> Input name -> * -> #00*

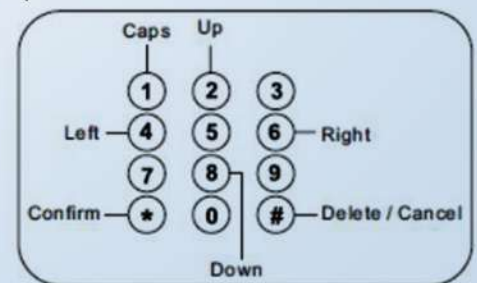

* Input user's name

DOOR LOCK CONNECTIONS

Internal power supply mode

1. The door lock power for a 12v DC strike (max current=250mA).
2. Set the jumper SIP1 to 1-2 for a normally closed lock (power OFF to open), or set SIP1 to 2-3 for a normally open lock(power ON to open).

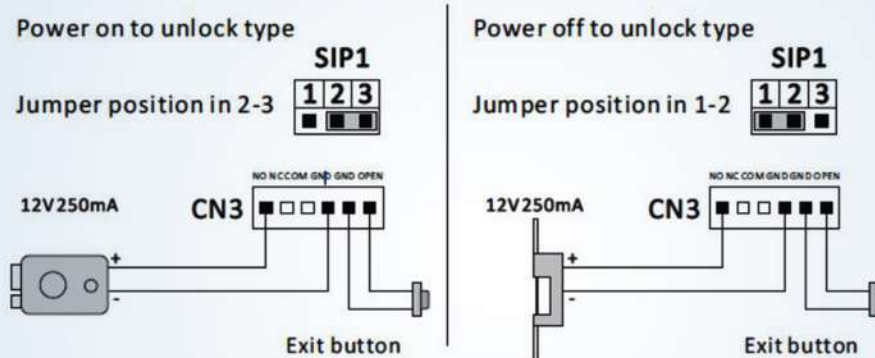

External power supply mode

When the electronic lock is over 12Vdc, additional power supply for the lock is needed. The jumper must be removed when using external power supply.

