

Product Information

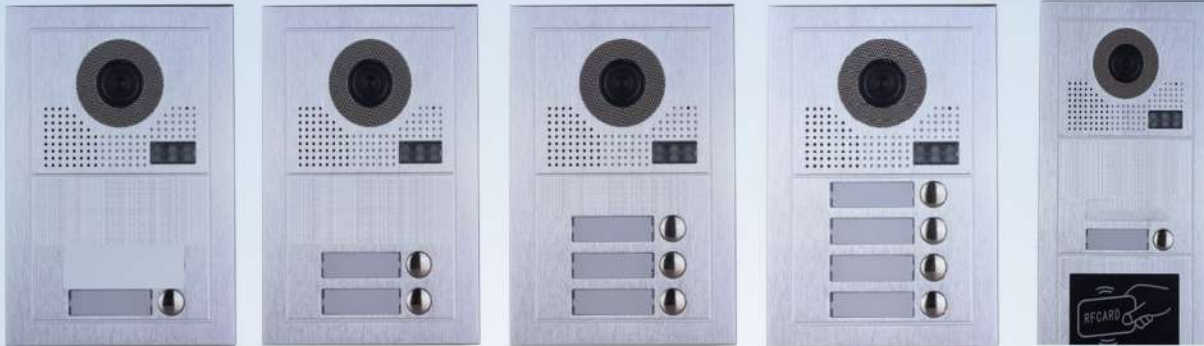

2-wire Apartment Door Station



MT-801

MT-802

MT-803

MT-804

MT-801R

Dimension: 7.7(H)×5.1(W) 2.0(D)in
Embedded Dimension: 7.3(H)×4.3(W)×1.3(D)in

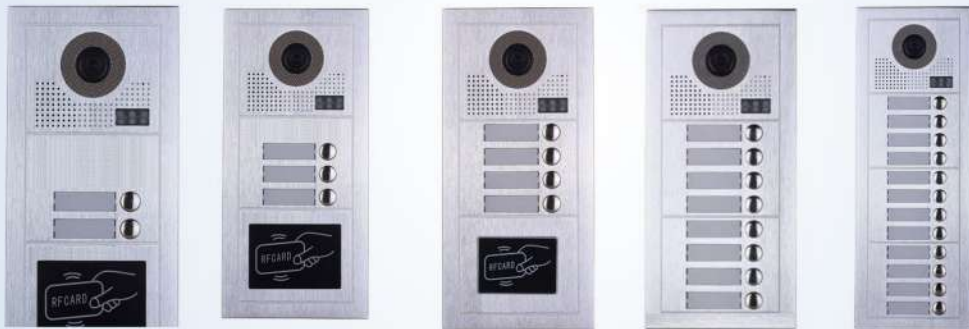

MT-802R

MT-803R

MT-804R

MT-808

MT-812

Dimension: 10.9(H)×5.1(W) 2.0(D)mm
Embedded Dimension: 10.6(H)×4.3(W)×1.3(D)mm



MT-808R

MT-812E

MT-816E

Dimension: 14.2(H)×5.1(W) 2.0(D)mm
Embedded Dimension:
13.8(H)×4.3(W)×1.3(D)mm



Toll-Free: 888.556.3998
Phone: 716.689.0871

Address: 5225 Sheridan Drive, Georgetown Square
Williamsville, New York 14221

E-mail: support@becsolutionsllc.com

PARTS AND FUNCTIONS

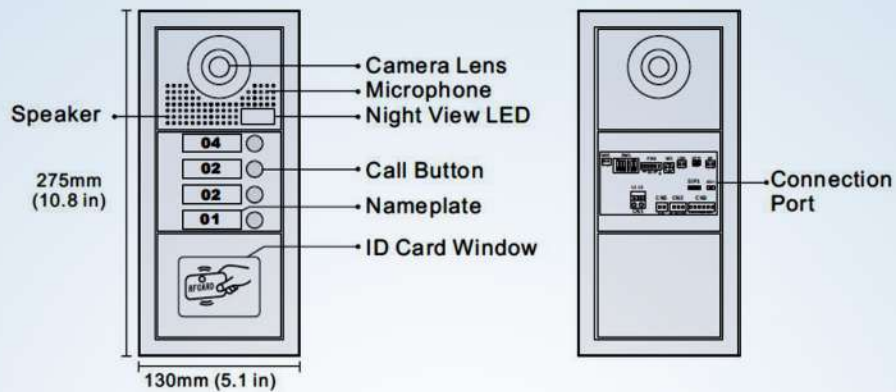

INSTALLATION

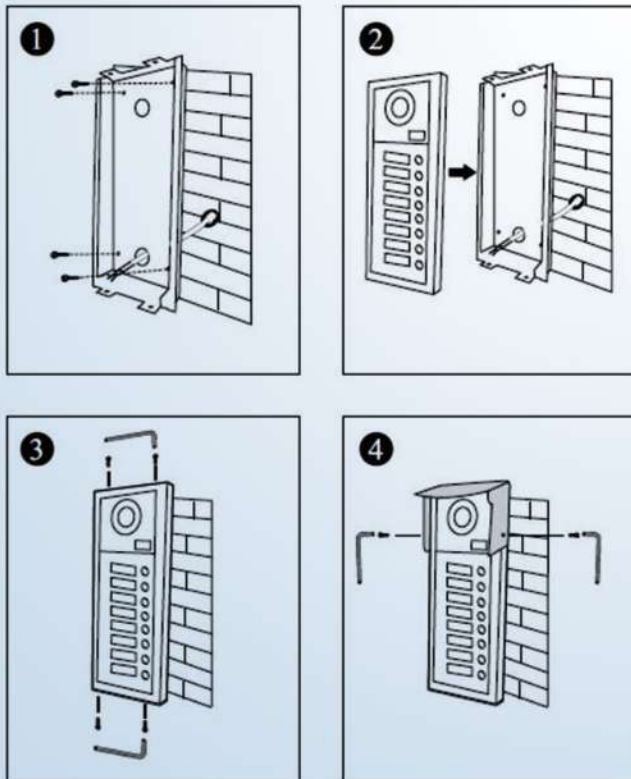

Installation with expanding panel

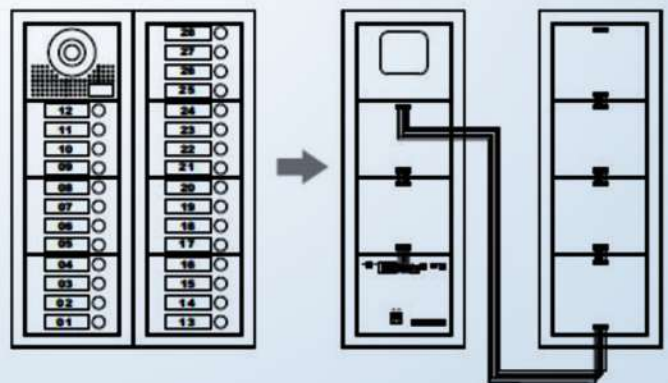

PLACE NAME LABEL

Press down and move left to open the transparent nameplate cover. Then insert the name paper and put the cover back.

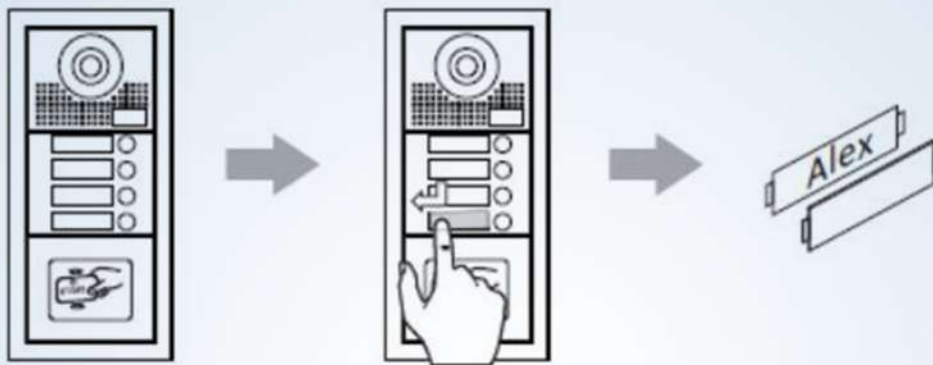

TERMINAL DESCRIPTION

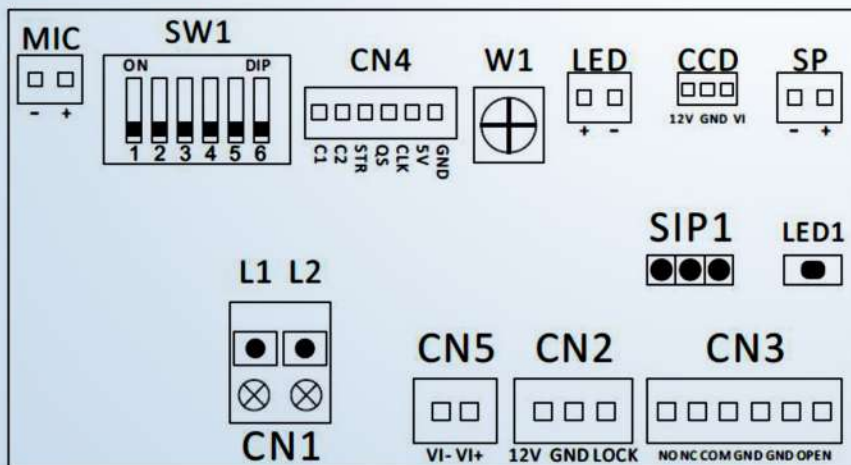

MIC: Microphone connection port

SWI: DIP switches for system configurations.

CN4: Call button module connection port

W1: Volume adjuster

LED: Night vision light connection port

CCD: Camera module connection port

SP: Speaker connection port

CN1: (L1, L2) non-polarity bus line

CN5: Extra camera connection port

Cn2: Card reader module connection port

SIP1: Door lock jumper

LED1: Unlock indicator light

CN3: Electronic lock connection port

WIRING

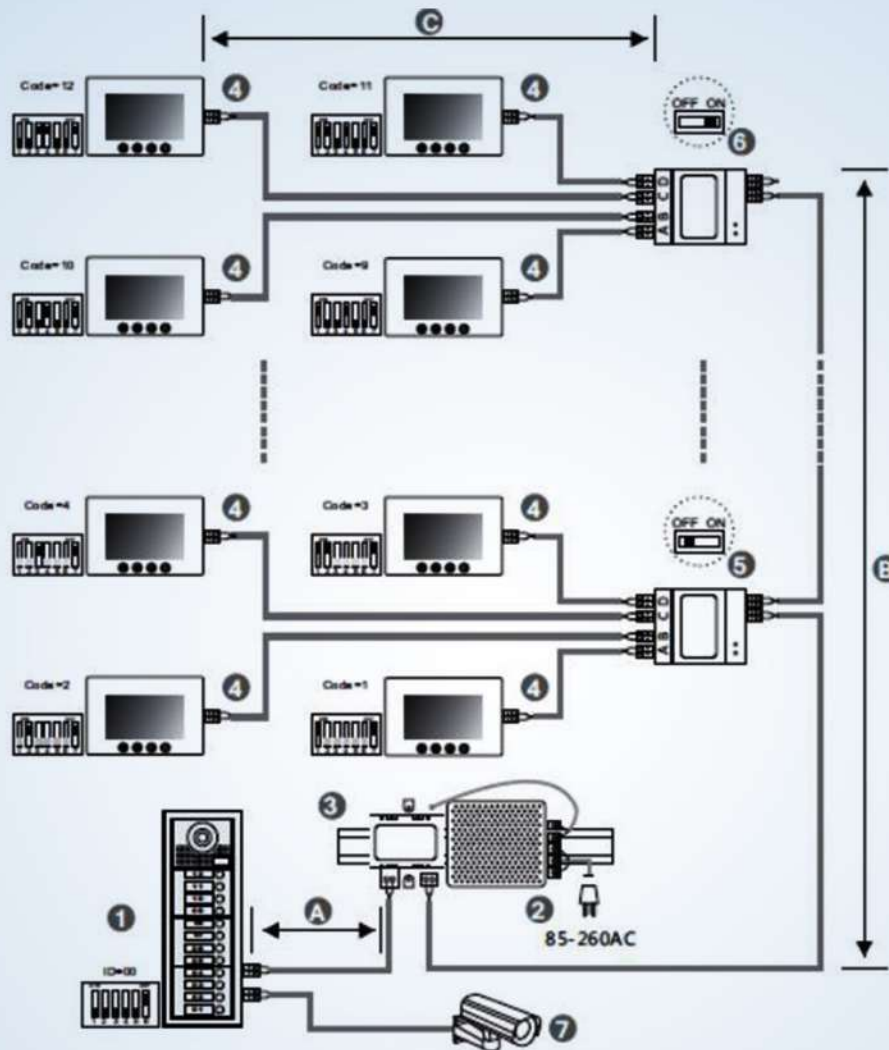

When monitor quantity < 20

Cable Usage	A	B	C
Parallel cable 2×0.75mm ²	60	60	30
Parallel cable 2×1mm ²	80	80	40

When monitor quantity > 20

Cable Usage	A	B	C
Parallel cable 2×1mm ²	60	60	30
Parallel cable 2×1.5mm ²	80	80	40

Product Information



2-wire Apartment Door Station

- [1]: DOOR STATION, WHEN THERE IS ONLY ONE DOOR STATION, THE DIP BIT-1 AND BIT-2 SHOULD BE SET TO 000.
- [2]: POWER SUPPLY, MUST BE INSTALLED SIDE BY SIDE WITH POWER SEPARATOR.
- [3]: POWER SEPARATOR, MUST BE INSTALLED SIDE BY SIDE WITH POWER SUPPLY.
- [4]: MONITOR, EACH ONE WITH AN UNIQUE USER CODE, NOTE THAT ALL THE BIT-6 OF THE DIP SHOULD BE SET TO 1(ON) IN THIS CASE.
- [5]: BRANCH CONTROLLER, THE SWITCH OF THE BRANCH CONTROLLER SHOULD BE SET TO OFF EXCEPT THE LAST ONE WHICH IS AT THE END OF THE BUS LINE.
- [6]: BRANCH CONTROLLER, THE SWITCH OF THE BRANCH CONTROLLER SHOULD BE SET TO ON AS IT IS AT THE END OF THE BUS LINE.
- [7]: EXTRA CAMERA

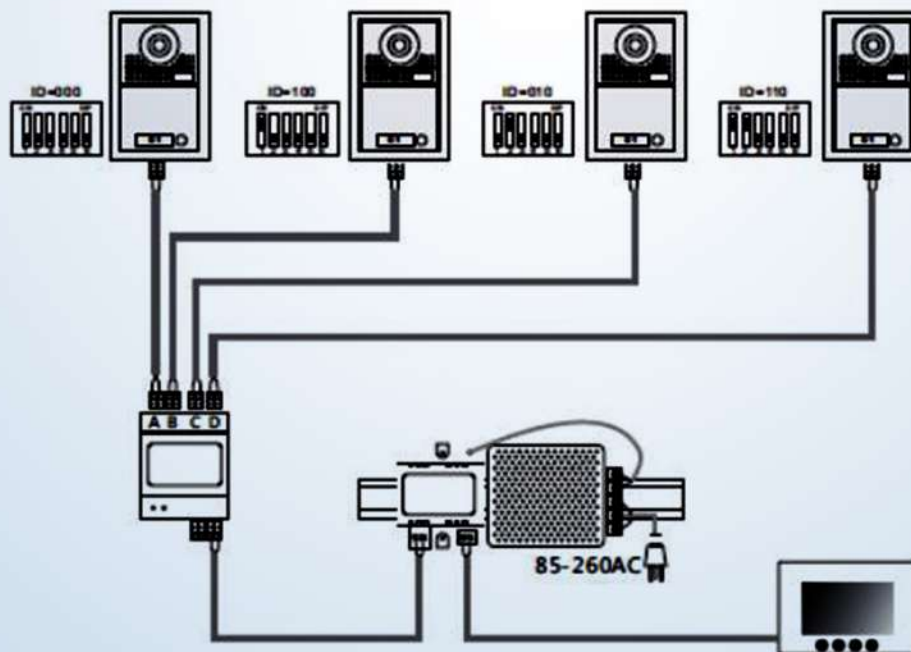

Multi Door Station Wiring

SPECIFICATION:

POWER SUPPLY:	DC 24V
POWER CONSUMPTION:	1W IN STANDBY, 5W IN WORKING
UNLOCK POWER OUTPUT:	12VDC, 250MA
UNLOCK TIMING:	1S, 5S, 10S, 15S
WORKING TEMPERATURE:	-20 ⁰ C~ +55 ⁰ C