

MODEL: 352020 - DOMELESS CORRIDOR CONTROLLER

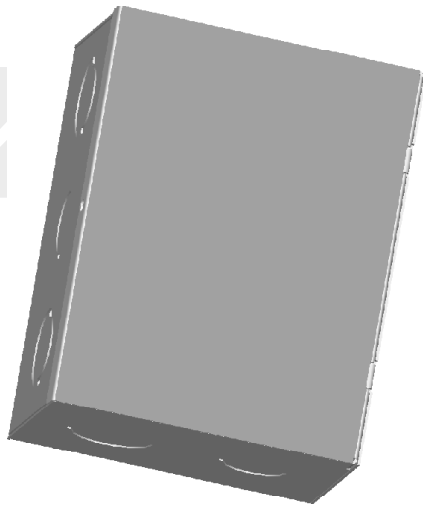

352020

FEATURES

- Located in areas where corridor light is not needed or desired
- Other corridor lights can be programmed to reflect calls placed on patient stations connected to a domeless room controller
- Supports up to sixteen (16) call-in stations, three (3) of which can have audio capability
- Serves as hub for all room wiring

SPECIFICATIONS

Power Required: 167mA at 36V

Weight: 1.3 lbs. (0.6 kg)

Size: **W:** 4.25" (10.8 cm)

H: 5.5" (14.0 cm)

D: 2.8" (7.1 cm)

Housing and Finish: 20 gauge steel, painted primer gray

Controls/Indicators: Module Status LED, Nurse call activity LED, Power Good LED

Terminations: Plug-on connectors

Backbox Options: 1 gang, (Non-gangable), 3 1/2" Deep. The metal housing also permits the unit to be located above ceiling tiles and attached directly to 1/2" and 3/4" conduit.

DESCRIPTION

The Domeless Controller is typically located where a corridor light display is not needed or desired. The controller provides annunciation at the associated console of calls originating from bedside, bath/emergency, and code stations as well as service requirements and staff registrations. The Domeless Controller can also be installed in areas where additional room stations are needed such as in a ward environment. Other corridor lights can be programmed to reflect calls placed on patient stations connected to a domeless room controller. The Domeless Controller supports up to sixteen (16) call-in stations; three (3) of which can have audio capability. The Domeless Controller mounts onto a variety of single and dual gang

back-boxes. The metal housing allows for the controller to sit above ceiling tiles and attached directly to 1/2" or 3/4" conduit. The Domeless Controller is continuously supervised for both power and data signal. Domeless Controllers may be hot-swapped on the room-to-room communication line without the loss of communications to other devices on the local network.

*Architect and Engineer (A&E) Specifications available online at: customerconnection.rauland.com
 Specifications subject to change without notice*

©Copyright 2008 Rauland-Borg Corporation Printed in USA Rev 08/2008