

 weightechUSA

WTX4

JUNCTION BOX

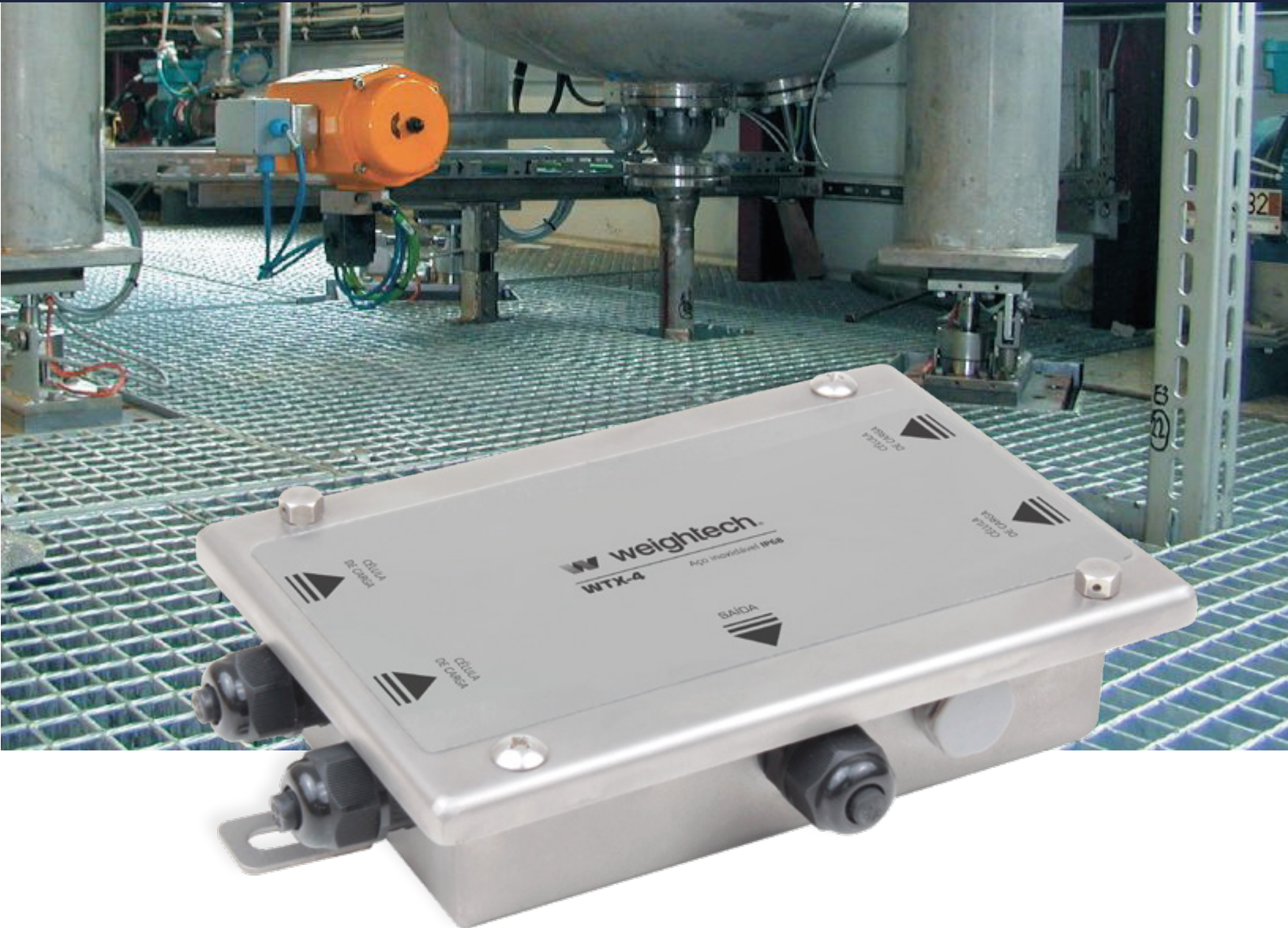

**Unrivalled robustness for connecting
the signal from up to 4 load cells**

wtx4_datasheet_v01 - 22/01/2025

Technical review: Loui Oriqui | Comercial review: Louir Oriqui

Edition: Stéphanie



WTX4

JUNCTION BOX

Equipment designed to deliver mechanical robustness, consistency and simplicity of installation. With its compact size and excellent thermal stability, the WTX4 is often used in automation systems, platform scales, silos or reactors in industrial yards.



**Connection of
2 to 4 load cells**



IP67

Encapsulated in stainless steel, perfectly sealed for outdoor use.

AMPLE PROTECTION

GORE valve, pressure equalizer, which allows additional protection against internal condensation.

OUTLINE DIMENSIONS (in millimeters)

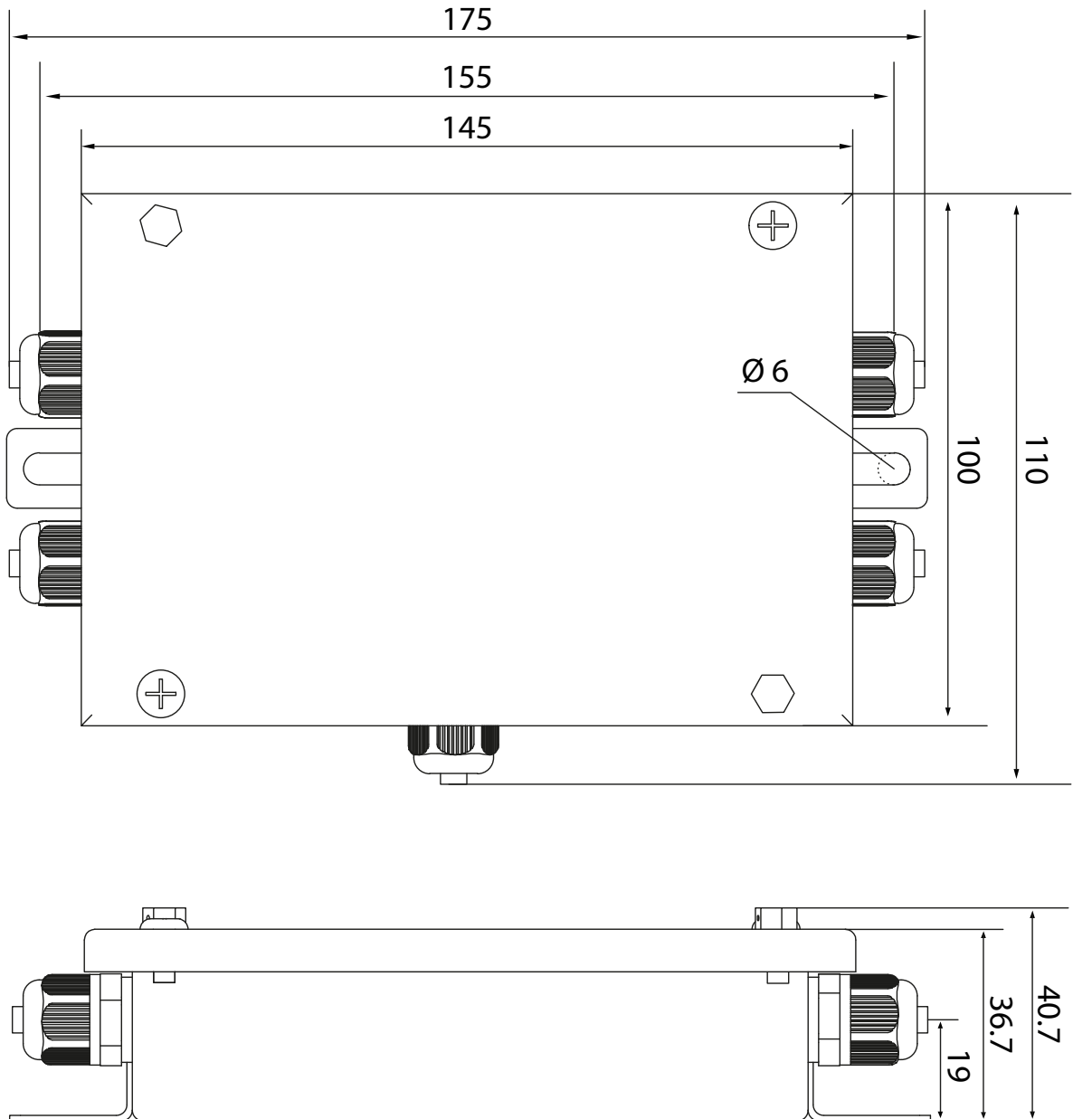

USING WTX4

The circuit board for adjusting the corner is housed inside the box, which is attached via the holes marked A in the photo. The load cells must be connected to the groups of 5 terminals distributed inside the box and each group of terminals is associated with one of the trimpots, where the adjustment is carried out.

Group of 5 cell terminals	Trimpot for adjustment
CN1	T1
CN2	T2
CN3	T3
CN4	T4

TRIMPOT ADJUSTMENT

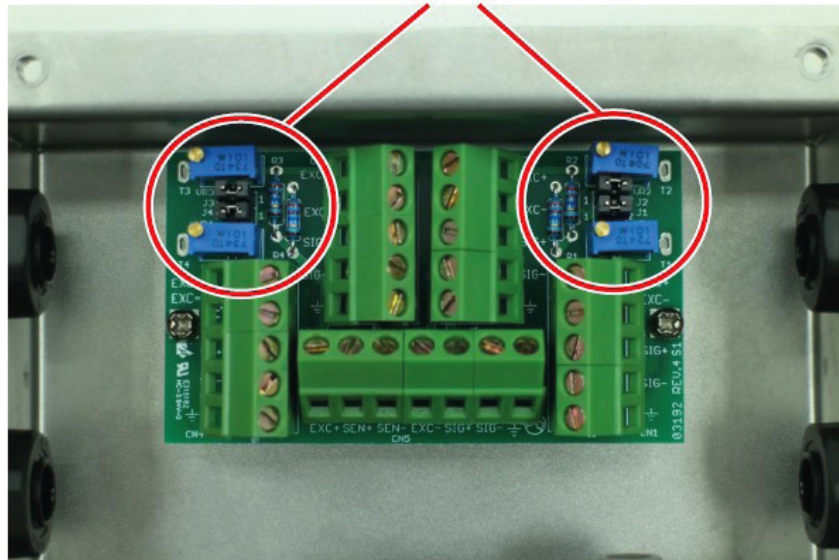

INSTRUCTIONS FOR ADJUSTMENTS

- ① Before starting the calibration, make sure that all four jumps have been opened
Remove J1, J2, J3 and J4, ALL TOGETHER ALWAYS.
- ② Set all the potentiometers to the middle of their range. If it is a new product, they will already be in this position, otherwise, turn it until you hear a sequential click (end of the range) and then count 10 turns to the opposite side, repeating this for all the potentiometers.

- ③ To lower the value read at the corners, potentiometers VR1 (T1) and VR2 (T2) are turned clockwise and potentiometers VR3 (T3) and VR4 (T4) are turned counterclockwise (refer to photo above).
- ④ Zero the indicator and place the weight in each corner, noting the results and comparing them in X (cell 1 with 3 and 2 with 4, as long as you have organized the distribution of the cells, following the same organization as the position of the potentiometers in the photo above).
- ⑤ If the values are equal, the adjustment is complete, otherwise, apply the weight to the corners with the highest value and turn the corresponding potentiometer until the reading is the same as the opposite corner (corner with the lowest value).
- ⑥ Repeat the procedure from step 4.

PART NUMBER

Products	Codes
Junction box	132200

FIND US

10384 W State road 84 #6 - Davie, FL 33324
sales@weightechusa.com
weightechusa.com

Technical Support: +1 (954) 666-0877x302

Sales: +1 (954) 666-0877x305

MORE INFO



[PRODUCT PAGE](#)



CABLE PRESS

They allow the connection of cables from 3.5 to 7mm in external diameter made of PA66 polyamide, with excellent sealing and high mechanical resistance.

CORNER ADJUSTMENT

Corner adjustment range of approximately 4.2% of output or 350 ohm cells.

CONNECTION

