

# The Type 565 Electrically Actuated Wafer Style Butterfly Valve

The Type 565 Butterfly Valve is designed as a tough, yet lightweight direct replacement for typical metal butterfly valves. It is rated at PN16 for sizes 2"-6", PN10 for sizes 8"-10", and PN6 for size 12".

## Part Numbers

### 100-230V

Size (Inch)	EPDM	FKM
2	199565300	199565320
2½	199565301	199565321
3	199565302	199565322
4	199565303	199565323
5	199565304	199565324
6	199565305	199565325
8	199565306	199565326
10	199565307	199565327
12	199565308	199565328

### 24V

Size (Inch)	EPDM	FKM
2	199565400	199565420
2½	199565401	199565421
3	199565402	199565422
4	199565403	199565423
5	199565404	199565424
6	199565405	199565425
8	199565406	199565426
10	199565407	199565427
12	199565408	199565428



# Valve Seals

## Reinforced Disc

The Type 565 Butterfly Valve is designed with a reinforced PVDF disc for improved strength. This rugged design is impact resistant, but does not compromise easy operation. The wetted PVDF disc material features superior surface finish and lubricity, while its Durethan® reinforcement provides lightweight toughness.



## Replacement Seat Liner

The seat liner of the Type 565 Butterfly Valve is removable. If desired, the seat liner can be replaced with either an EPDM or FKM variant.



Size (Inch)	EPDM	FKM
2	199565930	199565940
2½	199565931	199565941
3	199565932	199565942
4	199565933	199565943
5	199565934	199565944
6	199565935	199565945
8	199565936	199565946
10	199565937	199565947
12	199565938	199565948

## Double Redundant Seals

The Type 565 Butterfly Valve features a truly non-wetted shaft design. The shaft is isolated from the flow media by utilizing a disc-hub seal and double redundant o-rings. This industry tested design ensures a reliable seal for a variety of applications.



## Replacement O-Ring

The o-ring on the Type 565 Butterfly Valve can be replaced with either an EPDM or FKM variant.



Size (Inch)	EPDM	FKM
2-3	199565951	199565961
4-5	199565952	199565962
6-8	199565953	199565963
10-12	199565954	199565964

# Feedback

## Inductive Double Switches

The electrically actuated Type 565 Butterfly Valve is offered with inductive switches that signal the CLOSED or OPEN position of the valve via an electric signal to a controller supplied by the customer. This feedback system can be added with the valve in-line with out removing the operator.

## Switch Part Numbers

The switch for the Type 565 Butterfly Valve provides electrical feedback to signal the valve's position.



Open Signal Color	Closed Signal Color	Output Circuit	Part Number
LED red	LED green	PNP	198546001
LED green	LED red	PNP	198546002

# Electric Operators

## EA45 - 250 Electric Actuators

A stand-alone electric actuator is offered as a spare part to the Type 565 Butterfly Valve. Ranging in power and sizing, adapter kits are required if bought independent of a valve.

## dEA45 - 250 Smart Electric Actuators

The dEA Smart Electric Actuator is offered as an accessory to the Type 565 Butterfly Valve. This smart actuator can be operated using an app through WiFi and NFC. A 360° LED strip is displays the position of the valve and the status of the actuator.



	Size (inch)	Part Number	Type	Voltage	Max. Torque (Nm)	Mouting Pad
Standard Electric Operators	2	198153184	EA45	AC 100-230V	45	F05 (WS 11/14)
	2	198153185	EA45	AC/DC 24V	45	F05 (WS 11/14)
	2-5	198153186	EA120	AC 100-230V	120	F07 (WS17)
	2-5	198153187	EA120	AC/DC 24V	120	F07 (WS17)
	6-12	198153188	EA250	AC 100-230V	250	F07 (WS17)
	6-12	198153189	EA250	AC/DC 24V	250	F07 (WS17)
Smart Electric Operators	2	198153194	dEA45	AC 100-230V	45	F05 (WS 11/14)
	2	198153195	dEA45	AC/DC 24V	45	F05 (WS 11/14)
	2-5	198153196	dEA120	AC 100-230V	120	F07 (WS17)
	2-5	198153197	dEA120	AC/DC 24V	120	F07 (WS17)
	6-12	198153198	dEA250	AC 100-230V	250	F07 (WS17)
	6-12	198153199	dEA250	AC/DC 24V	250	F07 (WS17)

# Additional Operators

## Stem Extension

The Type 565 Butterfly Valve is offered with optional stem extensions that allows for manual valve operation far from the valve itself. Stem extensions are ordered by the foot.



Size (Inch)	SS 316/SS 316	PVC/SS 316
2-3	150567001	150567501
4-5	150567002	150567502
6	150567003	150567503
8	150567004	150567504
10-12	150567005	150567505

## Manual Override

A manual override is offered for the Electrically Actuated 565 Butterfly Valve as an optional accessory. The declutchable design allows manual override to operate the valve while the electric actuator is still attached.

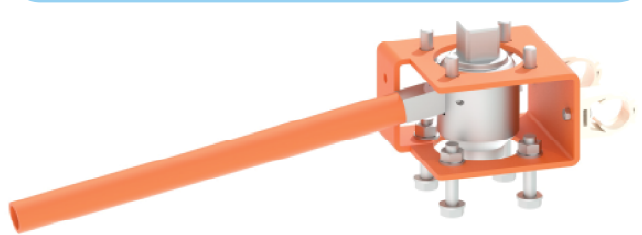

Size (inch)	Part Number
2-3	199565914
4-5	199565915
6-8	199565916

## Intermediate Element

An intermediate element is offered for the Electrically Actuated Type 565 Butterfly Valve. This product is used to mount an electric actuator to a valve that does not currently have an electric actuator. This kit is not needed when purchasing the fully assembled Electrically Actuated Type 565 Butterfly Valve.

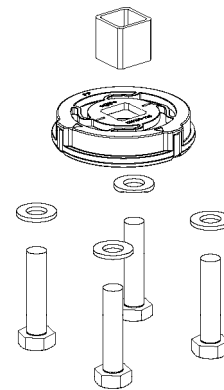

Size (inch)	Part Number	Type
2	199565909	EA45
2-3	199565910	EA120/dEA120
4-5	199565911	EA120/dEA120
6-8	199565912	EA250/dEA250
10-12	199565913	EA250/dEA250