

Sonic-Pro® T-Track Installation Guide - V-Mount method

1

Parts Locator

Locate the T-Track assembly package and your Transducer set. The package should contain the following items:

- 1) Retainer slide nut (2)
- 2) Positioning set screw (2)
- 3) Tensioning thumb screw (2)
- 4) T-Track cover
- 5) V-Block (2)
- 6) V-Block screws (8)
- 7) Pipe clamp (2)
- 8) Pipe clamp screws (2)
- 9) Pipe clamp wrench (1)
- 10) Installation Guide (1)

Note the serial number location on the transducer.

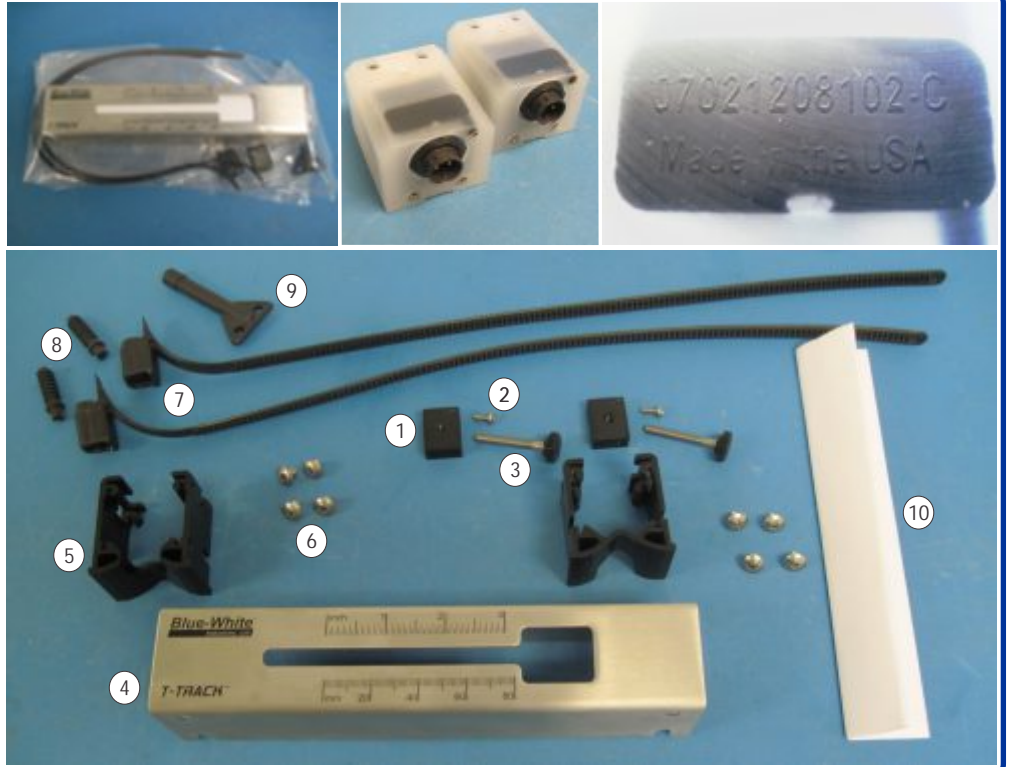

2

Determine Separation Distance

If not already done, configure the meter for the pipe application. The meter's display screen will display the transducer separation distance.

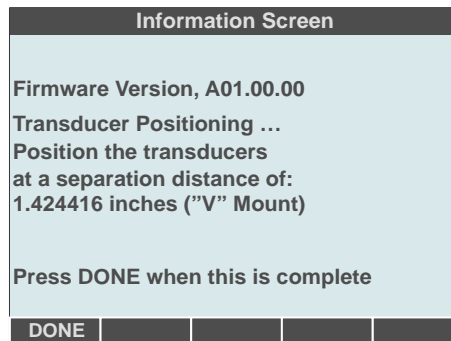

3

Install Retainer Slide Nut Assembly

Install the Positioning Set Screws (2) and the Tensioning Thumb Screws (3) into the Retainer Slide Nuts (1).

There is a captured nut located inside transducer housing. While holding the captured nut with a small screwdriver, thread the thumb screw into the captured nut. Do not over-tighten.

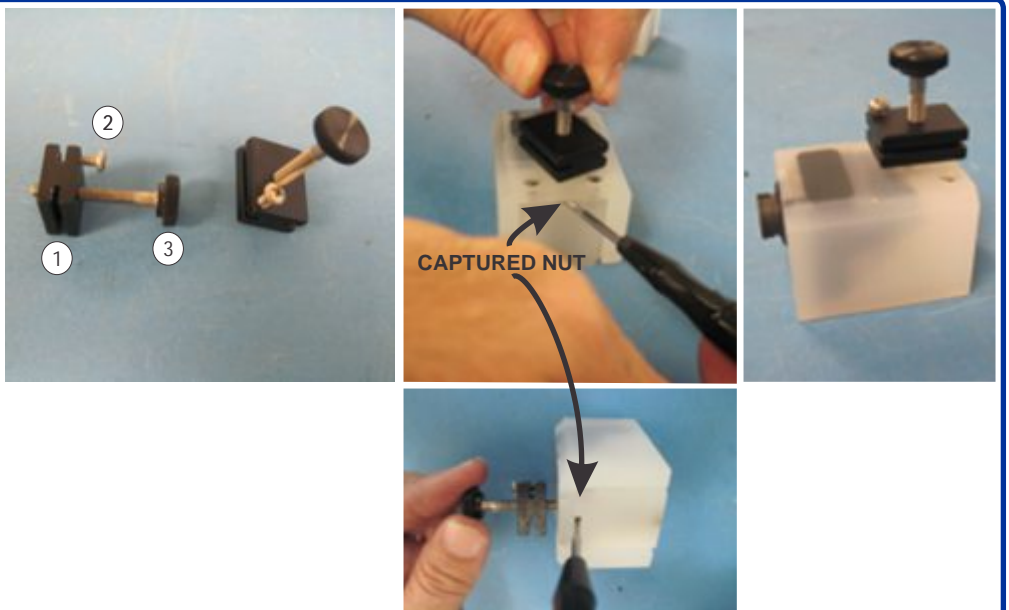

4

Install the V-Blocks

Position the transducer cable through the V-Block (5).

Install the V-Block into the T-Track Cover (4).

Install the 4 V-Block Screws (6).

Repeat this process for the second V-Block.

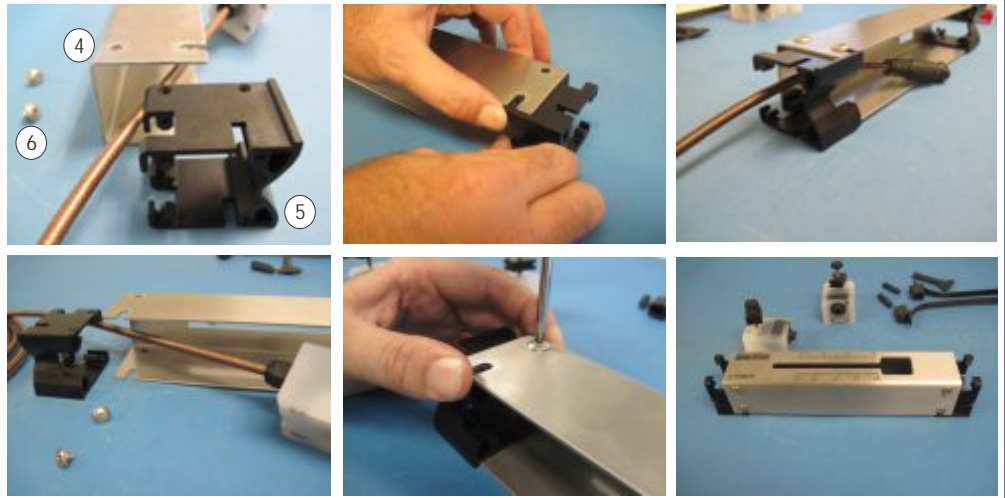

5

Install and Position the Transducers in the T-Track

Insert the first transducer's Retainer Slide Nut (1) through the square opening in the underside of the T-Track Cover (4). Align the grooves in the Slide Nut with the slot in the T-Track Cover. Slide the transducer assembly over to the zero position and lock in place with the Positioning Set Screw (2).

Insert the second transducer's Retainer Slide Nut (1) through the square opening in the underside of the T-Track Cover (4). Align the grooves in the Slide Nut with the slot in the T-Track Cover. Slide the transducer assembly over to the correct separation distance position (see step 2) and lock in place with the Positioning Set Screw (2).

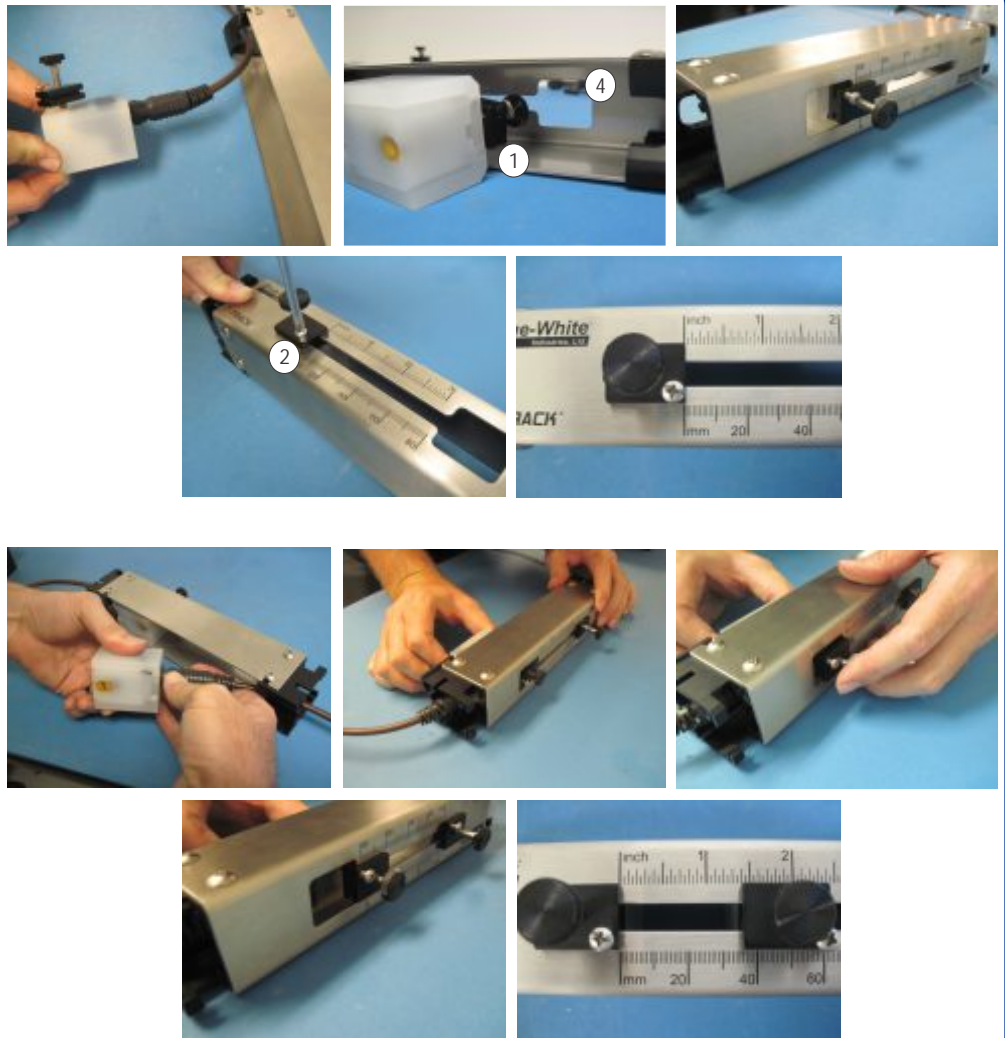

6

Adjust the Tensioning Thumb Screws

Adjust the Tensioning Thumb Screws (2) counter-clockwise so that the transducers are fully inside the T-Track Cover (4) as shown.

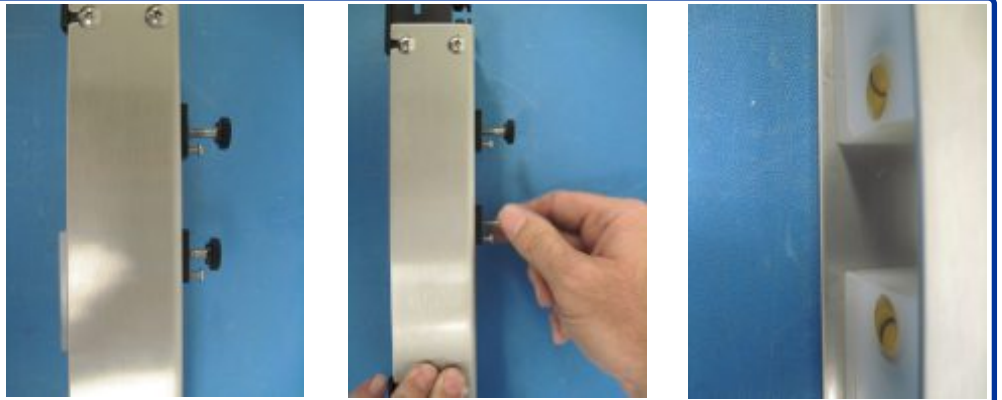

7

Apply Acoustic Coupling Material

An acoustic coupling material must be placed between the transducer and the pipe surface at the point where the sound waves enter the pipe. Place a drop of DOW 111 grease or the permanent Blue Gasket pad on the oval shape waveguide.



DOW 111 Silicone Grease
or
BLUE GASKET - Permanent installations. Recommended for metal pipes.



TRANSDUCER BOTTOM VIEW

8

Install the Pipe Clamps

Place the first Pipe Clamp (7) around the pipe being careful to position the screw where it will be easy to tighten. Insert the Clamp Screw (8) into the clamp. Use the Clamp Wrench (9) to tighten the clamp loosely onto the pipe.

Repeat for the second pipe clamp.

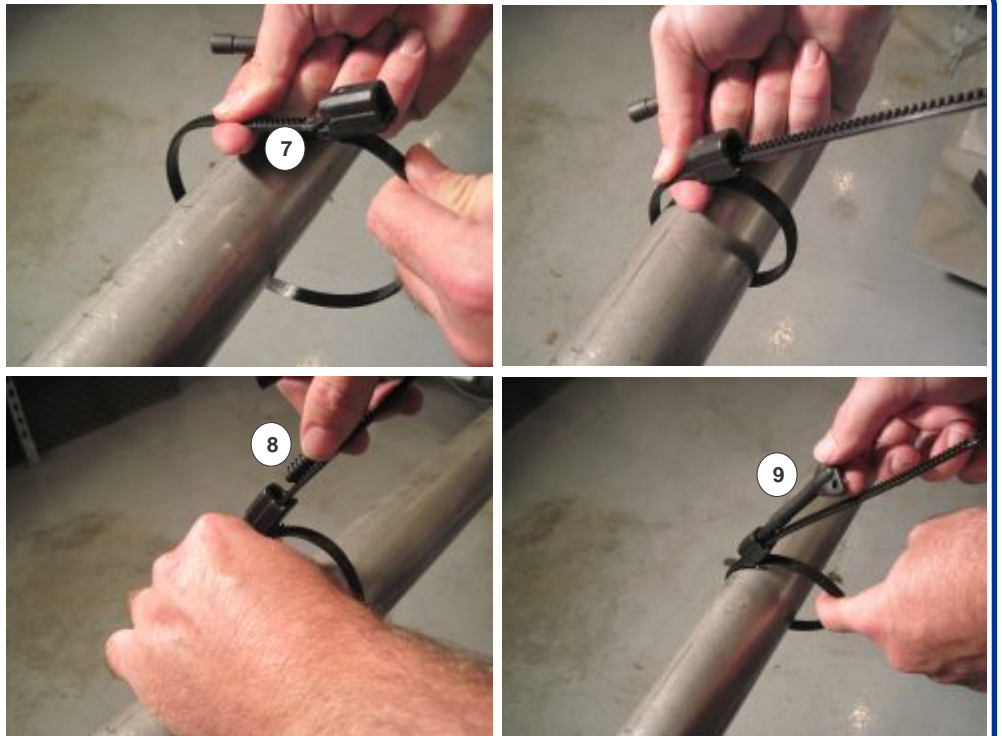

9

Install the T-Track on the Pipe

Position the T-Track on the side of the pipe - do not install on the top or bottom of the pipe.

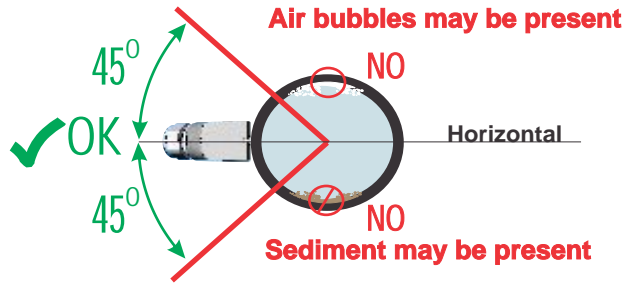

Insert the first Pipe Clamp (7) into the slot in the V-Block (5) and tighten. Ensure the transducers are fully adjusted up into the T-Track Cover (4).

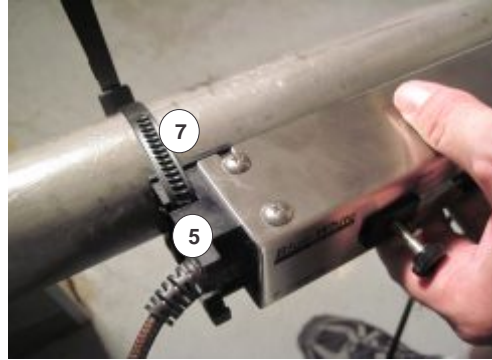

Insert the second Pipe Clamp (7) into the slot in the V-Block (5) on the other side of the T-Track and tighten.

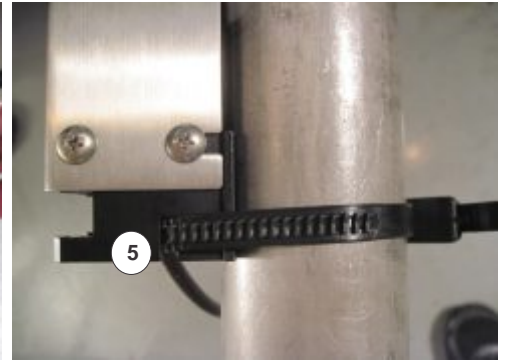

Tighten both clamps securely. Do not over-tighten.

10

Tension the Transducers against the Pipe Surface

Tighten the Tensioning Thumb Screws (3) by turning clockwise.

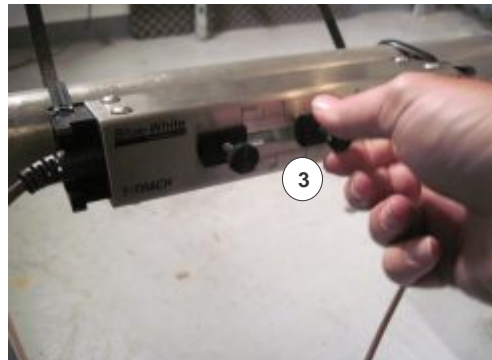

Confirm that the Retainer Slide Nuts (1) are positioned so that the distance between the slide nuts is equal to the correct separation distance per step 2.

