



HydroTap G5 UltraCare BCU40 UV Non-Carbon Filter Classic Accessible Tap Chrome

Boiling Chilled

 **Finish:** Chrome

Product code: H5D7U1Z00AUC

Capacity: Commercial

Zip HydroTap UltraCare Boiling, Chilled Filtered water tap features antimicrobial protection impregnated into key water paths for enhanced hygiene, LED UV-C disinfection, 0.2 micron carbon free internal filtration, Life cycle maintenance plan in a single under bench command centre including full colour interactive touch screen display with pin code protection and customisable settings including boiling water safety mode, 2 energy saving modes including ON/OFF timers and 2 hour sleep mode, 'Quiet' mode with automated intelligent fan speed adjustment, and 100% water efficient air cooled technology. Easy to install integrated ventilation tray included.

Specifications

Product name	HydroTap G5 UltraCare BCU40 UV Non-Carbon Filter Classic Accessible Tap Chrome
Product code	H5D7U1Z00AUC
Filtered water type	BC
Product approvals	WaterMark, RCM, ARC
Warranty	5 years (appliance warranty 36 months plus additional 24 months tank warranty)

Capacity, weight & dimensions

Number of people	21-40
Boiling cups per hour	160
Chilled cups per hour	125

Plumbing

Water supply requirements	Cold
Water connection	1/2" BSP (G1/2)
Water valves	Integrated 500kPa Pressure limiting valve and Dual Check Valve
Water pressure	Min 170kPa - Max 700kPa

Electrical

Power rating	1.97kW 220-240V 50Hz
Power supply	2 × 10 Amp socket outlet

Tap design

Tap	Zip HydroTap CLASSIC ACCESSIBLE Tap (Chrome)
HydroTap style	Classic Accessible,UltraCare
Finish	Chrome

Command centre

Dimensions

W280mm x D478mm x H333mm

Installation

Installation requirements

1. Installation and connection of your Zip HydroTap must be carried out by a qualified person, observing national and local regulations.
2. You will require suitable mains electrical and drinking water connections, plus waste water drainage all within 1.5 metres of the product.
3. **Discrete cabinetry cut outs are required for airflow. 40mm minimum clearance on cupboard base overhang required otherwise alternative installation options are available.**
4. Installation on most bench tops is straightforward however some stone bench tops may require a specialised cutting service.
5. If you live in a hard water area, we recommend installation of a Zip scale filtration kit.
6. Installation by Zip Professional Service can be arranged with a phone call or through www.zipwater.com/book-service-visit

Files

Installation Layout 3D (DWG)

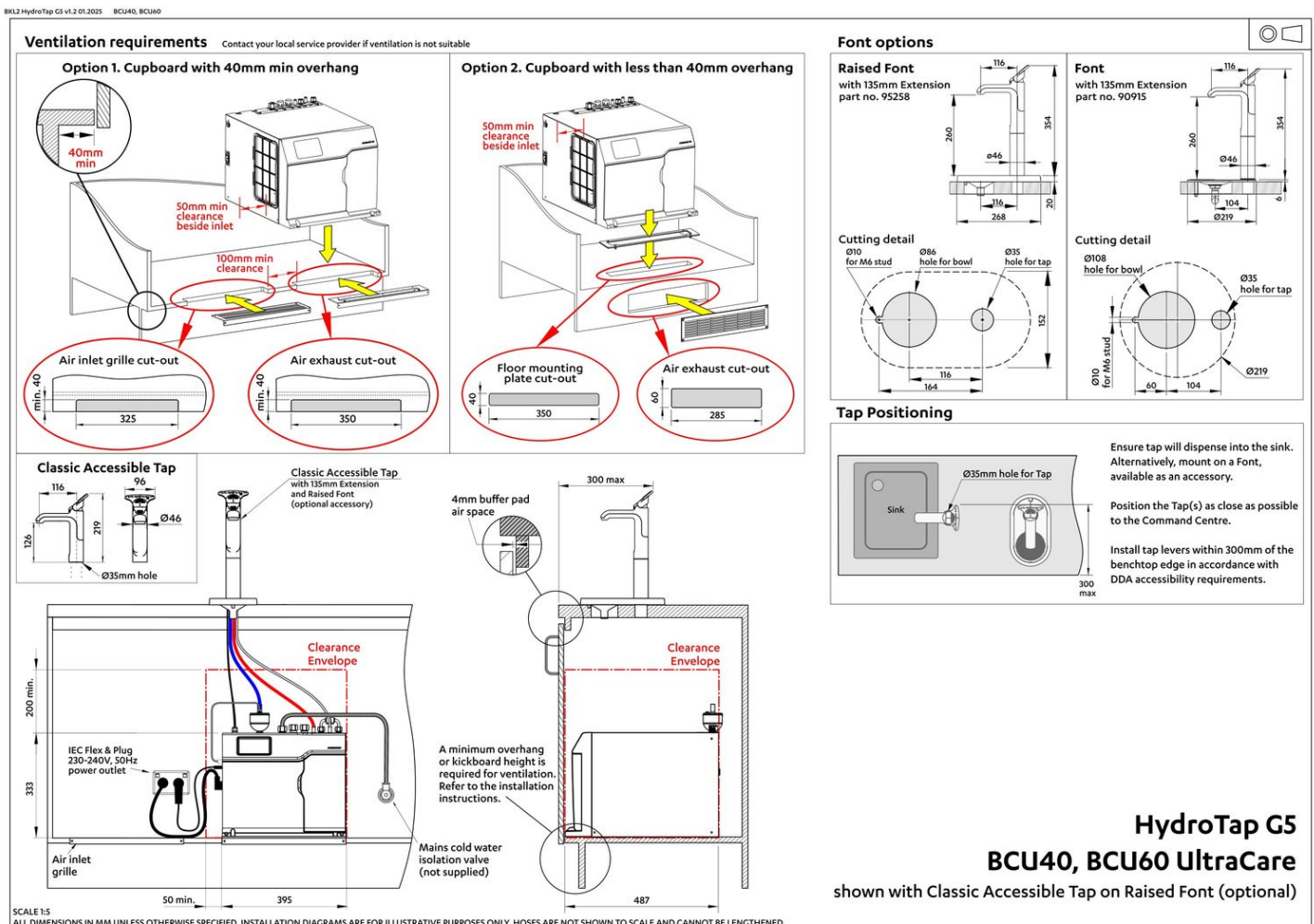

BIM files



↓ ArchiCAD Swift
Globals Library
(LCF)



↓ ArchiCAD Zip Water
Library (LCF)



↓ Revit Project File
(RFA)



↓ Revit Virtual
Showroom (RVT)

↓ Download all

Certifications



Environment
ISO 14001



Health & Safety
AS/NZS 4801



Quality
ISO 9001



↓ ARC (PDF)



↓ Environment ISO
(PDF)



↓ Environmental
Product Declaration
Brochure (PDF)



↓ Filter performance
(PDF)



↓ Health & Safety
(PDF)



↓ HydroTap Clean
SDS (PDF)



↓ Quality ISO (PDF)

Manuals & brochures



 Brochure (PDF)



 Instruction manual (PDF)



 Quick guide (PDF)



 Tap operation label (PDF)



 User manual (PDF)

 Download all