



## HydroTap G5 BCHA20 4-in-1 Classic Plus tap with Cube Mixer Chrome

Boiling Chilled



**Finish:** Chrome

**Product code:** H55921Z00AU

**Capacity:** Commercial

Zip HydroTap Classic Plus 4 in 1 Boiling, Chilled, Filtered water plus Hot and Cold washing up water from two separate taps. The system features a single under bench command centre including full colour interactive touch screen display with pin code protection and customisable settings including 2 boiling water safety modes, 3 energy saving modes including ON/OFF timers and sensor activated 'sleep when it's dark', 'Quiet' mode with automated intelligent fan speed adjustment, antimicrobial protection impregnated into key water paths for enhanced hygiene, 100% water efficient air cooled technology, and 0.2 micron water filtration.

# Specifications

|                     |  |
|---------------------|--|
| Product name        | HydroTap G5 BCHA20 4-in-1 Classic Plus tap with Cube Mixer Chrome              |
| Product code        | H55921Z00AU  |
| Filtered water type | BCHA   |
| Product approvals   | WaterMark, RCM, ARC  |
| WELS rating         | 5 Star, 6 litres   |
| Warranty            | 5 years (appliance warranty 36 months plus additional 24 months tank warranty) |

# Capacity, weight & dimensions

|                       |      |
|-----------------------|------|
| Number of people      | 1-20 |
| Boiling cups per hour | 100  |
| Chilled cups per hour | 75   |

# Plumbing

|                           |  |
|---------------------------|--|
| Water supply requirements | Cold   |
| Water connection          | 1/2" BSP (G1/2)  |
| Water valves              | Integrated 500kPa Pressure limiting valve and Dual Check Valve |
| Water pressure            | Min 300kPa - Max 700kPa  |

# Electrical

|              |                          |
|--------------|--------------------------|
| Power rating | 1.9kW 220-240V 50Hz      |
| Power supply | 1 × 10 Amp socket outlet |

# Tap design

|                 |  |
|-----------------|--|
| Tap             | Zip HydroTap CLASSIC PLUS Tap (Chrome) |
| HydroTap style  | Classic Plus                           |
| Mixer tap style | Cube                                   |
| Finish          | Chrome                                 |

# Command centre

Dimensions

W395mm x D487mm x H333mm

## Installation

### Installation requirements

1. Installation and connection of your Zip HydroTap must be carried out by a qualified person, observing national and local regulations.
2. You will require suitable mains electrical and drinking water connections, plus waste water drainage all within 1.5 metres of the product.
3. **Discrete cabinetry cut outs are required for airflow. 40mm minimum clearance on cupboard base overhang required otherwise alternative installation options are available.**
4. Installation on most bench tops is straightforward however some stone bench tops may require a specialised cutting service.
5. If you live in a hard water area, we recommend installation of a Zip scale filtration kit.
6. Installation by Zip Professional Service can be arranged with a phone call or through [www.zipwater.com/book-service-visit](http://www.zipwater.com/book-service-visit)

### Files

Installation Layout 3D (DWG)

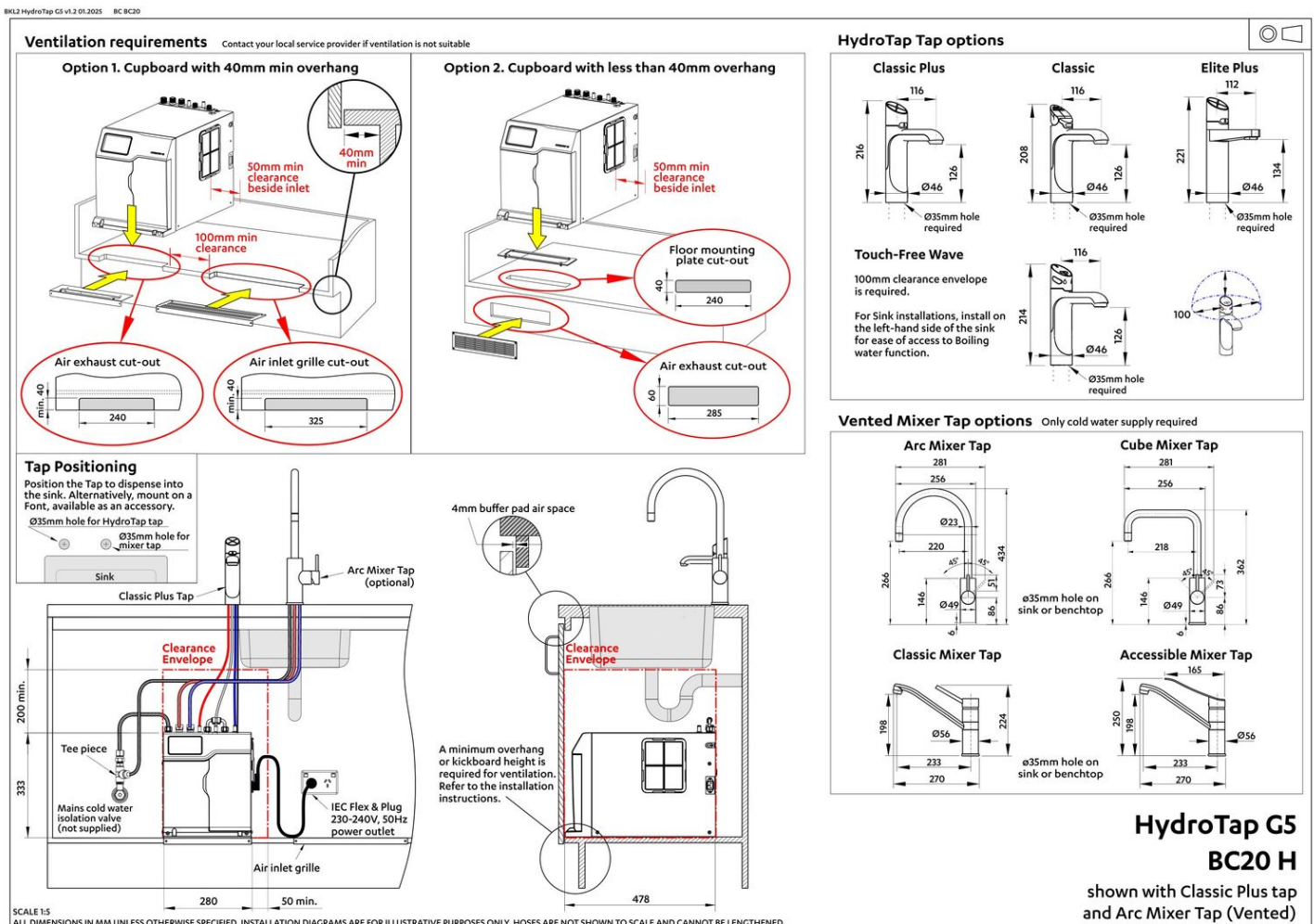

Installation Layout (PDF)

# BIM files



↓ ArchiCAD Swift  
Globals Library  
(LCF)



↓ ArchiCAD Zip Water  
Library (LCF)



↓ Revit Project File  
(RFA)



↓ Revit Virtual  
Showroom (RVT)

↓ Download all

# Certifications



Environment  
ISO 14001



Health & Safety  
AS/NZS 4801



Quality  
ISO 9001



↓ ARC (PDF)



↓ Environment ISO  
(PDF)



↓ Environmental  
Product Declaration  
Brochure (PDF)



↓ Filter performance  
(PDF)



↓ Health & Safety  
(PDF)



↓ HydroTap Clean  
SDS (PDF)



↓ Quality ISO (PDF)

# Manuals & brochures



 Brochure (PDF)



 Instruction manual (PDF)



 Quick guide (PDF)



 Tap operation label (PDF)



 User manual (PDF)

 Download all