

LTM1SSHC

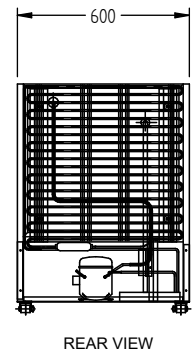

CATEGORY	TOPAZ RANGE
RANGE	Topaz Compact
UNIT	FREEZER
TYPE	SELF CONTAINED
DOOR	1

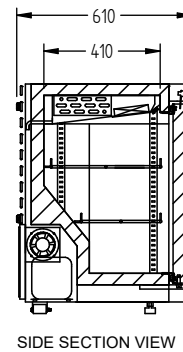
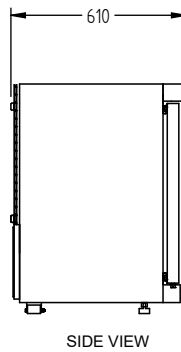
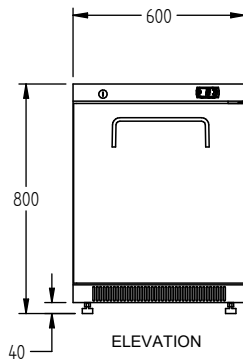
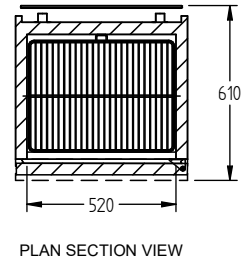
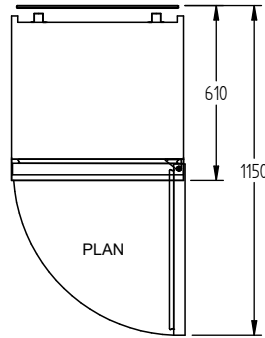

SPECIFICATIONS

CAPACITY LITRES	120
TEMPERATURE - 32°C AMBIENT ENVIRONMENT	-18°C / -22°C
DIMENSIONS - W X D X H MM	600 x 610 x 803
WEIGHT UNPACKED (KG)	60
DOOR TYPE	Standard: S (Solid Door)
FINISH (INTERIOR AND EXTERIOR EXCLUDING REAR AND UNDER)	S (Stainless Steel)
SHELVES	2

ELECTRICAL

POWER SUPPLY	10 amp
POWER CABLE LENGTH (METRES)	2
RUNNING AMPS	1.9

GAS TYPE

REFRIGERANT	R290
--------------------	------

PERFORMANCE

KWH/24HR READING	3.03
TEMPERATURE CLASS	4 M1
AMBIENT RATING	32°C

*** For **OPTIONS** refer to the current Williams Price Guide

1800 338 148
williams-refrigeration.com.au