

HSP18

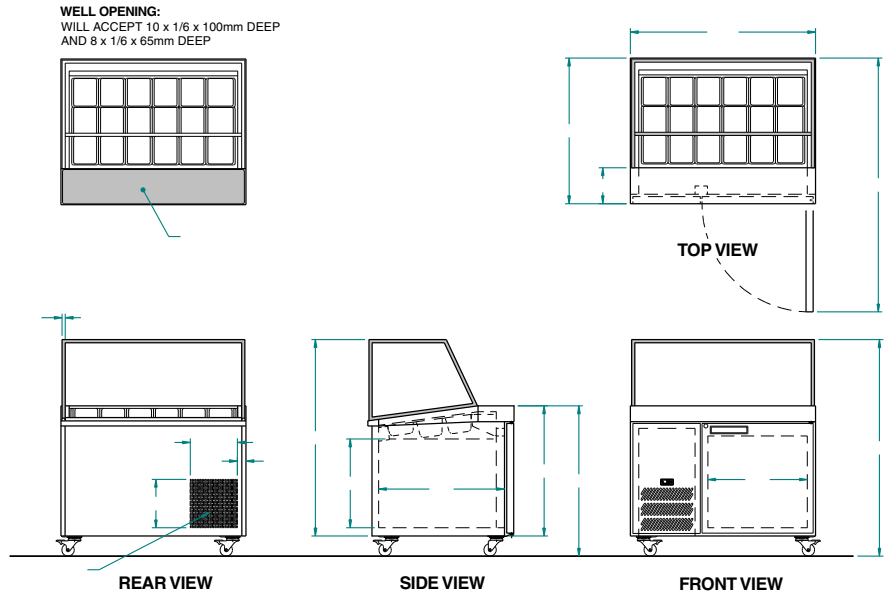

CATEGORY	PREPARATION COUNTERS
RANGE	Banksia
UNIT	REFRIGERATOR
TYPE	SELF CONTAINED
DOORS	1



SPECIFICATIONS

CAPACITY LITRES	250
TEMPERATURE	1°C / 4°C
GN PANS (INCLUDED)	18 X 1/6 (8 X 65 mm, 10 X 100 mm deep)
DIMENSIONS - W X D X H (ON CASTORS) MM	1117.5 W x 879 D x 907 H
WEIGHT UNPACKED (KG)	160

STANDARD INCLUSIONS ***

DOOR TYPE	Standard: SD (Solid Door)
FINISH (INTERIOR & EXTERIOR EXCLUDING UNDER. STAINLESS STEEL INTERNAL FLOOR & PREP AREA)	CB (White), CBB (Black), SS (Stainless Steel)
SHELVES/DOOR	1

ELECTRICAL

POWER SUPPLY	10 amp
POWER CABLE LENGTH (METRES)	2
RUNNING AMPS	4.2

GAS TYPE

REFRIGERANT	SELF CONTAINED	R134a
	REMOTE (OPTIONAL)	R448a

REFRIGERATION WATTAGES FOR OPTIONAL REMOTE UNITS

REMOTE WATTAGES	750 @ -10°C SST
-----------------	-----------------

*** For **OPTIONS** refer to the current Williams Price Guide