

HB4USBHC

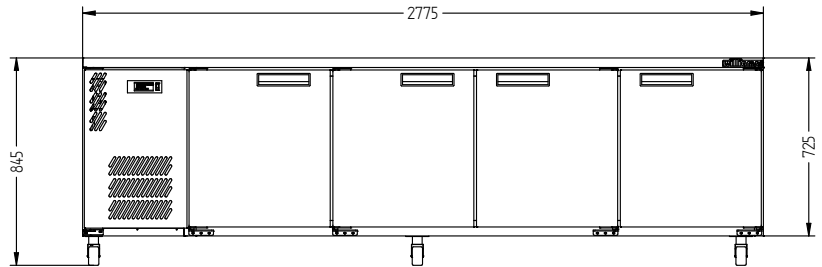

CATEGORY	GENERAL COUNTERS & BACK BARS
RANGE	Boronia
UNIT	REFRIGERATOR
TYPE	SELF CONTAINED
DOORS	4

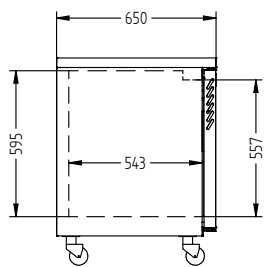
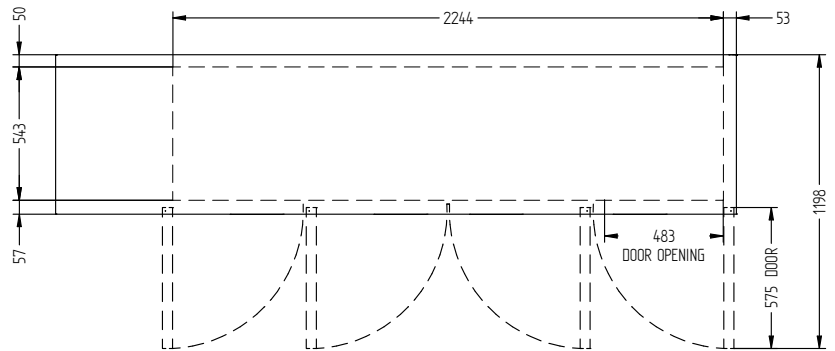

SPECIFICATIONS

CAPACITY LITRES	760
TEMPERATURE	1°C / 4°C
FRONT BREATHING	YES
DIMENSIONS - W X D X H (ON 120 MM H CASTORS) MM	2775 W x 650 D x 845 H
WEIGHT UNPACKED (KG)	180

STANDARD INCLUSIONS ***

DOOR TYPE	Standard: S (Solid Door)
FINISH (INTERIOR AND EXTERIOR EXCLUDING REAR AND UNDER)	B (Black with stainless steel countertop and internal floor)
SHELVES/DOOR (ADJUSTABLE STRIPS AND CLIPS)	2

GAS TYPE

REFRIGERANT	R290
-------------	------

ELECTRICAL

POWER SUPPLY	10 amp
POWER CABLE LENGTH (METRES)	2
RUNNING AMPS	2.6

PERFORMANCE

KWH/24H READING	6.6
TEST STANDARD	EN 16825 (Professional)
TEST CONDITIONS	4 M1
AMBIENT RATING	40°C

*** For **OPTIONS** refer to the current Williams Price Guide