

LDGE7R Commercial Dryer



10 KG TOUCH CONTROL GAS DRYER - REAR CONTROLS

Features and Benefits

- Energy saving 'Automatic Drying' function prevents over drying.
- Same 'Speed Queen' premium quality commercial components, fitted into a sleek stylish design actuated by the home style controls we are all familiar with.
- Rear controls matching the LWNE52 top load washer for perfect paring of both capacity and style.
- 21.09 Mj Natural Gas or LPG for fast, efficient drying.

SPECIFICATIONS

DIMENSIONS	
CAPACITY	10 kg
WIDTH	683 mm
DEPTH	711 mm
HEIGHT	1,092 mm
DRUM VOLUME	198 litres
NET WEIGHT	61 kg
OPERATION	
CYCLES	6 cycles, 3 fabric temperatures
CYCLE INDICATOR	Yes & Timer Display
CYCLE TIME	10 - 70 min or auto dry
CONTROLS	Electronic E-Mech
ACTIVATION	Push Button Controls
HEAT INPUT	21.09 Mj Natural Gas or LPG
MOTOR	1/3 hp, 0.25 kw
POWER SUPPLY	10 amp single phase
CONSTRUCTION	
DRUM	White enamel steel cylinder
OUTER CASING	Steel



LDGE7R Commercial Dryer



TECHNICAL SPECIFICATIONS

UTILITIES

10 AMP SINGLE PHASE 240 V 50 HZ

10 AMP BREAKER REQUIRED

1.8 M FLEX SUPPLIED FITTED

FLUE DIAMETER 102 MM (4 IN)

AIR FLOW 85 LITERS / SEC

21.09MJ GAS (NATURAL OR LPG)

OPTIONAL RIGHT VENTING

SHIPPING DIMENSIONS

WEIGHT	66 kg
HEIGHT	1,156 mm
WIDTH	737 mm
DEPTH	832mm
	0.71 m ³

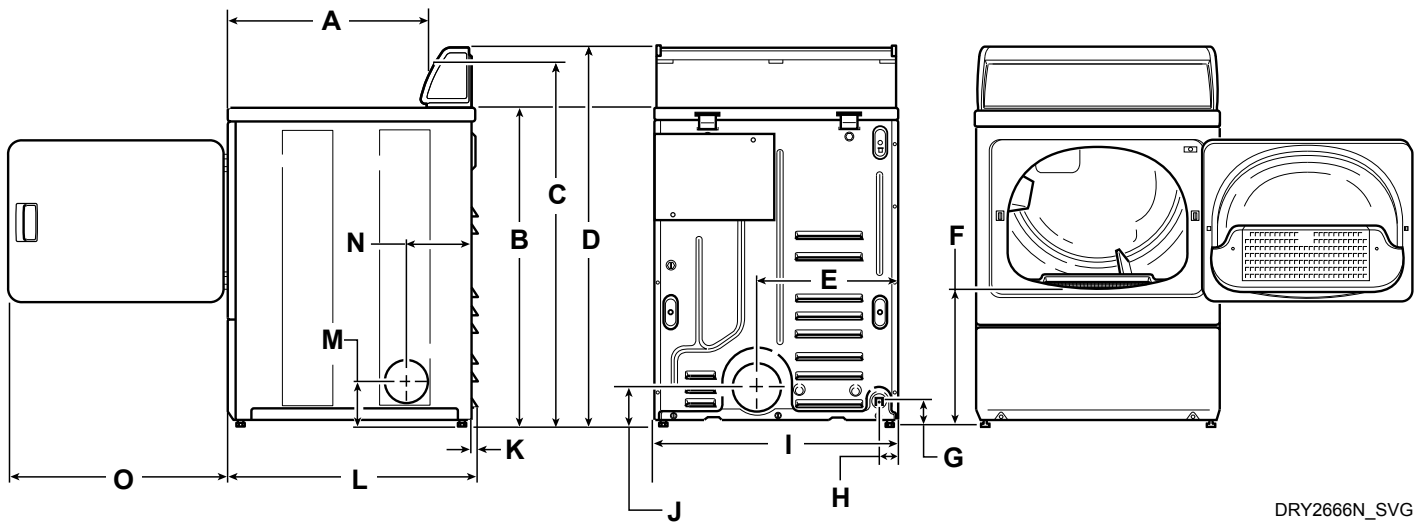

DRY2666N_SVG



Speed Queen Equipment Sales
26 Theobald Street, Thornbury, VIC 3071
Ph: (03) 9495 1300
Ph: 1300 945 414
W: www.speedqueensales.com.au
E: info@speedqueensales.com.au
Servicing Victoria & Tasmania.