

MXF Series Modular Flake Ice Machines – up to 187kg

MXF 427 AS OX Superflake ice



Superflake ice



Note: Ice production rate is measured with the water temperature at 10°C and an ambient temperature of 21°C.

- Up to 187kg daily production rate
- Head only ice maker: requires a separate storage bin to store the ice produced
- Very dry flake ice – 12% of water contents
- Hydrocarbon R290 refrigerant gas
- Air cooled version
- XSafe – Natural Sanitation System
- Core ice system – stable evaporator system (Axial load)
- Highly balanced augur double fly system core evaporator
- Improved evaporator stability and noise free
- High tech water sump with easy regulation system
- Ice level sensor for seamless operations
- Smart touch display
- Bluetooth and cloud connectivity

- XWave app with improved electronics and programming
- 304 stainless steel finish with removable air grid

Recommended Storage Bins

- NB 193 - 129kg storage capacity
- NB 393 with CBT 30 52 AMCD cover – 181kg storage capacity
- NB 530 with CBT 30 52 AMCD cover – 243kg storage capacity

MXF Series Modular Flake Ice Machines – up to 187kg

MXF 427 AS OX

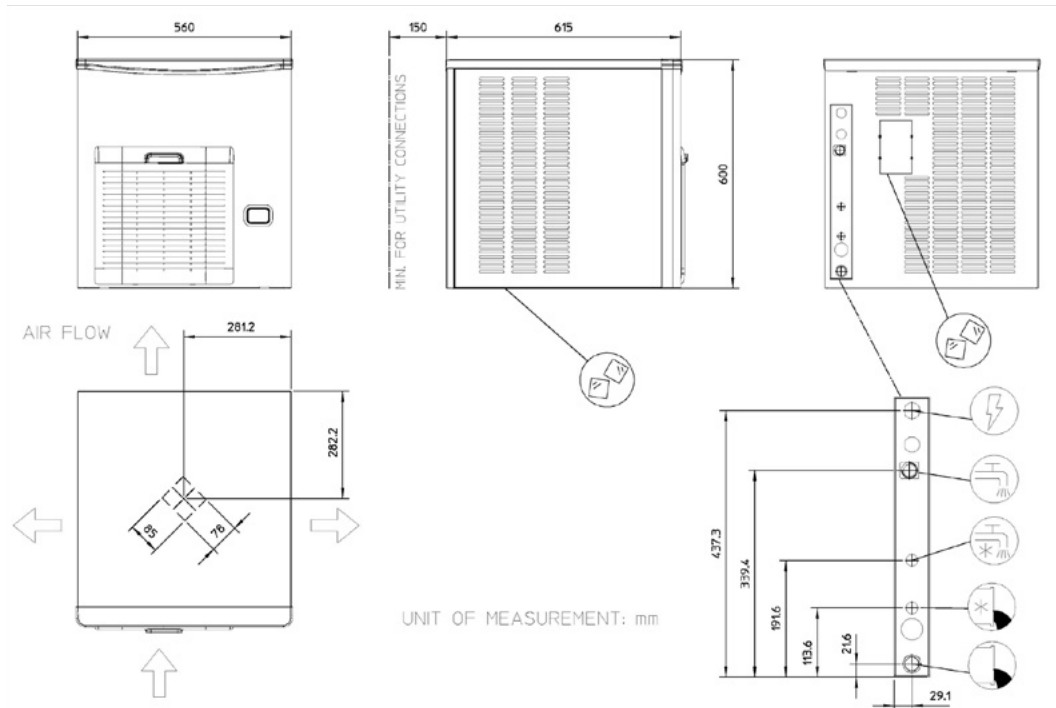

moffat.com.au

Australia
Moffat Pty Limited
Victoria/Tasmania
740 Springvale Road
Mulgrave, Victoria 3170
Telephone 03-9518 3888
Facsimile 03-9518 3833
vsales@moffat.com.au

New South Wales
Telephone 02-8833 4111
nswsales@moffat.com.au

South Australia
Telephone 03-9518 3888
vsales@moffat.com.au

Queensland
Telephone 07-3630 8600
qldsales@moffat.com.au

Western Australia
Telephone 08-9413 2400
wasales@moffat.com.au

Ice production kg per 24 hours

Ambient temperature / Water temperature

10°C / 10°C	21°C / 10°C	32°C / 21°C
215	187	170

Dimensions

Width: 560mm
Depth: 615mm
Height: 600mm
Nett weight: 57kg
Packed weight: 66kg

Water consumption

Air cooled version: 8 litres per hour

Electrical rating

Air cooled version: 230-240V, 1P+N+E, 50Hz, 750W,
10A cordset supplied
No. Circuit wire: 3
Compressor: 1400W
Energy consumption: 16kW/24hr

* Based on 32°C ambient / 21°C water temperature conditions

Refrigerant type

R290

Installation distance from wall

Rear 100mm
Side 150mm

Operating requirement air temperature 10-43°C

Water connection requirements

Inlet connection: R ¾"
Cold water: 5-38°C
Pressure: 100-500kPa
Water outlet connection: Ø ¾"

Operating requirements

	Minimum	Maximum
Air temperature	10	43
Water temperature	5	38
Water pressure	1 bar / 14psi / 100kPa	5 bar / 70psi / 500kPa

Important Notice:

Models and specifications are subject to change without notice. This spec sheet is meant for commercial purpose only. For technical documentation please refer to our service manuals.



© Copyright Moffat Ltd
AU.SM.2501