

DXN Series Cubelet Ice Maker and Water Dispenser – up to 125kg **DXN 187 AS** Cubelet ice – 1g W 16mm x D 15mm x H 7-8mm



Cubelet ice
1g – W 16mm x D 15mm x
H 7-8mm



Note: Ice production rate is measured with the water temperature at 10°C and an ambient temperature of 21°C.

- Up to 125kg daily production rate
- 7kg storage bin capacity
- Compact countertop ice and water dispenser (Cubelet ice)
- Hydrocarbons R290 refrigerant gas
- Easy to read touch screen with view of settings, errors and when reservoir is temporarily empty
- Programmable dosage, ice or water dispensing or both
- Ice evaporator with stainless steel auger
- Touch-free or button activated
- Fast friendly cleaning mode
- High grade stainless steel exterior
- Accessories - matching stainless steel cabinet stand

DXN Series Cubelet Ice Maker and Water Dispenser – up to 125kg

DXN 187 AS

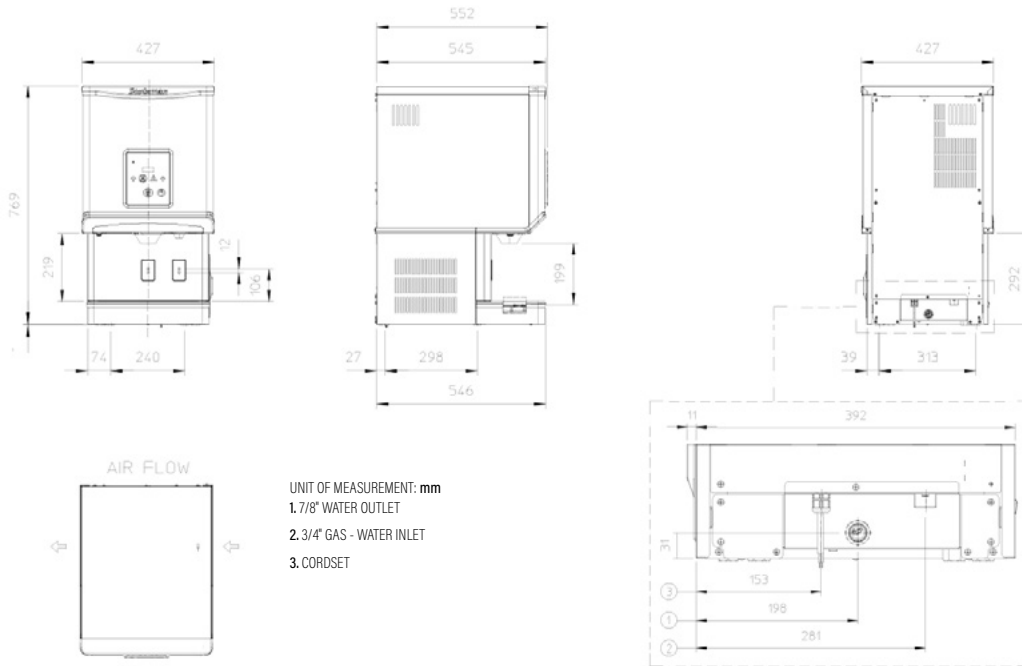

moffat.com.au

Australia
 Moffat Pty Limited
 Victoria/Tasmania
 740 Springvale Road
 Mulgrave, Victoria 3170
 Telephone 03-9518 3888
 Facsimile 03-9518 3833
 vsales@moffat.com.au

New South Wales
 Telephone 02-8833 4111
 nswsales@moffat.com.au

South Australia
 Telephone 03-9518 3888
 vsales@moffat.com.au

Queensland
 Telephone 07-3630 8600
 qldsales@moffat.com.au

Western Australia
 Telephone 08-9413 2400
 wasales@moffat.com.au

Ice production kg per 24 hours

Ambient temperature / Water temperature

10°C / 10°C	21°C / 10°C	32°C / 21°C
140	125	95

Dimensions

Width: 427mm
 Depth: 552mm
 Height: 769mm
 Nett weight: 49kg
 Packed weight: 56kg

Water consumption

Air cooled version: 4 litres per hour

Electrical rating

Air cooled version: 230-240V, 1P+N+E, 50Hz, 530W,
 10A cordset supplied
 No. Circuit wire: 3
 Compressor: 1200W*
 Energy consumption: 12.6kW/24hr*

* Based on 32°C ambient / 21°C water temperature conditions

Refrigerant type

R290

Installation distance from wall

Sides: 150mm
 Operating requirement air temperature 10-43°C

Water connection requirements

Inlet connection: R 3/4"
 Cold water: 5-38°C
 Pressure: 100-500kPa
 Water outlet connection: Ø20mm

Operating requirements

	Minimum	Maximum
Air temperature	10	43
Water temperature	5	38
Water pressure	1 bar / 14psi / 100kPa	5 bar / 70psi / 500kPa

Important Notice:

Models and specifications are subject to change without notice. This spec sheet is meant for commercial purpose only. For technical documentation please refer to our service manuals.



© Copyright Moffat Ltd
 AU.SM.2501