

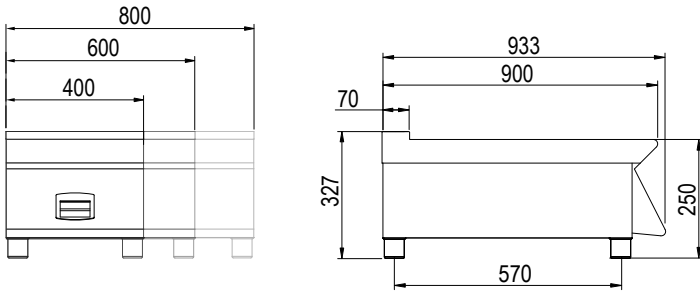

Product Information:

- Class leading, European style, professional quality and reliability since 1963
- 900 series, ambient worktops with drawer, available in 400, 600 and 800mm wide units
- Drawer with handle, suitable for 150mm high trays
- Robust 304 grade stainless steel construction with rounded corners for improved cleaning
- 24-month warranty

General Drawing:



Specifications:

Model	EN92CTT
W x D x H (mm)	400 x 920 x 327
Weight	- kg

Model	EN93CTT
W x D x H (mm)	600 x 920 x 327
Weight	- kg

Model	EN94CTT
W x D x H (mm)	800 x 920 x 327
Weight	- kg