

The Australian owned and designed\* Trueheat RC Series of Gas Cooking Equipment has been developed for the restaurant and cafe market with a high quality finish, designed to fulfill the busy demands within a commercial kitchen.

Sturdy stands are available in 300mm, 400mm, 600mm and 900mm widths.

Castors with or without brake can be added to 600mm and 900mm stands only. Stands fitted with castors will need to be cut down by 120-150mm.

#### DIMENSIONS & WEIGHT

Working height : 910mm (+/-15mm with stand)

External Dimension: 300W x 683D x 680H mm

Net Weight: 7.8kg

#### SHIPPING DATA

Shipping Dimensions: 360W x 740D x 170H mm

Shipping Weight: 8.9kg

SPECIFICATIONS ARE SUBJECT TO CHANGE WITHOUT NOTICE.

\*manufactured in China

## RCSTD3

### 300mm WIDE STANDS

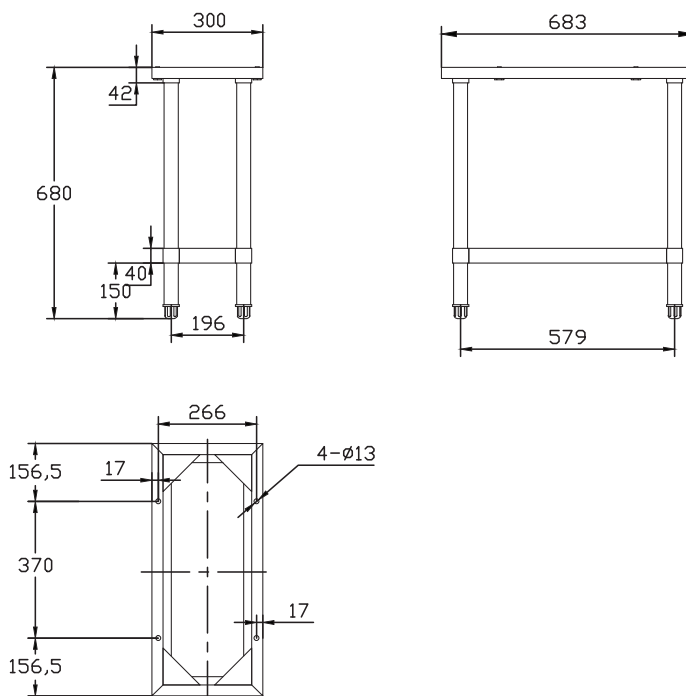

# INDUSTRY KITCHENS

www.industrykitchens.com.au 1800 611 058