

432mm WIDE MASTER SERIES TARGET TOP ATTACHMENT WITH STORAGE BASE

The Extra Heavy Duty Master Series' modular approach combines the convenience of custom kitchen design with proven, premium quality components to deliver world class functionality.

Featuring stainless steel construction front and sides, large front 'plate rail' 191mm deep and 2.5mm thick.

Dual cast-iron 'knuckle' burners sit below removable cast-iron ring and lid for concentrated heat at the target area with heat graduating further away from the target. Protected individual pilot lights and flame failure as standard. Large 683mm deep work surface fits three 300mm pots easily and the design allows pots to slide across the surface easily.

Large easy-to-use control knobs are located beneath the front rail protected from any potential spills. The modular top sits on of top the 683mm high storage base.

STANDARD FEATURES

- 152mm chrome steel adjustable legs
- Modular 1¼" front manifold
- Removable front-mounted s/steel grease receptacle
- 250mm stainless steel backguard
- Electric Spark ignition on all pilots

OPTIONAL FEATURES

- Gas regulator ¾" or 1¼"
- Rear gas connection, ¾", 1", or 1¼"
- 4 swivel casters with front brakes
- End caps and cover (NC, Specify)
- Dais base (not for use with "RC" oven)
- Stainless steel common front rail up to 1728mm wide (2 or more units in a battery)
- Gas flex hose & quick disconnect (¾", 1" or 1¼" x 5') w/restraining device

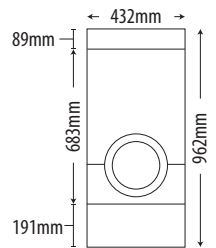

DIMENSIONS	
External Dimension: 432W x 962D x 1174H mm	
Working height : 924mm	
Modular Top: 432W x 965D x 491H mm	
Combustible wall clearance: Side: 356mm, Rear: 152mm	

TECHNICAL DATA		
Gas Type: Natural or LP		
Total Output:	Natural	LP
	42.2MJ	42.2MJ
Burner Ratings:	Natural	LP
Target Burner	42.2MJ	42.2MJ
Gas Connection: 1¼"		
Shipping weight: 105kg		

AGA approval number	
SC381	

SPECIFICATIONS ARE SUBJECT TO CHANGE WITHOUT NOTICE.

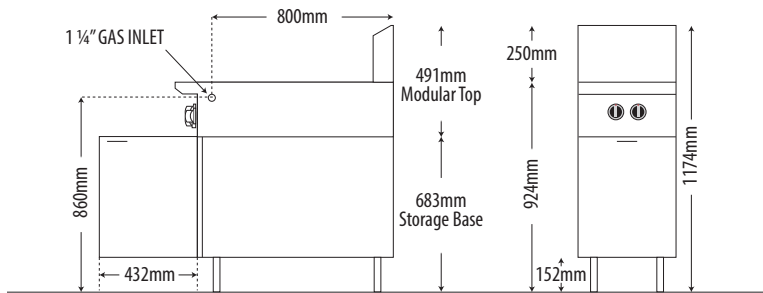

INDUSTRY KITCHENS

www.industrykitchens.com.au 1800 611 058



National Head Office
 156 Swann Drive
 Derrimut VIC 3030
 Tel: +61 3 8369 4600
 Fax: +61 3 8369 4699
www.comcater.com.au

Melbourne
 96-100 Tope Street
 South Melbourne VIC 3205
 Tel: +61 3 8369 4600
 Fax: +61 3 8699 1299

Sydney
 20/4 Avenue of the Americas
 Newington, NSW 2127
 Tel: +61 2 9748 3000
 Fax: +61 2 9648 4762

Brisbane
 1/62 Borthwick Avenue
 Murarrie QLD 4172
 Tel: +61 7 3399 3122
 Fax: +61 7 3399 5311

Perth
 Unit 16, 7 Abrams Street
 Balcatta, WA 6021
 Tel: +61 8 6217 0700
 Fax: +61 8 6217 0799

from the world of Comcater!