

# H2TLDS

MULTIDECK GLASS DOOR FREEZER DISPLAY CABINET



ENHANCED ENERGY EFFICIENCY  
& VERSATILITY

**PRODUCT BENEFITS**

- Ergonomic design for easy product access
- Adjustable shelving options to optimise merchandising
- Optimised display with LED lighting
- Product temperature compliance
- Easy plug-in on-site installation

**STANDARD FEATURES**

- Durable internal and external powder coat finish
- Vertical 4000K mullion LED lights
- 5 rows 450mm powder coated unlit shelves plus 480mm base
- Ticket strips
- Triple glazed hinged doors with grab handles
- Air return grill
- Long life galvanized internal base
- Solid end walls
- Stainless steel bumper
- Adjustable feet
- Evaporative condensate removal
- EC fan motors
- Digital controller with temperature display

**CUSTOMISATIONS**

**SHELVING & BASE SHELF**

- Optional additional shelves and brackets

**OTHER**

**TECHNOLOGY SOLUTIONS**

- Electronic shelf labels or video rail
- 35mm Castors (Not Lockable)

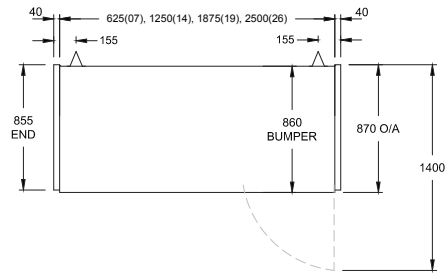
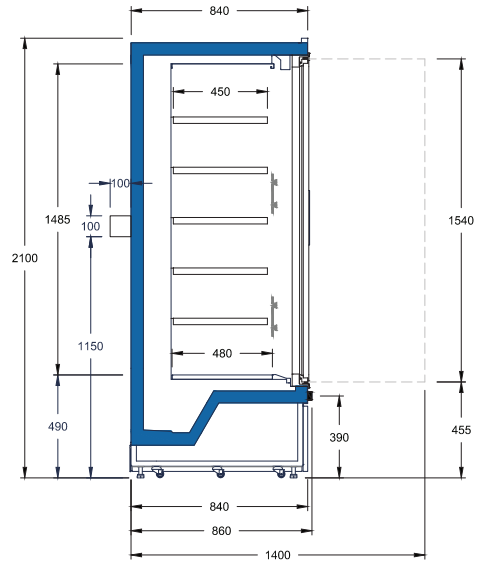

TECHNICAL DATA				
Model (H2TLDS)	H2TLDS-07	H2TLDS-14	H2TLDS-19	H2TLDS-26
Number of Doors	1	2	3	4
Depth (mm)	860			
Height (mm)	2100			
Length w/o ends (mm)	625	1250	1875	2500
Length with ends (mm)	705	1330	1955	2580
Net Volume (L)	239	479	718	958
Gross Volume (L)	576	1151	1727	2303
Display Area (m <sup>2</sup> )	0.811	1.607	2.469	3.317
Amperes (amps)	10	10	20	20

**AVAILABLE COLOURS**



**TEMPERATURE CLASS**

**3L1**

(-18 °C to -15 °C)

**Additional Information**

All Dimensions shown in Millimetres (mm) unless otherwise stated. Dimensions and features are subject to change. Please obtain current technical information prior to order confirmation.

**NOTE:** We reserve the right to change or revise specifications and product design in connection with any feature of our products. Such changes do not entitle the buyer to corresponding changes, improvements, additions or replacements for equipment previously sold or Shipped.



**Australia Head Office**  
 66 Glendenning Road Glendenning, NSW 2761 Australia  
 ph. +612 8805 0400  
 w. hussmann.com.au

