



WE ARE THE SPECICOOOLIST!

ESL3831
ESL3832

SALADETTES

FEATURES

- High grade stainless steel interior and exterior
- Heavy duty marble prep area (ESL3831)
- Heavy duty stainless steel top
- 43-degree ambient working temperature
- -2 to 8 degrees working temp
- Insulation foam CH10, ODP zero emissions
- Static cooling system
- Digital controls
- Self-evaporating drainage
- One shelf per door
- Manual defrosting system
- Regular defrosting recommended
- Compressor and condenser situated on bottom
- Unit can be positioned against a wall
- Fits GN pans
- White epoxy shelves and stainless steel rails
- Comes installed with 4 castors for easy mobility
- ESL3831 fits 5 x 1/6 GN pans 100mm deep
- ESL3832 fits 5 x 1/6 GN pans 100mm deep
- GN pans and lids not included
- ESL3831 Comes with 4 wired shelves
- ESL3832 Comes with 4 wired shelves
- Shelves RRP \$65.00 each



Two Doors Pizzatable
Marble Top Saladette

ESL3831



Two Doors
Open Top Saladette

ESL3832



INDUSTRY KITCHENS

www.industrykitchens.com.au 1800 611 058

INFORMATION

ESL3831

Capacity	300L
Power	310W
Voltage	220~240V/50Hz
Working Temp	-2°C~+8°C
Ambient Temp	43°C
Dimensions(mm)	W900 x D700 x H1095, 96kg
Packaging Dimensions(mm)	W955 x D754 x H1290, 125kg
RRP	\$2,289.00

ESL3831

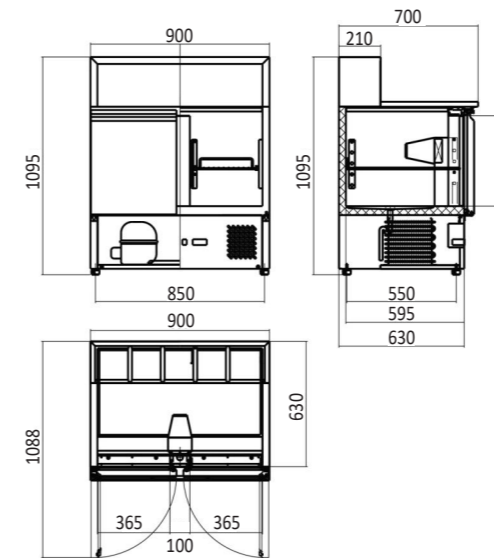

ESL3832

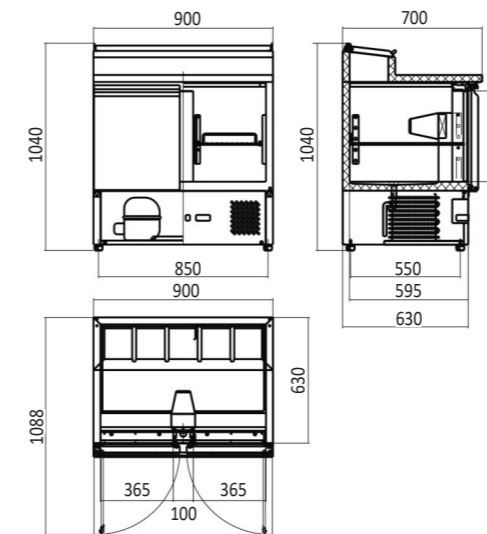

INFORMATION

ESL3832

Capacity	300L
Power	310W
Voltage	220~240V/50Hz
Working Temp	-2°C~+8°C
Ambient Temp	43°C
Dimensions(mm)	W900 x D700 x H1040, 77kg
Packaging Dimensions(mm)	W955 x D754 x H1211, 95kg
RRP	\$2,289.00



2 YEARS WARRANTY ON ALL PARTS & LABOUR
EXTRA 2 YEARS WARRANTY ON PARTS WHEN YOU REGISTER WITH US ONLINE

* All prices are EX-GST

* All prices are EX-GST