



PRODUCT ADVANTAGES

- PERMANENT-CLEAN automatic soil removal: innovative filter system eliminates manual pre-cleaning. Soil is immediately removed into an external strainer, which saves operating costs and protects the machine
- VISIOTRONIC control: single button control with remaining time indicator together with text and graphic display
- SENSO-ACTIVE resource management: constantly measures the quality of the wash water and keeps the amount of rinsing needed in each rinse cycle to the minimum in order to guarantee a fully hygienic wash result
- Eco programme: switchable steam rinse cycle reduces fresh-water consumption to 1.4 l/cycle. Saving of up to 44 % water and chemicals
- VAPO-ACTIVE steam washing: significantly less manual pre-cleaning and second runs by intensive wash cycles with steam
- POWER-PLUS wash programme: selectable high-pressure programme to wash heavily soiled wash items
- Exhaust energy storage: the fully enclosed 4-sided hood keeps steam and energy inside the system: energy saving up to 3 kW, less humidity in the kitchen area and better hygienic conditions
- USB-interface: download of operational data via USB
- CLIP-IN wash and rinse arms: wash and rinse arms can be removed with one hand and without any tools
- ROTOR-X wash system: separate rotating upper & lower 4-spoke wash arms deliver dynamic wash power
- VAPOSTOP (optional): prevents vapour escaping from the machine when the hood is opened. Certified to remove the need for an exhaust canopy
- Intelligent energy management: the available energy is used continuously. Thus, at a low total loading value the heating time gets reduced
- Interlocked strainer: prevents operation without tank strainer
- EASY-CLEAN: items with blue markings identify components which require cleaning
- Hygiene programme: for removal of calcium carbonate and other deposits from wash chamber
- WATERMARK approved

TECHNICAL DATA

Cycle times*	1. 52sec 2. 70sec 3. 170sec 4. 180sec.
Water consumption	1.4 l/rack
Tank capacity	40 litres
Tank heating	2.5 kW
Power supply	415 / 50 / 3N
Booster loading	
Standard	12.4 kW
Alternative	6.2 kW
Total loading	
Standard	17.5 3 x 32 A
Alternative	11.3 3 x 25 A
Wash pump	2 x 1.1 kW
Rack size	500 x 500 mm
Loading height	440 mm
Noise level	67 dB (A)
Weight (gross / net)	145 / 125 kg

INDUSTRY KITCHENS

www.industrykitchens.com.au 1800 611 058

CONNECTIONS

① Drain hose - 2nd drain required - see point 6 below	2,000 mm ID 20 / OD 25
② Supply hose	2,000 mm R 3/4"
Required flow rate	5 l/min
Flow pressure	0.5 (0.8 with softener)- 6 bar
Max. supply water temperature	60 °C 35 °C With RO
③ Power cord	2,500 mm
Supply hose for	
④ Detergent	2,000 mm
⑤ Rinse aid	2,000 mm
⑥ Drain hose for PERMANENT-CLEAN	2,000 mm ID 20 / OD 25

DIMENSIONAL DRAWING

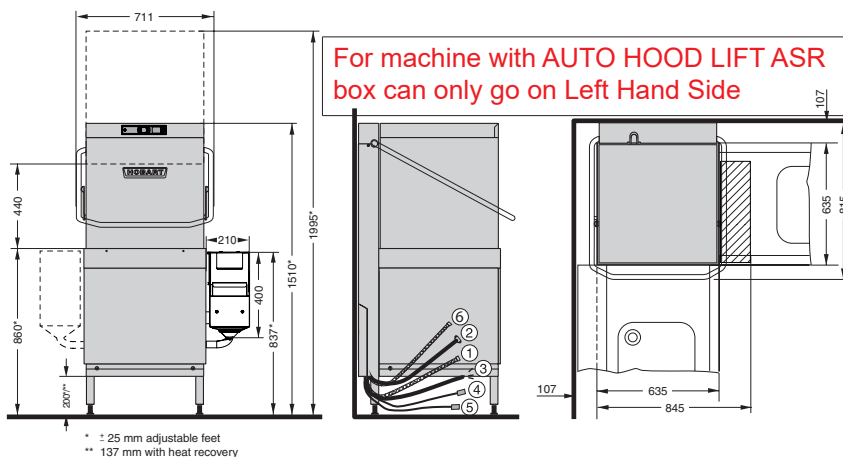

** Thermostop guarantees required temperatures with cold water, the actual cycle times extend accordingly.

For corner operation we recommend to make the right side of the machine accessible for service.

For machine protection the water hardness should not exceed 3°dH, if higher we recommend using an integrated water softener or a HOBART HYDROLINE water treatment system.