

# Sinks & Basins



## Wall Mounted Hand Basin with Splashback

### HB300SB

#### HB300SB - 1TH (35mm Centre Tap Hole)

- 12.2 Litre Capacity
- Constructed from 1mm 304 Grade Stainless Steel
- 300mm Splashback
- 40mm Outlet - Suits PW40 & SSBW-40
- Comes Complete with Wall Brackets
- Mirror Polish Finish
- Available in 1, 2 or 3 Tap Hole Configurations
- Taphole Position and Size to Be Indicated When Ordering
- Galvanised Brackets



Use optional SAFETEE-STRIP for no sharp edges

Top

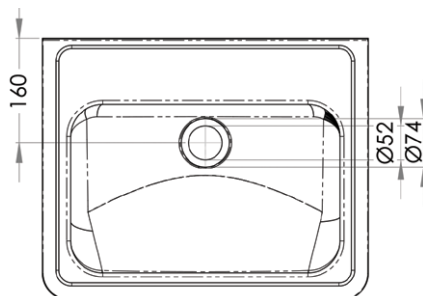

Front

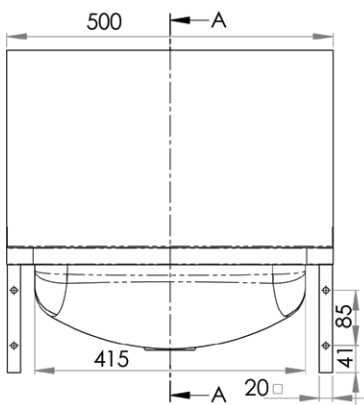

Cross Section

