



410BT Series Bluetooth® Battery Powered Irrigation Controller

410BT-000 | 410BT-075 | 410BT-100 | 410BT-150 | 410BT-200



I N S T R U C T I O N M A N U A L

FCC certified | Bluetooth® certified | Waterproof | 3-year Limited Warranty

1. INTRODUCTION

Thank you for purchasing DIG's 410BT Single Station Battery Operated Controller. This manual describes how to get the 410BT series controller up and running quickly. After reading this manual and becoming familiar with the basic functionality of the controller, use the manual as a reference for less common tasks in the future.

2. ABOUT THE 410BT BATTERY OPERATED CONTROLLER

The 410BT series irrigation controller employs the latest in Bluetooth® technology using the free DIG BTT app for Android™ or iPhone®. The 410BT is available as a single station battery operated controller and is powered by two AA batteries that can last up to one year using name brand alkaline batteries. The controller is enclosed in a compact, waterproof housing to protect it from degradation.

3. COMPONENT IDENTIFICATION



4. INSTALLING THE BATTERIES

1. Open the battery compartment cap by turning it counterclockwise.
2. Install two fresh, brand name, AA alkaline batteries (not included) and note the proper direction of the positive and negative orientation on the underside of the controller.
3. Insert and screw the battery cap clockwise. Make sure to securely tighten the cover firmly by hand only. The controller will now appear on the smartphone app and is ready to be connected to and programmed.

5. VALVE ADAPTER INSTALLATION

The 410BT series controller includes three adapters to retrofit Rainbird, Hunter and Toro valves. Follow the instructions below to install.

1. Shut off the main water supply
2. Remove the existing solenoid if applicable.
NOTE: If adapting to an IRRITROL valve, remove the solenoid but leave the existing solenoid adapter installed.
3. Select the appropriate solenoid adapter associated with the valve. (see chart A)
4. Screw the solenoid adapter into the valve bonnet by hand, tighten with pliers if necessary – but do not over tighten.
5. Thread the 410BT series solenoid into the valve adapter. Hand tighten only.
6. Turn the main water supply on and pressurize the valve; the valve may discharge water momentarily but should then shut off.
7. Test the controller and the installation by pressing the button on the controller or see pages 11-12 on how to perform a manual run through the app. To turn the valve on via the solenoid, lift the 410BT series controller from the solenoid and turn the solenoid

counter clockwise 1/2 to 3/4 of a turn, or until you hear or see water flowing through the valve. To turn the water off, turn the solenoid clockwise 1/2 to 3/4 of a turn and wait a few seconds for the valve to close.

8. Program the 410BT series controller (see pages 4-12).

CHART A

Model	Compatible Valves
30-920	BERMAD series 200, HIT series 500, DOROT series 80, GRISWOLD series 2000, DW and BUCKNER series VB valves
30-921 INCLUDED	RAIN BIRD DV, DVF, PGA, PEB (1" only), GB, EFB-CP, BPE, PESB (1" only) and ASVF valves
30-922 INCLUDED	HUNTER series ASV, HPV, ICV, PGV, SRV, IBV and ASVF valves
30-923	WEATHERMATIC series 12000, 21000, 8200CR valves
30-924 INCLUDED	IRRITROL series 100, 200B, 205, 217B, 700, 2400, 2500, 2600 and TORO series 220, P220 valves
30-925	SUPERIOR series 950, HUNTER HBV and TORO series 252 valves (1.5" and larger)

6. IN-LINE VALVE INSTALLATION

Rated operating pressure: 10-125 PSI

Recommended Operating Pressure: 10-80 PSI

Warning: Wrap all fittings with Teflon tape! Do not use pipe cement on fittings or the valve as this will damage the valve and void the warranty!

1. Shut off main water supply.
2. Install a 3/4" ball or gate valve onto the PVC pipe or to the valve manifold before installing the controller (Figure 6a and 6b).

3. Turn water supply on to flush the line and then shut the water off using the ball or gate valve.
4. Wrap the male threads of the PVC adapters with 4-6 layers of Teflon tape, then tighten into the valve with a wrench.
5. Glue fittings to PVC main line and allow to dry.
6. Turn water supply on to pressurize the system. The controller will open momentarily and then will shut off.
7. The unit is now ready to be programmed

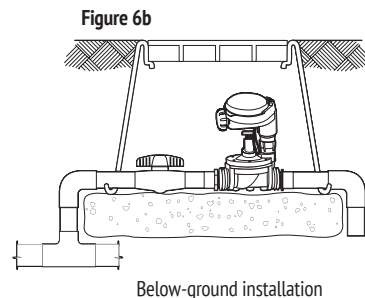
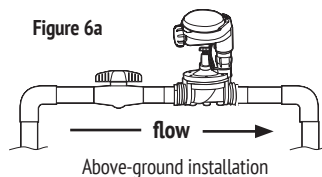

7. PROGRAMMING

- Download the DIG BTT app using the iOS App Store, Google Play, or the QR code on the box.
- Open the DIG BTT app from your smartphone or tablet and use the instructions in the App Screens Overview to program and operate the controller.

APP SCREENS OVERVIEW

The DIG BTT app automatically scans for nearby controllers after installation. Any DIG Bluetooth® controllers within 50' (15 meters) line of sight will appear on screen.

- Your new controller will appear as the BT Controller. Its default image, status (watering -on- or not watering -off-), connection strength, and battery life will appear alongside it.
- Tap on the controller to connect to it and start programming.

You can access [Connection History](#) and [Contact Us](#) through the information icon  in the top right corner of the screen.

- The Connection History allows you to see every controller and timer connected to from this phone or tablet. It stores the data it last received from each tap timer, but no editing can be done. Deleting an entry will remove all the saved data for that unit. Any passwords and/or pictures need to be reentered. To delete an entry, tap it and select the trash icon.



HOME SCREEN

Once connected, the Home screen will appear. This screen has everything needed to program the controller.

By default, the controller's Program is off. To turn it on, push the switch under the "Program" area. It will turn green and the Program area will light up indicating that the program is active and can now be modified.

The controller is now ready to be programmed. Simply select the schedule (weekly, even/odd, or cyclical), set your start date or days, add times, and set a duration. The controller is updated immediately each time a button is tapped.

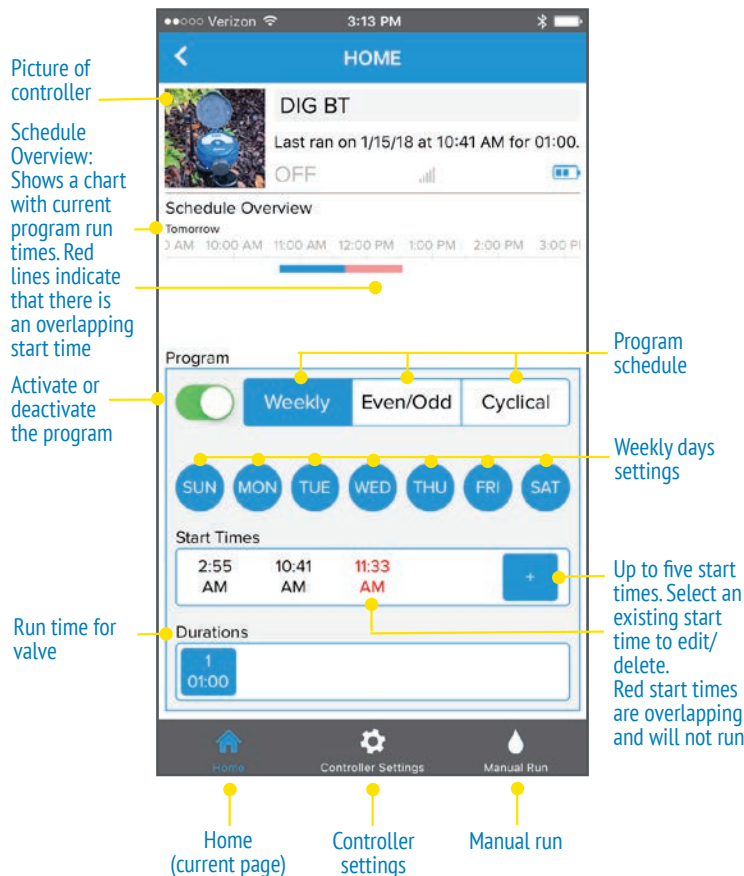

CONTROLLER SETTINGS

The controller's Settings screen contains everything else needed to fully control your irrigation system. It can be reached by selecting the Controller Settings button  on the bottom of the screen. On this screen you can turn on or off the entire system through the System Active switch, add a rain delay to shut off the controller for a limited time, budget each month to modify the watering duration based on the season, set specific dates on which the timer should not run, and view 12-month history of the controller.

Use the settings menu to rename the controller to something memorable and upload a picture for easy and fast recognition for future viewing. Set a password to prevent unallowed users from connecting to your timer. The password is saved to the phone so it will (almost) never have to be entered again (unless it's changed or when connecting to the timer with a new phone).

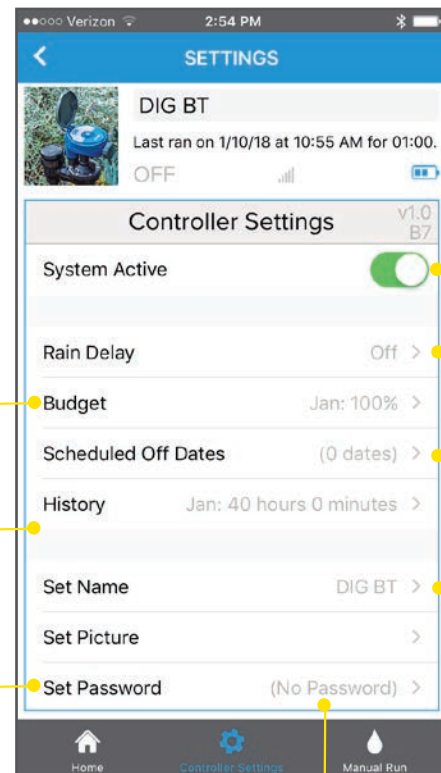

Budgeting
per month
(affects duration
only)

View monthly
watering
history for the
past 12 months

Set picture for
the controller

Turn the entire
system on/off.
Controller will
not water when
system is off

Set a rain
delay

Set up to nine
dates where
the controller
will prevent
watering

Set name of
the controller

Set password for controller. Password will only be seen
when entering controller from a new phone. Reset
controller to reset password if forgotten

MANUAL RUN

The Manual Run screen allows for manual operation of the controller. It can be reached by selecting the Manual Run button  on the bottom right of the screen.

To manually run the controller, tap the button on the right of the screen. This button can also be used to stop any existing run. The default manual run time is for five minutes; this can be changed by tapping on the time and changing it.

The controller can also manually run from the controller itself by tapping the water droplet button . The duration of this manual run is equal to the duration of the scheduled program. The button can also be used to end any watering.

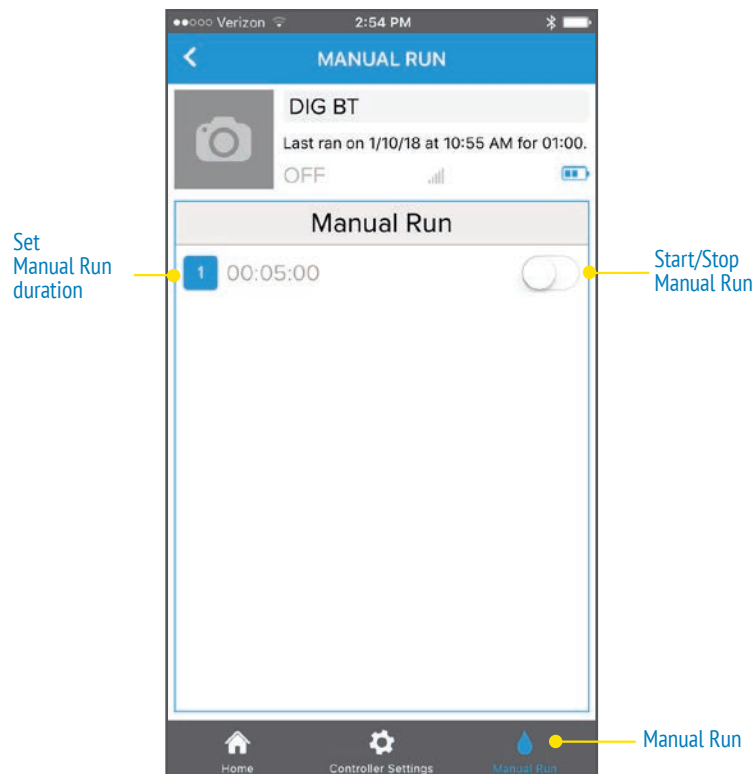

RESET TO FACTORY DEFAULTS

- Press and hold the button on the 410BT for 15 seconds. This will remove all app settings, historical information, and any set passwords. This is the only way to remove a password so try not to forget it!

TECHNICAL ASSISTANCE

Should you encounter any problem(s) with this product or if you do not understand its many features, please refer to this operating manual first. If further assistance is required, DIG offers the following customer support:

- DIGPRO Technical Service USA: DIG's Technical Service Team is available to answer questions in English and Spanish from 8:00 AM to 5:00 PM (PST) Monday-Friday (except holidays) at 1.800.344.2281 or 1.760.727-0914.
- Questions also can be e-mailed to questions@digcorp.com or faxed to 760.727.0282.
- Specification documents and manuals are available for download at www.digcorp.com.
- Customer Assistance Outside the USA: Contact your local distributor

FCC

This device complies with FCC and IC radiation exposure limits set forth for an uncontrolled environment. The device should be installed and operated with a minimum distance of 20cm between the radiator and your body. This device must not be collocated or operating in conjunction with any other antenna or transmitter.

I. Changes or modifications not expressly approved by DIG Corporation could void the user's authority to operate the equipment.

II. This equipment has been tested and found to comply with the limits for a Class B digital device, pursuant to Part 15 of the FCC Rules. These limits are designed to provide reasonable protection against harmful interference in a residential installation. This equipment generates, uses and can radiate radio frequency energy and, if not installed and used in accordance with the instructions, may cause harmful interference to radio communications. However, there is no guarantee that interference will not occur in a particular installation. If this equipment does cause harmful interference to radio or television reception, which can be determined by turning the equipment off and on, the user is encouraged to try to correct the interference by one of the following measures: Reorient or relocate the receiving antenna. Increase the separation between the equipment and receiver.

Connect the equipment into an outlet on a circuit different from that to which the receiver is connected. Consult the dealer or an experienced radio/TV technician for help.

III. Industry Canada

This device complies with Industry Canada licence-exempt RSS standard(s). Operation is subject to the following two conditions: (1) this device may not cause interference, and (2) this device must accept any interference, including interference that may cause undesired operation of the device.

Le présent appareil est conforme aux CNR d'Industrie Canada applicables aux appareils radio exempts de licence. L'exploitation est autorisée aux deux conditions suivantes : (1) l'appareil ne doit pas produire de brouillage, et (2) l'appareil doit accepter tout brouillage radioélectrique subi, même si le brouillage est susceptible d'en compromettre le fonctionnement.

WARRANTY

DIG CORPORATION warrants these products to be free from defects in material and workmanship for a period of three years from date of purchase. This warranty does not cover damage resulting from accident, indoor uses, misuse, neglect, modification, improper installation or subsection to line pressure more than 125 lbs. per square inch for anti-siphon valves, in-line valves and from an actuator. This warranty shall extend only to the original purchaser of the product for use by the purchaser. The obligation of DIG CORPORATION under this warranty is limited to repairing or replacing at its factory this product which shall be returned to the factory within three years after the original purchase and which on examination is found to contain defects in material and workmanship. DIG CORPORATION SHALL IN NO EVENT BE LIABLE FOR ANY INCIDENTAL OR CONSEQUENTIAL DAMAGES OF ANY KIND; THE SOLE OBLIGATION OF DIG BEING LIMITED TO REPAIR OR REPLACEMENT OF DEFECTIVE PRODUCTS. SOME STATES DO NOT ALLOW THE EXCLUSION OR LIMITATION OF INCIDENTAL OR CONSEQUENTIAL DAMAGES, SO THE ABOVE LIMITATION OR EXCLUSION MAY NOT APPLY TO YOU. Unattended use for prolonged periods without inspection to verify proper operation is beyond the intended use of this product, and any damage resulting from such use shall not be the responsibility of DIG CORPORATION. There are no warranties, which extend beyond the description on the face hereof. In the case of purchase of the product for use other than, for irrigation purposes, DIG CORPORATION hereby disclaims any implied warranties including any warranties of merchantability and fitness for a particular purpose. In the case of the purchase of the product for personal, family or household purposes, DIG CORPORATION disclaims any such warranties to the extent permitted by law. To the extent that any such disclaimer or implied warranties shall be ineffectual, then any implied warranties shall be limited in duration to a period of three years from the date of the original purchase for use by the purchaser. Some states do not allow limitation on how long an implied warranty lasts, so the above limitation may not apply to you. In order to obtain performance under this warranty, the unit must be returned to the factory, along with proof of purchase indicating original date of purchase, shipping prepaid, addressed as follows: DIG CORPORATION, 1210 Activity Drive, Vista, CA 92081. Repaired or replaced units will be shipped prepaid to the name and address supplied with the unit returned under warranty. Allow four weeks for repairs and shipping time. Repair of damaged units not otherwise within warranty may be refused or done at a reasonable cost or charge at the option of DIG CORPORATION. This warranty gives you specific legal rights, and you may also have other rights, which vary from state to state.



1210 Activity Drive
Vista, CA 92081-8510, USA



www.digcorp.com
e-mail: dig@digcorp.com

26-304 REVA 041618

Printed in the USA

DIG is a Registered Service Mark of DIG Corp.