



# SkyVisualEditor

## V18.0 Update Release Notes



Last Modified : December 18<sup>th</sup>, 2022.

## - Introduction

These release notes will cover the basic information about the new features and existing features enhancements. The updates may have an effect on your existing system. The new updates which may affect your existing pages will be marked with an **Important** icon. Please consider the effect on the existing pages when you deploy your page. For more details, please refer to the help documents which are scheduled to be released at the time of the update.

※This release notes includes the updates of V17.2 .

Help Documents :

SkyVisualEditor Portal <https://doc.terrasky.com/display/SVEPP4JA/Home>

SkyVisualEditor VF <https://doc.terrasky.com/display/SVE4JA/Home>

SkyVisualEditor LC <https://doc.terrasky.com/display/SVELC4JA/Home>

- **Table of Contents**

- V18.0 Updates ..... 4
  - 1. SkyVisualEditor LC Updates ..... 4
    - 1.1 New component Flexible Data Tables. .... 4
    - 1.2 Easily configure authentication for Slack components. .... 5
  - 2. SkyVisualEditor VF Updates ..... 6
    - 2.1 Search conditions can be shared with other users. .... 6
    - 2.2 Larger and more Freehand input items can be placed. .... 7
    - 2.3 Studio for Windows officially supports Windows 11. .... 7

- **V18.0 Updates**

**1. SkyVisualEditor LC Updates**

Here are the updates for SkyVisualEditor LC.

**1.1 New component Flexible Data Tables.**

A new feature, Flexible Data Tables, has been added. Flexible Data Tables are data tables with the following features.

- No need to deploy from Studio, they can be deployed from the Lightning application builder and used immediately.
- Users can customise the display items and column positions in Salesforce with simple operations

Users can sort in ascending/descending order, fix rows/columns, set search filters, change column positions with drag-and-drop, set multi-row headers, and flexibly change layouts with a single click. Users can also easily export CSV files from the customised layout with a right-click.

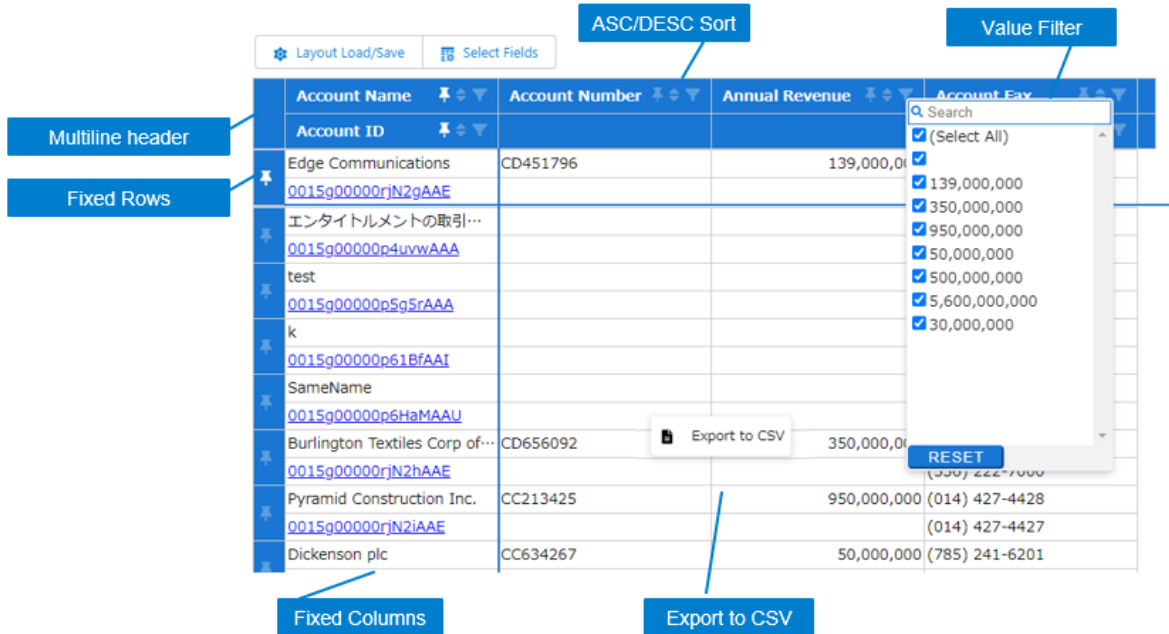

**Figure 1-1 Examples of the various functions of Flexible Data Tables**

## 1.2 Easily configure authentication for Slack components.

The Slack component's authentication settings no longer require the input of authentication information, making it easier to set up when using the component.

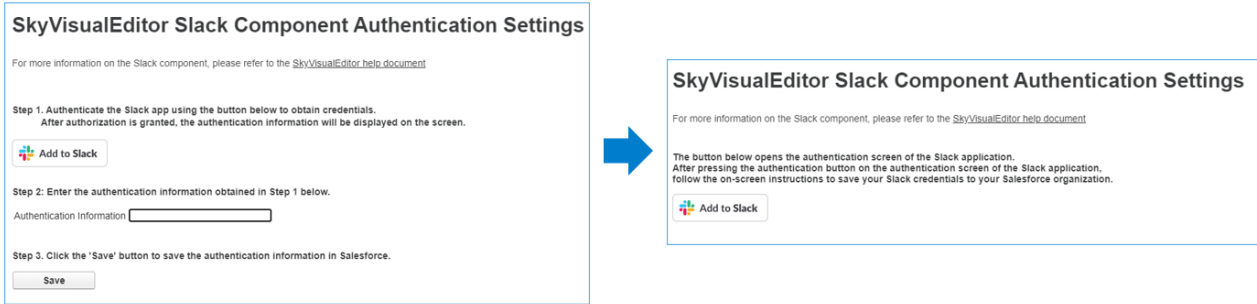

**Figure 1-2 Before and after changes to the Slack component authentication configuration screen.**

## 2. SkyVisualEditor VF Updates

Here are the updates for SkyVisualEditor VF.

### 2.1 Search conditions can be shared with other users.

Search conditions can be shared with other users when Save/Load search conditions.

This enables work efficiency improvements, such as "the leader registers in advance shared search criteria that are frequently used for specific tasks, and members read and use the shared search criteria".

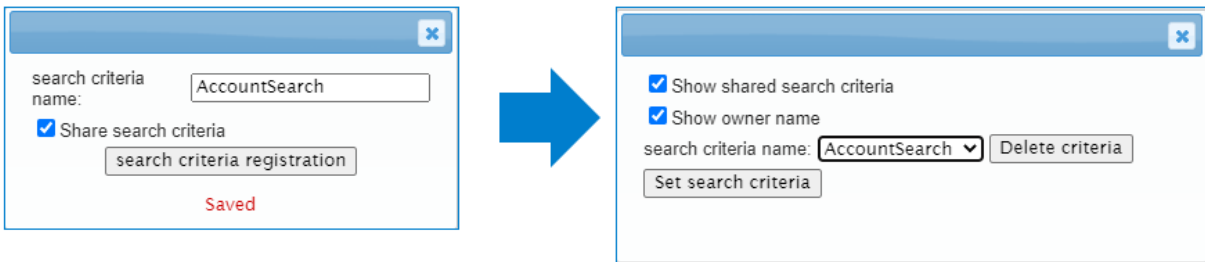

**Figure 2-1 Save shared search criteria (left) and Load shared search criteria (right).**

## **2.2 Larger and more Freehand input items can be placed.**

The maximum size of Freehand input items has been extended to 4000px and the number of items that can be placed on the screen to 8.

You can now make more use of the useful functions of Freehand input items, such as the ability to set a background image for photos taken with a tablet, which was added in V17.0.

## **2.3 Studio for Windows officially supports Windows 11.**

The Windows version of Studio is now officially compatible with Windows 11, making it available to customers in more environments.

SkyVisualEditor V18.0 Update Release Notes

SkyVisualEditor V18.0 Update Release Notes

---

TerraSky, Inc.

URL : <http://www.terrasky.com>

E-Mail : [support@terrasky.com](mailto:support@terrasky.com)

---