

Battery-powered Flashing Beacons

PFH

| | | |
|---------------------------------|--------------------|---------------------------|
| Φ101 | CE | RoHS 10 |
| IP55 | Indoor/Outdoor Use | Upright/Sideways Mounting |
| Ambient Temperature -10°C~+50°C | Red, Amber | Flash Battery |



Dimensions (mm)

Side view

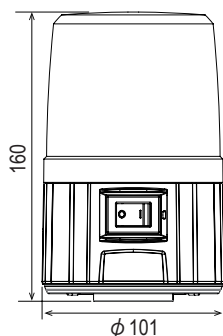

Bottom view

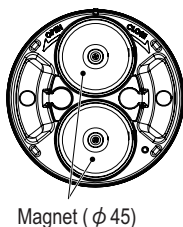

Small Rotating Beacons

SKH-EA

| | | | |
|-------------------------|--------------------------------------|--------------------------------------|--------------------------------------|
| Φ100 mm | CE | RoHS 10 | IP23 |
| Indoor/Outdoor Use | Upright/Sideways*/Inverted* Mounting | Ambient Temperature -30°C~+80°C (DC) | Ambient Temperature -30°C~+60°C (AC) |
| Red, Amber, Green, Blue | Motorized Rotation | | |



Dimensions (mm)

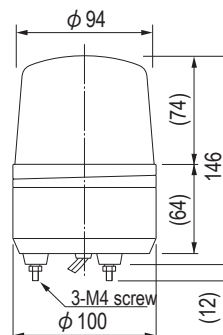

Installation Dimension Drawings

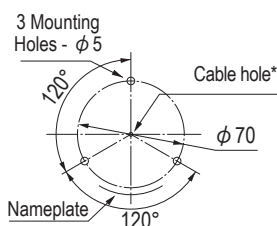

*To pass a 100V plug a Φ30 cable hole is required.

Product List

| Model Number | Power Supply | Luminous Color | Mass |
|--------------|---|----------------|-----------------------------|
| PFH-BT-R-Y | 4 AA alkaline or nickel metal hydride batteries | Red/Amber | 0.51 kg (without batteries) |

- Toggle between "Flash pattern" and "Lighting mode" depending on your application: Indoors, outdoors, day or night.

High visibility
Power mode

Battery life (24 h) *

Double flash
Single flash

Long-lasting
Eco Mode

Battery life (100 h) *

Double flash
Single flash

* Battery life will vary depending on battery type and environmental conditions.

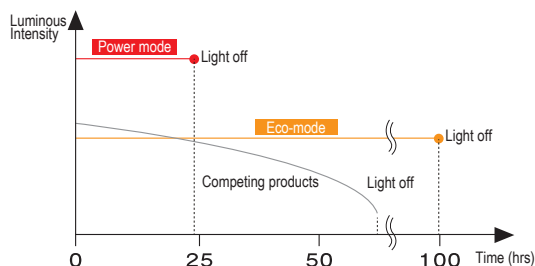

As the battery wears out the light will not dim but visibility and brightness are maintained until the end.

Product List

| Model Number | Rated Voltage | Bulb | No. | Luminous Color | Power Consumption | Mass |
|-------------------|---------------|---------|-----|------------------------|-------------------|-------|
| SKH-12EA-R/Y/G/B | 12V DC | 12V 10W | 9 | Red/ Amber/ Green/Blue | 9.6W | 0.4kg |
| SKH-24EA-R/Y/G/B | 24V DC | 24V 10W | 10 | Red/ Amber/ Green/Blue | 12.0W | 0.4kg |
| SKH-100EA-R/Y/G/B | 100V AC | 12V 5W | 12 | Red/ Amber/ Green/Blue | 6.2W | 0.6kg |
| SKH-200EA-R/Y/G/B | 200V AC | 12V 5W | 12 | Red/ Amber/ Green/Blue | 6.5W | 0.6kg |

Bulb shape: Halogen bulb cap BA15S

| Bulb No. | Model Number |
|----------|---------------|
| 9 | D01201003A-F1 |
| 10 | D02401003A-F1 |
| 12 | D01200503A-F1 |

Optional Parts

For details refer to P. 99 to P. 104

| Product Description | Model Number |
|---------------------|--------------|
| Wall Mount Bracket | SZ-007 |