

1.5" Series

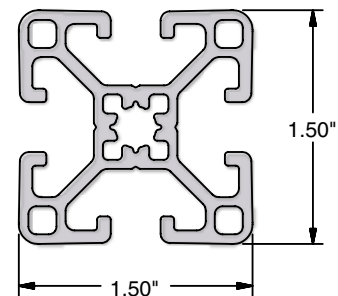
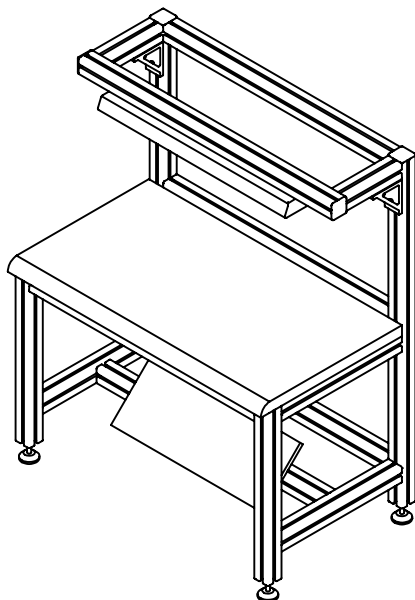

12-1515* ♦

Application

The 12-1515, 10-1515 and 11-1515 are ideal general purpose extrusions for guards, enclosures, work stations, tool carts and smaller machine frames. T-slots on four sides allows for effortless mounting of accessories directly onto the structure without additional machining.

Technical Data

Aluminum, Clear Anodized (See Technical Data page 17 for full material and finish specification)

Part #	I_x [cm ⁴]	I_y [cm ⁴]	W_x [cm ³]	W_y [cm ³]	Section [cm ²]	Weight [kg/m]
10-1515	8.49	8.49	4.46	4.46	6.19	1.70
11-1515	11.24	11.24	5.90	5.90	7.74	2.10
12-1515	7.08	7.08	3.72	3.72	4.82	1.31

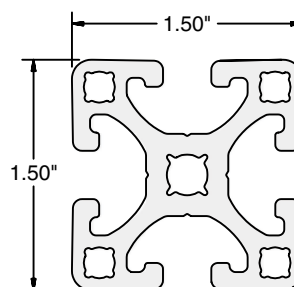

10-1515 ♦

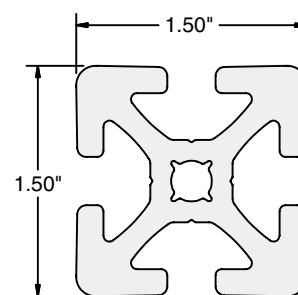

11-1515

Ordering Information

Description

Profile 1.5" x 1.5" Light
Profile 1.5" x 1.5" Standard
Profile 1.5" x 1.5" Heavy
Cut to Length Service Number

Max. Length

6 meters
6 meters
6 meters

Part

12-1515
10-1515
11-1515
19-001

End Cap

1.5" x 1.5"

Part

18-1515

*End tap requires spiral tap

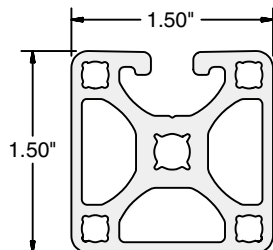

10-1591

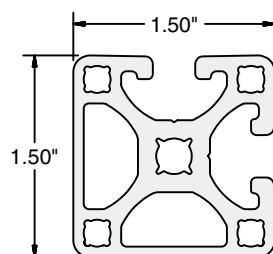

10-1592

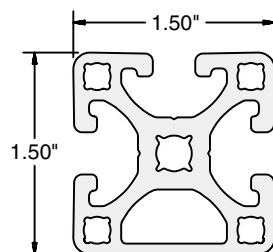

10-1593

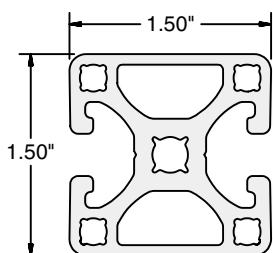

10-1594

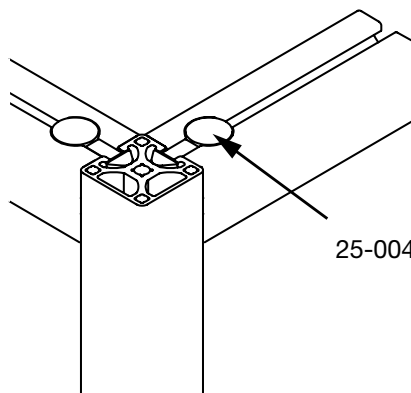

Application

These profiles are designed with various closed faces. They are particularly useful when a smooth appearance is desired. The smooth surfaces are ideal for clean room, packaging, medical and pharmaceutical applications. The option of different T-slotted faces is ideal for fastening the profiles while retaining a smooth exterior to create the most aesthetic appearance.

Technical Data

Aluminum, Clear Anodized (See Technical Data page 17 for full material and finish specification)

Part #	I_x [cm ⁴]	I_y [cm ⁴]	W_x [cm ³]	W_y [cm ³]	Section [cm ²]	Weight [kg/m]
10-1591	8.53	8.70	4.47	4.57	6.20	1.68
10-1592	8.62	8.62	4.51	4.51	6.24	1.68
10-1593	8.66	8.49	4.53	4.46	6.22	1.69
10-1594	8.78	8.45	4.61	4.44	6.21	1.68

Ordering Information

Description

Profile 1.5" x 1.5" Mono-Slot
Profile 1.5" x 1.5" Bi-Slot Corner
Profile 1.5" x 1.5" Tri-Slot
Profile 1.5" x 1.5" Bi-Slot Midframe
Cut to Length Service Number

Max. Length

6 meters
6 meters
6 meters
6 meters

Part

10-1591
10-1592
10-1593
10-1594
19-001

End Cap

1.5" x 1.5"

Part

18-1515

1.5" Series

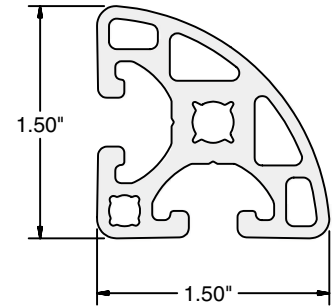
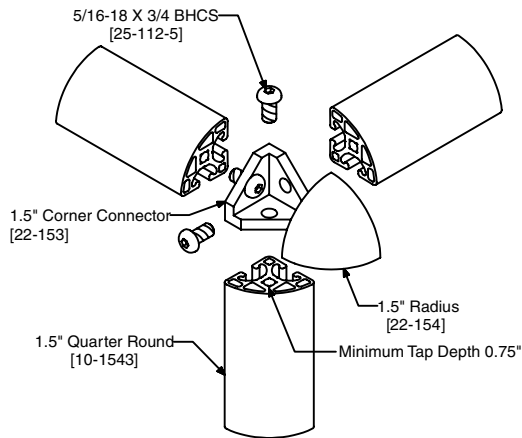

10-1543

Application

This profile is designed with a curved surface while retaining T-slotted surfaces for connecting. This is particularly useful for rounding or smoothing off corners of structures where ergonomics apply. The smooth surfaces are ideal for clean room, medical and pharmaceutical applications.

Technical Data

Aluminum, Clear Anodized (See Technical Data page 17 for full material and finish Specification)

Part #	I_x [cm ⁴]	I_y [cm ⁴]	W_x [cm ³]	W_y [cm ³]	Section [cm ²]	Weight [kg/m]
10-1543	6.16	6.16	2.90	2.90	5.48	1.47

Ordering Information

Description	Max. Length	Part #
Profile 1.5" x 1.5" Quarter Round Cut to Length Service Number	6 meters	10-1543 19-001
End Cap	Part #	
1.5" x 1.5" Quarter Round	18-1543	

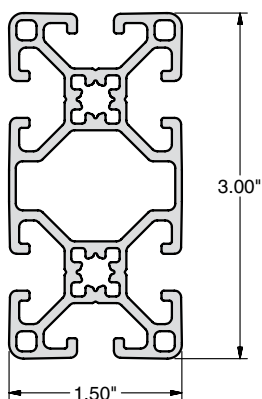

12-1530*

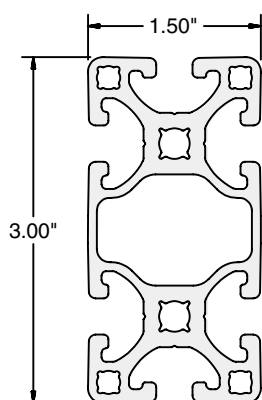

10-1530

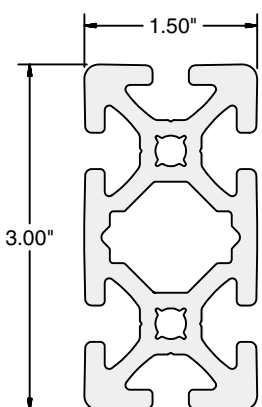

11-1530

* End tap requires spiral tap

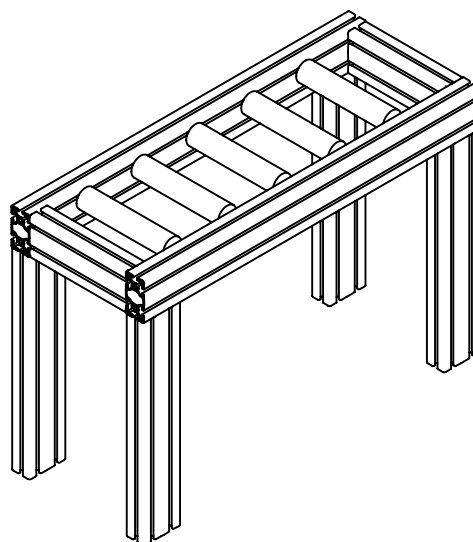

Application

Profiles 10-1530 and 11-1530 are ideal general purpose extrusions for guards, enclosures, work stations, tool carts and machine frames. They are designed with a high inertial strength in the "Y" axis. This allows higher structural integrity to create more stable and rigid structures. T-slots on four sides allow for effortless mounting of accessories directly onto the structure without additional machining.

Technical Data

Aluminum, Clear Anodized (See Technical Data page 17 for full material and finish Specification)

Part #	I_x [cm ⁴]	I_y [cm ⁴]	W_x [cm ³]	W_y [cm ³]	Section [cm ²]	Weight [kg/m]
10-1530	15.15	61.85	7.95	16.23	10.38	2.81
11-1530	21.10	78.79	11.08	20.68	14.00	3.72
12-1530	13.10	49.63	6.88	13.03	8.43	2.28

Ordering Information

Description

Profile 1.5" x 3" Light
Profile 1.5" x 3" Standard
Profile 1.5" x 3" Heavy
Cut to Length Service Number

Max. Length

6 meters
6 meters
6 meters

Part

12-1530
10-1530
11-1530
19-001

End Cap

1.5" x 3"

Part

18-1530

1.5" Series

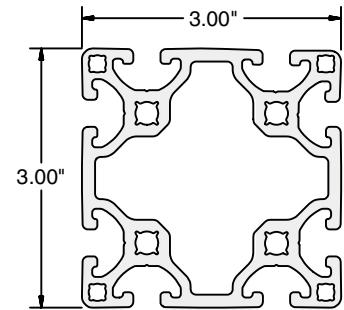
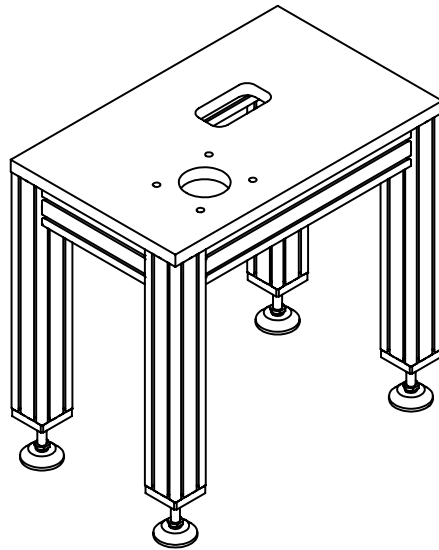

10-3030

Application

These profiles are designed for medium to heavy duty structures and are ideal for structural support and post applications. These profiles have high structural integrity to create extra stable and rigid structures. T-slots on four sides allow for effortless mounting of accessories directly onto the structure without additional machining.

Technical Data

Aluminum, Clear Anodized (See Technical Data page 17 for full material and finish specification)

Part #	I_x [cm ⁴]	I_y [cm ⁴]	W_x [cm ³]	W_y [cm ³]	Section [cm ²]	Weight [kg/m]
10-3030	113.38	113.38	29.76	29.76	17.42	4.72
11-3030	146.43	146.43	38.43	38.43	22.61	6.04

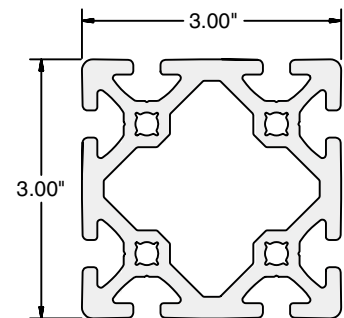

11-3030

Ordering Information

Description

Profile 3" x 3" Standard
Profile 3" x 3" Heavy
Cut to Length Service Number

Max. Length

6 meters
6 meters

Part

10-3030
11-3030
19-002

End Cap

3" x 3"

Part

18-3030

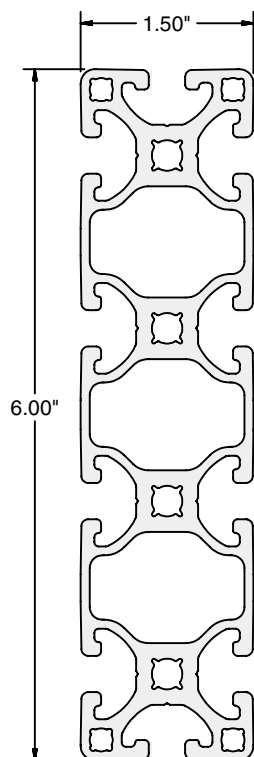

10-1560*

* No end cap available

Application

10-1560 is designed for heavy duty structures and is an ideal profile for structural support and post applications. 10-1560 is designed with a high inertial strength in the "Y" axis. This allows for very high structural integrity to create extra stable and rigid structures. T-slots on four sides allow for effortless mounting of accessories directly onto the structure without additional machining. Because of its multiple T-slots, it is also an ideal profile for a fixture table.

Technical Data

Aluminum, Clear Anodized (See Technical Data page 17 for full material and finish specification.)

Part #	I_x [cm ⁴]	I_y [cm ⁴]	W_x [cm ³]	W_y [cm ³]	Section [cm ²]	Weight [kg/m]
10-1560	27.97	420.89	14.68	55.24	18.33	6.98

Ordering Information

Description

Profile 1.5" x 6"

Cut to Length Service Number

Max. Length

6 meters

Part

10-1560

19-003

1" Series

Part #	Description	Moment of Inertia		Section Modulus		Section [cm ²]	Weight [kg/m]	Page
		I _x [cm ⁴]	I _y [cm ⁴]	W _x [cm ³]	W _y [cm ³]			
12-1010	Profile 1" x 1"	1.91	1.91	1.51	1.51	2.84	0.77	52
12-1020	Profile 1" x 2"	3.62	13.03	2.85	5.13	5.16	1.41	52
12-2020	Profile 2" x 2"	23.68	23.68	9.32	9.32	8.13	2.21	52

T - Slot Details

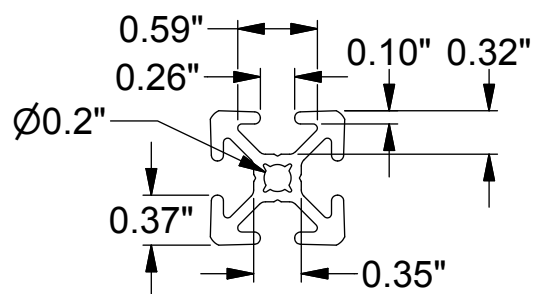

Fastening Methods

Universal Fastener

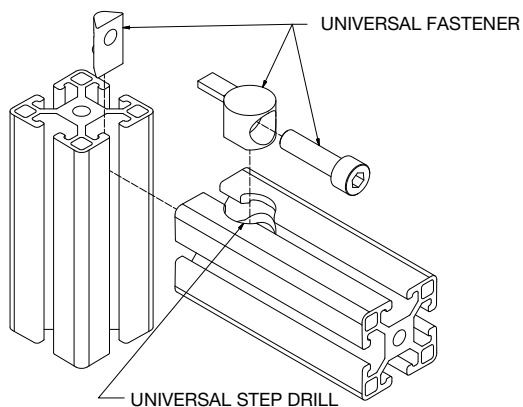

Standard Fastener

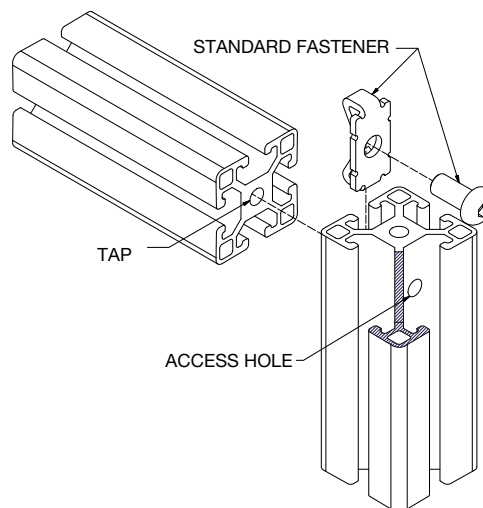

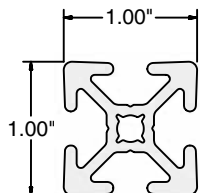

◆ 12-1010

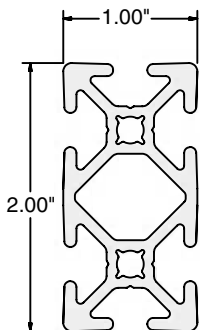

12-1020

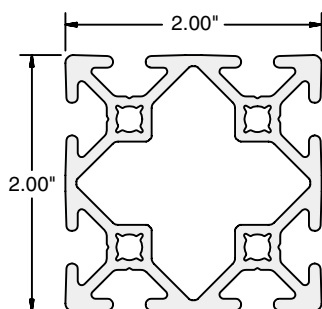

12-2020

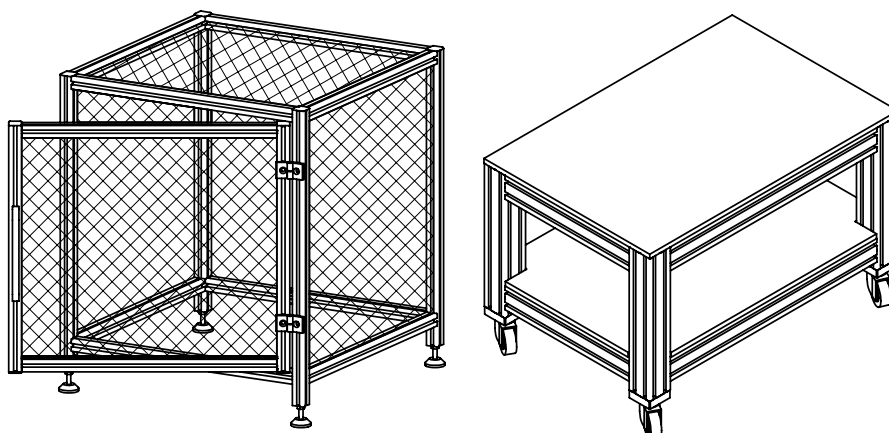

Application

1" Series profiles are designed for safety guards, enclosures, shelves, and other light to medium duty applications. T-Slots on four sides allows for effortless mounting of accessories directly onto the structure without additional machining. The T-slot is smaller than the 1.5" Series, requiring different hardware. With profile 12-1020, higher rigidity can be attained by orienting the extrusion on its "Y" axis. The 12-2020 profiles are ideal for support and post applications. With their higher rigidity, structures can be built with higher stability.

Technical Data

Aluminum, Clear Anodized (See Technical Data page 17 for full material and finish Specification)

Part #	I_x [cm ⁴]	I_y [cm ⁴]	W_x [cm ³]	W_y [cm ³]	Section [cm ²]	Weight [kg/m]
12-1010	1.91	1.91	1.51	1.51	2.84	0.77
12-1020	3.62	13.03	2.85	5.13	3.16	1.41
12-2020	23.68	23.68	9.32	9.32	8.13	2.21

Ordering Information

Description	Max. Length	Part #
Profile 1" x 1"	6 meters	12-1010
Profile 1" x 2"	6 meters	12-1020
Profile 2" x 2"	6 meters	12-2020
Cut to Length Service Number		19-001

End Caps	Part #
1" x 1"	18-1010
1" x 2"	18-1020
2" x 2"	18-2020

Profile & Accessories

Application

- 12-032 is used for sliding door applications. [See page 130].
- 12-022 is used with 12-032 for large sliding doors. Applications include case packers, material handling equipment, packaging installations, and access panels for large machine enclosures. [See page 131.]
- 14-248 designed for use with rail carts [23-200, 23-201, and 23-202], which can be used in applications such as moving materials on workstations. [See page 134.]

Technical Data

Aluminum, Clear Anodized [See Technical Data page 17 for full material and finish specifications]

Part #	Weight [kg/m]
12-032	0.67
12-022	1.78
14-248	4.19

Ordering Information

Description	Max. Length	Part #
Profile 18x32 Bi-Slot	6 meters	12-032
Profile Rolling Door Guide	3 meters	12-022
Profile 40x80 Rail Transport	6 meters	14-248
Cut to Length Service Number		19-001

End Cap	Part #
18" x 32"	18-807

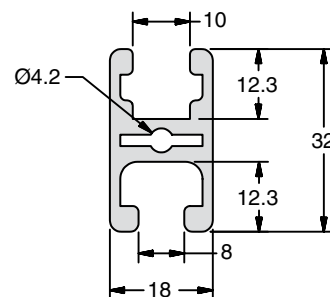

12-032

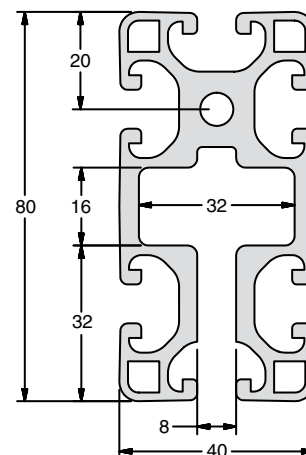

14-248

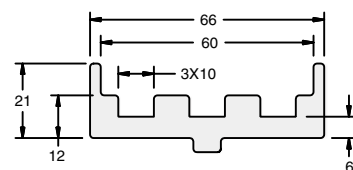

12-022