

**VTSLH65RBL / VTSLH92RBL**

DATE:



Available in two sizes, each with three different beam angles, achieved through refractive or hybrid optical units. The junction arm is integrated into the spotlight's body, ensuring the barrel stays aligned with the track and preventing any imbalance in suspended track versions. The junction also allows for 360° rotation, providing maximum flexibility. Additionally, the fixture includes an external dimming interface compatible with Triac, 0/1-10V, and Dali systems for versatile lighting control.

## PHOTOMETRICS

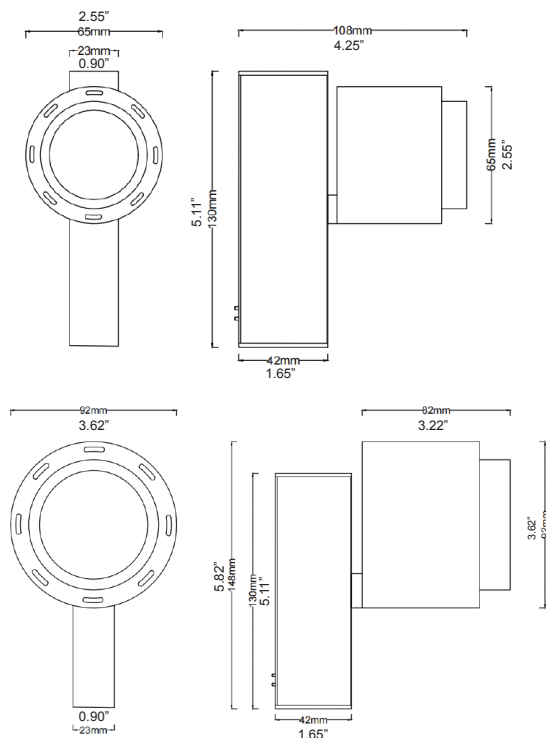

UNIT: °cd

- C0/180, 32.5°
- C30/210, 33.2°
- C60/240, 33.3°
- C90/270, 33.2°

AVERAGE BEAM ANGLE (50%): 33.0 DEG

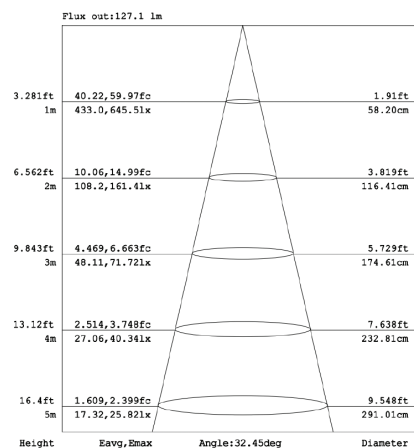

MODEL	SIZE	WATTAGE	CCT	LUMENS	CRI	BEAM ANGLE
VTSLH65RBL	65mm x 65m x 63mm (2.56" x 2.56" x 2.48")	8W	2700K/3000K/4000K	250Lm	>90	10/20/30D
VTSLH92RBL	92mm x 92m x 82mm (3.62" x 3.62" x 3.23")	15W	2700K/3000K/4000K	486Lm	>90	10/20/30D

\*Any custom modifications are subject to minimum order quantity. (M.O.Q.)

© VONN Lighting, 2024

**VONN, LLC.** reserves the right to make any design changes for continuous improvement which will not affect the overall appearance or performance.

