

STANDARD HALO HEAD WITH DOTS

VTSHD12BL

By VONN Lighting

VONN

PROJECT:

TYPE:

CATALOG#:

DATE:



DEMENSIONS

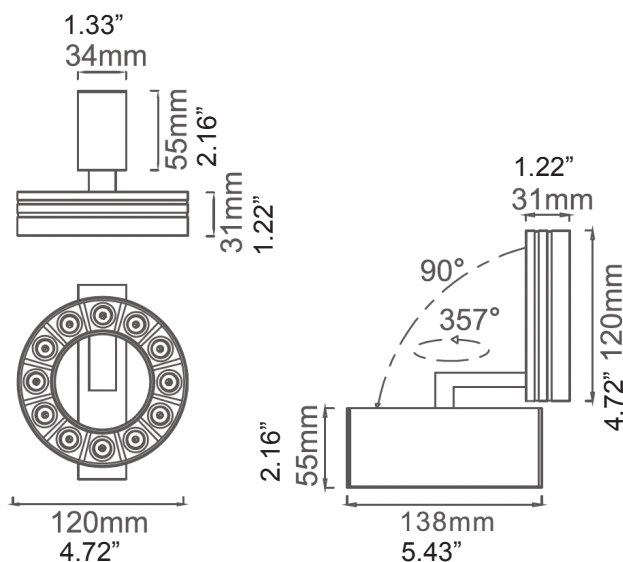

DESCRIPTION

The standard Halo head with dots embodies the concept of an invisible source of illumination, offering a soft and comforting glow without the harshness of glare. Its radiant light fills the space with warmth, gently caressing every corner, while remaining effortlessly discreet. Complemented by an anti-glare cover, this light creates a serene atmosphere that invites relaxation, and a touch of timeless elegance.

PHOTOMETRICS

20°

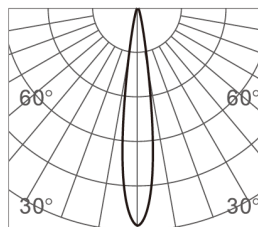

| h(m) | E(lx) | Φ(m) |
|------|-------|-------|
| 1 | 4033 | Φ0.42 |
| 2 | 1008 | Φ0.84 |
| 3 | 448 | Φ1.26 |
| 4 | 252 | Φ1.68 |
| 5 | 161 | Φ2.10 |

48°

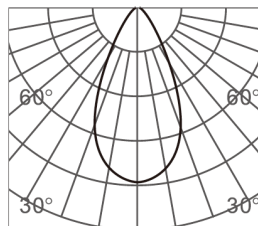

| h(m) | E(lx) | Φ(m) |
|------|-------|-------|
| 1 | 1404 | Φ0.85 |
| 2 | 351 | Φ1.70 |
| 3 | 156 | Φ2.55 |
| 4 | 87 | Φ3.41 |
| 5 | 56 | Φ4.26 |

34°

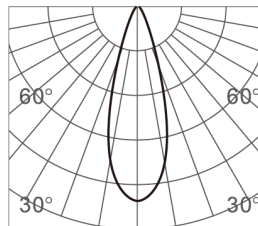

| h(m) | E(lx) | Φ(m) |
|------|-------|-------|
| 1 | 2787 | Φ0.57 |
| 2 | 696 | Φ1.15 |
| 3 | 309 | Φ1.72 |
| 4 | 174 | Φ2.30 |
| 5 | 111 | Φ2.88 |

SPECIFICATION

| MODEL | SIZE | WATTAGE | CCT | LUMENS | CRI | BEAM ANGLE |
|-----------|---|---------|-------------------|--------|-----|------------|
| VTSHD12BL | L: 120MM x W: 120MM x H: 120MM (L: 4.72" x W: 4.72" x H: 4.72") | 12W | 2700K/3000K/4000K | 950Lm | >90 | 20/34/48D |

Theoretical Lumens: XXX LM (subject to change)

Theoretical Wattage: XXX W (subject to change)

***Please note lumens and wattage are subject to change and will be determined post production of the first articles.

*Any custom modifications are subject to minimum order quantity. (M.O.Q.)

© VONN Lighting, 2024

VONN, LLC.

3323 NE 163rd St, PH-706
North Miami Beach, FL 33160

WWW.VONN.COM 888.604.8666

VONN, LLC. reserves the right to make any design changes for continuous improvement which will not affect the overall appearance or performance.

