

INSTALLATION GUIDE:

Up/Down Linear LED

White or Black

VUD22CCT



TOOLS YOU MAY NEED



GOGGLES



TAPE MEASURE



RUBBER GLOVES



PHILLIPS SCREW DRIVER



DRILL

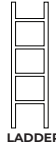

LADDER



FOR YOUR SAFETY, READ AND UNDERSTAND FOLLOW INSTRUCTIONS!
KEEP THE INSTRUCTIONS IN SAFE PLACE FOR FUTURE REFERENCE!

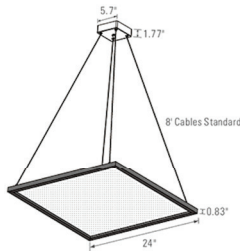

CIRCUIT BOX

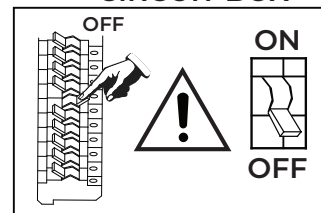

LED INFO & WARNINGS

Please read and understand the entire manual before attempting to assemble, operate, or install the product.	Make sure that you have all necessary parts by checking the parts list. If any part is missing or damaged please contact VONN LIGHTING CUSTOMER SERVICE at 888-604-8666 for a replacement.
All parts must be used as indicated in these instructions. Do not substitute any parts, leave parts out, or use any parts that are worn or broken.	Inspect the LED fixture prior to installation to make sure that it has not been damaged during shipping.
Please handle the LED light with care when unpacking. Do not apply pressure to the LED's, do not open any factory sealed compartments, and do not touch the LEDs with your hands.	VONN highly recommends to use a qualified, licensed electrician to install the fixture. 
VONN recommends to install the fixture on its own independent circuit. Do not install the fixture on the same circuit with the other appliances, or HVAC systems.	Do not remove or replace VONN manufactured parts that is provided with the fixture.
Place the wall switch in the "OFF" position of the room you are installing the fixture.	Shut "OFF" the electricity at main fuse box.

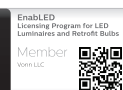

Instructions



RISK OF FIRE AND ELECTRICAL SHOCK. FIXTURE MUST BE INSTALLED BY A QUALIFIED ELECTRICIAN ONLY IN ACCORDANCE WITH NATIONAL, LOCAL BUILDING AND ELECTRICAL CODES. DISCONNECT POWER AT ELECTRICAL PANEL BEFORE SERVICING.

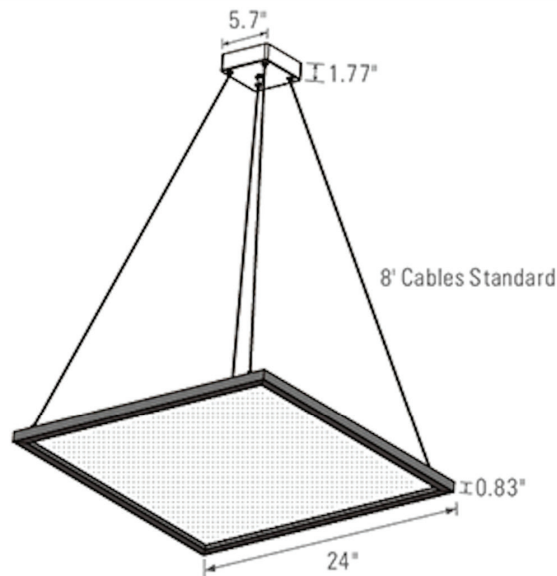

IMPORTANT

1. Read all instructions.
2. Install in accordance with national and local electrical code regulations.
3. This product is intended to be installed and serviced by a qualified, licensed electrician.
4. Do not install in wet locations. For dry and damp use only.
5. Turn off electrical power before installing or servicing fixture in any way.
6. To reduce the risk of fire and overheating, make sure all connections are tight.
7. Under no circumstances can the lighting fixture be covered with heat insulation gasket or similar materials.

ATTENTION

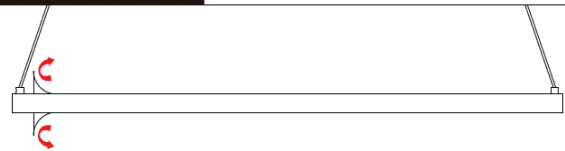

Leave the protective protective films on the fixtures until construction and furniture are complete.



SHOCK HAZARD!

May result in serious injury or death. Turn power OFF at circuit breaker prior to installation or servicing.

WIRING DIAGRAM

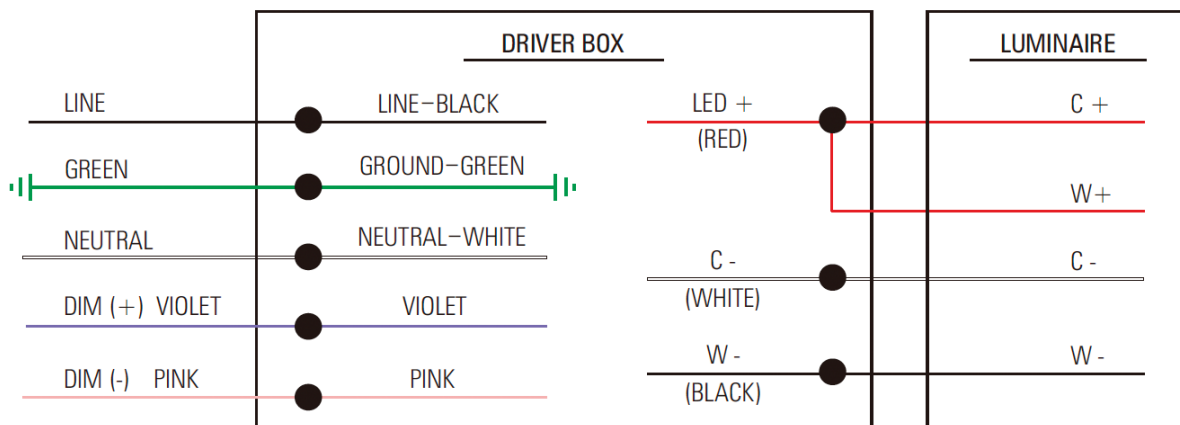

Instructions

VONN



RISK OF FIRE AND ELECTRICAL SHOCK. FIXTURE MUST BE INSTALLED BY A QUALIFIED ELECTRICIAN ONLY IN ACCORDANCE WITH NATIONAL, LOCAL BUILDING AND ELECTRICAL CODES. DISCONNECT POWER AT ELECTRICAL PANEL BEFORE SERVICING.

DRY CEILING

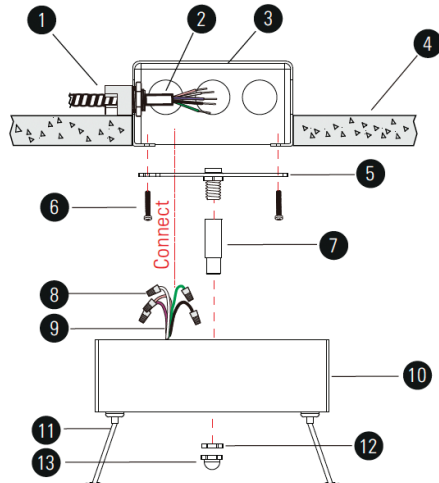

Connect DC wires correctly according to the label.

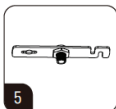

5 Junction Box Crossbar

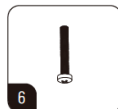

6 Screw PM4*22

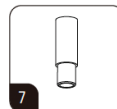

7 Cable Holder



8 Wire Nut

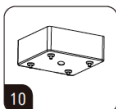

10 Driver Box



12 Hex Nut



13 Nut

PARTS LIST

- 1 Armored Cable & Connector (By Others)
- 2 AC Input (By Others)
- 3 J-Box (By Others)
- 4 Drywall Ceiling (By Others)
- 5 Junction Box Crossbar
- 6 Screw PM4*22
- 7 Cable Holder
- 8 Wire Nut
- 9 AC Input Of Driver
- 10 Driver Box
- 11 DC Input
- 12 Hex Nut
- 13 Nut

DROP CEILING - T-GRID CLIPS

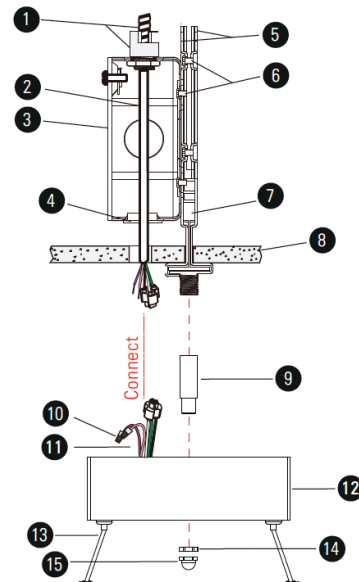

Connect DC wires correctly according to the label.

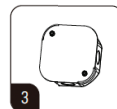

3 4" Octagon Junction Box

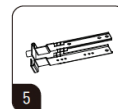

5 Assembled T-grid Clips

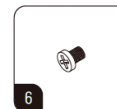

6 Screw 6#*4

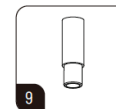

9 Cable Holder

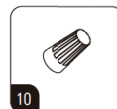

10 Wire Nut



12 Driver Box

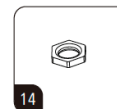

14 Hex Nut



15 Nut

PARTS LIST

- 1 Armored Cable & Connector (By Others)
- 2 Power Cord (By Others)
- 3 4" Octagon Junction Box
- 4 Plastic Grommet
- 5 Assembled T-grid Clips
- 6 Screw 6#*4
- 7 T- grid (By Others)
- 8 Ceiling Tile (By Others)
- 9 Cable Holder
- 10 Wire Nut
- 11 AC Input Of Driver
- 12 Driver Box
- 13 DC Input
- 14 Hex Nut
- 15 Nut