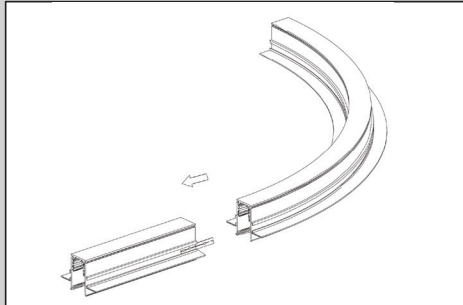


INSTALLATION GUIDE: LYRA MAGNETIC TRACK MAGNETIC TRACK LED LIGHT SYSTEM

SURFACE / RECESSED / PENDANT



TOOLS YOU MAY NEED



GOGGLES



TAPE MEASURE



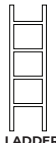
RUBBER
GLOVES



PHILLIPS
SCREW DRIVER



DRILL

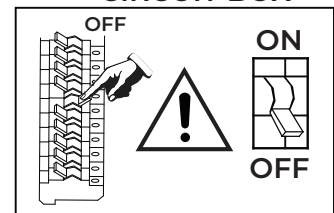


LADDER



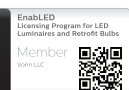
FOR YOUR SAFETY, READ AND UNDERSTAND FOLLOW INSTRUCTIONS!
KEEP THE INSTRUCTIONS IN SAFE PLACE FOR FUTURE REFERENCE!

CIRCUIT BOX



LED INFO & WARNINGS !

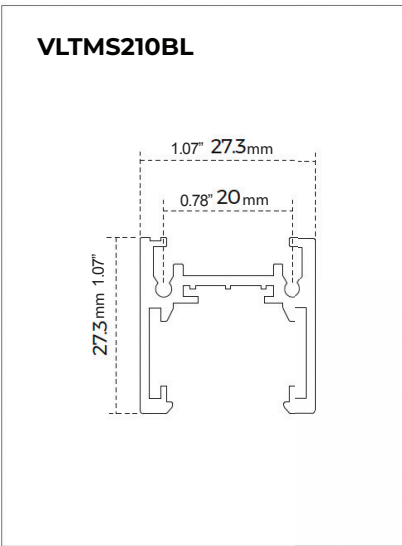
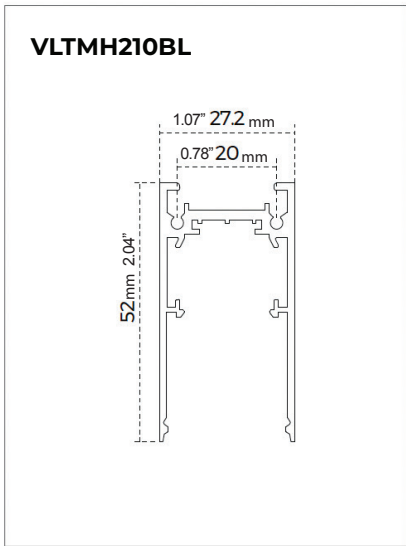
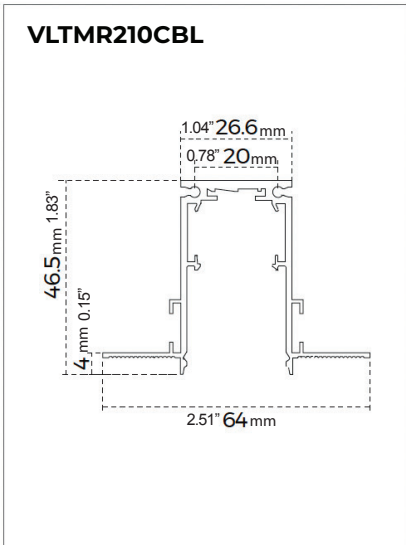
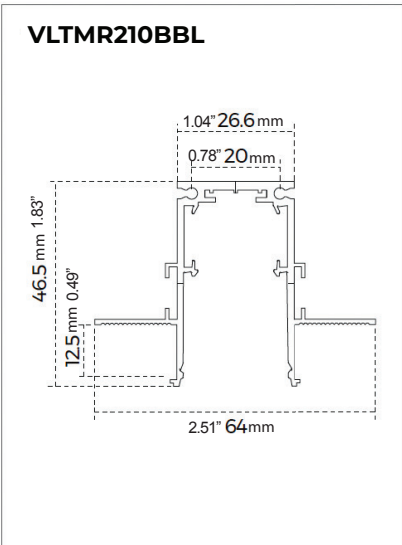
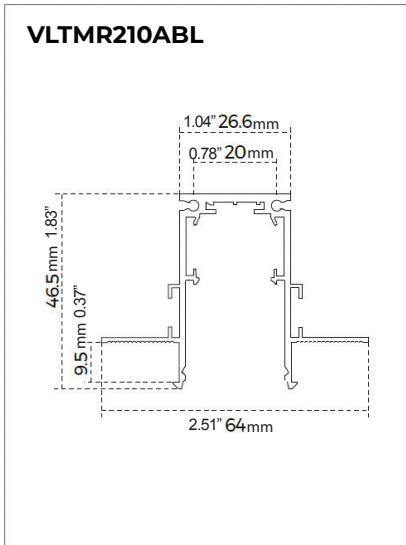
Please read and understand the entire manual before attempting to assemble, operate, or install the product.	Make sure that you have all necessary parts by checking the parts list. If any part is missing or damaged please contact VONN LIGHTING CUSTOMER SERVICE at 888-604-8666 for a replacement.
All parts must be used as indicated in these instructions. Do not substitute any parts, leave parts out, or use any parts that are worn or broken.	Inspect the LED fixture prior to installation to make sure that it has not been damaged during shipping.
Please handle the LED light with care when unpacking. Do not apply pressure to the LED's, do not open any factory sealed compartments, and do not touch the LEDs with your hands.	VONN highly recommends to use a qualified, licensed electrician to install the fixture. !
VONN recommends to install the fixture on its own independent circuit. Do not install the fixture on the same circuit with the other appliances, or HVAC systems.	Do not remove or replace VONN manufactured parts that is provided with the fixture.
Place the wall switch in the "OFF" position of the room you are installing the fixture.	Shut "OFF" the electricity at main fuse box.



Instructions



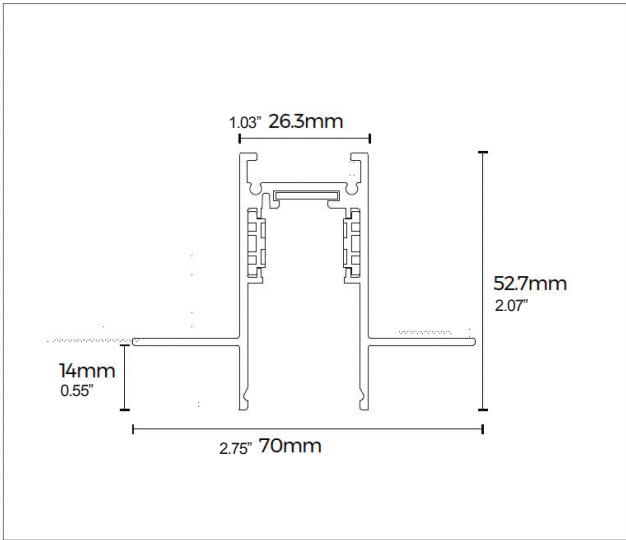
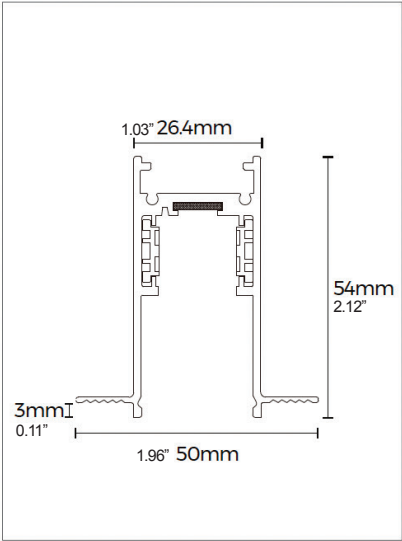
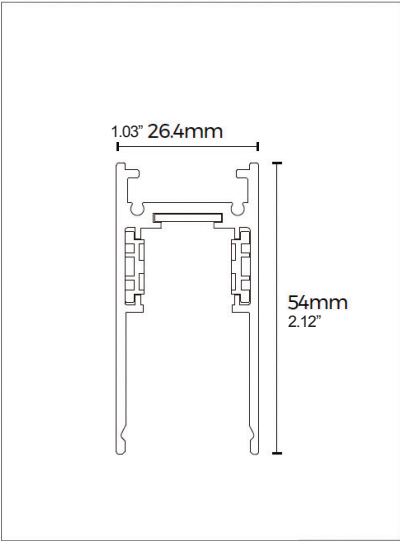
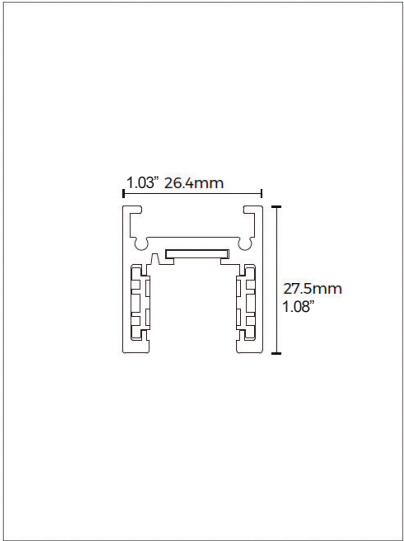
Product Structure



Instructions



Product Structure

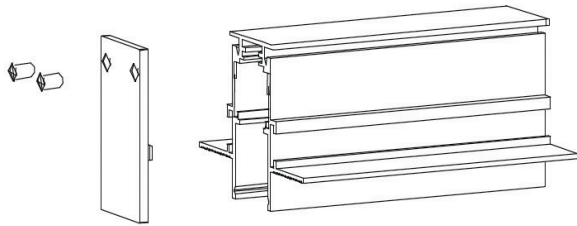


Instructions

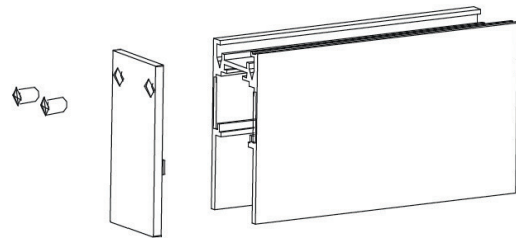


Diagram of end cap installation

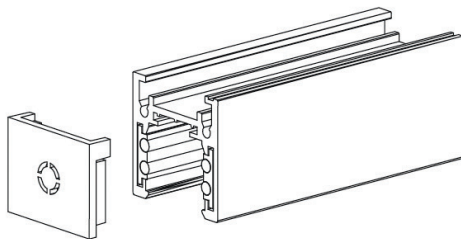
VLTMR210ABL
VLTMR210BBL
VLTMR210CBL



VLTMH210BL



VLTMS210BL



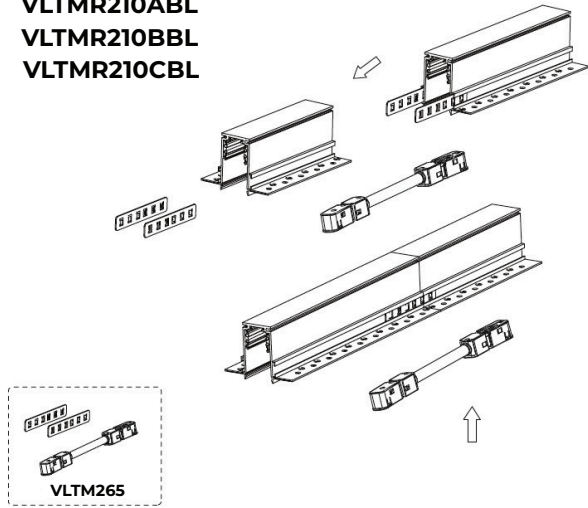
End cap is used in the first track and the last track of the route.
When installing end caps, use 2 screws to fix it tightly on the track.

Instructions

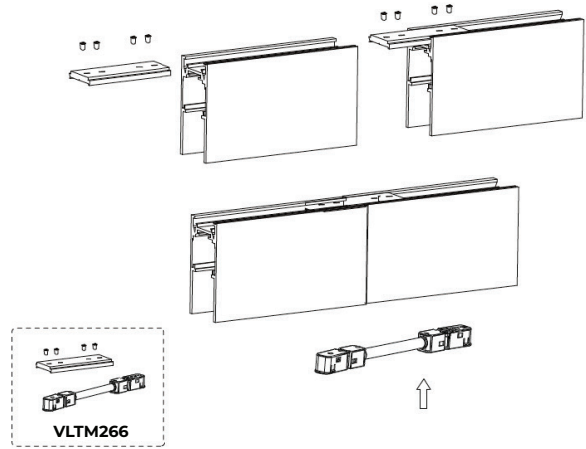


Diagram of track connection

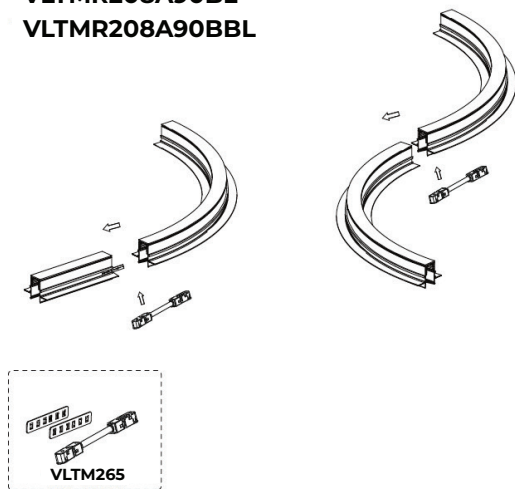
VLTMR210ABL
VLTMR210BBL
VLTMR210CBL



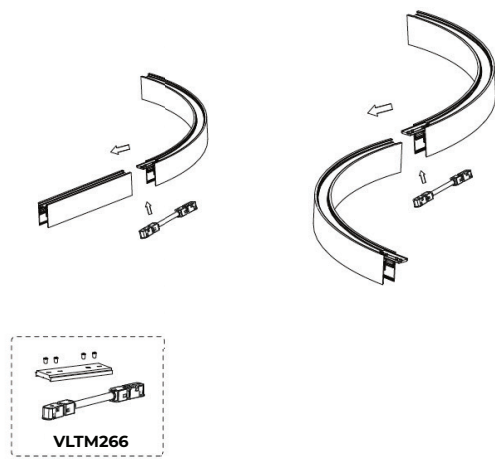
VLTMH210BL
VLTMS210BL



VLTMR208A90BL
VLTMR208A90BBL



VLTMH220BL



Straight connecting power box is used for power feeding between two tracks. Make sure to place power box into place.

Straight-curve power box is used for power feeding between straight track and curved track.

Make sure to place power box into place.

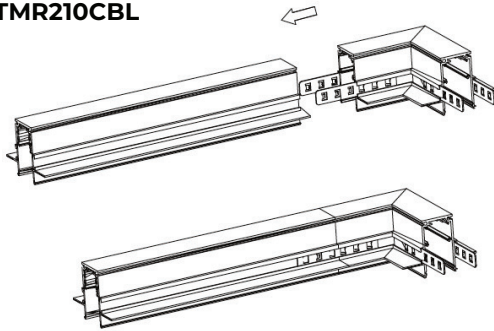
Instructions



Diagram of L-shaped connection

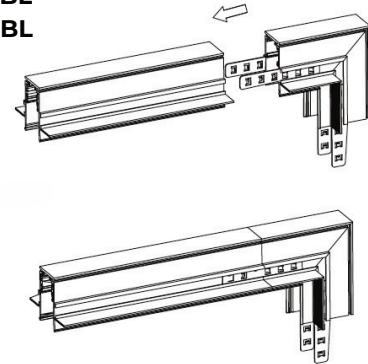
Outer 90° corner connection

VLTMR210ABL
VLTMR210BBL
VLTMR210CBL



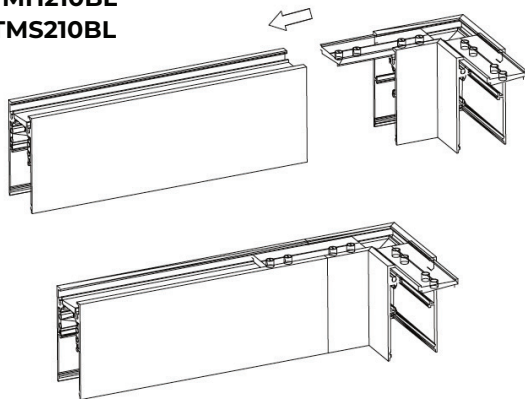
Inner 90° corner connection

VLTMR210ABL
VLTMR210BBL
VLTMR210CBL



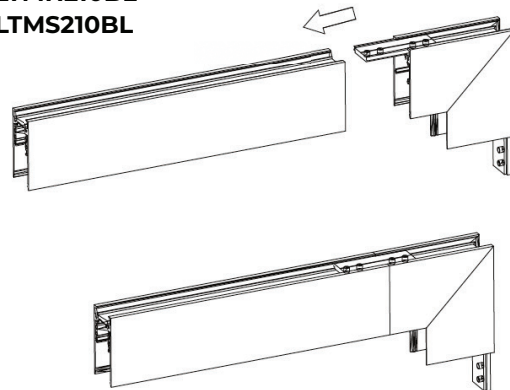
Outer 90° corner connection

VLTMH210BL
VLTMS210BL



Inner 90° corner connection

VLTMH210BL
VLTMS210BL



Installation method of 90° corner, 90° connecting power box, inner 90° corner and inner 90° connecting power box is suitable for all models of tracks.

Instructions



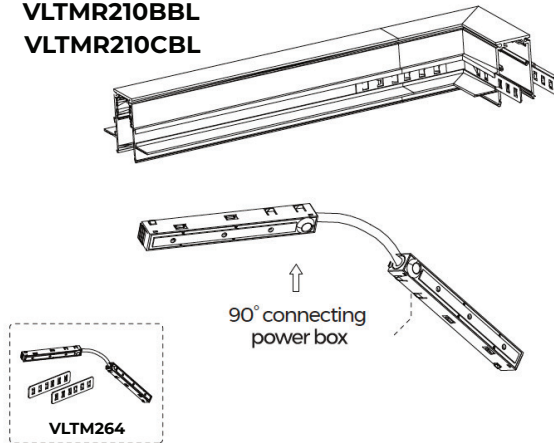
Diagram of power connection for L-shaped splicing

Power connection of outer 90° corner

VLTM210ABL

VLTM210BBL

VLTM210CBL

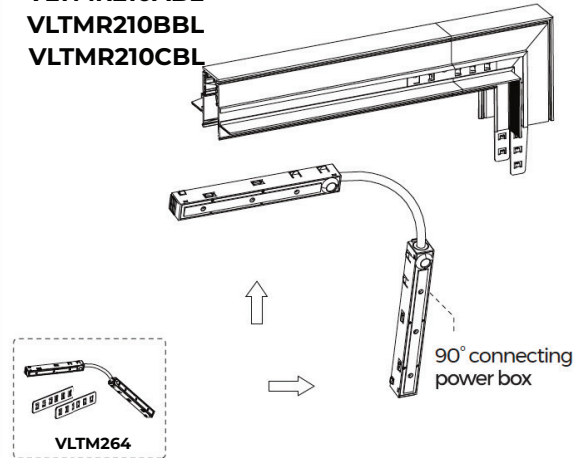


Inner 90° corner connection

VLTM210ABL

VLTM210BBL

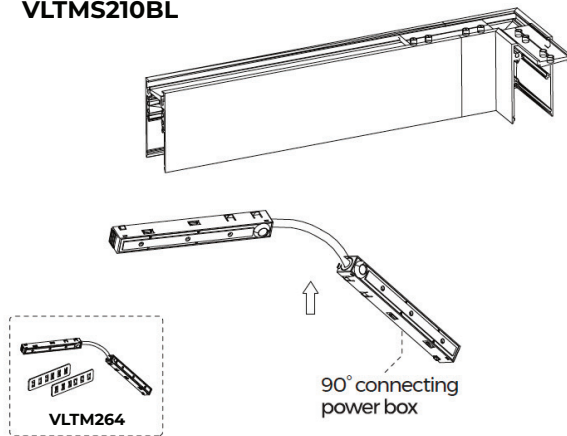
VLTM210CBL



Power connection of 90° corner

VLTMH210BL

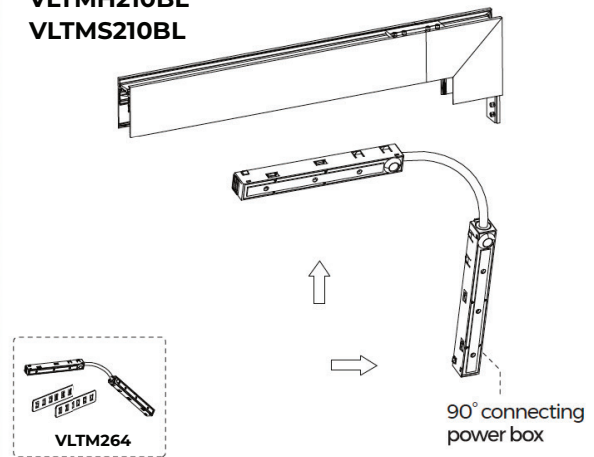
VLTMS210BL



Power connection of inner 90° corner

VLTMH210BL

VLTMS210BL



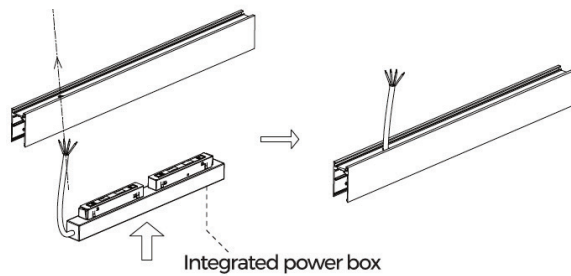
Installation method of 90° corner, 90° connecting power box, inner 90° corner and inner 90° connecting power box is suitable for all models of tracks.

Instructions

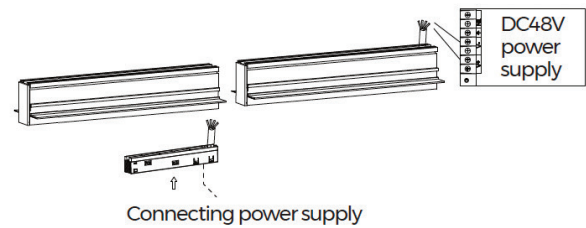


Installation of power supply

Integrated power supply

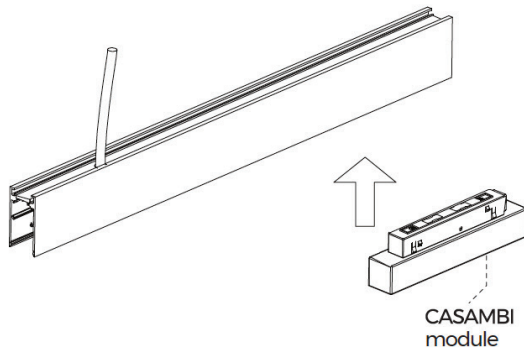


External power supply

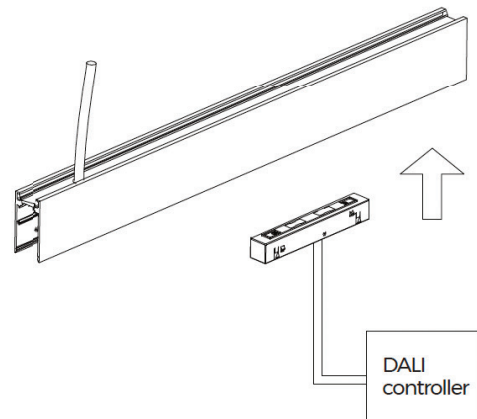


Installation diagram of dimming module

CASAMBI module (DALI luminaire)



DALI module (DALA luminaire)



* Built-in power modules can only match the modules provided by our company.

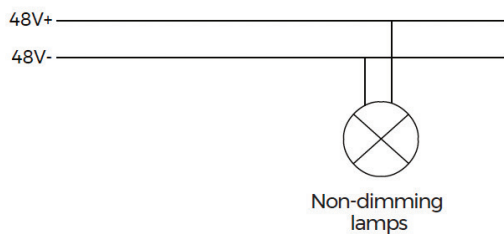
Instructions



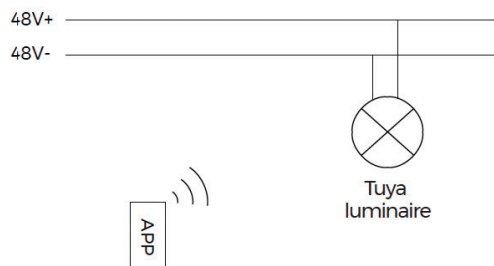
Diagram of power feeding

Wiring diagram

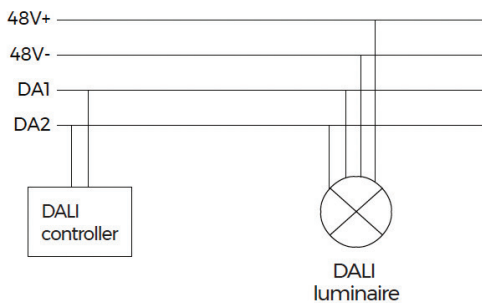
Wiring of non-dimming luminaire



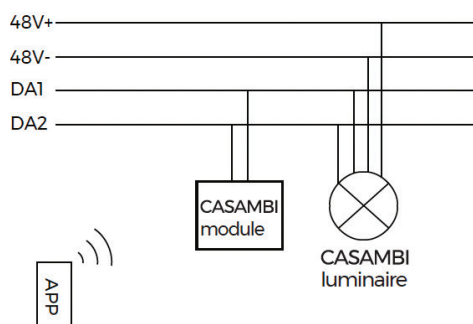
Wiring of bluetooth luminaire



Wiring of DALI luminaire



Wiring of CASAMBI luminaire



Instructions



Installation of track

Installation of recessed track

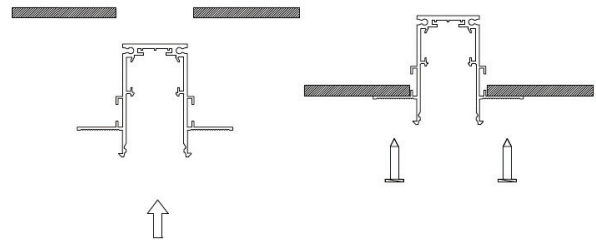
1



Opening size: width 40mm
height > 60mm

Open holes on load-bearing board as per requirement

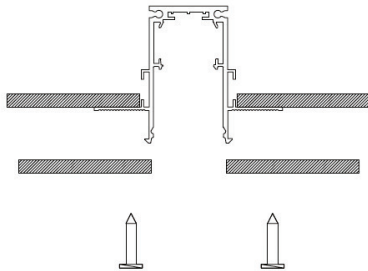
2



Use screws to fix track on load-bearing board

* note: prepare screws by installer in advance

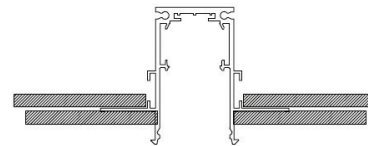
3



Cover the lower end with gypsum board
and fix with screws

* note: prepare screws by installer in advance

4



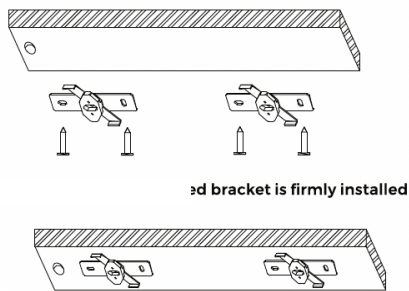
Plastering

Instructions



Installation of surface-mounted track

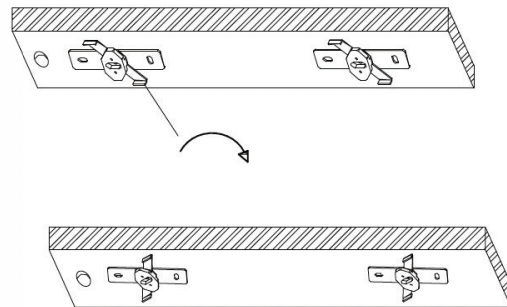
1



Each bracket is firmly installed

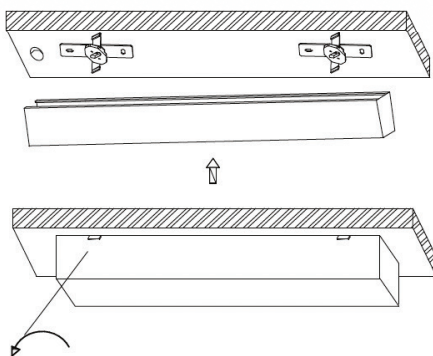
Reserve wire outlet as per requirement and fix surface-mounted bracket on ceiling as per this diagram

2



Rotate the bracket to its largest angle

3

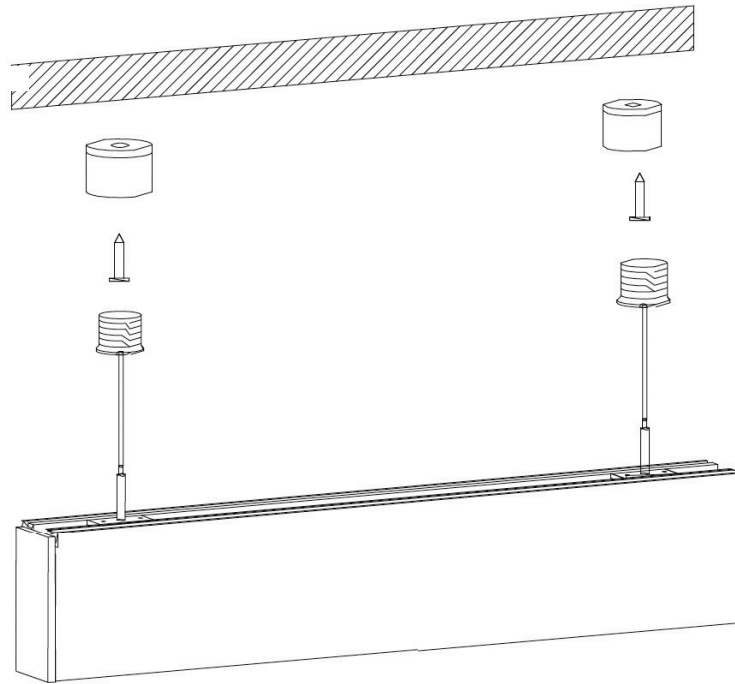


Click track into place and rotate the angle of the bracket to its minimum

Instructions



Installation of pendant track



Fix the screw head of the pendant kit onto the ceiling and fix the screw onto the head firmly.
Adjust the pendant cable to its suitable height and tighten the screws on both sides of the
pendant board.