

INSTALLATION GUIDE:
LED Hexagonal Light

Garage Lighting

VONN LIGHTING MODEL# VBY011

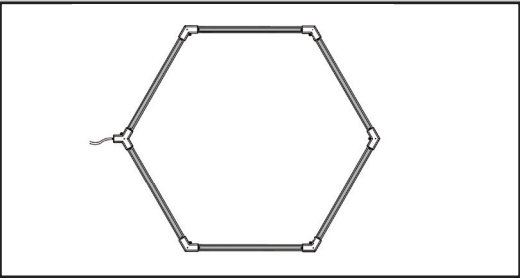

TOOLS YOU MAY NEED

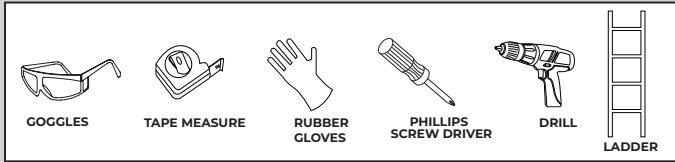

CIRCUIT BOX

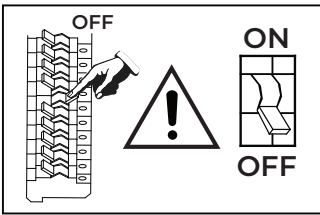

LED INFO & WARNINGS ⚠

Please read and understand the entire manual before attempting to assemble, operate, or install the product.	Make sure that you have all necessary parts by checking the parts list. If any part is missing or damaged please contact VONN LIGHTING CUSTOMER SERVICE at 888-604-8666 for a replacement.
All parts must be used as indicated in these instructions. Do not substitute any parts, leave parts out, or use any parts that are worn or broken.	Inspect the LED fixture prior to installation to make sure that it has not been damaged during shipping.
Please handle the LED light with care when unpacking. Do not apply pressure to the LED's, do not open any factory sealed compartments, and do not touch the LEDs with your hands.	VONN highly recommends to use a qualified, licensed electrician to install the fixture. ⚠
VONN recommends to install the fixture on its own independent circuit. Do not install the fixture on the same circuit with the other appliances, or HVAC systems.	Do not remove or replace VONN manufactured parts that is provided with the fixture. Do not remove or replace VONN manufactured driver that is provided with the fixture.
Place the wall switch in the "OFF" position of the room you are installing the fixture. Do not remove or replace VONN manufactured driver that is provided with the fixture.	Shut "OFF" the electricity at main fuse box.



Instructions



Important Safety Instructions

1. Fire or electric shock hazard: Please turn off the power before installation.
2. Always use the product within the safe working load range.
3. Designed for static positioning and suspension. Do not use for lifting or dynamic positioning.
4. Always use cables provided and specified by the manufacturer, and never use uncoated cables.
5. Please strictly follow the drawings before installation!
6. Please disconnect the power supply when installing or removing the fixture.
7. Please test the entire lamp after the lamp body is spliced to ensure that there is no problem with the overall lamp connection.

***Check the quantity of lamps and accessories after opening the package.**

Parts List

Model	VBY011	Luminous Flux	100-120LM/W
Voltage	230V	Color rendering index	>90
Luminous surface	22mm (0.86")	Color temperature	6500K
Power	591W		
Size	2386 (93.9") x 4750mm (187.")		

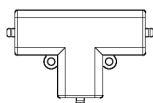

T type connector
x1

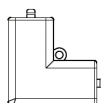

L type connector
x3

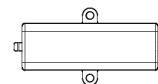

straight connector
x20

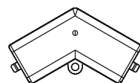

V type connector
x17

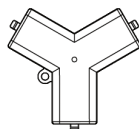

Y type Connector
x27



Power cord
x2



Tubes(size440*22mm) x57pcs
17.3" 0.86"



Nylon cable tie



Tubes(size565*22mm) x24pcs
22.2" 0.86"

Instructions



1. Connect the light tube with the splicing parts as shown in the figure below.

Length Unit: mm & in.

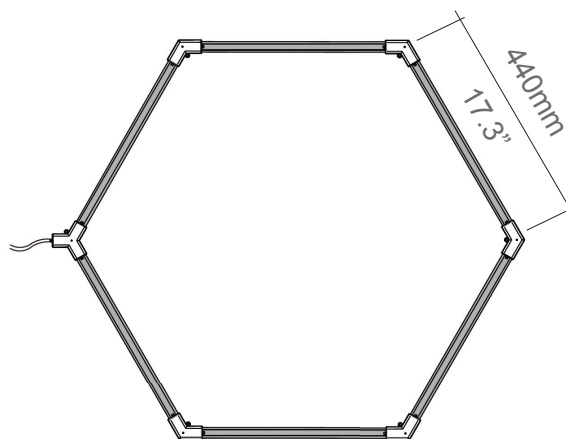
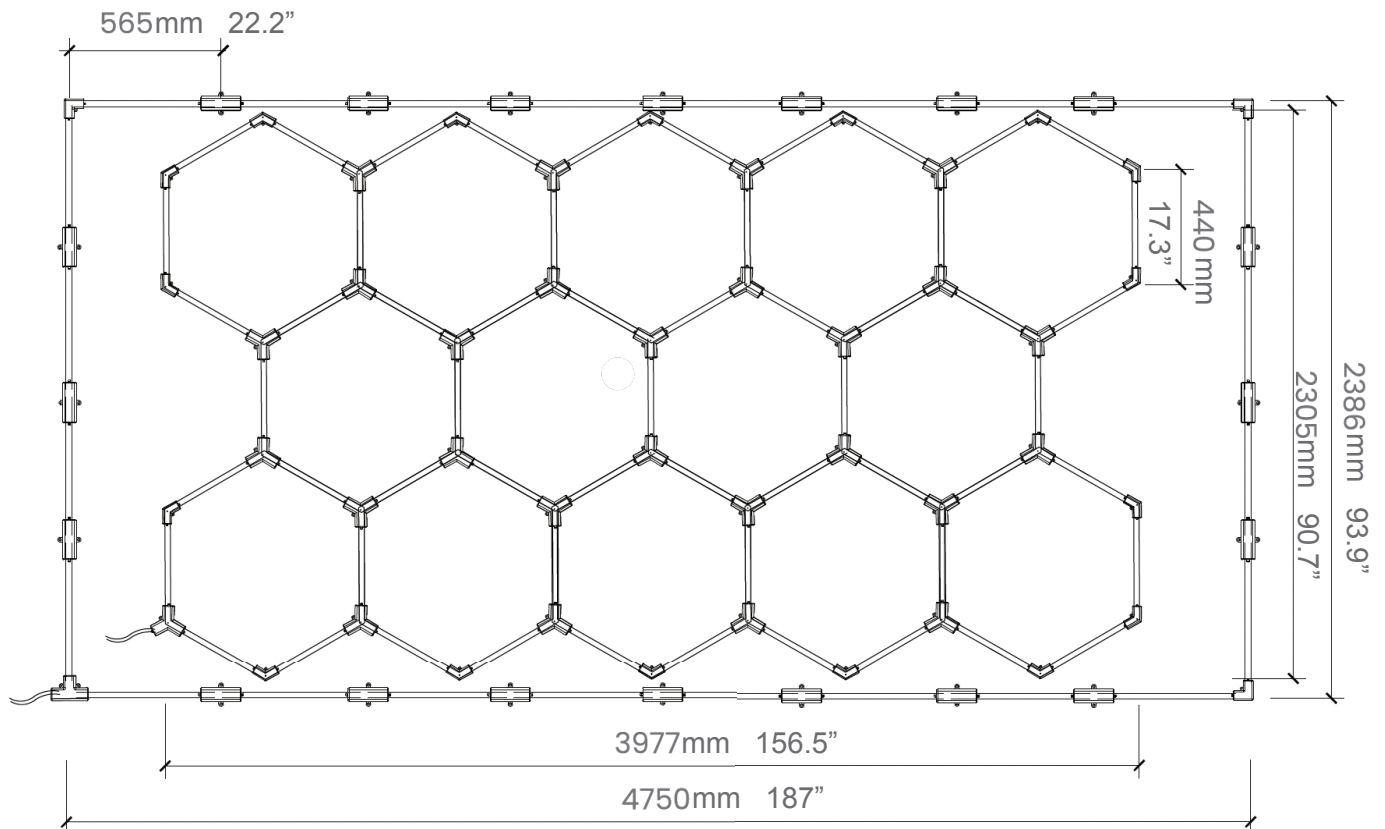

2. Check the splicing parts and the lamp connection to make sure they are not loose and then turn on the power to test light.

Instructions



3. After turning off the power, install the lamp as a whole to the designated position, make sure the joints are not loose and after the lamp body is fully fixed, turn on the power.

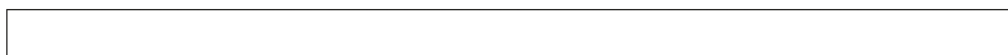
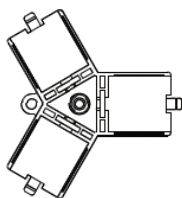

***Notice:** If you install it incorrectly, please do not pull the lamp and the connector hard. Hold the connector and shake the lamp slowly until it separates.

Circuit Box

