

<b>Main floor</b>	Total Exterior Area 2002 sq ft
	Total Interior Area 1825 sq ft

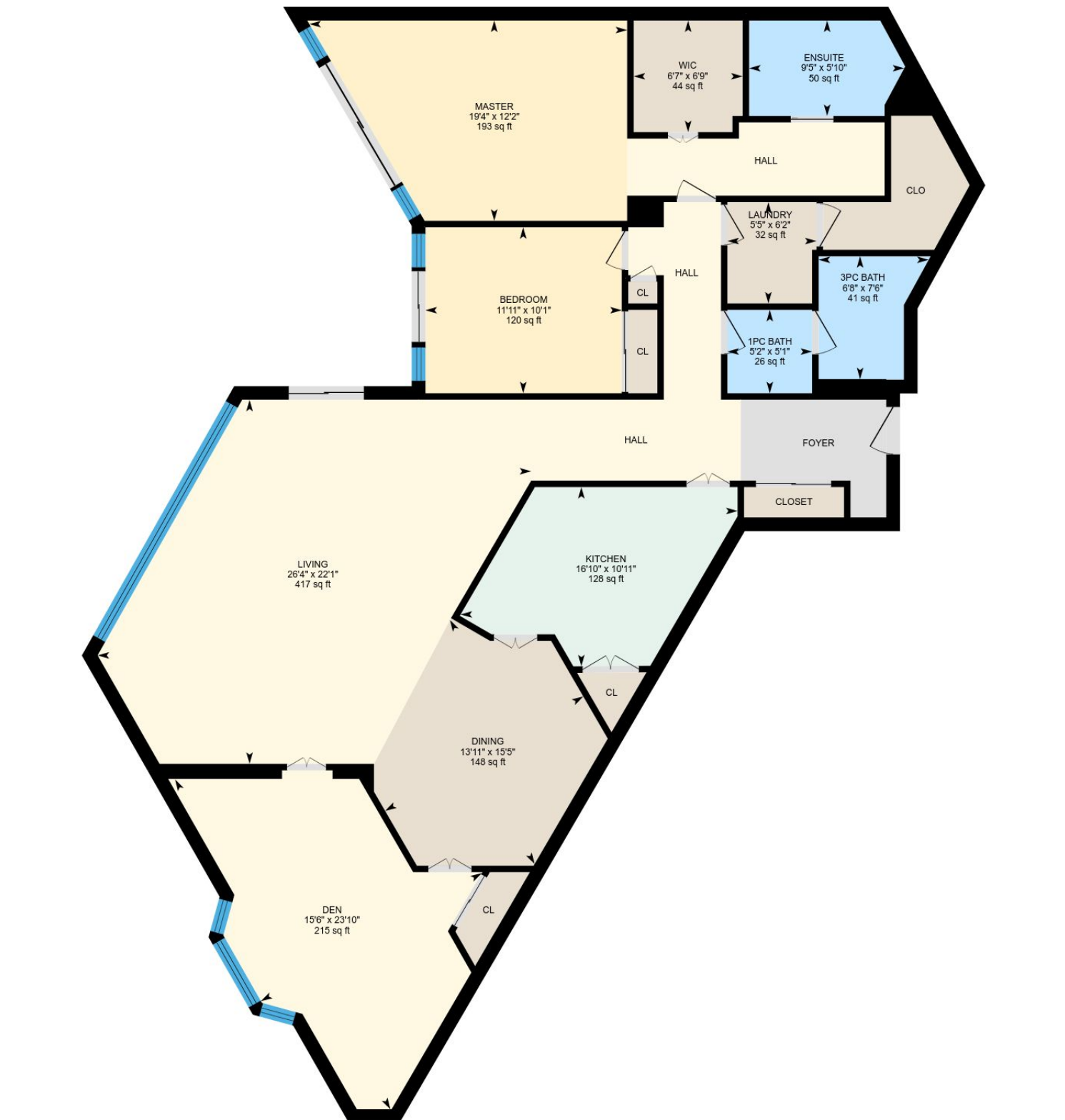

A horizontal scale bar with a black background and white markings. The markings are labeled '0', '4', and '8' in black text. The unit 'ft' is written in black text at the right end of the bar.

PREPARED: May, 2018

Colored regions are included in total floor area. All room dimensions and floor areas must be considered approximate and are subject to independent verification. For method of measurement please see <https://youriguide.com/measure/>.



## Property Details

### Room Measurements

Only major rooms are listed. Room dimensions are largest width and length, parts of room may be smaller.  
Room area is interior area and excludes footprint of walls.

### Main Building

#### MAIN FLOOR

Master: 19'4" x 12'2" | 193 sq ft  
Living: 26'4" x 22'1" | 417 sq ft  
Dining: 13'11" x 15'5" | 148 sq ft  
3pc Bath: 6'8" x 7'6" | 41 sq ft  
Laundry: 5'5" x 6'2" | 32 sq ft  
1pc Bath: 5'2" x 5'1" | 26 sq ft  
Den: 15'6" x 23'10" | 215 sq ft  
Kitchen: 16'10" x 10'11" | 128 sq ft  
Wic: 6'7" x 6'9" | 44 sq ft  
Bedroom: 11'11" x 10'1" | 120 sq ft  
Ensuite: 9'5" x 5'10" | 50 sq ft

### Floor Area Information

For explanation of floor area calculations and method of measurement please see <http://youriguide.com/measure/>

### Main Building

#### MAIN FLOOR

Interior Area: 1825 sq ft  
Perimeter Wall Length: 212 ft  
Perimeter Wall Thickness: 10 in  
Exterior Area: 2002 sq ft

### Total Above Grade Floor Area

Main Building Interior: 1825 sq ft

**Main Building Exterior: 2002 sq ft**