

332 Scriver Rd, Brighton, ON

Main Floor Total Exterior Area 141.7 m²
Total Interior Area 130.2 m²

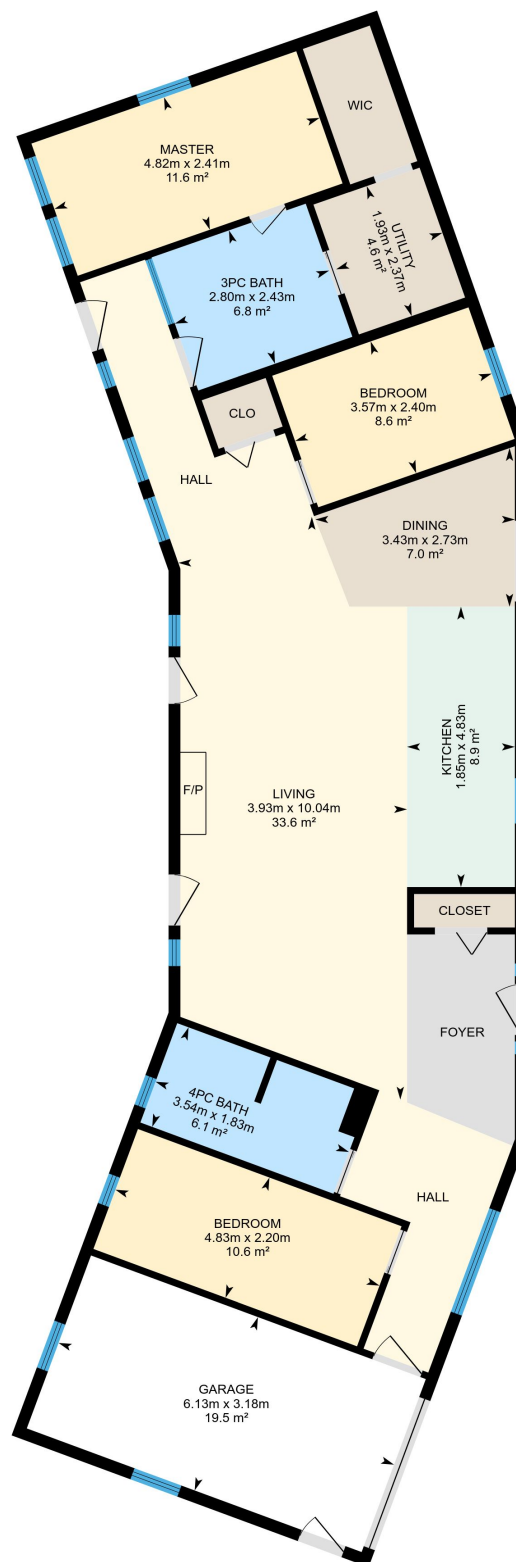

0 2 4 m

PREPARED: Oct, 2018

Property Details

Room Measurements

Only major rooms are listed. Some listed rooms may be excluded from total interior floor area (e.g. garage). Room dimensions are largest length and width; parts of room may be smaller. Room area is not always equal to product of length and width.

Main Building

MAIN FLOOR

Kitchen: 1.85m x 4.83m | 8.9 m²

Utility: 1.93m x 2.37m | 4.6 m²

3pc Bath: 2.80m x 2.43m | 6.8 m²

Master: 4.82m x 2.41m | 11.6 m²

Bedroom: 3.57m x 2.40m | 8.6 m²

Garage: 6.13m x 3.18m | 19.5 m²

Bedroom: 4.83m x 2.20m | 10.6 m²

4pc Bath: 3.54m x 1.83m | 6.1 m²

Living: 3.93m x 10.04m | 33.6 m²

Dining: 3.43m x 2.73m | 7.0 m²

Floor Area Information

For explanation of floor area calculations and method of measurement please see <http://youriguide.com/measure/>

Main Building

Building Perimeter Wall Thickness: 20 cm

MAIN FLOOR

Interior Area: 130.2 m²

Perimeter Wall Length: 56.6 m

Exterior Area: 141.7 m²

Total Above Grade Floor Area

Main Building Interior: 130.2 m²

Main Building Exterior: 141.7 m²