

## Heartland Jubilee “Build” Itinerary

### Friday, August 30

	<u>Location*</u>
5:00pm.....	Check-In/Registration opens ..... Sheraton Lobby (near escalators)
7:30-9:00PM .....	Youth & Family Devotional (6 <sup>th</sup> -12 <sup>th</sup> grade youths & parents) ..... Leatherwood 1
	TENTATIVE Young Married/Young Professionals Event..... Leatherwood 2
	Singles Event..... Leatherwood 3
	Campus Event..... Burge Union (off-site)
	1605 Irving Hill Rd, Lawrence, KS 66045

### Saturday, August 31

8:00-10:15am .....	Check-In/Registration.....	Sheraton Lobby (near escalators)
8:30am-9:30am .....	Family Prayer Time (families, parents, & children of all ages).....	Leatherwood 1
9:00am-2:00pm .....	<b>Blood Drive (<a href="#">click here to schedule an appointment</a>).....</b>	<b>Leatherwood 2</b>
10:00am-12:00pm .....	Main Session “A City Built On A Hill” (Kevin Hoecke) .....	Cottonwood
12:00-2:00pm .....	Break/Lunch**	
	Check-In/Registration re-opens	
2:00-2:45pm .....	First Breakout Session ( <a href="#">childcare information below</a> )	
	“Build Each Other Up” (Janus & Melissa Abello) .....	Leatherwood 3
	<i>This session will look at how deepening our one-another relationships will help us to have an even greater impact in our cities!</i>	
	“Unless The Lord Builds The House” (Mark & Jodi Hayward).....	Cottonwood 1 (Upper Level)
	<i>We will be looking at the importance of passing faith on to the next generation in our churches!</i>	
	“Build Your House On The Rock” (Bill & Kristin Moulden).....	Cottonwood 2 (Upper Level)
	<i>This class will look at the vital importance of building our life on biblical convictions!</i>	
	“Gifts That Build Up The Church” (Tim & Wendy Sherrill // Tim & Crystal Schmidt) .....	Cottonwood 3 (Upper Level)
	<i>Join us as we look at God’s plan of using our talents and abilities to advance His kingdom!</i>	
2:45-3:15pm .....	Break	
3:15-4:00pm .....	Second Breakout Session ( <a href="#">childcare information below</a> )	
	“Build Each Other Up” (Janus & Melissa Abello) .....	Leatherwood 3
	“Unless The Lord Builds The House” (Mark & Jodi Hayward).....	Cottonwood 1 (Upper Level)
	“Build Your House On The Rock” (Bill & Kristin Moulden).....	Cottonwood 2 (Upper Level)
	“Gifts That Build Up The Church” (Tim & Wendy Sherrill // Tim & Crystal Schmidt) .....	Cottonwood 3 (Upper Level)
4:00-6:30pm .....	Break/Dinner**	
6:30-10:30pm .....	Recreation Fun Night (all ages: see our Hospitality Info Sheet for more info) .....	Lenexa Rec Center (off-site)
		17201 W 87 <sup>th</sup> St Pkwy, Lenexa, KS 66219

### Sunday, September 1

10am-12pm .....	Worship Service “We Will Build” (Vince Hawkins) ( <a href="#">childcare information below</a> ) .....	Cottonwood (Upper Level)
1:30-6:00pm .....	Urban Hike (optional after-Jubilee event: see our Hospitality Info Sheet for more info) .....	Jack Stack BBQ (Plaza Location)

**CHILDCARE: Available Saturday 1:40pm-4:00pm & Sunday 9:40am-12:00pm – [open to children ages 6 months - 5<sup>th</sup> grade](#)**

**6 months - 3 years: check-in at Hawthorne 1/Linden (lower level-see [Hotel Map page](#))**

**4 years - 5<sup>th</sup> grade: check-in by age at lower level check-in desk (see [Hotel Map page](#))**

-children 4 years-5<sup>th</sup> grade will participate in VBS which includes Bible adventure, crafts, snacks, and lots of fun!

\*The Cottonwood Rooms are located on the hotel main (lobby) level; all other rooms are located on the lower level

\*\*Please be sure to make your own arrangements for lunch and dinner on Saturday; see our Hospitality Info Sheet for information on local restaurants & deals

**MAIN (LOBBY) LEVEL**

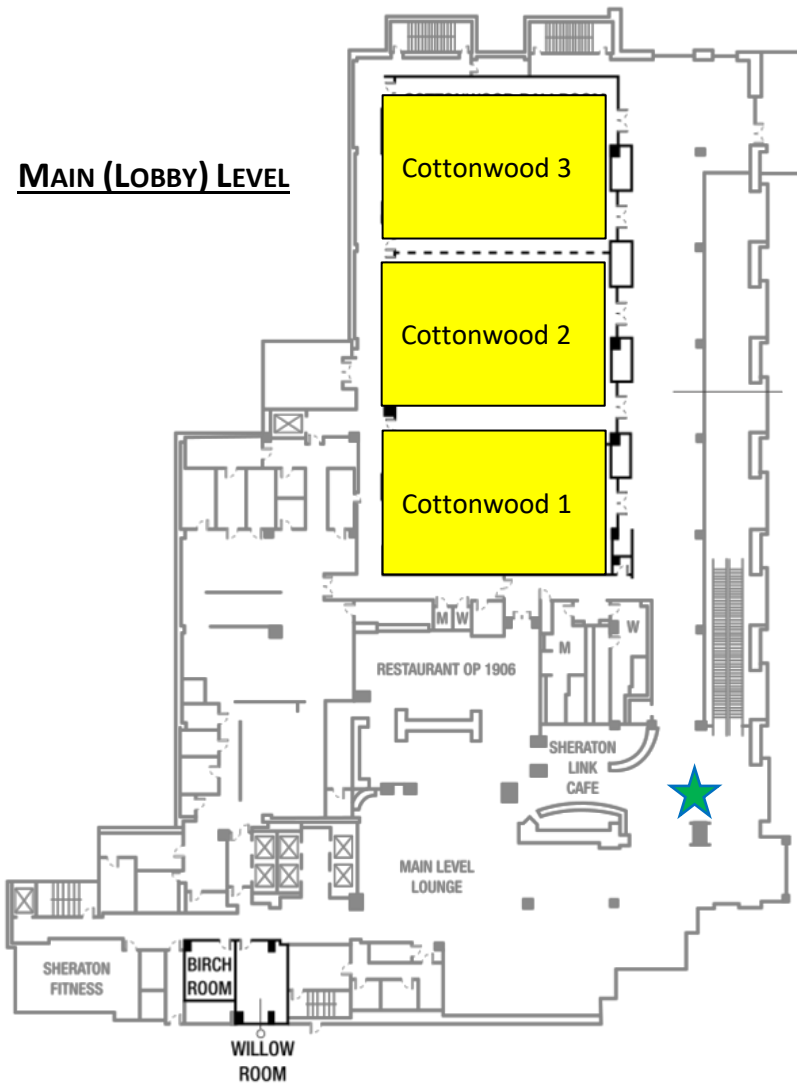

**SHERATON OVERLAND PARK HOTEL  
AT THE CONVENTION CENTER**

- Main Session & Breakout Rooms
- YFM & Childcare Rooms
- ★ Registration/Check-in (6<sup>th</sup> grade - Adult)
- ★ Check-in (4 years - 5<sup>th</sup> grade)
- ★ Check-in (6 months - 3 years)

**LOWER LEVEL**

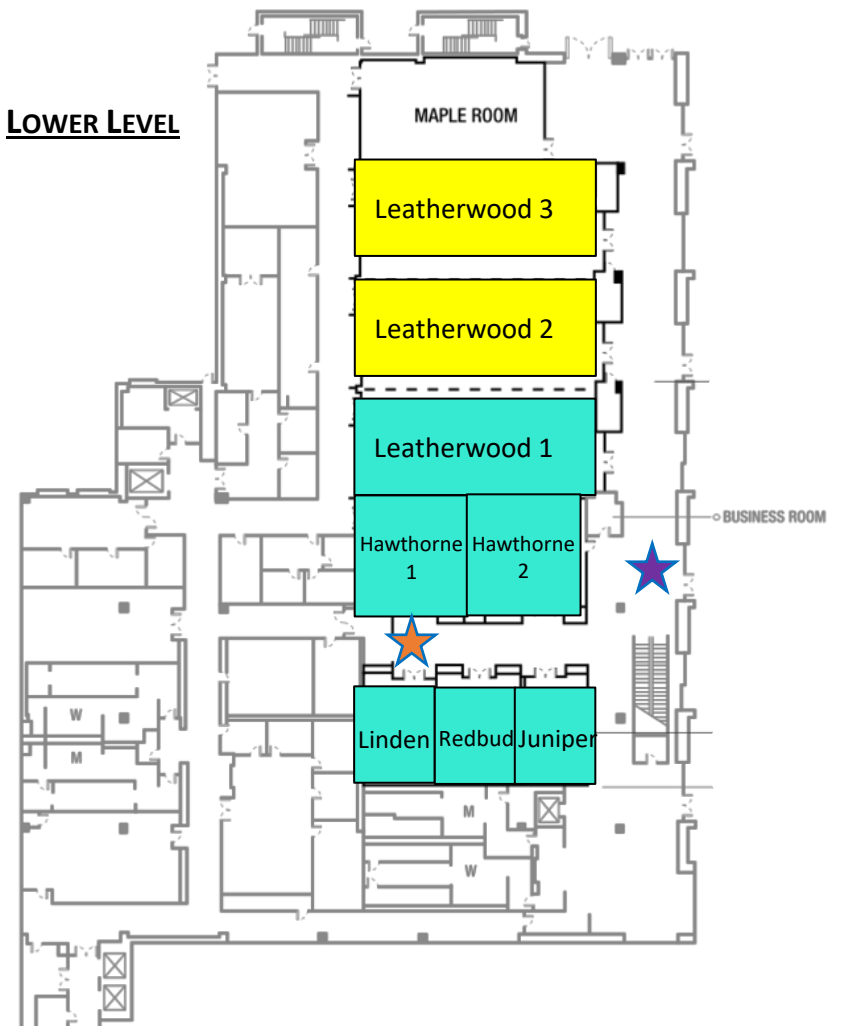

# Heartland Jubilee Hospitality Info Sheet

## **SHERATON HOTEL (6100 College Blvd, Overland Park, KS 6621)**

-Free Public/Self-Parking in the South Lot of the hotel (past the front entrance/follow the signs).

-The side door (off the parking lot) is unlocked during business hours. Take the elevator or stairs to the main/lobby level.

**-You will be asked to sign a consent form from the KC Church at the Event Registration table**

## **LOCAL DINING **!!discounts on Saturday if you show your Heartland Jubilee lanyard!!****

- **RA Sushi Bar** (11638 Ash St, Leawood, KS 66211)—Receive 15% off your meal
- **SPIN! Pizza** (6541 W 119th St, Overland Park, KS 66209)—Receive 10% off your meal
- **Burnt End BBQ** (11831 Metcalf Ave, Overland Park, KS 66210) —Receive 10% off your meal
- **Smashburger** (6551 W 119th St, Overland Park, KS 66209)— Receive 10% off your meal
- **Grand Street Cafe\*** (8815 Renner Blvd, Lenexa, KS 66219)—Receive 15% off your meal (\*near Lenexa Rec Center)



## **RECREATION FUN NIGHT @ LENEXA REC CENTER**

Who: All adults, youth & children

When: Saturday, August 31 at 6:30pm-10:30pm

Where: 17201 W 87th St Pkwy., Lenexa KS 66219

Dining: Public Market has local eating options with plenty of dining space. [Dining Options](#)

**REMEMBER to bring active wear and/or swim wear! You will be asked to sign a consent form when you arrive at the Rec Center**

Activities\* for all ages include:

- \*\* Open Swim ([FAQ](#))
- Water basketball & Water Volleyball
- Lobby area: Games & Fellowship
- 2 Inflatable Bounce House for Kids (6:30-8:30pm)
- Gagaball Pit (6:30-8:30pm)
- Pickleball (6:30-8:30pm)
- Volleyball/Speedball (8:30-10:30pm)
- Soccer (8:30-10:30pm)
- Basketball
- Ping Pong
- Wii Game Room

\*Activities are free of charge and are available from 6:30-10:30pm unless noted above; parental supervision is required at all times.

\*\*To promote a family atmosphere & protect one another we encourage girls to wear one-piece swimsuit and boys wear t-shirts.



## **URBAN BBQ HIKE**

Sunday, September 1<sup>st</sup> (AFTER the conclusion of the Jubilee)

Lunch at Jack Stack 1:30-2:45 PM (4747 Wyandotte St, Kansas City, MO 64112)

Hike starts at 2:45 PM and ends at 6:00 PM

Cost: \$15 per person—Difficulty: Moderate—[Click here to book the hike](#)

We start this 5-mile adventure with lunch at the famous Jack Stack BBQ. Following lunch, we'll experience Union Station and then trek up the hill to Liberty Memorial to see what we'll cover. We'll experience the Crossroads Art District and move into the architecturally and culturally diverse neighborhood of the Westside and glimpse the confluence of the Kansas and Missouri Rivers. While we enter a couple of historical buildings, we are mostly outside. We observe intricately painted murals and street art. We walk atop bridges and below underpasses, experience nature and rich historical buildings of downtown. You'll get a work out and see a new side of Kansas City.

*\*The cost of lunch is not included. This hike is over 10,000 steps and requires physical stamina and is not recommended for anyone with heart problems.*