

- ✓ We supply projector final products
- ✓ We welcome customers' brands
- ✓ We supply optical engines
- ✓ We provide ID design, mold development, and production services

2019

PROJECTORS & ACCESSORIES



- DLP / LCoS
- regular / Android / EZcast
- Interactive White Board
- pico / mini / portable / ceiling mount
- WiFi / non-WiFi
- regular throw / short throw / ultra-short throw
- LED / bulb
- 2D / 3D



Ultmost Technology Group - China Operation

World Electronic(Shenzhen)Co.,Ltd.
 Add.: No.160, Longping West Rd, Longgang District, Shenzhen City, Guangdong, China (Zip Code: 518172)
 Sales Direct Lines: 86-755-84880719 (tel.) / 86-755-84880780 (tel.) / 86-755-84820817 (fax)
 E-mail: ut@ultmost.com.cn
<http://www.fussdigital.com> (for IT & Digital Entertainment) <http://www.ultmost.com> (for Small Gadgets)

Ultmost Technology Corp.

4F, No. 52, Ming Chuang Rd., Hsintien, Taipei, Taiwan, R.O.C.
 Tel: 886-2-29179901 (Rep.) Fax: 886-2-29177603 (Rep.)



We innovate to enrich your life.

All products included in this copy are original designs of Ultmost Tech. and well protected by patents.
 Specifications subject to change without notice.

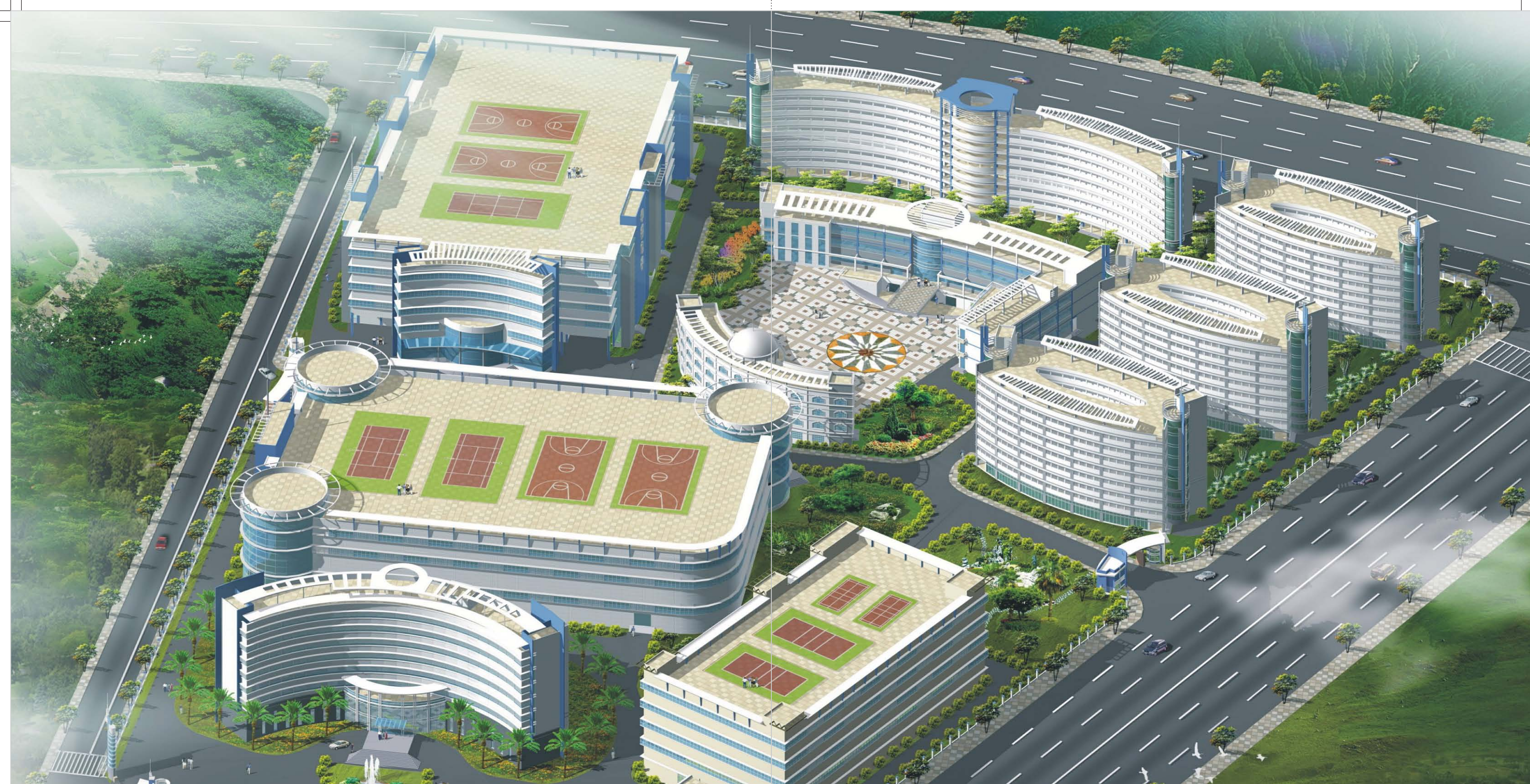

Aerial View of Shenzhen Factory

About us :

- Established in 1987
 - Head quarter based in Taiwan
 - Manufacturing in China
- Ultmost is a typical vertical integrated manufacturing entity. It engages all production works including R&D, Engineering, Plastic/Metal Molding, Plastic Injection, Pressing/Punching, Wire Bonding, SMT, Optical(such as glass cutting/grinding/polishing, and coating for PBS production), Printing, Spray Painting, and Assembly in its own plant.

- Expertise: consumer electronic products design / production
- Product range: Optical Engine, CasTV (ultra-short throw smart TV projector), Multimedia Pico/Mini LED Projectors, Full HD Home Theater Projectors, Interactive White-board Short Throw projectors & TV, and assorted speech-featured Electronic Gadgets.

Pico / Mini LED Projectors

- Portable & light weight
- LED light source - mercury free (green to environment), low power consumption, 20,000 hours long life (no after cost for bulb changing)
- Instant on/off - no need to warm-up & cool-down
- Can project on any light color surfaces such as white walls, ceilings, white paper/cloth, camping tent, frosted glass, curtain...etc
- Comes with universal voltage adapter & rechargeable battery
- Big screen projection
- Bountiful connectivity: Micro SD/TF card, USB stick, CVBS(RCA), HDMI, VGA, LAN, Wi-Fi
- Some models built with Android OS & Wi-Fi for internet access, also supports wireless casting programs such as EZCast, Miracast allowing mirroring for mobile devices
- Compatible to all kinds of casting devices including Chromecast dongle, Apple TV box, Miracast TV dongle, Intel Compute Stick allowing easy access to YouTube, Netflix, and online movies...



When selecting a projector, consider both the brightness of White as well as the brightness of Color.



Projector Buyers Guide to Color Brightness by Model

Projector buyers should proceed with caution.

Derived when presentations consisted of a black font on a white background, the old lumens metric only measures white light. Lumens, or brightness, tells the projector buyer little about the brightness of colors in photos, videos or graphics.

Fortunately, a newer metric gives projector buyers a measurement for the brightness of colors. Color Light Output, or more simply Color Brightness, quantifies the brightness of Red, Green and Blue; the primary colors of light.

The photograph below shows two projectors setup side-by-side, set in their brightest mode. Both offer similar resolution, price and white brightness levels.

The projector on the left exhibits low Color Brightness; only a fraction of its white brightness. The one on the right shows equal amounts of Color and White Brightness. Colors on the right are much brighter, providing more impact.

This document starts with a listing of projectors where the manufacturer specifies both White and Color Brightness. Second is a table containing projectors measured for their Color Brightness level by a 3rd party laboratory because the manufacturer did not specify the color brightness.

Insist on brighter colors. When selecting a projector, consider both the brightness of White as well as the brightness of Color.

Low Color Brightness¹

High Color Brightness

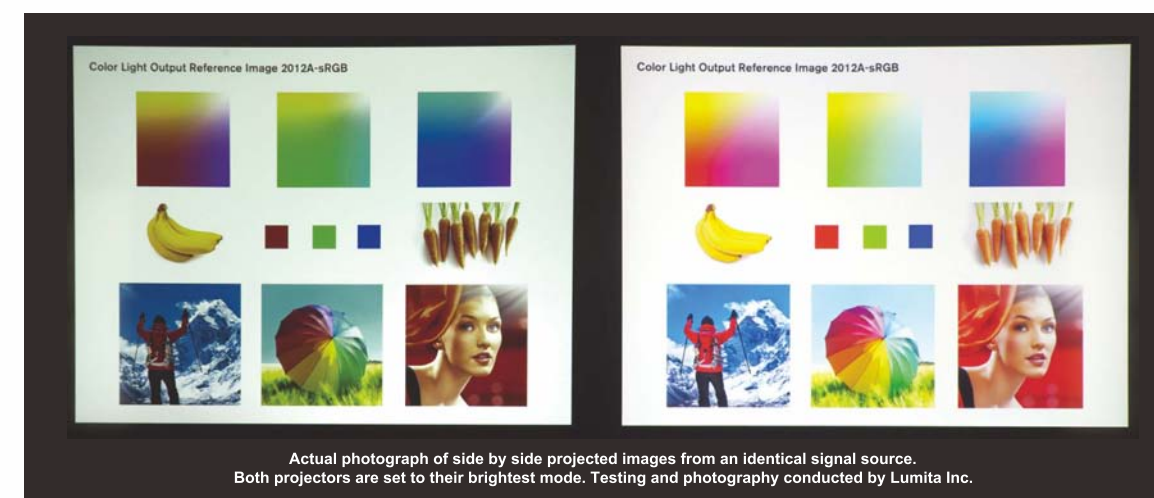

Actual photograph of side by side projected images from an identical signal source. Both projectors are set to their brightest mode. Testing and photography conducted by Lumita Inc.

Full copy of this buyer's guide will be provided upon your request or visit: http://www.colorlightoutput.com/Color_Brightness_Buyers_Guide.pdf

CONTENT

- ▶ Android / WiFi
 - Full HD (1920 x 1080), support 4K..... 06
 - HD (1280 x 800)..... 07
 - (854 x 480)..... 08
- ▶ EZcast / WiFi
 - (854 x 480)..... 09
 - EZCast Dongle..... 10
- ▶ Regular
 - HD (1280 x 800)..... 11
 - (854 x 480)..... 12
 - (640 x 480)..... 13
 - (320 x 240)..... 14
- ▶ Interactive White Board
 - portable..... 15
 - ceiling mount..... 16
 - Optional Accessories..... 17-18
- ▶ Regular Pico/Mini Projectors Specifications..... 19-20
- ▶ Android WiFi Pico/Mini Projectors Specifications..... 21-22

Android / WiFi

Full HD (1920 x 1080), support 4K

Mobile 1080P FP-369 – a Full HD mini Smart Projector

4K content compatible, 60"-180" projection

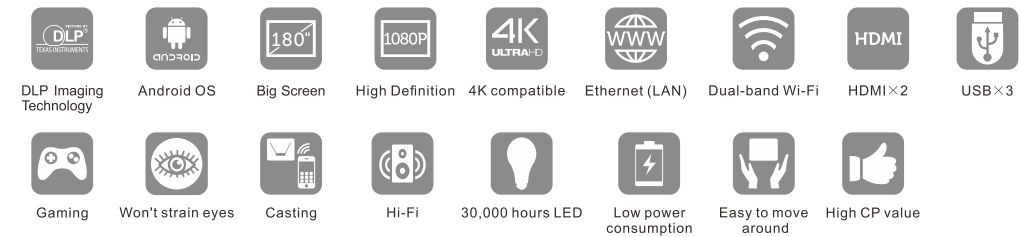

- ▣ Throw ratio 1.3:1
Takes 1.52m-4.5m (59.84"-177") distance to project a 60"-180" image.
- ▣ High Definition (1920 × 1080 pixels)
- ▣ Equal white / color brightness ensuring vivid color and image in depth
- ▣ Powerful Hi-Fi stereo



SPECIFICATIONS

Imaging technology		DLP	
Light source		LED	
White brightness		700 ANSI lumens	
Color brightness		700 ANSI lumens	
Sensual brightness (rough numbers, equivalent to lumens of a lamp based projector)		3500 ANSI lumens	
Resolution (pixels)		1920 × 1080	
LED life		20000 hours	
Projection size (can go bigger, however the image quality could be compromised)		60" ~ 180"	
Projection distance		1.52m~ 4.5m / 59.84"~177"	
Input	USB HOST	Yes (3)	
	CVBS (RCA)	Yes	
	HDMI	Yes (2)	
File decoder (for USB drive)	Video file format	MKV, WMV, MPG, DAT, MPEG, AVI, MOV, MP4, RM, F4A, FVV, RMVI	
	Audio file format	M4A, M4R, MP2, MP3, OGG, WAV, AAC, AMV, CPE, FLAC	
	Picture file format	JPEG, BMP, GIF, PNG	
	Document file format	TXT, PDF, OFFICE (with APK, GIF, PNG)	
Operating system		Android	
Processor		Quad Core	
Casting	Miracast	Yes	
	Screen mirroring	Yes	
Ethernet (LAN)		Yes	
Wi-Fi		2.4G & 5G	
Remote control		Yes	
Wireless mouse		Yes	
Speaker		10W × 2	
Audio output		Yes	
Power supply		DC 12V / 10A	
Dimension		275.2×152×100.45mm / 10.83×5.98×3.95(inch)	
Weight		2.1 Kg / 4.6 pound	

Android / WiFi

HD (1280 x 800)



▲ **FP-362A,FP-362B(TRUE 3D)**
 Brightness: 500 ANSI lumens
 Resolution: 1280x800 pixels
 Dimension: 215x150x53(mm)
 Weight: 820g

Features:

- Two versions:
 FP-362A (Android + WiFi)
 FP-362B (Android + WiFi + 3D)
- DLP imaging technology
- 500 ultra-high White & Color ANSI lumens
- High definition
- Built-in speakers
- Bountiful connectivity: Micro SD/TF card, USB, VGA, CVBS(RCA), HDMI, LAN
- Built with Android OS, Quad Core CPU, Bluetooth, Wi-Fi
- Support Miracast wireless mirroring for Android & iOS mobile devices
- (FP-362B) Supports 2D to 3D, 3D function (electronic shutter glasses x 1 included)

Android / WiFi

(854 x 480)



(mobile phone size)



▲ **FP-364D**
 Brightness: 100 ANSI lumens
 Resolution: 854x480 pixels
 Dimension: 136.8x83.6x25(mm)
 Weight: 300g

Features:

- Android + WiFi
- DLP imaging technology
- 100 White & Color ANSI lumens
- Light weight, pocket size, easy to carry around
- Built with a speaker & a rechargeable battery(can be charged by a regular power bank)
- Bountiful connectivity: Micro SD/TF card, USB, CVBS(RCA), HDMI
- Support Miracast wireless mirroring for Android & iOS mobile devices
- Brightness level is consistent no matter if it is powered by AC or DC



▲ **FP-359A,FP-359B(TRUE 3D)**
 Brightness: 200 ANSI lumens
 Resolution: 1280x800 pixels
 Dimension: 175x124x38(mm)
 Weight: 623g

Features:

- Two versions:
 FP-359A (Android + WiFi)
 FP-359B (Android + WiFi + 3D)
- DLP imaging technology
- 200 ultra-high White & Color ANSI lumens
- Built with speakers & a rechargeable battery (car charger included)
- High definition
- Bountiful connectivity: Micro SD/TF card, USB, VGA, CVBS(RCA), HDMI
- Built with Android OS, Quad Core CPU, Bluetooth, Wi-Fi
- Support Miracast wireless mirroring for Android & iOS mobile devices
- (FP-359B) Supports 2D to 3D, 3D function (electronic shutter glasses x 1 included)
- Brightness level is consistent no matter if it is powered by AC or DC



▲ **FP-360C**
 Brightness: 50 ANSI lumens
 Resolution: 854x480 pixels
 Dimension: 148x82x24(mm)
 Weight: 210g

Features:

- Android + WiFi
- DLP imaging technology
- 50 White & Color ANSI lumens
- Light weight, pocket size, easy to carry around
- Built with a speaker & a rechargeable battery (car charger included)
- Bountiful connectivity: Micro SD/TF card, USB, CVBS(RCA), HDMI
- Brightness level is consistent no matter if it is powered by AC or DC



▲ **FP-343B(TRUE 3D)**
 Brightness: 200 ANSI lumens
 Resolution: 1280x800 pixels
 Dimension: 110x110x129(mm)
 Weight: 950g

Features:

- Android + WiFi + 3D
- DLP imaging technology
- 200 ultra-high White & Color ANSI lumens
- Built with speakers & a rechargeable battery (car charger included)
- High definition
- Bountiful connectivity: Micro SD/TF card, USB, VGA, CVBS(RCA), HDMI
- Built with Android OS, Quad Core CPU, Bluetooth, and Wi-Fi
- Support Miracast wireless mirroring for Android & iOS mobile devices
- Supports 2D to 3D, 3D function (electronic shutter glasses x 1 included)
- Brightness level is consistent no matter if it is powered by AC or DC



▲ **FP-358D**
 Brightness: 100 ANSI lumens
 Resolution: 854x480 pixels
 Dimension: 145x104x29(mm)
 Weight: 360g

Features:

- Android + WiFi
- DLP imaging technology
- 100 high White & Color ANSI lumens
- Built with speakers & a rechargeable battery (car charger included)
- Bountiful connectivity: Micro SD/TF card, USB, CVBS(RCA), HDMI
- Built with Android OS, Quad Core CPU, Bluetooth, and Wi-Fi
- Support Miracast / wireless mirroring for Android & iOS mobile devices
- Brightness level is consistent no matter if it is powered by AC or DC

EZcast / WiFi

Wirelessly projecting from mobile phone to large screen



(mobile phone size)



FP-364A
 Brightness: 100 ANSI lumens
 Resolution: 854x480 pixels
 Dimension: 136.8x83.6x25(mm)
 Weight: 265g

Features:

- DLP imaging technology
- 100 high White & Color ANSI lumens
- Light weight, pocket size, easy to carry around
- Built with a speaker & a rechargeable battery (can be charged by a regular power bank)
- Bountiful connectivity: Micro SD/TF card, USB, HDMI
- No need to have a router around, it can wirelessly project from a mobile phone, tablet, or laptop to a large screen (compatible with Android, iOS, Windows, Mac-based devices)
- Can surf the web and watch YouTube videos etc. wirelessly through a connected smartphone or computer
- Support EZCast, Miracast casting programs
- Brightness level is consistent no matter if it is powered by AC or DC

Features:

- DLP imaging technology
- 100 high White & Color ANSI lumens
- Light weight, palmtop size, easy to carry around
- Built with a speaker & a rechargeable battery (can be charged by a regular power bank)
- Connectivity: HDMI
- No need to have a router around, it can wirelessly project from a mobile phone, tablet, or laptop to a large screen (compatible with Android, iOS, Windows, Mac-based devices)
- Can surf the web and watch YouTube videos etc. wirelessly through a connected smartphone or computer
- Support EZCast, Miracast casting programs
- Brightness level is consistent no matter if it is powered by AC or DC



FP-363A
 Brightness: 100 ANSI lumens
 Resolution: 854x480 pixels
 Dimension: 58x58x54(mm)
 Weight: 220g

EZcast / WiFi

Wirelessly casting from mobile phone to large screen

- No need to have a router around, it can wirelessly acquires and casts your mobile device display to a TV screen, or a projector's virtual screen
- Can surf the web and cast YouTube videos etc. wirelessly through a connected smartphone or computer
- Can work with Android, iOS, Windows, Mac based devices including smartphone, tablet, laptop, & PC
- Supports popular casting standards such as Miracast

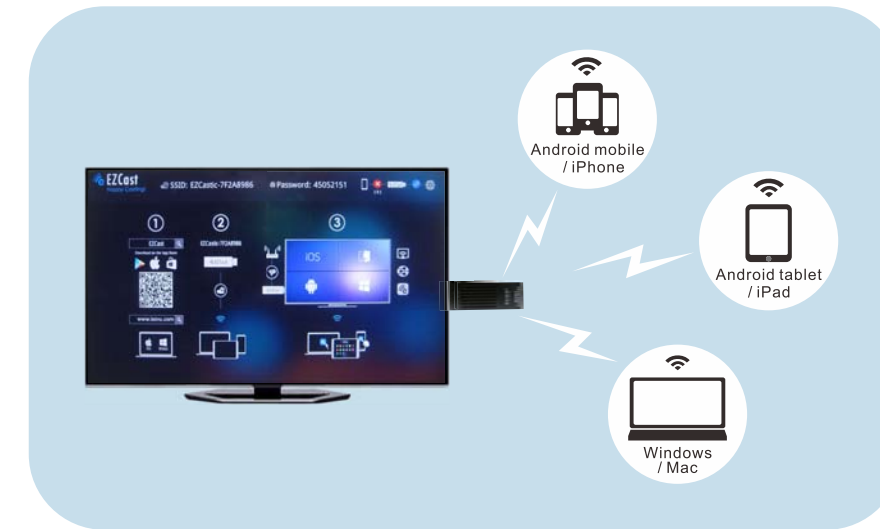

EL-384A

System requirements for mobile devices:

For iOS

iOS	iOS 7 and above
Device	All iPhone model after iPhone 4 All iPad model after iPad 2 All iPod touch after iPod touch 4 th generation
Resolution support	● iPhone: 480x320~1136x640 ● iPad: 1024x768~2048x1536
Storage	At least 40MB free space needed

For Windows

CPU	Dual Core 2 GHz or higher(ATOM not supported)
Graphic card	Graphic card with 64MB VRAM or above
OS version	Windows XP SP3, Vista SP2, Windows 7 SP1, Windows 8/8.1 and above
PC's WiFi	802.11n (2T2R recommended)

For Mac

CPU	Dual Core Intel Core i1.4 GHz or higher(PowerPC not supported)
Graphic card	Graphic card with 64MB VRAM or above
OS version	Mac OS X 10.8 and above
Recommended Models	Mac Book series and iMac series after E/2011

For Android

Phone/Pad	Android 4.0 and above with 1GB RAM
Resolution	WVGA ~1080p
Storage	At least 40MB free space needed

Regular

HD (1280 x 800)



FP-362C
Brightness: 500 ANSI lumens
Resolution: 1280x800 pixels
Dimension: 215x150x53(mm)
Weight: 820g

Features:

- ▣ DLP imaging technology
- ▣ 500 ultra-high White & Color ANSI lumens
- ▣ High definition
- ▣ Built-in speakers
- ▣ Bountiful connectivity: Micro SD/TF card, USB, VGA, CVBS(RCA), HDMI



FP-359C
Brightness: 200 ANSI lumens
Resolution: 1280x800 pixels
Dimension: 175x124x38(mm)
Weight: 623g

Features:

- ▣ DLP imaging technology
- ▣ 200 ultra-high White & Color ANSI lumens
- ▣ Light weight, easy to carry around
- ▣ Built with speakers & a rechargeable battery (car charger included)
- ▣ Bountiful connectivity: Micro SD/TF card, USB, VGA, CVBS(RCA), HDMI
- ▣ High definition
- ▣ Brightness level is consistent no matter if it is powered by AC or DC



FP-319
Brightness: 200 ANSI lumens
Resolution: 1280x800 pixels
Dimension: 170x110x37(mm)
Weight: 578g

Features:

- ▣ DLP imaging technology
- ▣ 200 ultra-high White & Color ANSI lumens
- ▣ Light weight, easy to carry around
- ▣ Built with speakers & a rechargeable battery (car charger included)
- ▣ Bountiful connectivity: Micro SD/TF card, USB, VGA, CVBS(RCA), HDMI
- ▣ High definition
- ▣ Brightness level is consistent no matter if it is powered by AC or DC

Regular

(854 x 480)



FP-360B
Brightness: 50 ANSI lumens
Resolution: 854x480 pixels
Dimension: 148x82x24(mm)
Weight: 210g

Features:

- ▣ DLP imaging technology
- ▣ Light weight, pocket size, easy to carry around
- ▣ Built with speakers & a rechargeable battery (car charger included)
- ▣ Bountiful connectivity: Micro SD/TF card, USB, CVBS(RCA), HDMI
- ▣ Brightness level is consistent no matter if it is powered by AC or DC



FP-318
Brightness: 100 ANSI lumens
Resolution: 854x480 pixels
Dimension: 143x89x27(mm)
Weight: 310g

Features:

- ▣ DLP imaging technology
- ▣ Light weight, pocket size, easy to carry around
- ▣ Built with speakers & a rechargeable battery (car charger included)
- ▣ Bountiful connectivity: Micro SD/TF card, USB, CVBS(RCA), HDMI
- ▣ Brightness level is consistent no matter if it is powered by AC or DC

Regular

(640 x 480)



▲ **FP-345**
 Brightness: 50 ANSI lumens
 Resolution: 640x480 pixels
 Dimension: 142x72x23(mm)
 Weight: 198g

Features:

- DLP imaging technology
- 50 White & Color ANSI lumens
- Light weight, pocket size, easy to carry around
- Built with speakers & a rechargeable battery (car charger included)
- Bountiful connectivity: Micro SD/TF card, USB, CVBS(RCA), HDMI
- Brightness level is consistent no matter if it is powered by AC or DC

Features:

- FP-339D**
- LCoS imaging technology
 - 40 White & Color ANSI lumens
 - Light weight, pocket size, easy to carry around
 - Built with a speaker & a rechargeable battery
 - Bountiful connectivity: Micro SD/TF card, USB, CVBS(RCA), HDMI
 - Front & ceiling projection design (flexible projection angle)
 - Brightness level is consistent no matter if it is powered by AC or DC

FP-339B

- LCoS imaging technology
- 40 White & Color ANSI lumens
- Light weight, easy to carry around
- Built with a speaker & a rechargeable battery
- With Micro SD/TF card reader
- Front & ceiling projection design (flexible projection angle)
- Has a child-safe design
- Brightness level is consistent no matter if it is powered by AC or DC

Features:

- LCoS imaging technology
- 40 White & Color ANSI lumens
- Light weight, easy to carry around
- Built with speakers & a rechargeable battery
- Bountiful connectivity: Micro SD/TF card, USB, CVBS(RCA), HDMI
- Brightness level is consistent no matter if it is powered by AC or DC

Features:

- LCoS imaging technology
- 40 White & Color ANSI lumens
- Light weight, palmtop size, easy to carry around
- Built with speakers & a rechargeable battery
- Bountiful connectivity: Micro SD/TF card, USB, CVBS(RCA), HDMI
- Brightness level is consistent no matter if it is powered by AC or DC

▲ **FP-272F**
 Brightness: 40 ANSI lumens
 Resolution: 640x480 pixels
 Dimension: 132x105x40(mm)
 Weight: 352g

▲ **FP-199B**
 Brightness: 40 ANSI lumens
 Resolution: 640x480 pixels
 Dimension: 73x58x41(mm)
 Weight: 125g

Regular

(320x 240)



▲ **FP-339E**
 Brightness: 10 ANSI lumens
 Resolution: 320x240 pixels
 Dimension: ∅ 106(mm)
 Weight: 420g

Features:

- LCoS imaging technology
- 10 White & Color ANSI lumens
- Light weight, pocket size, easy to carry around
- Built with a speaker & a rechargeable battery
- Bountiful connectivity: Micro SD/TF card, USB, CVBS(RCA), HDMI
- Front & ceiling projection design (flexible projection angle)
- Brightness level is consistent no matter if it is powered by AC or DC



▲ **FP-339C**
 Brightness: 10 ANSI lumens
 Resolution: 320x240 pixels
 Dimension: ∅ 106(mm)
 Weight: 320g

Features:

- LCoS imaging technology
- 10 White & Color ANSI lumens
- Light weight, easy to carry around
- Built with a speaker & a rechargeable battery
- With Micro SD/TF card reader
- Front & ceiling projection design (flexible projection angle)
- Has a child-safe design
- Brightness level is consistent no matter if it is powered by AC or DC



▲ **FP-272G**
 Brightness: 10 ANSI lumens
 Resolution: 320x240 pixels
 Dimension: 132x105x40(mm)
 Weight: 352g

Features:

- LCoS imaging technology
- 10 White & Color ANSI lumens
- Light weight, easy to carry around
- Built with speakers & a rechargeable battery
- Bountiful connectivity: Micro SD/TF card, USB, CVBS(RCA), HDMI
- Brightness level is consistent no matter if it is powered by AC or DC

Interactive White Board (portable version)

A short focal length projector with built-in computer, interactive optical white board, document camera, & high power speakers for classroom or meeting room use



FR-306BA



Features:



Mobility

- Small & lightweight
- Ergonomic design of carrying handle
- Can be stored in school / company equipment room to maximize the utilization rate

- Can be easily carried to different places such as outdoor teaching, student recruitment, meetings and more
- Single power source design eliminate tedious wiring and reduces setup complexities

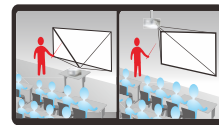

Advanced Projection

- Ultra short focal length (short throw) projection technology prevent projection image blocked by the presenter

- Available in desktop placement model (FR-306BA) & ceiling mount model (FR-306BB)
- Built-in interactive optical electronic whiteboard can project on any white wall or curtain without the need for any additional electronic devices



Highly Integrated (All in one design)

- HD short focal length projector
- Microsoft Windows PC
- Interactive optical whiteboard
- High wattage stereo amplifying system(20W x2)

- 5 megapixels document camera with rotatable folding support to provide easy camera direction and height adjustment (available in the desktop model only)



Other Important Design

- Heat radiation duct design
- Dust-proof design



Flexible Connectivity

- Proprietary wireless remote streaming software allows up to 253 users to seamlessly switch between presenter (optional)

- Keyboard / mouse can be connected via USB port or wirelessly
- Laptop or other video source can be connected via HDMI port to project HD video and audio with a single cable

SPECIFICATIONS

Model		FR-306BA (desktop model)	FR-306BB (ceiling-mount model)
Projector specifications	Display technology	TI 0.65 DMD™	
	Native resolution	XGA (1024 x 768Pixels)	
	Aspect ratio	16:10 & 4:3	
	Bulb type / Bulb service life	UHP 230W / 3,000 hours (power saving mode: 5,000 hours)	
	Brightness	3000 Lumen	
	Contrast	3000:1	
	Uniformity	≥90%	
	Image offset	108% ~ 118%	
	Projection ratio	0.54:1	

Interactive White Board (ceiling mount version)

A short focal length projector with built-in computer, interactive optical white board, document camera(optional), & high power speakers for classroom or meeting room use



FR-306BB



wall-mount control box

Projector specifications	Projection size	30" ~ 180"	
	Projection distance	1.97m ~ 2.17m	
	Input port	HDMI x 1	
	Output port	3.5mm audio out x 1	
	Video type	480i, 480p, 576i, 576p, 720p, 1080i, VGA, SVGA, XGA, SXGA, WXGA Quad VGA, MAC19, MAC, SECAM, PAL, NTSC	
	Power consumption	310W (standard)	
	Standby power consumption	<1W	
	Operating environment	Working temperature: 5°C ~ 35°C (41°F ~ 95°F), Room Humidity: 10% ~ 85% (no condensing state)	
	Power requirement	100V~240V AC (automatic conversion), 50~60Hz	
	Interactive touch control method	Optical pen touch control	
Intelligent key lock control box	—	Available	
Computer specifications	CPU	Intel	
	Memory	4 GB DDR3	
	Hard disk	500GB	
	Graphics card	Onboard Intel Graphics Media Accelerator 3150 video card	
	Peripheral device interface	USB3.0 x 2, USB2.0 x 2, microphone x 1, audio line output (earphone) x 1, network interface x 1	
Document camera	LAN network interface	Integrated PCIE 1000M LAN	
	Photosensitive chip type	CMOS sensor	Optional
	Camera pixel	5 Megapixels	Optional
Options	Auto focusing	Available	Optional
	Speaker	2.0 channels, 20Wx2 (standard) / 2.1 channels, 20Wx2+50Wx1 (optional) for FR-306BB	
Others	Wireless microphone	Optional	
	Wireless remote screen streaming	Optional	
	Dimension (WxHxD)	436 x 355 x 150mm	436 x 355 x 150mm
	Weight	7.5Kg(10Kg with speaker)	7.5Kg(10Kg with speaker)

Interactive White Board

Optional Accessories

AEP-280

Control Box with Document Camera (upgrade version for FR-306BB's standard control box)

- Adjustable camera height and angle



SPECIFICATIONS	
Sensor Chips	CMOS
Light	White LED with Manual Switch
Camera Resolution	500M Pixel
Focus	Automatic
USB port	USBX2



standard control box for FR-360BB

AEP-379

Multifunction Interactive Pointer

- Combining writing, laser pointer, and wireless mouse in one piece
- Unique PPT control function
- IR touch control
- Hand writing recognition
- 20 meters effective range for wireless mouse
- Lithium battery with USB charger
- Ergonomic design



Interactive White Board

EL-387A (Microphone & Transmitter) + EL-324E (Receiver)

Wireless Low Noise Microphone (for classroom, conference, concert, monitor & home entertainment use)

- Patented Noise-filter technology
- Wireless automatic pairing
- Compact, handy, & easy to use
- Eliminates microphone howling
- Lithium rechargeable battery
- 30 meters effective transmitting range



EL-387A
(Microphone & Transmitter)

EL-324E
(Receiver)







AEP-320







Ceiling Mount

- Patented easy-installation design
- Strong alloy material
- Flexible length adjustment
- Flexible angle adjustment
- Supports up to 15KG weight
- Without the need of any tools, projector can be easily mounted or dismantled

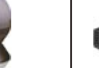

Regular Pico/Mini Projectors

Model No.							
Specification	FP-199B	FP-272F	FP-272G	FP-318	FP-319	FP-339B	FP-339C
Page	P13	P13	P14	P12	P11	P13	P14
Imaging technology	LCoS	LCoS	LCoS	DLP	DLP	LCoS	LCoS
Sensual brightness (rough numbers, equivalent to lumens of a lamp based projector)	200 ANSI lumens	200 ANSI lumens	50 ANSI lumens	500 ANSI lumens	1000 ANSI lumens	200 ANSI lumens	50 ANSI lumens
White brightness	40 ANSI lumens	40 ANSI lumens	10 ANSI lumens	100 ANSI lumens	200 ANSI lumens	40 ANSI lumens	10 ANSI lumens
Color brightness	40 ANSI lumens	40 ANSI lumens	10 ANSI lumens	100 ANSI lumens	200 ANSI lumens	40 ANSI lumens	10 ANSI lumens
Resolution(pixels)	640 x 480	640 x 480	320 x 240	854 x 480	1280 x 800	640 x 480	320 x 240
LED life (hours)	20000	20000	20000	20000	20000	20000	20000
Projection size (can go bigger, however the image quality could be compromised)	6" ~ 71"	6" ~ 71"	5" ~ 50"	14" ~ 140"	17" ~ 161"	6" ~ 71"	5" ~ 50"
Projection distance	0.15m ~ 1.86m	0.15m ~ 1.86m	0.25m ~ 2.5m	0.5m ~ 5m	0.5m ~ 5m	0.15m ~ 1.86m	0.25m ~ 2.5m
File decoder (for USB drive & memory card)	Video file format	AVI,MP4, MPG,RMVB/RM,MJPEG, MKV	AVI,MP4, MPG,RMVB/RM,MJPEG, MKV	AVI,MP4, MPG,RMVB/RM,MJPEG, MKV	AVI,MP4, MPG,RMVB/RM,MJPEG, MKV	AVI,MOV, MP4,MPG, DAT,3GP,	AVI,MOV, MP4,MPG, DAT,3GP,
	Audio file format	MP3,WMA, W4A,WAV, AAC	MP3,WMA, W4A,WAV, AAC	MP3,WMA, W4A,WAV, AAC	MP3,WMA, W4A,WAV, AAC	WMA,WAV, OGG,MP3	WMA,WAV, OGG,MP3
	Picture file format	JPG,BMP, PNG	JPG,BMP, PNG	JPG,BMP, PNG	JPG,BMP, PNG	JPG,BMP, PNG	JPG,BMP, PNG
	Document file format	TXT	TXT	TXT	TXT	TXT	-
Input	Micro SD/TF card	Yes	Yes	Yes	Yes	Yes	Yes
	USB HOST	Yes	Yes	Yes	Yes	Yes	-
	VGA	-	-	-	-	Yes	-
	CVBS (RCA)	Yes	Yes	Yes	Yes	Yes	-
	HDMI	Yes	Yes	Yes	Yes	Yes	-
Android OS	-	-	-	-	-	-	-
Processor	-	-	-	-	-	-	-
Wi-Fi	-	-	-	-	-	-	-
Ethernet(LAN)	-	-	-	-	-	-	-
Casting	EZCast	-	-	-	-	-	-
	Miracast	-	-	-	-	-	-
	Screen mirroring	-	-	-	-	-	-
3D	2D to 3D	-	-	-	-	-	-
	3D	-	-	-	-	-	-
Remote control	Yes	Yes	Yes	Yes	Yes	Yes	Yes
Speaker	1W x 1	1W x 1	1W x 1	2W x 1	1W x 2	2W x 1	2W x 1
Audio output	Yes	Yes	Yes	Yes	Yes	Yes	Yes
Audio output (Bluetooth)	-	-	-	-	-	-	-
Power supply	DC 12V / 2A	DC 12V / 2A	DC 12V / 1.25A	DC 12V / 1.25A	DC 12V / 3A	DC 12V / 2A	DC 12V / 1.25A
Rechargeable Lithium battery	7.4V, 2200mAh	7.4V, 2200mAh	7.4V, 2200mAh	7.4V, 1800mAh	7.4V, 4500mAh	7.4V, 2200mAh	7.4V, 2200mAh
Dimension	73x58x41(mm)	132x105x40(mm)	132x105x40(mm)	143x89x27(mm)	170x110x37(mm)	ø106(mm)	ø106(mm)
Weight	125g	326g	352g	310g	578g	320g	320g

Model No.						
Specification	FP-339D	FP-339E	FP-345	FP-360B	FP-359C	FP-362C
Page	P13	P14	P13	P12	P11	P11
Imaging technology	LCoS	LCoS	DLP	DLP	DLP	DLP
Sensual brightness (rough numbers, equivalent to lumens of a lamp based projector)	200 ANSI lumens	50 ANSI lumens	250 ANSI lumens	250 ANSI lumens	1000 ANSI lumens	2500 ANSI lumens
White brightness	40 ANSI lumens	10 ANSI lumens	50 ANSI lumens	50 ANSI lumens	200 ANSI lumens	500 ANSI lumens
Color brightness	40 ANSI lumens	10 ANSI lumens	50 ANSI lumens	50 ANSI lumens	200 ANSI lumens	500 ANSI lumens
Resolution(pixels)	640 x 480	320 x 240	640 x 480	854 x 480	1280 x 800	1280 x 800
LED life (hours)	20000	20000	20000	20000	20000	20000
Projection size (can go bigger, however the image quality could be compromised)	6" ~ 71"	5" ~ 50"	15" ~ 91"	9" ~ 120"	17" ~ 161"	17" ~ 161"
Projection distance	0.15m ~ 1.86m	0.25m ~ 2.5m	0.5m ~ 3m	0.3m ~ 4m	0.5 ~ 5m	0.5m ~ 5m
File decoder (for USB drive & memory card)	Video file format	AVI,MP4, MPG,RMVB/RM,MJPEG, MKV	AVI,MP4, MPG,RMVB/RM,MJPEG, MKV	AVI,MP4, MPG,RMVB/RM,MJPEG, MKV	AVI,MP4, MPG,RMVB/RM,MJPEG, MKV	AVI,MP4, MPG,RMVB/RM,MJPEG, MKV
	Audio file format	MP3,WMA, W4A,WAV, AAC	MP3,WMA, W4A,WAV, AAC	MP3,WMA, W4A,WAV, AAC	MP3,WMA, W4A,WAV, AAC	MP3,WMA, W4A,WAV, AAC
	Picture file format	JPG,BMP, PNG	JPG,BMP, PNG	JPG,BMP, PNG	JPG,BMP, PNG	JPG,BMP, PNG
	Document file format	TXT	TXT	TXT	TXT	TXT
Input	Micro SD/TF card	Yes	Yes	Yes	Yes	Yes
	USB HOST	Yes	Yes	Yes	Yes	Yes
	VGA	-	-	-	-	Yes
	CVBS (RCA)	Yes	Yes	Yes	Yes	Yes
	HDMI	Yes	Yes	Yes	Yes	Yes
Android OS	-	-	-	-	-	-
Processor	-	-	-	-	-	-
Wi-Fi	-	-	-	-	-	-
Ethernet(LAN)	-	-	-	-	-	-
Casting	EZCast	-	-	-	-	-
	Miracast	-	-	-	-	-
	Screen mirroring	-	-	-	-	-
3D	2D to 3D	-	-	-	-	-
	3D	-	-	-	-	-
Remote control	Yes	Yes	Yes	Yes	Yes	Yes
Speaker	2W x 1	2W x 1	1W x 1	1W x 1	2W x 2	3W x 2
Audio output	Yes	Yes	Yes	Yes	Yes	Yes
Audio output (Bluetooth)	-	-	-	-	-	-
Power supply	DC 12V / 2A	DC 12V / 1.25A	DC 12V / 1.25A	DC 12V / 1.25A	DC 12V / 3A	DC 12V / 5A
Rechargeable Lithium battery	7.4V, 2200mAh	7.4V, 2200mAh	7.4V, 1800mAh	7.4V, 2400mAh	7.4V, 4500mAh	-
Dimension	106(mm)	106(mm)	142x72x23(mm)	148x82x24(mm)	175x124x38(mm)	215x150x53(mm)
Weight	420g	420g	198g	210g	623g	820g

Why us?

1. We have superior expertise & experiences in Optical Engine / Projector design and production.
2. Our projectors' performances in brightness & color exceeds competitors' models in the same league.
3. Brightness levels of our projectors remain consistent when AC power supply is switched to DC(battery). (Attn: Brightness drops 30-50% in 90% of competitors' models when the power supply is switched from AC to DC.)

Specifications subject to change without notice

Android WiFi Pico/Mini Projectors

Model No.						
Specification	FP-343B (TRUE 3D)	FP-358D	FP-359A	FP-359B	FP-360C	
Page	P07	P08	P07	P07	P08	
Imaging technology	DLP	DLP	DLP	DLP	DLP	
Sensual brightness (rough numbers, equivalent to lumens of a lamp based projector)	1000 ANSI lumens	500 ANSI lumens	1000 ANSI lumens	1000 ANSI lumens	250 ANSI lumens	
White brightness	200 ANSI lumens	100 ANSI lumens	200 ANSI lumens	200 ANSI lumens	50 ANSI lumens	
Color brightness	200 ANSI lumens	100 ANSI lumens	200 ANSI lumens	200 ANSI lumens	50 ANSI lumens	
Resolution (pixels)	1280 x 800	854 x 480	1280 x 800	1280 x 800	854 x 480	
LED life (hours)	20000	20000	20000	20000	20000	
Projection size (can go bigger, however the image quality could be compromised)	17" ~ 161"	14" ~ 140"	17" ~ 161"	17" ~ 161"	9" ~ 120"	
Projection distance	0.5m ~ 5m	0.5m ~ 5m	0.5 ~ 5m	0.5 ~ 5m	0.3m ~ 4m	
File decoder (for USB drive & memory card)	Video file format	MKV, WMV, MPG, DAT, MPEG, AVI, MOV, MP4, RM, F4A, FVV, RMVI	MKV, WMV, MPG, DAT, MPEG, AVI, MOV, MP4, RM, F4A, FVV, RMVI	MKV, WMV, MPG, DAT, MPEG, AVI, MOV, MP4, RM, F4A, FVV, RMVI	MKV, WMV, MPG, DAT, MPEG, AVI, MOV, MP4, RM, F4A, FVV, RMVI	
	Audio file format	M4A, M4R, MP2, MP3, OGG, WAV, AAC, AMV, CPE, FLAC	M4A, M4R, MP2, MP3, OGG, WAV, AAC, AMV, CPE, FLAC	M4A, M4R, MP2, MP3, OGG, WAV, AAC, AMV, CPE, FLAC	M4A, M4R, MP2, MP3, OGG, WAV, AAC, AMV, CPE, FLAC	
	Picture file format	JPEG, BMP, GIF, PNG	JPEG, BMP, GIF, PNG	JPEG, BMP, GIF, PNG	JPG, BMP, PNG	
	Document file format	TXT, PDF, OFFICE (with APK installed)	TXT, PDF, OFFICE (with APK installed)	TXT, PDF, OFFICE (with APK installed)	TXT, PDF, OFFICE (with APK installed)	TXT
Input	Micro SD/TF card	Yes	Yes	Yes	Yes	Yes
	USB HOST	Yes x 2	Yes x 2	Yes x 2	Yes x 2	Yes
	VGA	Yes	-	Yes	Yes	-
	CVBS (RCA)	Yes	Yes	Yes	Yes	Yes
	HDMI	Yes	Yes	Yes	Yes	Yes
Android OS	Yes	Yes	Yes	Yes	Yes	
Processor	Quad core	Quad core	Quad core	Quad core	Dual core	
Wi-Fi	Yes	Yes	Yes	Yes	Yes	
Ethernet (LAN)	-	-	-	-	-	
Casting	EZCast	-	-	-	-	
	Miracast	Yes	Yes	Yes	Yes	-
	Screen mirroring	Yes	Yes	Yes	Yes	-
3D	2D to 3D	Yes	-	-	Yes	-
	3D	Yes	-	-	Yes	-
Remote control	Yes	Yes	Yes	Yes	Yes	
Speaker	2W x 2	2W x 1	2W x 2	2W x 2	1W x 1	
Audio output	Yes	Yes	Yes	Yes	Yes	
Audio output (Bluetooth)	Yes	Yes	Yes	Yes	-	
Power supply	DC 12V / 3A	DC 12V / 2A	DC 12V / 3A	DC 12V / 3A	DC 12V / 1.25A	
Rechargeable Lithium battery	7.4V, 6000mAh	7.4V, 4200mAh	7.4V, 4500mAh	7.4V, 4500mAh	7.4V, 2400mAh	
Dimension	110x110x129(mm)	145x104x29(mm)	175x124x38(mm)	175x124x38(mm)	148x82x24(mm)	
Weight	950g	370g	623g	640g	210g	

Model No.							
Specification	FP-362A	FP-362B (TRUE 3D)	FP-363A	FP-364A	FP-364D	FP-369	
Page	P07	P07	P09	P09	P08	P06	
Imaging technology	DLP	DLP	DLP	DLP	DLP	DLP	
Sensual brightness (rough numbers, equivalent to lumens of a lamp based projector)	2500 ANSI lumens	2500 ANSI lumens	500 ANSI lumens	500 ANSI lumens	500 ANSI lumens	3500 ANSI lumens	
White brightness	500 ANSI lumens	500 ANSI lumens	100 ANSI lumens	100 ANSI lumens	100 ANSI lumens	700 ANSI lumens	
Color brightness	500 ANSI lumens	500 ANSI lumens	100 ANSI lumens	100 ANSI lumens	100 ANSI lumens	700 ANSI lumens	
Resolution (pixels)	1280 x 800	1280 x 800	854 x 480	854 x 480	854 x 480	1920 x 1080	
LED life (hours)	20000	20000	20000	20000	20000	20000	
Projection size (can go bigger, however the image quality could be compromised)	17" ~ 161"	17" ~ 161"	14" ~ 140"	14" ~ 140"	14" ~ 140"	60" ~ 180"	
Projection distance	0.5m ~ 5m	0.5m ~ 5m	0.5m ~ 5m	0.5m ~ 5m	0.5m ~ 5m	1.52m ~ 4.5m	
File decoder (for USB drive & memory card)	Video file format	MKV, WMV, MPG, DAT, MPEG, AVI, MOV, MP4, RM, F4A, FVV, RMVI	MKV, WMV, MPG, DAT, MPEG, AVI, MOV, MP4, RM, F4A, FVV, RMVI	-	AVI, MP4, MPG, RMVB, RM, MJPEG, MKV	MKV, WMV, MPG, DAT, MPEG, AVI, MOV, MP4, RM, F4A, FVV, RMVI	
	Audio file format	M4A, M4R, MP2, MP3, OGG, WAV, AAC, AMV, CPE, FLAC	M4A, M4R, MP2, MP3, OGG, WAV, AAC, AMV, CPE, FLAC	-	MP3, WMA, W4A, WAV, AAC	M4A, M4R, MP2, MP3, OGG, WAV, AAC, AMV, CPE, FLAC	
	Picture file format	JPEG, BMP, GIF, PNG	JPEG, BMP, GIF, PNG	-	JPG, BMP, PNG	JPEG, BMP, GIF, PNG	
	Document file format	TXT, PDF, OFFICE (with APK installed)	TXT, PDF, OFFICE (with APK installed)	-	TXT	TXT, PDF, OFFICE (with APK installed)	TXT, PDF, OFFICE (with APK installed)
Input	Micro SD/TF card	Yes	Yes	-	Yes	Yes	-
	USB HOST	Yes x 2	Yes x 2	-	Yes	Yes x 2	Yes x 2
	VGA	Yes	Yes	-	-	-	-
	CVBS (RCA)	Yes	Yes	-	-	Yes	Yes
	HDMI	Yes	Yes	Yes	Yes	Yes	Yes
Android OS	Yes	Yes	-	-	Yes	Yes	
Processor	Quad core	Quad core	-	Quad core	Quad core	Quad core	
Wi-Fi	Yes	Yes	Yes	Yes	Yes	Yes	
Ethernet (LAN)	Yes	Yes	-	-	-	Yes	
Casting	EZCast	-	-	Yes	Yes	-	-
	Miracast	Yes	Yes	Yes	Yes	Yes	Yes
	Screen mirroring	Yes	Yes	-	-	Yes	Yes
3D	2D to 3D	-	Yes	-	-	-	-
	3D	-	Yes	-	-	-	-
Remote control	Yes	Yes	-	Yes	Yes	Yes	
Speaker	3W x 2	3W x 2	1.5W x 1	1.5W x 1	1.5W x 1	10W x 2	
Audio output	Yes	Yes	Yes	Yes	Yes	Yes	
Audio output (Bluetooth)	Yes	Yes	-	-	Yes	Yes	
Power supply	DC 12V / 5A	DC 12V / 5A	DC 5V / 3A	DC 5V / 3A	DC 5V / 3A	DC 12V / 10A	
Rechargeable Lithium battery	-	-	3.7V, 4000mAh	3.7V, 4000mAh	3.7V, 4000mAh	-	
Dimension	215x150x53(mm)	215x150x53(mm)	58x58x54(mm)	136.8x83.6x25(mm)	136.8x83.6x25(mm)	275.2x152x100.45mm	
Weight	820g	820g	220g	293g	293g	2.1 Kg	

Why us?

1. We have superior expertise & experiences in Optical Engine / Projector design and production.
 2. Our projectors' performances in brightness & color exceeds competitors' models in the same league.
 3. Brightness levels of our projectors remain consistent when AC power supply is switched to DC (battery).
- (Attn: Brightness drops 30-50% in 90% of competitors' models when the power supply is switched from AC to DC.)

Specifications subject to change without notice