

EZ-LIGHT® TL50CZ Compact Universal AC Voltage Tower Light

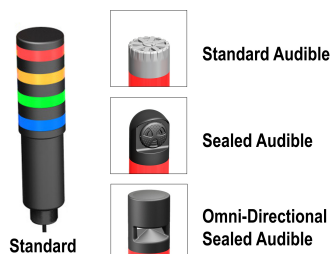

Datasheet

Multi-Color General-Purpose or Audible Indicators



- Bright, uniform lighted segments at only half the height of the standard TL50 models
- Rugged, cost-effective, and easy-to-install multi-segment indicators
- Illuminated segments provide easy-to-see operator guidance and indication of equipment status
- Displays up to 5 colors
- Available in black or light gray housing
- Audible models available with standard, sealed, or omni-directional audible element
- Compact devices are completely self-contained - no controller needed
- 85 to 264 V ac operation
- No assembly required

Models

Models—cabled Black models only are listed. For gray housing, add suffix C at the end of the model number (cabled models) or before the QP (pigtail models), for example, TL50CZRC or TL50CZRCQP.

LED Function—the first color listed is the bottom color, going up in successive order. Five color options are only available in non-audible cabled models. Four color options are only available in audible cabled models.

Connection—cabled models only are listed; mating cordset required for pigtail models (see [Cordsets](#) on page 4). For 150 mm (5.9 in) PVC pigtail with QD, add QP to the end of the model number, for example, TL50CZRQP.

For additional models and colors, visit Banner Engineering website at www.bannerengineering.com.

Non-Audible Models	# of LED Colors	LED Function	Connection	Inputs
TL50CZR	1	Red	4-wire PVC cable	85-264 V ac
TL50CZGR	2	Green, Red		
TL50CZGYR	3	Green, Yellow, Red		
TL50CZBGYR	4	Blue, Green, Yellow, Red	5-wire PVC cable	
TL50CZWBGYR	5	White, Blue, Green, Yellow, Red	6-wire PVC cable	

Standard Audible Models	# of LED Colors	LED Function	Connection	Inputs
TL50CZRA	1	Red	4-wire PVC cable	85-264 V ac
TL50CZGRA	2	Green, Red		
TL50CZGYRA	3	Green, Yellow, Red	5-wire PVC cable	
TL50CZBGYRA	4	Blue, Green, Yellow, Red	6-wire PVC cable	

Sealed Audible Models			# of LED Colors	LED Function	Connection	Inputs
Continuous	Pulsed at 1.6 Hz	Staccato				
TL50CZRALS	TL50CZRALS3	TL50CZRALS4	1	Red	4-wire PVC cable	85-264 V ac
TL50CZGRALS	TL50CZGRALS3	TL50CZGRALS4	2	Green, Red		
TL50CZGYRALS	TL50CZGYRALS3	TL50CZGYRALS4	3	Green, Yellow, Red	5-wire PVC cable	
TL50CZBGYRALS	TL50CZBGYRALS3	TL50CZBGYRALS4	4	Blue, Green, Yellow, Red	6-wire PVC cable	

Omni-Directional Sealed Audible Models			# of LED Colors	LED Function	Connection	Inputs
Continuous	Pulsed at 1.6 Hz	Staccato				
TL50CZRAOS	TL50CZRAOS3	TL50CZRAOS4	1	Red	4-wire PVC cable	85-264 V ac



Omni-Directional Sealed Audible Models			# of LED Colors	LED Function	Connection	Inputs
Continuous	Pulsed at 1.6 Hz	Staccato				
TL50CZGRAOS	TL50CZGRAOS3	TL50CZGRAOS4	2	Green, Red		5-wire PVC cable 6-wire PVC cable
TL50CZGYRAOS	TL50CZGYRAOS3	TL50CZGYRAOS4	3	Green, Yellow, Red	5-wire PVC cable	
TL50CZBGYRAOS	TL50CZBGYRAOS3	TL50CZBGYRAOS4	4	Blue, Green, Yellow, Red	6-wire PVC cable	

Omni-Directional Sealed Audible Models with Intensity Adjustment			# of LED Colors	LED Function	Connection	Inputs
Continuous	Pulsed at 1.6 Hz	Staccato				
TL50CZRAOS	TL50CZRAOS3	TL50CZRAOS4	1	Red	4-wire PVC cable	85-264 V ac
TL50CZGRAOSI	TL50CZGRAOSI 3	TL50CZGRAOSI 4	2	Green, Red	5-wire PVC cable	
TL50CZGYRAOSI	TL50CZGYRAOSI 3	TL50CZGYRAOSI 4	3	Green, Yellow, Red	6-wire PVC cable	
TL50CZBGYRAOSI	TL50CZBGYRAOSI 3	TL50CZBGYRAOSI 4	4	Blue, Green, Yellow, Red	6-wire PVC cable	

Specifications

Supply Voltage and Current

85–264 V ac; 50 or 60 Hz

Indicators—maximum current per LED color:

65 mA at 85 V ac

50 mA at 120 V ac

31 mA at 240 V ac

29 mA at 264 V ac

Standard Audible Alarm: 30 mA maximum current

Sealed Audible Alarm: 35 mA maximum current

Omni-Directional Sealed Audible Alarm: 45 mA maximum current

Supply Protection Circuitry

Protected against reverse polarity and transient voltages

Audible Adjustment

Standard Audible Alarm: Unscrew the cover (up to 1.5 turns maximum) to adjust the audible intensity. (Do not exceed 1.5 turns or the cover may detach during operation.) For maximum intensity, rotate the center plug 180° counterclockwise to remove it.

Sealed Audible Alarm and Omni-Directional Sealed Audible Alarm with Intensity Adjustment: Rotate the front cover until the desired intensity is reached.

Omni-Directional Sealed Audible Alarm: No adjustment.

Leakage Current Immunity

500 μ A

Application Note: The use of relay output PLC is recommended since there is no leakage current. Solid state output PLCs often have leakage current above 1 mA and, therefore, turn the light on in the off state. To counteract the leakage current, a shunt resistor must be used. A resistor must be applied from the neutral wire of the device to the hot wire of each channel of the device.

Indicators

LEDs are independently selected; 1 to 5 colors (Green, Red, Yellow, Blue, White) depending on model

Construction

Bases and Covers: ABS

Light Segment: Polycarbonate

Connections

4-wire, 5-wire, or 6-wire 2 m (6.5 ft) integral cable; 4-pin or 5-pin 150 mm (6 in) PVC pigtail with QD, depending on model

Audible Alarm

Standard Audible Alarm: 2.7 kHz \pm 500 Hz oscillation frequency; maximum intensity 92 dB at 1 m (3.3 ft) (typical)

Sealed Audible Alarm: 2.9 kHz \pm 250 Hz oscillation frequency; maximum intensity 94 dB at 1 m (3.3 ft) (typical)

Omni-Directional Sealed Audible Alarm: 2.1 kHz \pm 250 Hz oscillation frequency; maximum intensity 99 dB at 1 m (3.3 ft) (typical)

Omni-Directional Sealed Audible Alarm with Intensity Adjustment: 2.1 kHz \pm 250 Hz oscillation frequency; maximum intensity 95 dB at 1 m (3.3 ft) (typical)

Input Response Time

Indicator On/Off: 500 ms (maximum)

Vibration and Mechanical Shock

All models meet Mil Std. 202F requirements. Method 201A (vibration: 10 to 60 Hz max., double amplitude 0.06", maximum acceleration 10G). Also meets IEC 947-5-2 requirements: 30G 11 ms duration, half sine wave.

Operating Conditions

Non-Audible: -40 °C to +50 °C (-40 °F to +122 °F)
Standard and Sealed Audible: -20 °C to +50 °C (-4 °F to +122 °F)
95% at +50 °C maximum relative humidity (non-condensing)

Environmental Rating

Non-Audible and Sealed Audible: IEC IP67
Standard Audible: IEC IP50

Certifications**Required Overcurrent Protection**

WARNING: Electrical connections must be made by qualified personnel in accordance with local and national electrical codes and regulations.

Overcurrent protection is required to be provided by end product application per the supplied table.

Overcurrent protection may be provided with external fusing or via Current Limiting, Class 2 Power Supply.

Supply wiring leads < 24 AWG shall not be spliced.

For additional product support, go to <http://www.bannerengineering.com>.

Supply Wiring (AWG)	Required Overcurrent Protection (Amps)
20	5.0
22	3.0
24	2.0
26	1.0
28	0.8
30	0.5

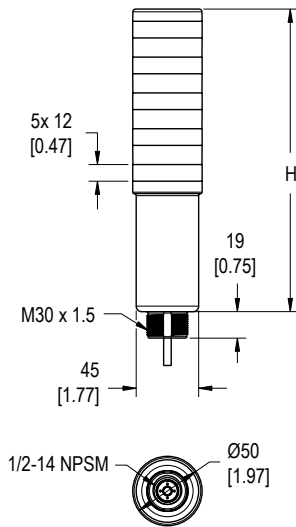
Dimensions

# of Colors	Tower Height (H)			
	Non-Audible	Standard Audible*	Sealed Audible	Omni-Directional Sealed Audible
1	115.2 mm (4.5 in)	146.1 mm (5.8 in)	169.2 mm (6.7 in)	183.2 mm (7.2 in)
2	141.0 mm (5.6 in)	171.9 mm (6.8 in)	195.0 mm (7.7 in)	209.0 mm (8.2 in)
3	166.8 mm (6.6 in)	197.7 mm (7.8 in)	220.8 mm (8.7 in)	234.8 mm (9.2 in)
4	192.6 mm (7.6 in)	223.5 mm (8.8 in)	246.6 mm (9.7 in)	260.6 mm (10.3 in)
5	218.4 mm (8.6 in)	-	-	-

* Tower height (H) with top unscrewed approximately 3.5 mm to allow sound to escape

Wiring Diagram

4-wire	5-wire	6-wire
<p>1 = Brown 2 = Blue 3 = Black 4 = White</p> <p>C1 = Color 1 C2 = Color 2 C3 = Color 3 A = Audible</p>	<p>1 = Brown 2 = Blue 3 = White 4 = Black 5 = Gray</p> <p>C1 = Color 1 C2 = Color 2 C3 = Color 3 C4 = Color 4 A = Audible</p>	<p>1 = Brown 2 = Blue 3 = White 4 = Black 5 = Gray 6 = Red</p> <p>C1 = Color 1 C2 = Color 2 C3 = Color 3 C4 = Color 4 C5 = Color 5 A = Audible</p>

Accessories

Cordsets

4-Pin Micro-Style Cordsets				
Model	Length	Style	Dimensions	Pinout (Female)
MQAC2-406	1.83 m (6 ft)	Straight		<p>1 = Brown 2 = Blue 3 = Black 4 = White</p>
MQAC2-415	4.57 m (15 ft)			
MQAC2-430	9.14 m (30 ft)			

5-Pin Micro-Style Cordsets				
Model	Length	Style	Dimensions	Pinout
MQAC2-506	1.83 m (6 ft)	Straight		<p>1 = Brown 2 = Blue 3 = White 4 = Black 5 = Gray</p>
MQAC2-515	4.57 m (15 ft)			
MQAC2-530	9.14 m (30 ft)			

Mounting Brackets

SMB30A

- Right-angle bracket with curved slot for versatile orientation
- Clearance for M6 (¼ in) hardware
- Mounting hole for 30 mm sensor
- 12-ga. stainless steel

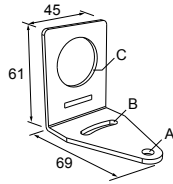

Hole center spacing: A to B=40

Hole size: A=ø 6.3, B= 27.1 x 6.3, C=ø 30.5

SMB30FA

- Swivel bracket with tilt and pan movement for precise adjustment
- Mounting hole for 30 mm sensor
- 12-ga. 304 stainless steel
- Easy sensor mounting to extrude rail T-slot
- Metric and inch size bolt available

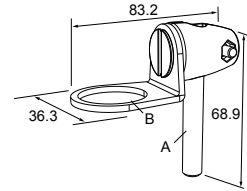

Bolt thread: SMB30FA, A= 3/8 - 16 x 2 in; SMB30FAM10, A= M10 - 1.5 x 50

Hole size: B= ø 30.1

SMB30MM

- 12-ga. stainless steel bracket with curved mounting slots for versatile orientation
- Clearance for M6 (¼ in) hardware
- Mounting hole for 30 mm sensor

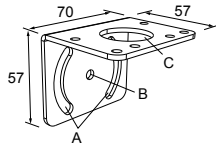

Hole center spacing: A = 51, A to B = 25.4

Hole size: A = 42.6 x 7, B = ø 6.4, C = ø 30.1

SMBAMS30P

- Flat SMBAMS series bracket
- 30 mm hole for mounting sensors
- Articulation slots for 90° + rotation
- 12-ga. 300 series stainless steel

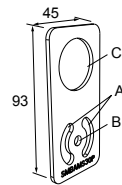

Hole center spacing: A=26.0, A to B=13.0

Hole size: A=26.8 x 7.0, B=ø 6.5, C=ø 31.0

SMBAMS30RA

- Right-angle SMBAMS series bracket
- 30 mm hole for mounting sensors
- Articulation slots for 90° + rotation
- 12-ga. (2.6 mm) cold-rolled steel

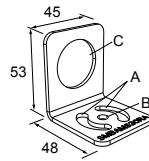

Hole center spacing: A=26.0, A to B=13.0

Hole size: A=26.8 x 7.0, B=ø 6.5, C=ø 31.0

SMB30SC

- Swivel bracket with 30 mm mounting hole for sensor
- Black reinforced thermoplastic polyester
- Stainless steel mounting and swivel locking hardware included

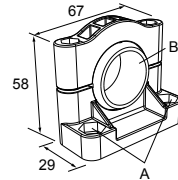

Hole center spacing: A=ø 50.8



Hole size: A=ø 7.0, B=ø 30.0

All measurements are listed in millimeters (inches), unless noted otherwise.

LMB Sealed Right-Angle Bracket

Model	Description	Construction	
LMB30RA	Direct-Mount Models: Bracket kit with base, 30 mm adapter, set screw, fasteners, o-rings, and gaskets	Black polycarbonate	
LMB30RAC		Gray polycarbonate	
LMBE12RA	Pipe-Mount Models: Bracket kit with base, ½-14 pipe adapter, set screw, fasteners, o-rings, and gaskets. For use with stand-off pipe (listed and sold separately)	Black polycarbonate	
LMBE12RAC		Gray polycarbonate	

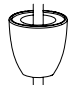
Elevated Mount System

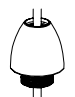
Model			Features	Components
SA-M30TE12 - Black Acetal			<ul style="list-style-type: none">Streamlined black acetal or white UHMW stand-off pipe adapter/coverConnects between 30 mm light base and ½ in. NPSM/DN15 pipeMounting hardware included	
SA-M30TE12C - White UHMW				
Polished 304 Stainless Steel	Black Anodized Aluminum	Clear Anodized Aluminum	<ul style="list-style-type: none">Elevated-use stand-off pipe (½ in. NPSM/DN15)Polished 304 stainless steel, black anodized aluminum, or clear anodized aluminum surface½ in. NPT thread at both endsCompatible with most industrial environments	
SOP-E12-150SS 150 mm (6 in) long	SOP-E12-150A 150 mm (6 in) long	SOP-E12-150AC 150 mm (6 in) long		
SOP-E12-300SS 300 mm (12 in) long	SOP-E12-300A 300 mm (12 in) long	SOP-E12-300AC 300 mm (12 in) long		
SOP-E12-900SS 900 mm (36 in) long	SOP-E12-900A 900 mm (36 in) long	SOP-E12-900AC 900 mm (36 in) long		
SA-E12M30 - Black Acetal				
SA-E12M30C - White UHMW			<ul style="list-style-type: none">Streamlined black acetal or white UHMW mounting base adapter/coverConnects between ½ in. NPSM/DN15 pipe and 30 mm (1-3/16 in) drilled holeMounting hardware included	

Pipe Mounting Flange

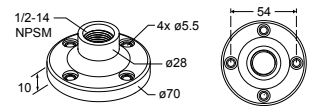
Pipe Mounting Flange			
Model	Features	Construction	
SA-F12	<ul style="list-style-type: none"> For use elevated stand-off pipes (½ in. NPSM/DN15) M5 mounting hardware and nitrile gasket included 	Die-cast zinc base with black paint	

Banner Engineering Corp. Limited Warranty

Banner Engineering Corp. warrants its products to be free from defects in material and workmanship for one year following the date of shipment. Banner Engineering Corp. will repair or replace, free of charge, any product of its manufacture which, at the time it is returned to the factory, is found to have been defective during the warranty period. This warranty does not cover damage or liability for misuse, abuse, or the improper application or installation of the Banner product.

THIS LIMITED WARRANTY IS EXCLUSIVE AND IN LIEU OF ALL OTHER WARRANTIES WHETHER EXPRESS OR IMPLIED (INCLUDING, WITHOUT LIMITATION, ANY WARRANTY OF MERCHANTABILITY OR FITNESS FOR A PARTICULAR PURPOSE), AND WHETHER ARISING UNDER COURSE OF PERFORMANCE, COURSE OF DEALING OR TRADE USAGE.

This Warranty is exclusive and limited to repair or, at the discretion of Banner Engineering Corp., replacement. IN NO EVENT SHALL BANNER ENGINEERING CORP. BE LIABLE TO BUYER OR ANY OTHER PERSON OR ENTITY FOR ANY EXTRA COSTS, EXPENSES, LOSSES, LOSS OF PROFITS, OR ANY INCIDENTAL, CONSEQUENTIAL OR SPECIAL DAMAGES RESULTING FROM ANY PRODUCT DEFECT OR FROM THE USE OR INABILITY TO USE THE PRODUCT, WHETHER ARISING IN CONTRACT OR WARRANTY, STATUTE, TORT, STRICT LIABILITY, NEGLIGENCE, OR OTHERWISE.

Banner Engineering Corp. reserves the right to change, modify or improve the design of the product without assuming any obligations or liabilities relating to any product previously manufactured by Banner Engineering Corp.