

Stepper motor EMMS-ST-87-M-SB-G2

Part number: 1370488

☆ Core product range

Without gear unit/with brake.

FESTO

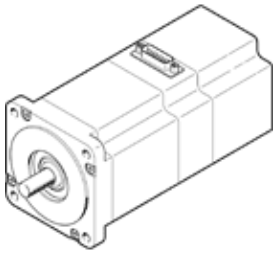

Data sheet

| Feature | values |
|--------------------------------------------------|---------------------------------------|
| Stepper angle at full step | 1.8 deg |
| Stepper angle tolerance | ±5% |
| Max. speed | 550 1/min |
| Operating voltage DC for brake | 24 V |
| Insulation protection class | B |
| Power consumption, brake | 11 W |
| Nominal operating voltage DC | 48 V |
| Nominal motor current | 9.5 A |
| Winding resistance phase | 0.23 Ohm |
| Winding inductance phase | 2.6 mH |
| Voltage constant, phase | 68.6 mVmin |
| Rating class according to EN 60034-1 | S1 |
| CE symbol (see declaration of conformity) | according to EU-EMV guideline |
| Corrosion resistance classification CRC | 1 |
| Storage temperature | -20 ... 70 °C |
| Relative air humidity | 0 - 85 % |
| Protection class | IP54 |
| Ambient temperature | -10 ... 50 °C |
| Thermal class according to EN 60034-1 | B |
| Authorization | RCM Mark c UL us - Recognized (OL) |
| Overall mass moment of inertia at power take-off | 1.97 kgcm ² |
| Brake holding torque | 2 Nm |
| Motor holding torque | 5.9 Nm |
| Mass moment of inertia of brake | 0.07 kgcm ² |
| Mass moment of inertia of rotor | 1.9 kgcm ² |
| Permissible axial shaft load | 65 N |
| Permissible radial shaft load | 200 N |
| Product weight | 3,450 g |
| Electrical connector system | Plug |
| Materials note | Conforms to RoHS |
| Conforms to standard | IEC 60034 |