



# HARRIS RIDGE

A TWO-BUILDING, CLASS-A SINGLE-STORY FLEX / OFFICE PARK



## 6125 LAKEVIEW ROAD AVAILABILITIES

### Suite 300: ±40,146 SF

- ±36,551 SF office
- Existing office can be reduced
- 18' clear height
- Divisible to ±6,464 SF

## 6135 LAKEVIEW ROAD AVAILABILITIES

### Suite 100: ±20,068 SF

- 100% office with substantial glass
- Existing office can be reduced

### Suite 150: ±7,778 SF

- ±6,095 SF existing office
- ±1,683 SF warehouse
- One (1) dock high door
- 18' clear height

### Suite 250: ±14,893 SF

- 100% office with substantial glass
- Existing office can be reduced

## CONTACT

BILL WOOD | WPW@TRINITY-PARTNERS.COM | 704.295.0445

OWNED BY



LEASED BY



# 6125 LAKEVIEW ROAD

---

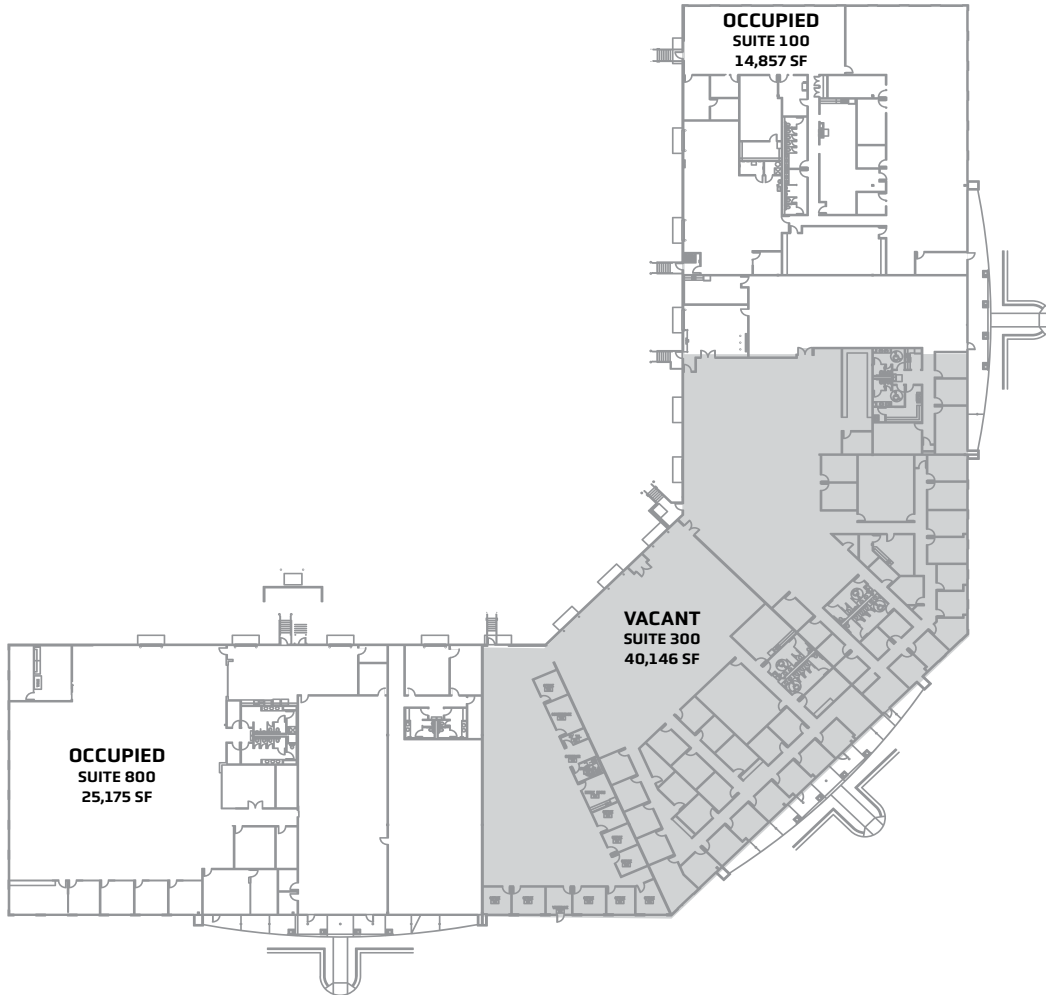

## CONTACT

BILL WOOD | [WPW@TRINITY-PARTNERS.COM](mailto:WPW@TRINITY-PARTNERS.COM) | 704.295.0445

OWNED BY



LEASED BY



# 6135 LAKEVIEW ROAD

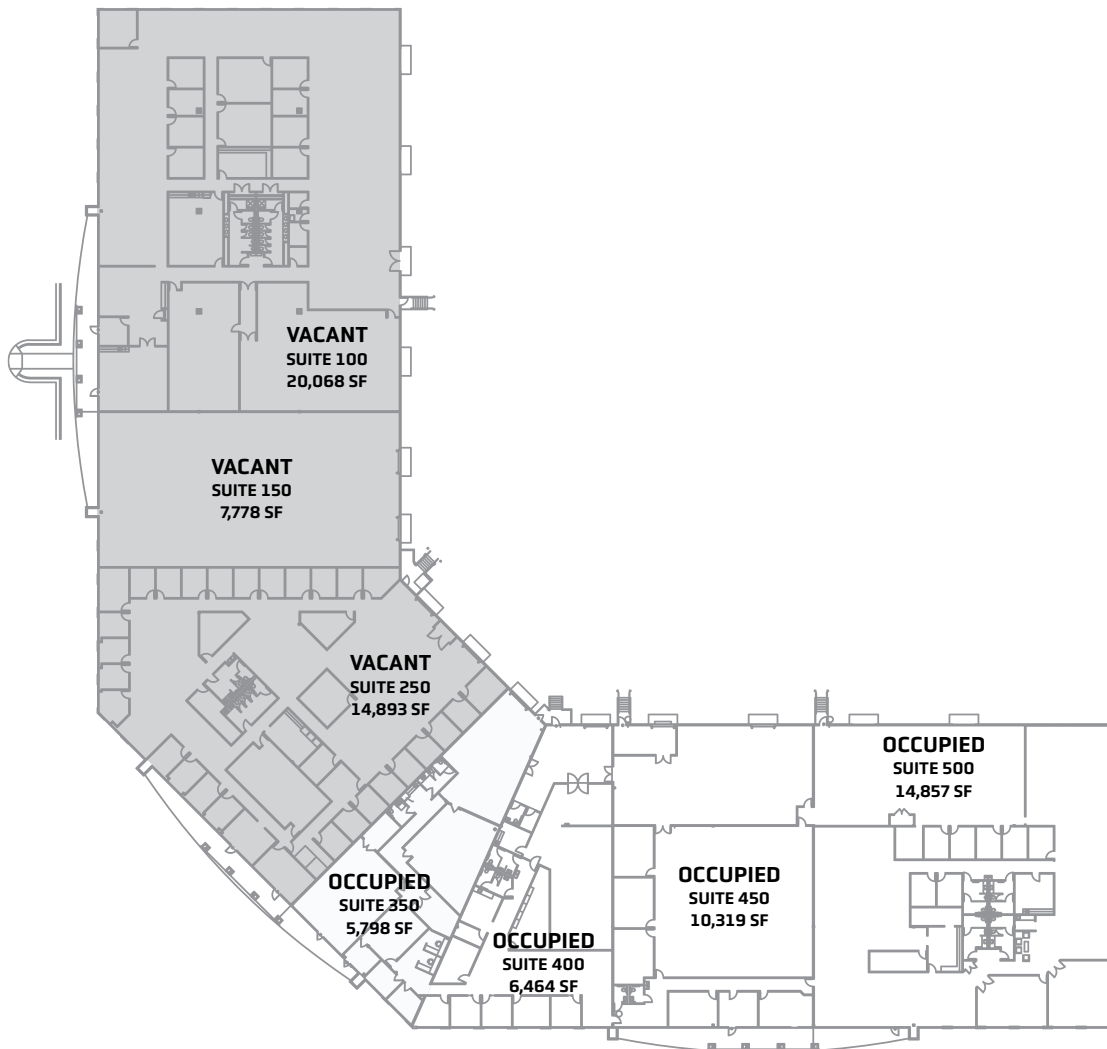

## CONTACT

BILL WOOD | [WPW@TRINITY-PARTNERS.COM](mailto:WPW@TRINITY-PARTNERS.COM) | 704.295.0445

OWNED BY



LEASED BY

