

**INDUSTRIAL  
SPACE  
FOR LEASE**

**±5,703 SF**

Immediate  
access to  
I-90 & I-290

Professionally  
owned and  
managed by:



**TRANSWESTERN**  
REAL ESTATE  
SERVICES

# 1201 REMINGTON ROAD

Unit 106, Schaumburg, IL 60173

[Property Website](#)



## Specifications:

- Building Size: ±51,681 SF
- Land Area: ±2.92 AC
- Available Size: ±5,703 SF
- Office Size: ±1,198 SF
- Ceiling Height: 16' Clear
- Loading: 1 Dock / 1 DID
- Power: 200A (to be confirmed)
- Year Built: 1980
- Construction: Masonry
- Possession: May 1, 2021
- Lease Rate: \$9.95 PSF MG

## Highlights:

- Professionally owned and managed
- Very well-maintained facility
- Excellent loading access
- Ample parking
- Close proximity to O'Hare International Airport
- Immediate access to I-90 and I-290 interchanges
- Epicenter of prestigious Schaumburg Business Park



**Ross Lehrman**  
Director  
847.588.5671  
[ross.lehrman@transwestern.com](mailto:ross.lehrman@transwestern.com)

**Justin Lerner, SIOR**  
Executive Vice President  
847.588.5665  
[justin.lerner@transwestern.com](mailto:justin.lerner@transwestern.com)

**Joe Karmin, SIOR**  
Executive Vice President  
847.588.5670  
[joe.karmin@transwestern.com](mailto:joe.karmin@transwestern.com)

The information provided herein was obtained from sources believed reliable; however, Transwestern makes no guarantees, warranties or representations as to the completeness of accuracy thereof. The presentation of this property is submitted subject to errors, omissions, change of price or conditions, prior to sale or lease, or withdrawal without notice. Copyright © 2021 Transwestern.

**INDUSTRIAL  
SPACE  
FOR LEASE**

**±5,703 SF**

Immediate  
access to  
I-90 & I-290

Professionally  
owned and  
managed by:



**TRANSWESTERN**  
REAL ESTATE  
SERVICES

# 1201 REMINGTON ROAD

Unit 106, Schaumburg, IL 60173

[Property Website](#)

**Unit Floor Plan**

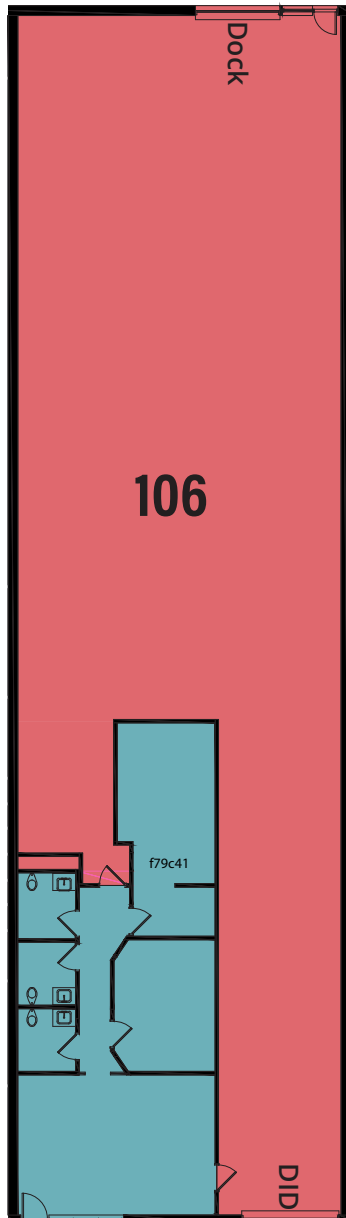

**Building Site Plan**

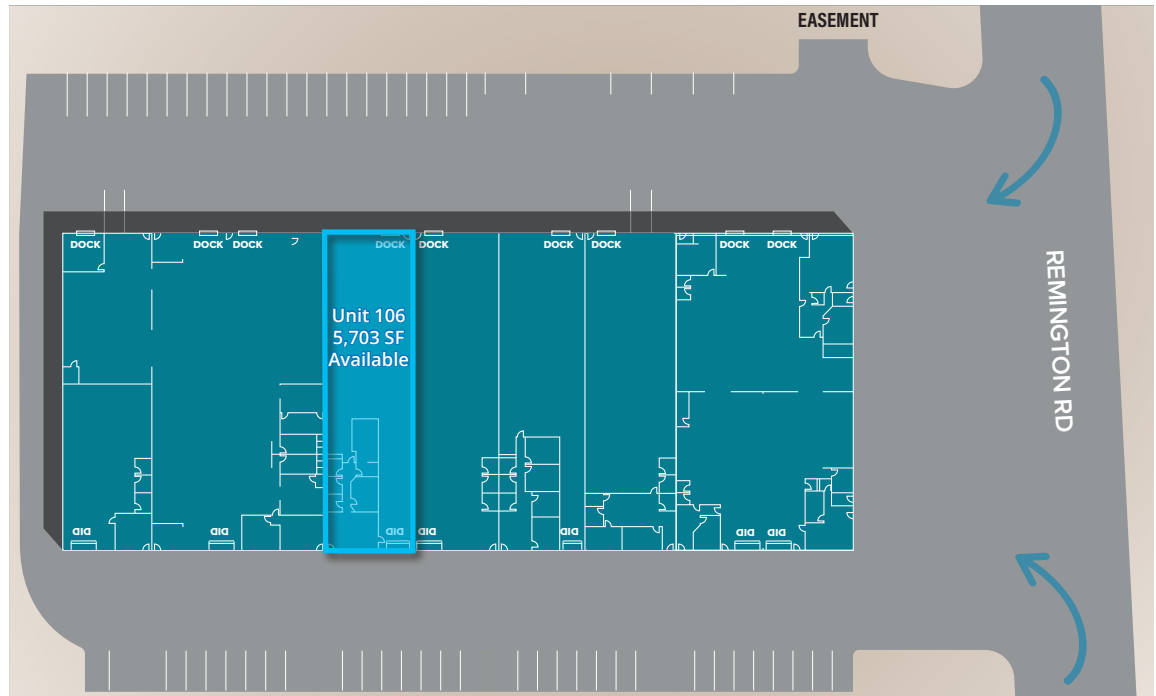

**Highway Access**

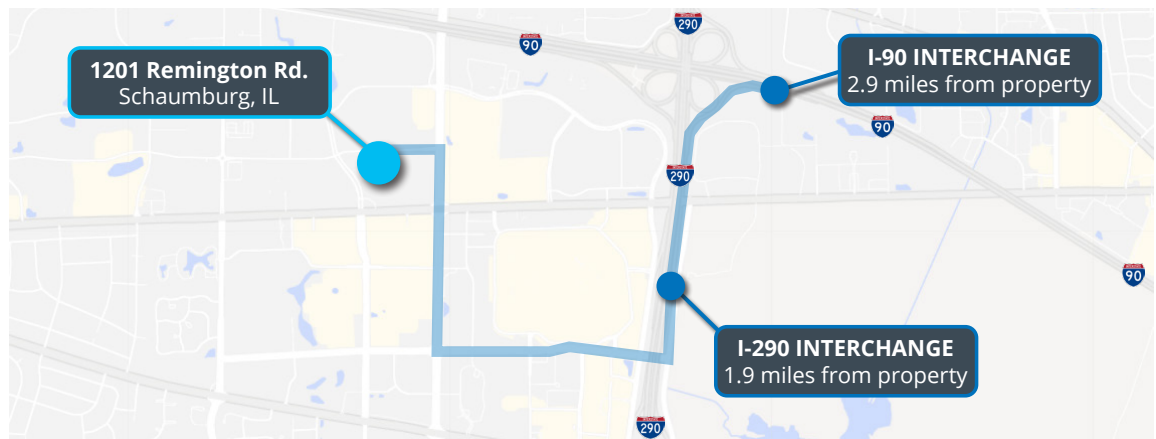

**Ross Lehrman**  
Director  
847.588.5671  
[ross.lehrman@transwestern.com](mailto:ross.lehrman@transwestern.com)

**Justin Lerner, SIOR**  
Executive Vice President  
847.588.5665  
[justin.lerner@transwestern.com](mailto:justin.lerner@transwestern.com)

**Joe Karmin, SIOR**  
Executive Vice President  
847.588.5670  
[joe.karmin@transwestern.com](mailto:joe.karmin@transwestern.com)

The information provided herein was obtained from sources believed reliable; however, Transwestern makes no guarantees, warranties or representations as to the completeness of accuracy thereof. The presentation of this property is submitted subject to errors, omissions, change of price or conditions, prior to sale or lease, or withdrawal without notice. Copyright © 2021 Transwestern.



**INDUSTRIAL  
SPACE  
FOR LEASE**

**±5,703 SF**

Immediate  
access to  
I-90 & I-290

Professionally  
owned and  
managed by:



# 1201 REMINGTON ROAD

Unit 106, Schaumburg, IL 60173

[Property Website](#)

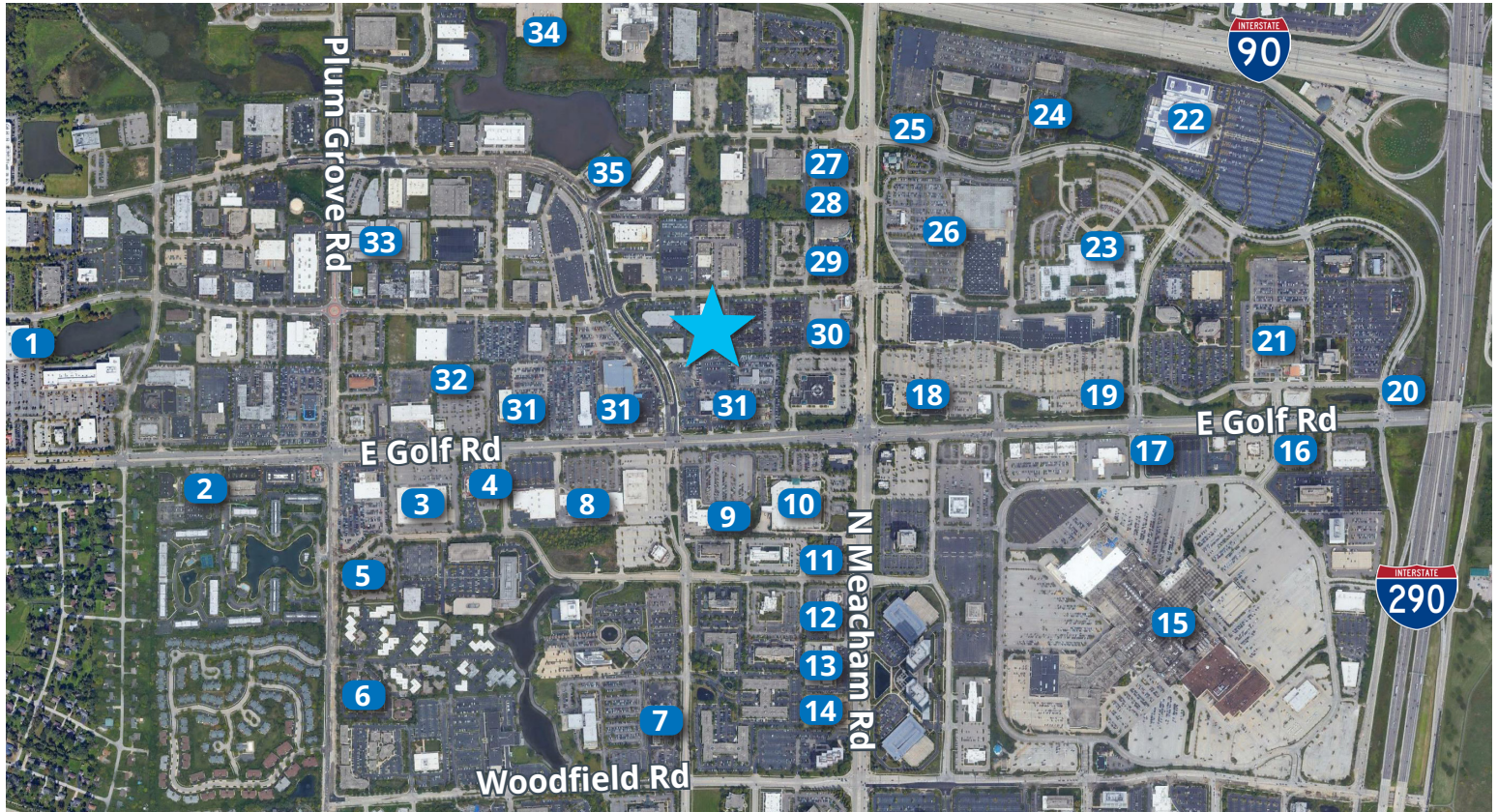

## Surrounding Amenities & Services

- |                     |                        |                        |                         |                       |
|---------------------|------------------------|------------------------|-------------------------|-----------------------|
| 1 Kohl's            | 8 Hobby Lobby          | 15 Woodfield Mall      | 22 Ikea                 | 29 Noodles & Company  |
| 2 Portillo's        | 9 Ross Dress For Less  | 16 Olive Garden        | 23 Roosevelt University | 30 Miller's Ale House |
| 3 Bed Bath & Beyond | 10 PGA Tour Superstore | 17 Shake Shack         | 24 Residence Inn        | 31 Car Dealerships    |
| 4 McDonald's        | 11 Starbucks           | 18 Michael's           | 25 Morton's Steakhouse  | 32 Best Buy           |
| 5 Homewood Suites   | 12 Giordano's          | 19 Kuma's Corner       | 26 Costco               | 33 Life Storage       |
| 6 Sonesta Suites    | 13 Potbelly's          | 20 The Capital Grille  | 27 Buffalo Wild Wings   | 34 Nicor Gas          |
| 7 DoubleTree Hotel  | 14 Panera Bread        | 21 Hyatt Regency Hotel | 28 Five Guys            | 35 Two Men & A Truck  |

**Ross Lehrman**  
Director  
847.588.5671  
[ross.lehrman@transwestern.com](mailto:ross.lehrman@transwestern.com)

**Justin Lerner, SIOR**  
Executive Vice President  
847.588.5665  
[justin.lerner@transwestern.com](mailto:justin.lerner@transwestern.com)

**Joe Karmin, SIOR**  
Executive Vice President  
847.588.5670  
[joe.karmin@transwestern.com](mailto:joe.karmin@transwestern.com)

The information provided herein was obtained from sources believed reliable; however, Transwestern makes no guarantees, warranties or representations as to the completeness of accuracy thereof. The presentation of this property is submitted subject to errors, omissions, change of price or conditions, prior to sale or lease, or withdrawal without notice. Copyright © 2021 Transwestern.