

OFFICE SPACE
FOR LEASE

300 North Martingale

Class A Office Space for Lease at
Woodfield Corporate Center
300 North Martingale Road, Schaumburg, Illinois



OFFICE SPACE FOR LEASE

300 North Martingale

SIZE

8,735 RSF (Divisible to 2,000 SF)

RENT

Negotiable

TERM

Lease expiration February 28, 2017

SPACE FEATURES

- Class A sublease
- Furniture available
- Space is divisible
- Extended term with Landlord available

BUILDING AMENITIES

- 4-story parking deck with enclosed link to building
- Manned Security
- Deli
- Vending
- ATM
- Outdoor Seating area
- Meeting Room
- Tenant Lounge
- Marriott Hotel located within Woodfield Corporate Center Complex
- On-site Property Management

LOCATION

- Convenient access to I-90 and Rt. 53 (I-290)
- Located on Martingale Road directly off Rt. 53
- Close proximity to Woodfield Mall and numerous restaurants, hotels, and retail shops.

Class A Office Space for Lease at Woodfield Corporate Center 300 North Martingale Road, Schaumburg, Illinois

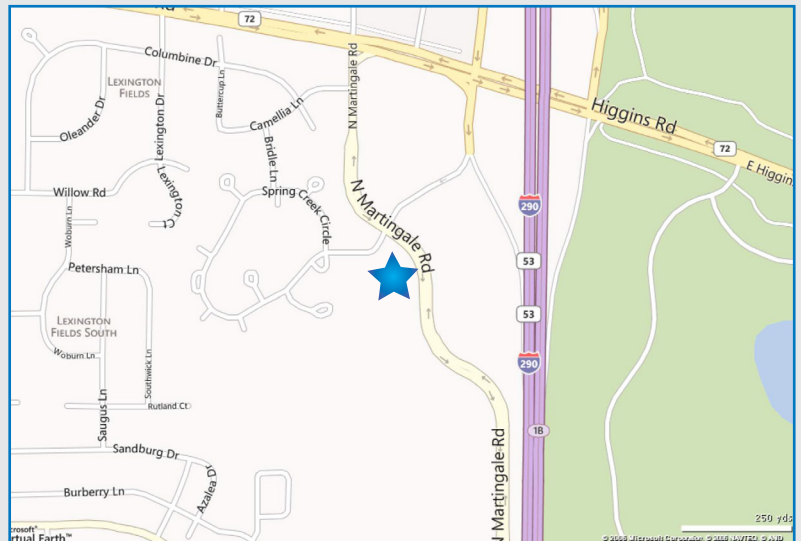

200 West Madison Street, Suite 3300
Chicago, IL 60606 ■ 312.881.7000
www.transwestern.net/chicago

LEASING INFORMATION

Joe Stevens
Fred Ishler
Zach Fox

312.881.7095
312.881.7034
312.881.7032

joseph.stevens@transwestern.net
fred.ishler@transwestern.net
zachary.fox@transwestern.net

The information provided herein was obtained from sources believed reliable; however, Transwestern makes no guarantees, warranties, or representations as to the completeness or accuracy thereof. The presentation of this property is submitted subject to errors, omissions, change of price or conditions, prior sale or lease, or withdrawal without notice. Copyright © 2013 Transwestern.