

OFFICE & WAREHOUSE FOR LEASE!

42,033 SQ FT OFFICE &
WAREHOUSE



FEATURES & AMENITIES

- 42,033 SF total | 3,003 SF office
- End-cap space
- The most preeminent business and industrial park in North Houston
- Strategically located at Beltway 8 and Interstate 45
- Master planned, deed restricted business park
- 971 total acres for future expansion or corporate campus
- Outstanding access with eleven (11) ingress/egress points
- Major tenants in the park include Amazon, Sysco, Coca Cola, BNSF Logistics, HD Supply, The Reynolds Co.
- Numerous amenities in close proximity to park

LOCATION MAP



LEASING INFORMATION

Jude Filippone
713.270.3318
Jude.Filippone@transwestern.com

Darryl Noon
713.270.3325
Darryl.Noon@transwestern.com

Brian Gammill
713.270.3321
Brian.Gammill@transwestern.com



FLOOR PLAN

42,033 SQ FT OFFICE & WAREHOUSE

OFFICE PLAN

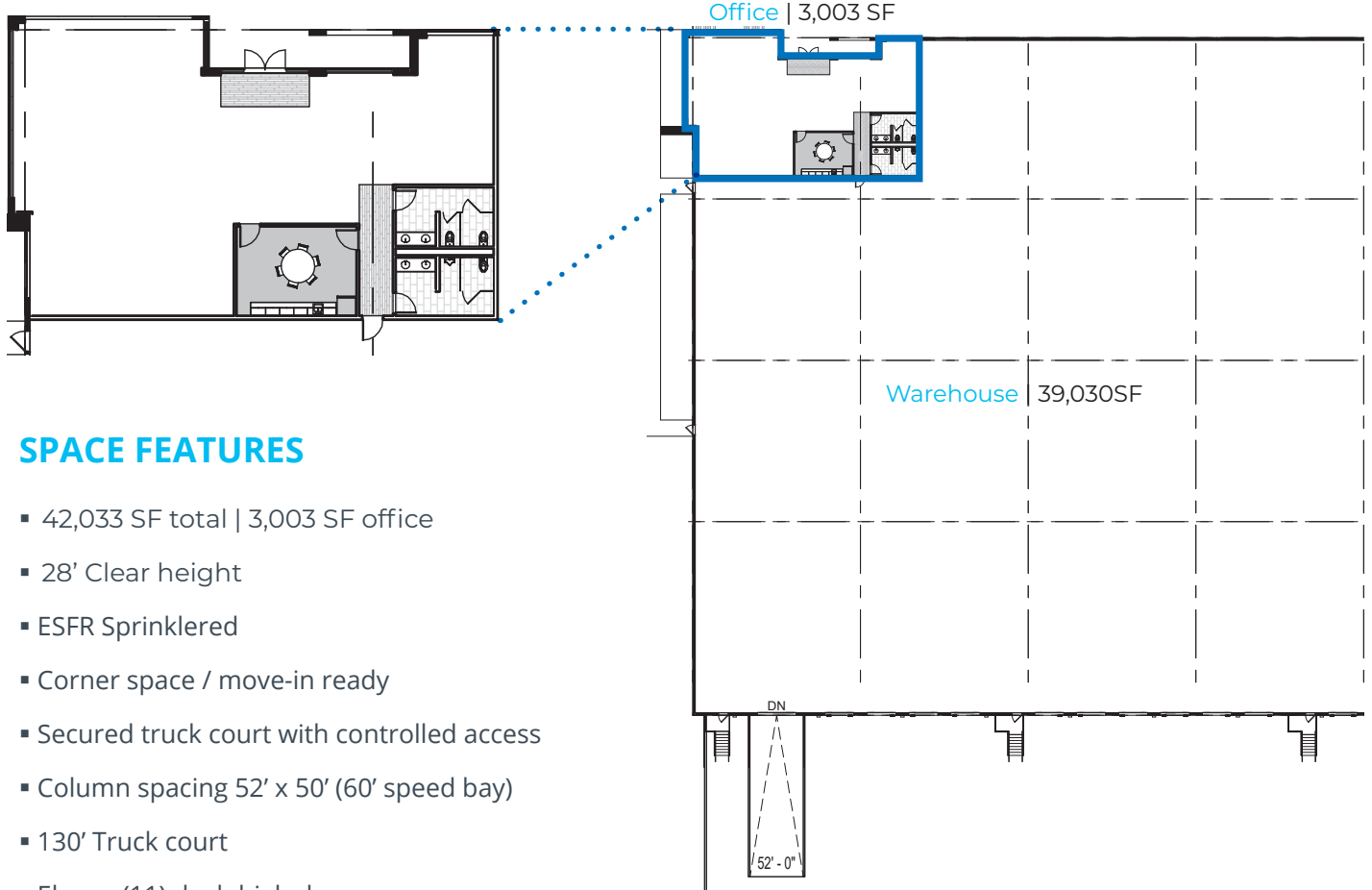

SPACE FEATURES

- 42,033 SF total | 3,003 SF office
- 28' Clear height
- ESFR Sprinklered
- Corner space / move-in ready
- Secured truck court with controlled access
- Column spacing 52' x 50' (60' speed bay)
- 130' Truck court
- Eleven (11) dock-high doors
- One (1) drive-in ramp with 12x16' overhead doors
- Two (2) LED Warehouse fixtures per bay
- Monument signage available

LEASING INFORMATION

Jude Filippone
713.270.3318
Jude.Filippone@transwestern.com

Darryl Noon
713.270.3325
Darryl.Noon@transwestern.com

Brian Gammill
713.270.3321
Brian.Gammill@transwestern.com





HOUSTON GALLERIA 20 MILES

DOWNTOWN 15 MILES

PORT OF HOUSTON 22 MILES

MEDICAL CENTER 20 MILES

HOBBY AIRPORT 25 MILES

IAH BUSH AIRPORT 10 MILES

LEASING INFORMATION

Jude Filippone
713.270.3318
Jude.Filippone@transwestern.com

Darryl Noon
713.270.3325
Darryl.Noon@transwestern.com

Brian Gammill
713.270.3321
Brian.Gammill@transwestern.com

