



TRANSWESTERN

REAL ESTATE  
SERVICES



## FOR LEASE 56,700 SF Warehouse/Distribution Space

Eastwood Industrial Park 4 | 4411-D Darien Street - Houston, TX 77028

### PROPERTY HIGHLIGHTS

- 56,700 SF Total
- Office: 2,865 SF
- Warehouse: 53,835 SF
- 24' Average clear height
- Dock high front loading docks
- 210' Maximum depth
- 8 Dock high doors
- 1 Drive in ramp
- Fully fire sprinklered
- Great access to major thoroughfares
- Easy access to 610 Loop
- All concrete paving
- Tilt-up concrete construction

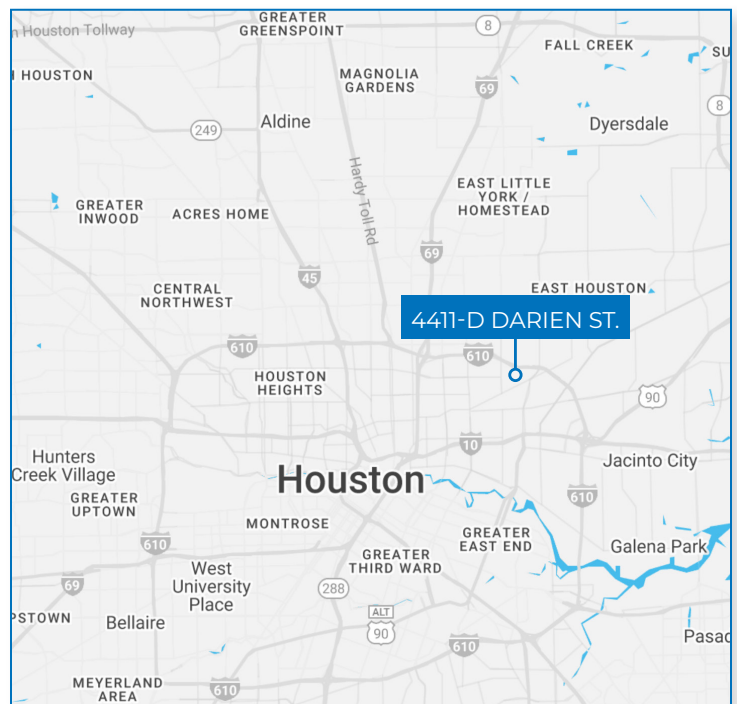

### LEASING CONTACTS



TRANSWESTERN REAL ESTATE SERVICES

Brian Gammill | 713.270.3321 | [Brian.Gammill@transwestern.com](mailto:Brian.Gammill@transwestern.com)

Darryl Noon | 713.270.3325 | [Darryl.Noon@transwestern.com](mailto:Darryl.Noon@transwestern.com)

The information provided herein was obtained from sources believed reliable; however, Transwestern makes no guarantees, warranties or representations as to the completeness or accuracy thereof. The presentation of this property is submitted subject to errors, omissions, change of price or conditions, prior sale or lease, or withdrawal without notice. Copyright © 2025 Transwestern.

Eastwood Industrial Park 4 | 4411-D Darien Street - Houston, TX 77028

## FLOOR PLAN

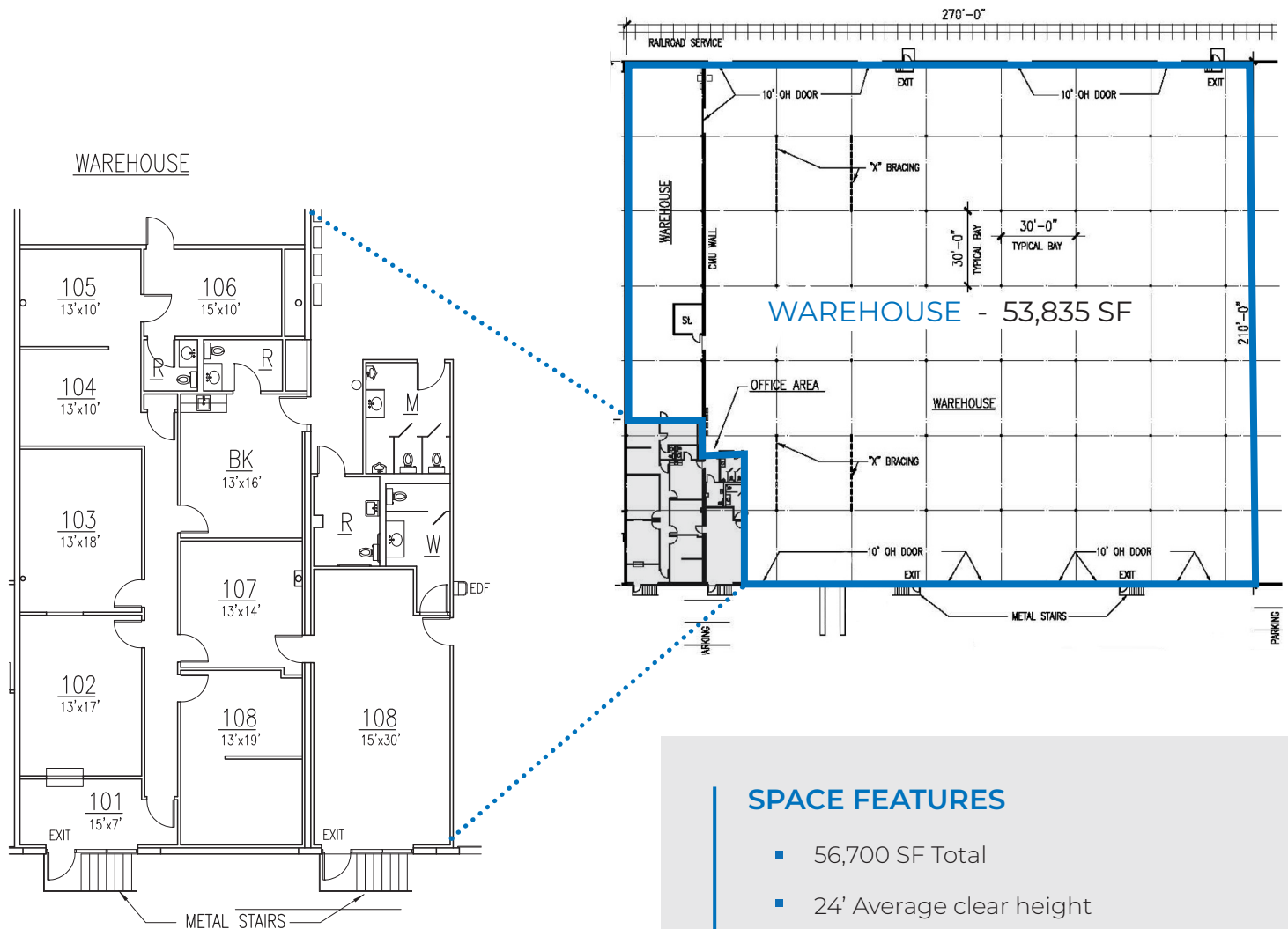

## SPACE FEATURES

- 56,700 SF Total
- 24' Average clear height
- Dock high front loading docks
- 210' Maximum depth
- 8 Dock high doors
- 1 Drive in ramp
- Fully fire sprinklered

## LEASING CONTACTS



**Brian Gammill | 713.270.3321 | [Brian.Gammill@transwestern.com](mailto:Brian.Gammill@transwestern.com)**

Darryl Noon | 713.270.3325 | Darryl.Noon@transwestern.com