

INDUSTRIAL  
FOR  
SALE & LEASE

89,625 SF  
TOTAL

2025  
CONSTRUCTION

TEN (10)  
WAREHOUSE  
BUILDINGS



TRANSWESTERN

REAL ESTATE  
SERVICES

# EDEN INDUSTRIAL PARK

Kennedale, TX 76063

**FENCED OUTSIDE STORAGE**  
**.50 - 1.25 ACRES OF FENCED YARD PER BUILDING**



The information provided herein was obtained from sources believed reliable; however, Transwestern makes no guarantees, warranties or representations as to the completeness of accuracy thereof. The presentation of this property is submitted subject to errors, omissions, change of price or conditions, prior to sale or lease, or withdrawal without notice. Copyright © 2026 Transwestern.

LYNDON TODD

817.528.6680

LYNDON.TODD@TRANSWESTERN.COM

CHARLIE MCCOLLUM

404.654.7906

CHARLIE.MCCOLLUM@TRANSWESTERN.COM

For Information:

WYTHE ROBERTS

903.315.0328

WYTHE.ROBERTS@TRANSWESTERN.COM

# EDEN INDUSTRIAL PARK

Kennedale, TX 76063



## AVAILABLE SPACES

- 3,062 SF
  - ± .25 Acre Fenced yard
  - 1 Office
  - 1 RestRoom
  - 2 - (14') Grade-Level Loading Doors
- 4,375 SF
  - ± .25 Acre Fenced yard
  - 1 Office
  - 1 RestRoom
  - 4 - (14') Grade-Level Loading Doors
- 5,000 SF
  - ± .25 Acre Fenced yard
  - 1 Office
  - 1 RestRoom
  - 4 - (14') Grade-Level Loading Doors
- 6,125 SF
  - Stand-Alone Building
  - ± .50 Acre Fenced yard
  - 2 Offices
  - 2 RestRooms
  - 4 - (14') Grade-Level Loading Doors
- 8,750 SF
  - Stand-Alone Building
  - ± .50 Acre Fenced yard
  - 2 Offices
  - 2 RestRooms
  - 8 - (14') Grade-Level Loading Doors
- 10,000 SF
  - Stand-Alone Building
  - ± .75 Acre Fenced yard
  - 2 Offices
  - 2 RestRooms
  - 8 - (14') Grade-Level Loading Doors

The information provided herein was obtained from sources believed reliable; however, Transwestern makes no guarantees, warranties or representations as to the completeness of accuracy thereof. The presentation of this property is submitted subject to errors, omissions, change of price or conditions, prior to sale or lease, or withdrawal without notice. Copyright © 2026 Transwestern.

**LYNDON TODD**

817.528.6680

LYNDON.TODD@TRANSWESTERN.COM

**CHARLIE MCCOLLUM**

404.654.7906

CHARLIE.MCCOLLUM@TRANSWESTERN.COM

**For Information:**

**WYTHE ROBERTS**

903.315.0328

WYTHE.ROBERTS@TRANSWESTERN.COM



# EDEN INDUSTRIAL PARK

Kennedale, TX 76063



TRANSWESTERN

REAL ESTATE  
SERVICES



## BUILDING 1

4,375 SF - 8,750 SF  
± .75 Acre Fenced Yard  
2 Private Offices  
2 Restrooms



## BUILDING 2

4,375 SF - 8,750 SF  
± 15 Acre Fenced Yard  
2 Private Offices  
2 Restrooms

The information provided herein was obtained from sources believed reliable; however, Transwestern makes no guarantees, warranties or representations as to the completeness of accuracy thereof. The presentation of this property is submitted subject to errors, omissions, change of price or conditions, prior to sale or lease, or withdrawal without notice. Copyright © 2026 Transwestern.

**LYNDON TODD**

817.528.6680

LYNDON.TODD@TRANSWESTERN.COM

**CHARLIE MCCOLLUM**

404.654.7906

CHARLIE.MCCOLLUM@TRANSWESTERN.COM

For Information:

**WYTHE ROBERTS**

903.315.0328

WYTHE.ROBERTS@TRANSWESTERN.COM



# EDEN INDUSTRIAL PARK

Kennedale, TX 76063



TRANSWESTERN

REAL ESTATE  
SERVICES

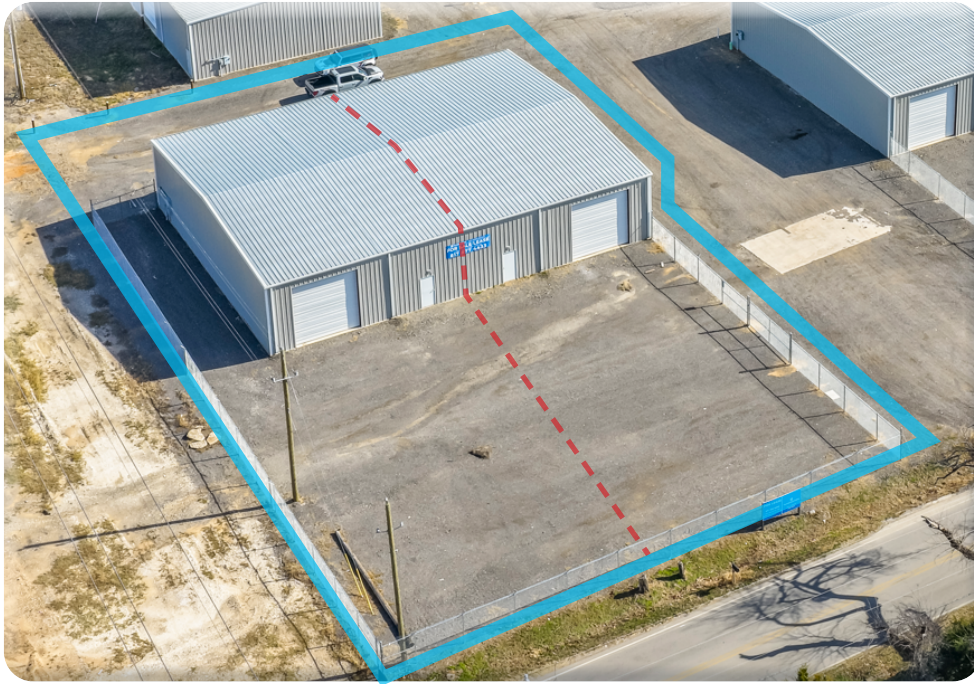

## BUILDING 3

3,062 SF - 6,125 SF  
± .50 Acre Fenced Yard  
2 Private Offices  
2 Restrooms

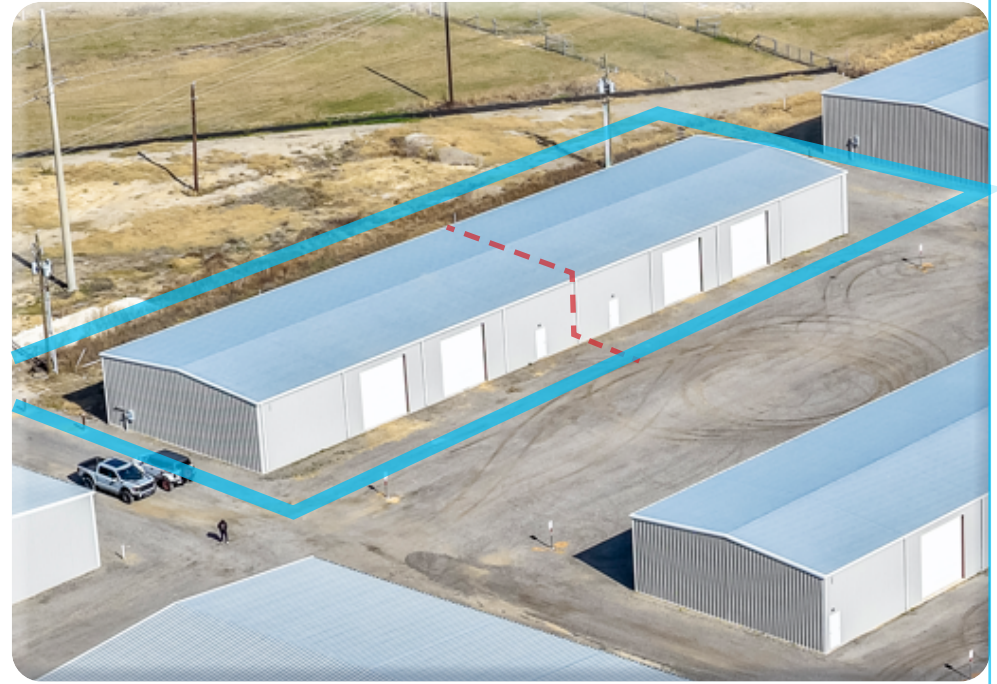

## BUILDING 4

5,000 SF - 10,000 SF  
± .05 Acre Fenced Yard  
2 Private Offices  
2 Restrooms

The information provided herein was obtained from sources believed reliable; however, Transwestern makes no guarantees, warranties or representations as to the completeness of accuracy thereof. The presentation of this property is submitted subject to errors, omissions, change of price or conditions, prior to sale or lease, or withdrawal without notice. Copyright © 2026 Transwestern.

**LYNDON TODD**

817.528.6680

LYNDON.TODD@TRANSWESTERN.COM

**CHARLIE MCCOLLUM**

404.654.7906

CHARLIE.MCCOLLUM@TRANSWESTERN.COM

**For Information:**

**WYTHE ROBERTS**

903.315.0328

WYTHE.ROBERTS@TRANSWESTERN.COM



# EDEN INDUSTRIAL PARK

Kennedale, TX 76063



TRANSWESTERN

REAL ESTATE  
SERVICES

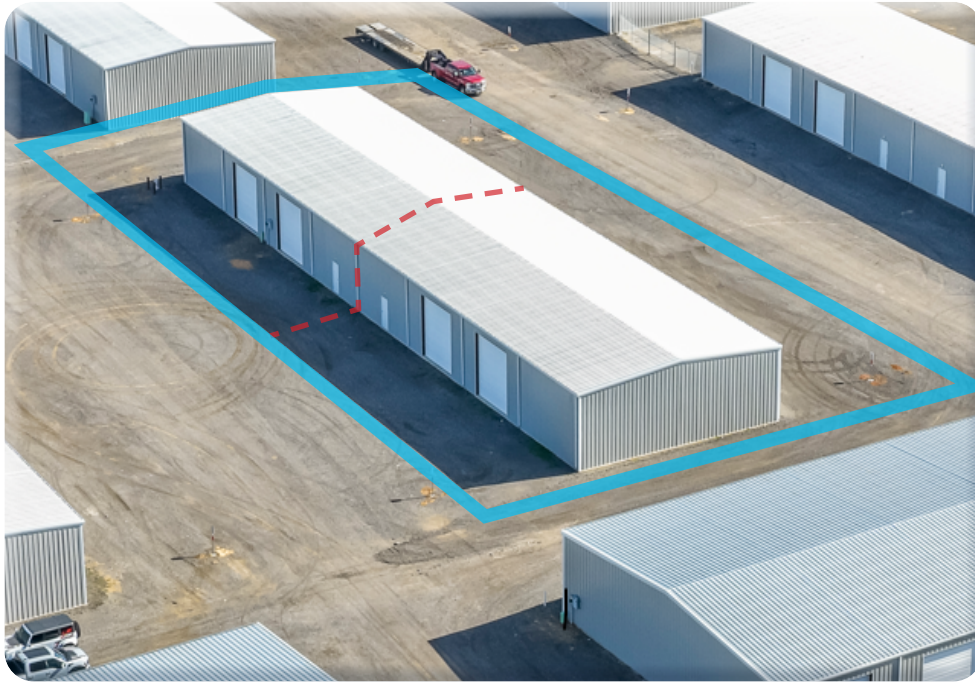

## BUILDING 5

5,000 SF - 10,000 SF  
± .05 Acre Fenced Yard  
2 Private Offices  
2 Restrooms



## BUILDING 6

5,000 SF - 10,000 SF  
± .05 Acre Fenced Yard  
2 Private Offices  
2 Restrooms

The information provided herein was obtained from sources believed reliable; however, Transwestern makes no guarantees, warranties or representations as to the completeness of accuracy thereof. The presentation of this property is submitted subject to errors, omissions, change of price or conditions, prior to sale or lease, or withdrawal without notice. Copyright © 2026 Transwestern.

**LYNDON TODD**

817.528.6680

LYNDON.TODD@TRANSWESTERN.COM

**CHARLIE MCCOLLUM**

404.654.7906

CHARLIE.MCCOLLUM@TRANSWESTERN.COM

**For Information:**

**WYTHE ROBERTS**

903.315.0328

WYTHE.ROBERTS@TRANSWESTERN.COM



# EDEN INDUSTRIAL PARK

Kennedale, TX 76063



TRANSWESTERN

REAL ESTATE  
SERVICES

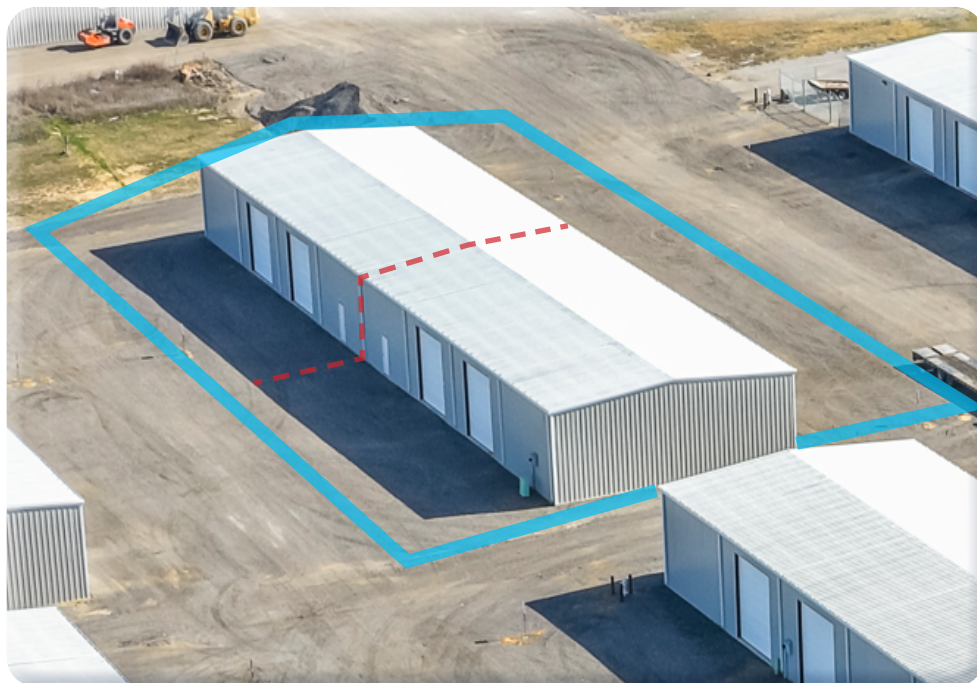

## BUILDING 8

5,000 SF - 10,000 SF  
± .05 Acre Fenced Yard  
2 Private Offices  
2 Restrooms

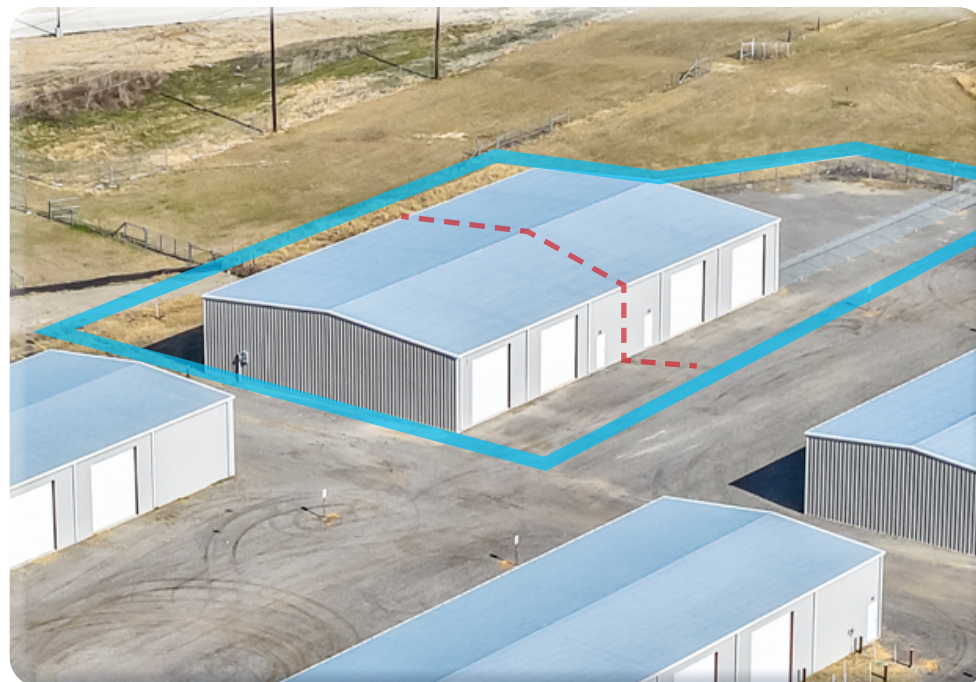

## BUILDING 9

4,375 SF - 8,750 SF  
± .05 Acre Fenced Yard  
2 Private Offices  
2 Restrooms

The information provided herein was obtained from sources believed reliable; however, Transwestern makes no guarantees, warranties or representations as to the completeness of accuracy thereof. The presentation of this property is submitted subject to errors, omissions, change of price or conditions, prior to sale or lease, or withdrawal without notice. Copyright © 2026 Transwestern.

**LYNDON TODD**

817.528.6680

LYNDON.TODD@TRANSWESTERN.COM

**CHARLIE MCCOLLUM**

404.654.7906

CHARLIE.MCCOLLUM@TRANSWESTERN.COM

**For Information:**

**WYTHE ROBERTS**

903.315.0328

WYTHE.ROBERTS@TRANSWESTERN.COM



# EDEN INDUSTRIAL PARK

Kennedale, TX 76063



TRANSWESTERN

REAL ESTATE  
SERVICES



## BUILDING 10

5,000 SF - 10,000 SF  
± .75 Acre Fenced Yard  
2 Private Offices  
2 Restrooms

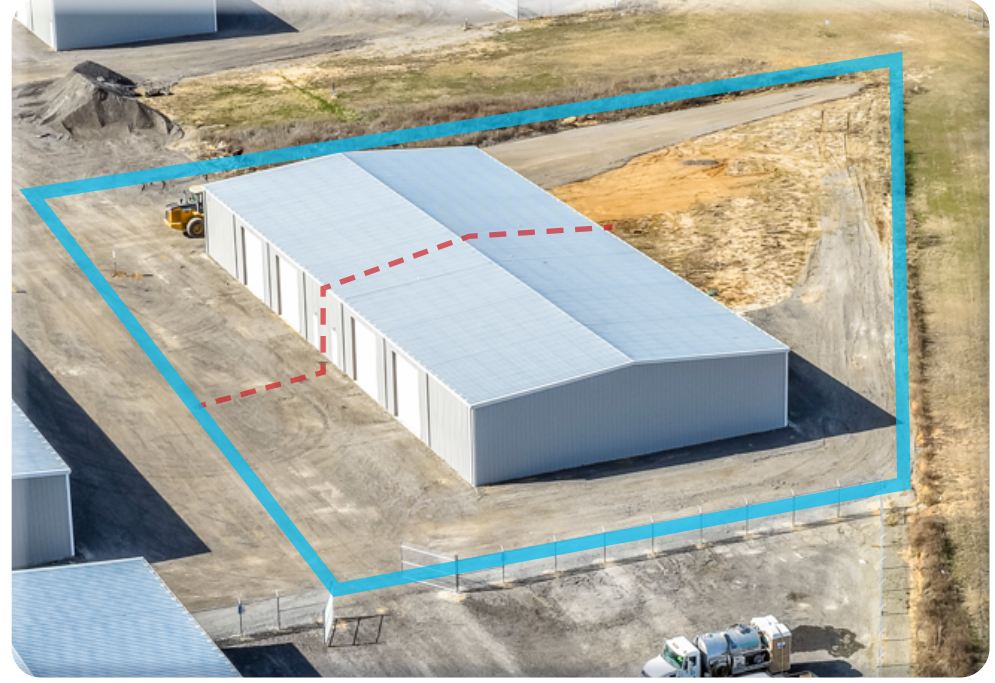

## BUILDING 11

5,000 SF - 10,000 SF  
± .75 Acre Fenced Yard  
2 Private Offices  
2 Restrooms

The information provided herein was obtained from sources believed reliable; however, Transwestern makes no guarantees, warranties or representations as to the completeness of accuracy thereof. The presentation of this property is submitted subject to errors, omissions, change of price or conditions, prior to sale or lease, or withdrawal without notice. Copyright © 2026 Transwestern.

**LYNDON TODD**

817.528.6680

LYNDON.TODD@TRANSWESTERN.COM

**CHARLIE MCCOLLUM**

404.654.7906

CHARLIE.MCCOLLUM@TRANSWESTERN.COM

**For Information:**

**WYTHE ROBERTS**

903.315.0328

WYTHE.ROBERTS@TRANSWESTERN.COM



# EDEN INDUSTRIAL PARK

Kennedale, TX 76063



TRANSWESTERN

REAL ESTATE  
SERVICES

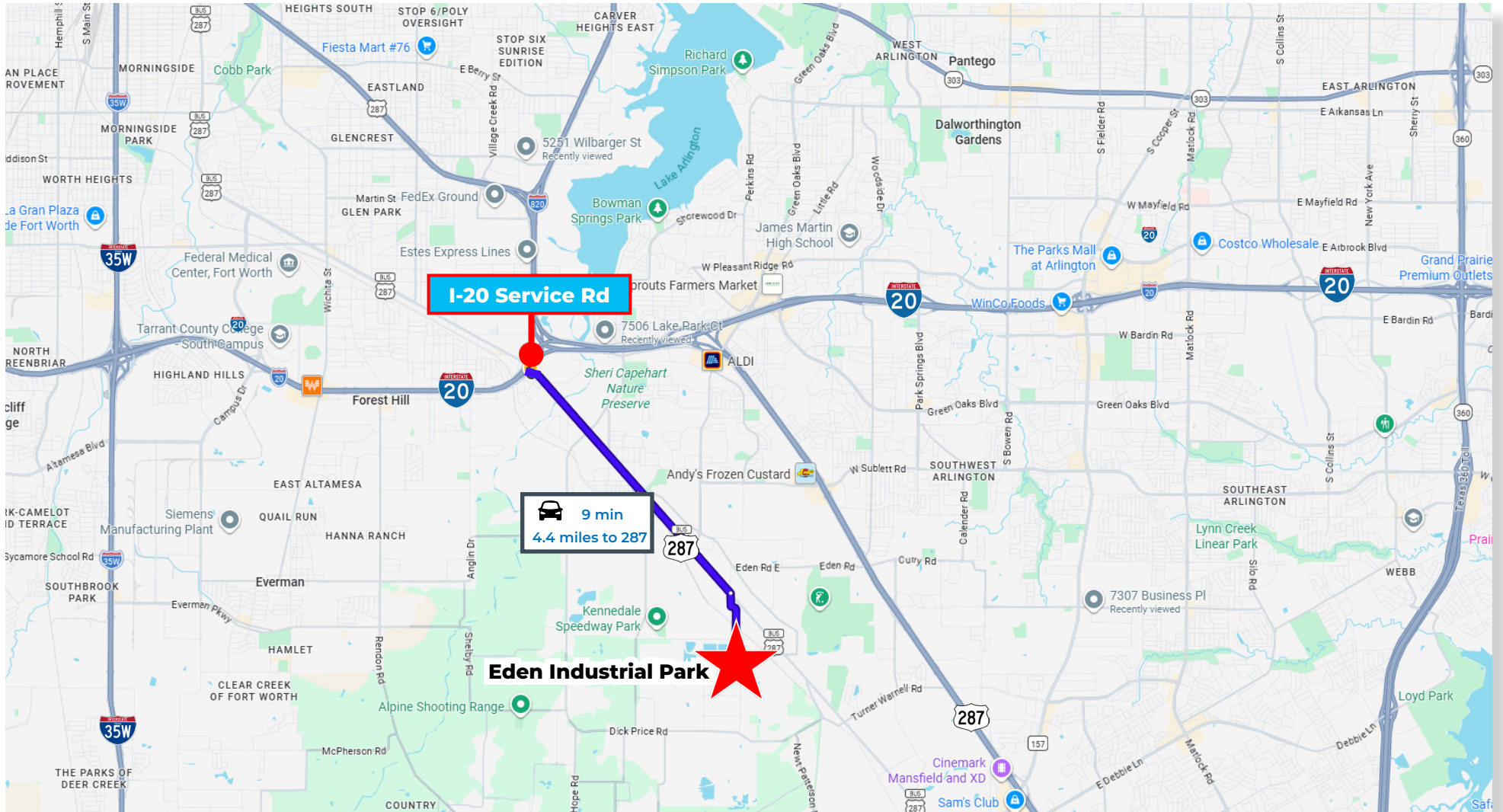

The information provided herein was obtained from sources believed reliable; however, Transwestern makes no guarantees, warranties or representations as to the completeness of accuracy thereof. The presentation of this property is submitted subject to errors, omissions, change of price or conditions, prior to sale or lease, or withdrawal without notice. Copyright © 2026 Transwestern.

LYNDON TODD

817.528.6680

LYNDON.TODD@TRANSWESTERN.COM

CHARLIE MCCOLLUM

404.654.7906

CHARLIE.MCCOLLUM@TRANSWESTERN.COM

WYTHE ROBERTS

903.315.0328

WYTHE.ROBERTS@TRANSWESTERN.COM

For Information:



# EDEN INDUSTRIAL PARK

Kennedale, TX 76063



TRANSWESTERN

REAL ESTATE  
SERVICES

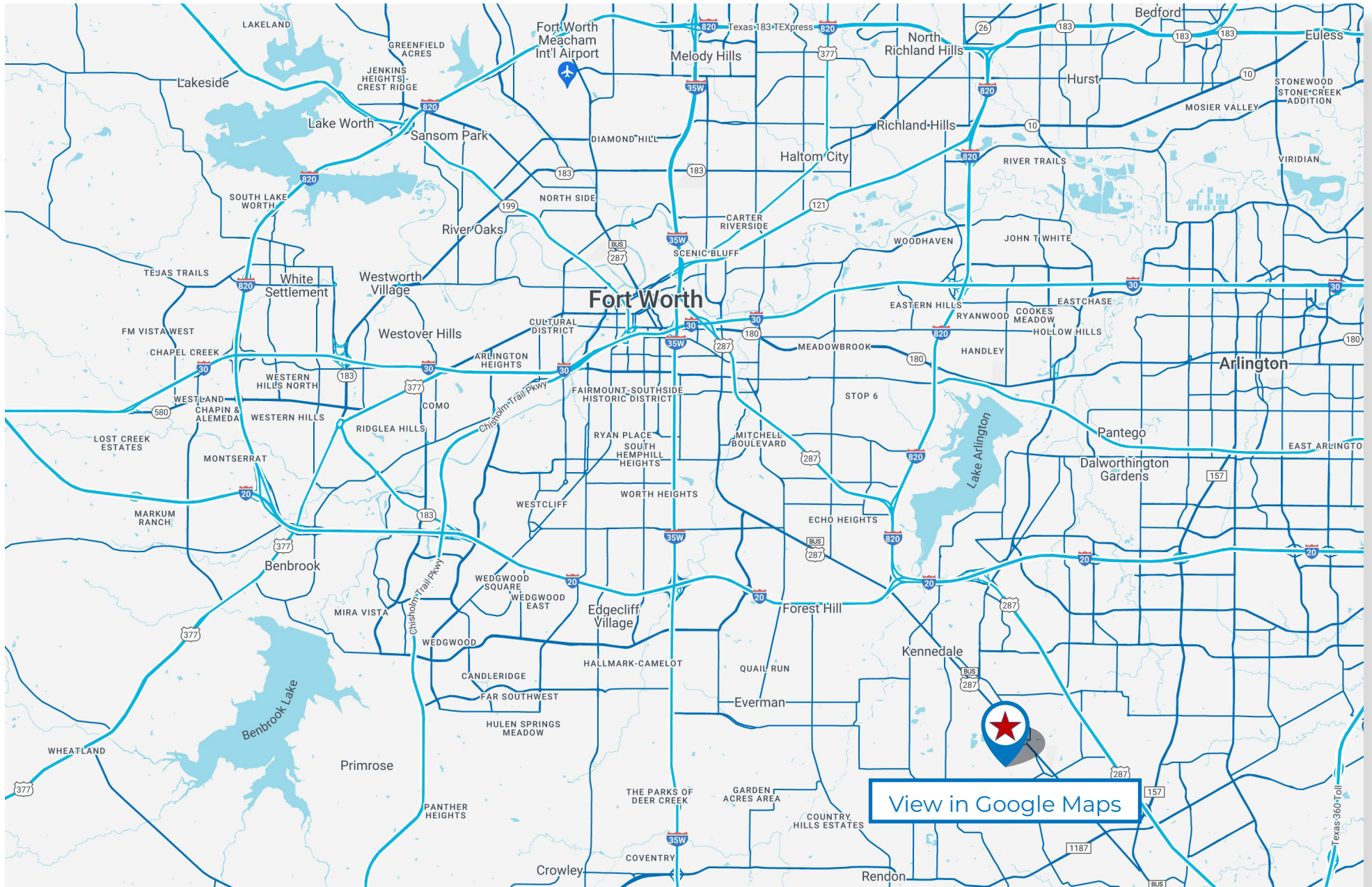



## Information About Brokerage Services

*Texas law requires all real estate license holders to give the following information about brokerage services to prospective buyers, tenants, sellers and landlords.*



### TYPES OF REAL ESTATE LICENSE HOLDERS:

- A **BROKER** is responsible for all brokerage activities, including acts performed by sales agents sponsored by the broker.
- A **SALES AGENT** must be sponsored by a broker and works with clients on behalf of the broker.

### A BROKER'S MINIMUM DUTIES REQUIRED BY LAW (A client is the person or party that the broker represents):

- Put the interests of the client above all others, including the broker's own interests;
- Inform the client of any material information about the property or transaction received by the broker;
- Answer the client's questions and present any offer to or counter-offer from the client; and
- Treat all parties to a real estate transaction honestly and fairly.

### A LICENSE HOLDER CAN REPRESENT A PARTY IN A REAL ESTATE TRANSACTION:

**AS AGENT FOR OWNER (SELLER/LANDLORD):** The broker becomes the property owner's agent through an agreement with the owner, usually in a written listing to sell or property management agreement. An owner's agent must perform the broker's minimum duties above and must inform the owner of any material information about the property or transaction known by the agent, including information disclosed to the agent or subagent by the buyer or buyer's agent. **An owner's agent fees are not set by law and are fully negotiable.**

**AS AGENT FOR BUYER/TENANT:** The broker becomes the buyer/tenant's agent by agreeing to represent the buyer, usually through a written representation agreement. A buyer's agent must perform the broker's minimum duties above and must inform the buyer of any material information about the property or transaction known by the agent, including information disclosed to the agent by the seller or seller's agent. **A buyer/tenant's agent fees are not set by law and are fully negotiable.**

**AS AGENT FOR BOTH - INTERMEDIARY:** To act as an intermediary between the parties the broker must first obtain the written agreement of *each party* to the transaction. The written agreement must state who will pay the broker and, in conspicuous bold or underlined print, set forth the broker's obligations as an intermediary. A broker who acts as an intermediary:

- Must treat all parties to the transaction impartially and fairly;
- May, with the parties' written consent, appoint a different license holder associated with the broker to each party (owner and buyer) to communicate with, provide opinions and advice to, and carry out the instructions of each party to the transaction.
- Must not, unless specifically authorized in writing to do so by the party, disclose:
  - o that the owner will accept a price less than the written asking price;
  - o that the buyer/tenant will pay a price greater than the price submitted in a written offer; and
  - o any confidential information or any other information that a party specifically instructs the broker in writing not to disclose, unless required to do so by law.

**AS SUBAGENT:** A license holder acts as a subagent when aiding a buyer in a transaction without an agreement to represent the buyer. A subagent can assist the buyer but does not represent the buyer and must place the interests of the owner first.

### TO AVOID DISPUTES, ALL AGREEMENTS BETWEEN YOU AND A BROKER SHOULD BE IN WRITING AND CLEARLY ESTABLISH:

- The broker's duties and responsibilities to you, and your obligations under the representation agreement.
- Who will pay the broker for services provided to you, when payment will be made and how the payment will be calculated.

**LICENSE HOLDER CONTACT INFORMATION:** This notice is being provided for information purposes. It does not create an obligation for you to use the broker's services. Please acknowledge receipt of this notice below and retain a copy for your records.

Transwestern Commercial Services Fort Worth LLC	9000246	(817)877-4433
Licensed Broker /Broker Firm Name or Primary Assumed Business Name	License No.	Phone
Paul Wittorf	479373	(214)446-4512
Designated Broker of Firm	License No.	Phone
Leland Alvinus Prowse IV	450719	(817)877-4433
Licensed Supervisor of Sales Agent/ Associate	License No.	Phone
Lyndon Webster Todd	740413	(817)528-6680
Sales Agent/Associate's Name	License No.	Phone

\_\_\_\_\_  
Buyer/Tenant/Seller/Landlord Initials                      Date

Regulated by the Texas Real Estate Commission

Information available at [www.trec.texas.gov](http://www.trec.texas.gov)