



TRANSWESTERN

REAL ESTATE  
SERVICES

BOLSTER

CREATIVE OFFICE SPACE FOR LEASE

**25 & 31 4TH ST NE**

MINNEAPOLIS, MN 55413

# PROPERTY SPECIFICATIONS

## Property Details

- **Available SF:** 5,000 SF
- **Net Rates:** Negotiable
- 12 - 18 month lease available
- 10 parking spaces available

## Building Features

- Conveniently located between 1st Avenue NE and Hennepin Ave E
- Cool space with concrete floors, exposed timber and skylights
- Walking distance to many restaurants and amenities



# SPACE PLAN

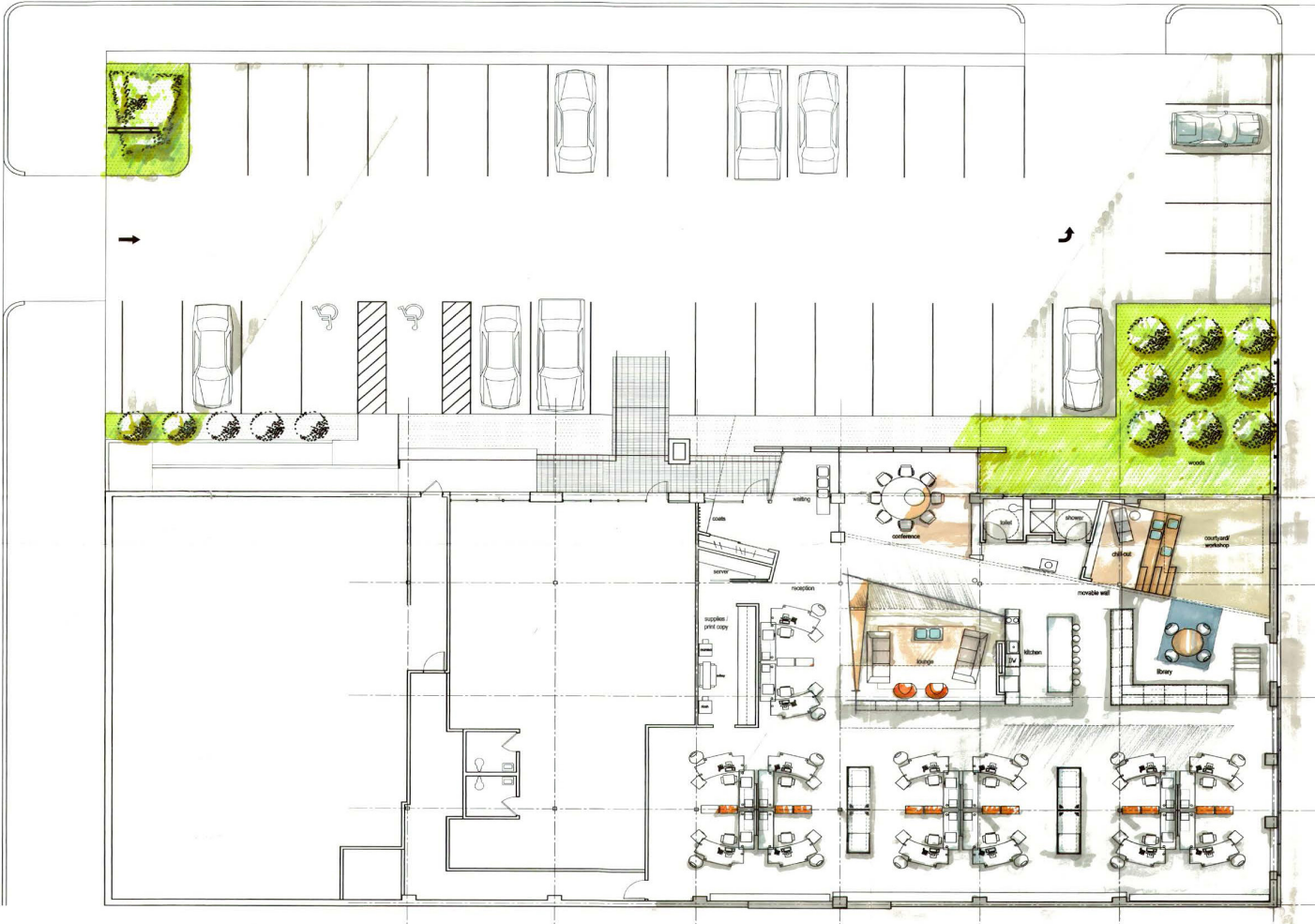





**NORMA JAEGER, CCIM**

612.359.1605

[norma.jaeger@transwestern.com](mailto:norma.jaeger@transwestern.com)