

PARK 8 | 290

FOR LEASE 6,150 SF

15110 NORTHWEST FREEWAY | SUITE 130 | HOUSTON, TX 77040

Property Features

- Ⓢ 6,150 SF total Available
- Ⓢ U.S. 290 Frontage
- Ⓢ Class A Office/Warehouse Space
- Ⓢ Strategically located at the intersection of U.S. 290 and Beltway 8 (outside city limits)
- Ⓢ Fully Sprinklered, Extensive Plumbing, Vents, and Electrical
- Ⓢ Front Park, Rear Load Configuration
- Ⓢ Immediate Access to Retail Amenities
- Ⓢ 1.3MM people within 10 Miles
- Ⓢ Strong Corporate Identity
- Ⓢ New Ownership - Relational and Proactive Landlord



Owned By



Leasing by



Jude Filippone | 713.270.3318 | jude.filippone@transwestern.com
Carter Thurmond | 713.490.3784 | carter.thurmond@transwestern.com
Brian Gammill | 713.270.3321 | brian.gammill@transwestern.com

PARK 8 | 290

FOR LEASE 6,150 SF

15110 NORTHWEST FREEWAY | SUITE 130 | HOUSTON, TX 77040

FLOOR PLAN

SPACE FEATURES

- Ⓢ 6,150 SF Class A
- Ⓢ ±18'-0" Clear Height
- Ⓢ Two (2) 12'x14' Grade-Level Doors

SUITE 130 IMPROVEMENTS IN PROCESS

- Ⓢ New LED Office & Warehouse Lighting
- Ⓢ New Paint, Carpet & LVT Flooring
- Ⓢ Renovated Breakroom & Bathrooms

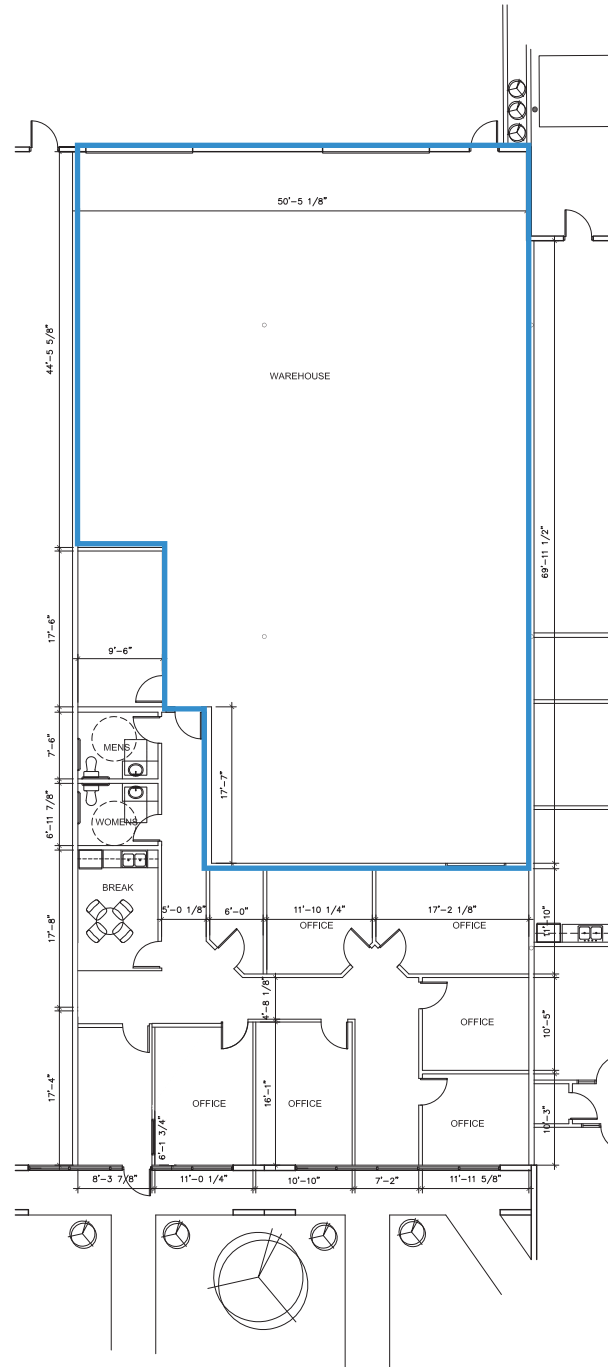

Owned By



Leasing by



Jude Filippone | 713.270.3318 | jude.filippone@transwestern.com

Carter Thurmond | 713.490.3784 | carter.thurmond@transwestern.com

Brian Gammill | 713.270.3321 | brian.gammill@transwestern.com

PARK 8 | 290

FOR LEASE 6,150 SF

15110 NORTHWEST FREEWAY | SUITE 130 | HOUSTON, TX 77040

AERIAL MAP

↔ Ingress ↔ Egress



Owned By



Leasing by



TRANSWESTERN®

Jude Filippone | 713.270.3318 | jude.filippone@transwestern.com

Carter Thurmond | 713.490.3784 | carter.thurmond@transwestern.com

Brian Gammill | 713.270.3321 | brian.gammill@transwestern.com