

MAYO
CLINIC
S Q U A R E



PROJECT OVERVIEW

LOCATION: 600 Hennepin Ave | Minneapolis, MN 55403
DESCRIPTION: Class A Mixed-use
Renovated in 2016
GLA: 222,482 sq. ft.
PARKING: 535 spaces on-site
+ 6,700 spaces nearby w/ skyway connection

AVAILABILITY

SUITE #100: 8,453 rsf [\[virtual tour\]](#)
SUITE #110: 10,337 rsf [\[virtual tour\]](#)
SUITE #180: 1,834 rsf [\[virtual tour\]](#)
SUITE #190: 1,048 rsf

CAM + TAXES: \$18.60 psf (\$11.22 psf CAM + \$7.38 psf Tax)

HIGHLIGHTS

Mayo Clinic Square is home to Jack Links Headquarters, both the MN Timberwolves and MN Lynx training center/offices, Mayo Clinic, and Loews Hotel.

The Destination for FUN, SPORTS & THEATER. Located in the heart of “sports fan central” with Target Center across the street and Target Field two blocks away. Mayo Clinic Square’s position for fresh retail has explosive potential. This complex also boasts it’s placement along Hennepin Avenue in the midst of the Hennepin Theater District, surrounded by high-end hotels and restaurants. It is further benefited by its skyway connection and direct pathways to other special events, the workday clientele, hotels, Nicollet Mall and additional parking options.

DEMOGRAPHICS

2021 ESRI est.

DISTANCE	0.5 MILE	1 MILE	2 MILE
TOTAL POPULATION	8,939	34,229	132,986
TOTAL EMPLOYEES	109,042	138,208	210,982
HOUSEHOLDS	5,071	20,387	61,766
AVERAGE HH INCOME	\$92,390	\$95,332	\$77,550



COMMUNITY



events

Target Field | **2.1M visitors**
Target Center | **1.2M visitors**
US Bank Stadium | **1.4M visitors**



guests

annual visitors | **33.9M visitors**
Employees | **218+k**
Residents | **53+k**



theaters
music

6-legendary theaters | **1+M visitors**
4-renowned music venues



hotels

Downtown Hotels | **39**
Hotel Rooms | **9,210**

6TH STREET NORTH

AVAILABILITY

SUITE #100: 8,453 rsf
SUITE #110: 10,337 rsf
SUITE #180: 1,834 rsf
SUITE #190: 1,048 rsf

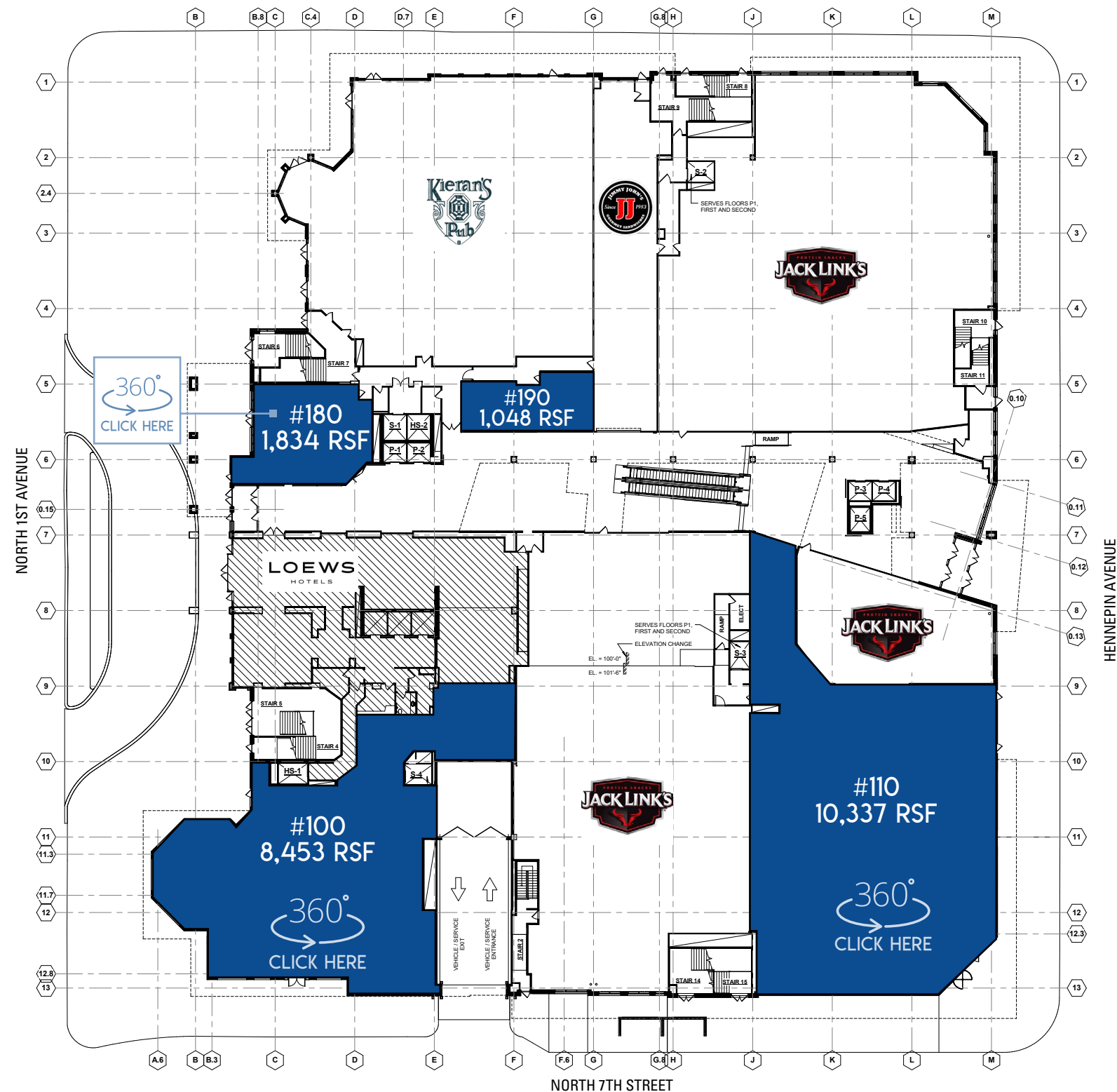

RETAIL SPACE CONTACT:

KRIS SCHISEL | 612.359.1691
kris.schisel@transwestern.com

TONY STRAUSS | 612.359.1694
tony.strauss@transwestern.com



RETAIL SPACE CONTACT:

KRIS SCHISEL | 612.359.1691
kris.schisel@transwestern.com

TONY STRAUSS | 612.359.1694
tony.strauss@transwestern.com