

**WAREHOUSE  
& OFFICE  
SPACE FOR  
LEASE**

18,450 SF  
FOR LEASE

CLASS A  
BUILDING

NORTHWEST  
SUBMARKET



**TRANSWESTERN**

REAL ESTATE  
SERVICES

# PARK PLACE EIGHT

5353 West Sam Houston Parkway North, Suite 390 - Houston, TX 77041



## Availability:

- 18,450 SF Total
- 12,082 SF Office space
- 6,368 SF Warehouse space

## Building Amenities:

- Excellent Beltway visibility and access to Hwy 290, Beltway 8 and I-10
- Strong corporate identity provides a productive working environment
- Tilt-up concrete construction
- All concrete paving

## Space Features:

- 19' Average clear height
- ADA Accessible
- Fully sprinklered
- Grade level loading / rear load
- Professional and extensive landscaping



## Leasing Information:

### Jude Filippone

Vice President  
713.270.3318  
jude.filippone@transwestern.com

### Carter Thurmond

Senior Associate  
713.490.3784  
carter.thurmond@transwestern.com

### Brian Gammill

Managing Director  
713.270.3321  
brian.gammill@transwestern.com

The information provided herein was obtained from sources believed reliable; however, Transwestern makes no guarantees, warranties or representations as to the completeness of accuracy thereof. The presentation of this property is submitted subject to errors, omissions, change of price or conditions, prior to sale or lease, or withdrawal without notice. Copyright © 2021 Transwestern.

# PARK PLACE EIGHT

5353 West Sam Houston Parkway North, Suite 390 - Houston, TX 77041



TRANSWESTERN

REAL ESTATE  
SERVICES

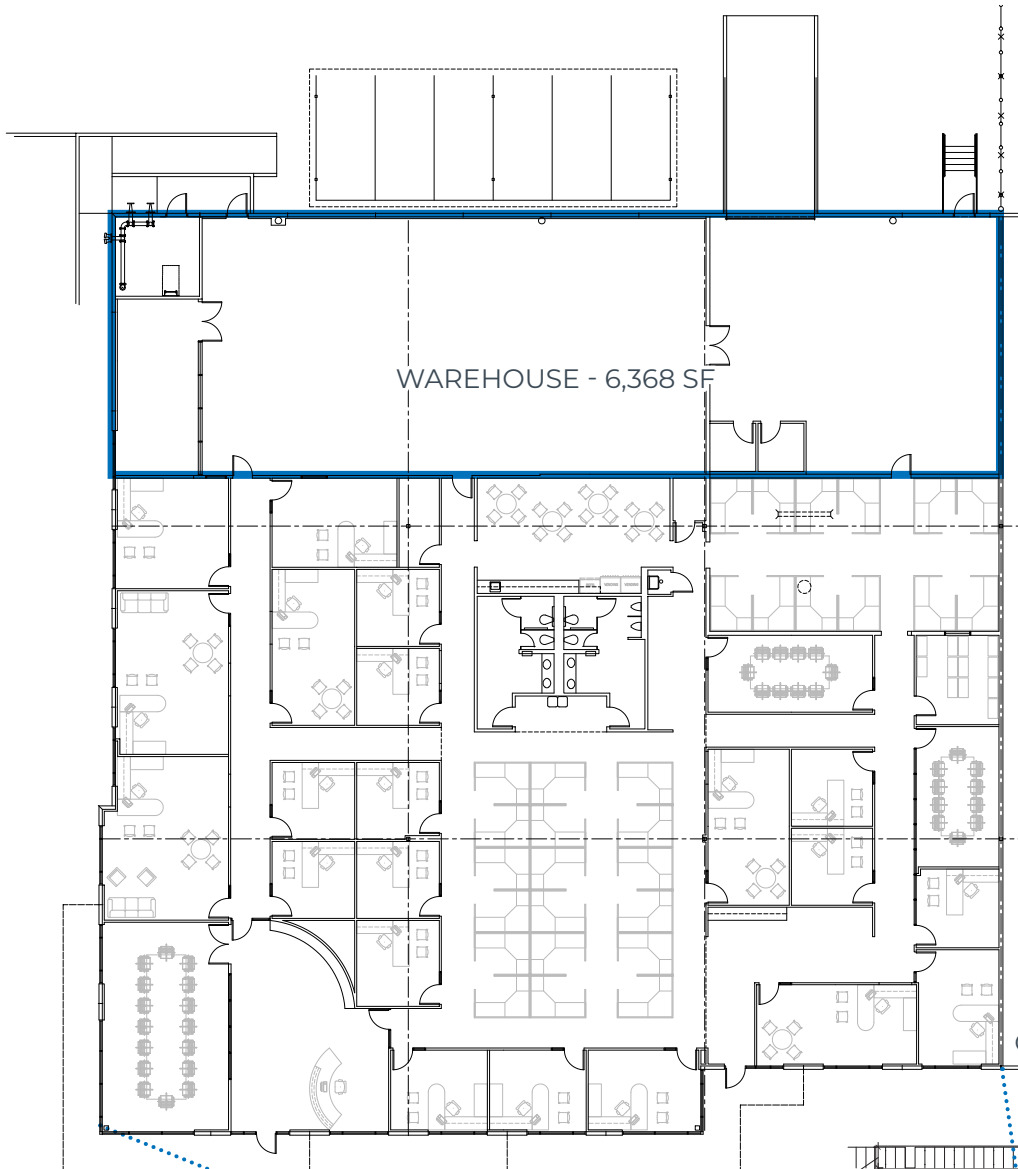

## Space Features:

- 19' Average clear height
- ADA Accessible
- Fully sprinklered
- Grade level loading / rear load
- Professional and extensive landscaping

Office - 12,082 SF

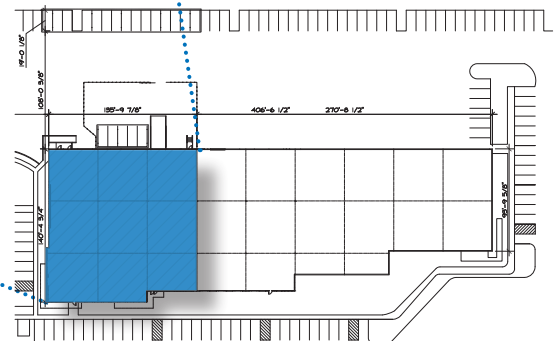

## Leasing Information:

### Jude Filippone

Vice President

713.270.3318

jude.filippone@transwestern.com

### Carter Thurmond

Senior Associate

713.490.3784

carter.thurmond@transwestern.com

### Brian Gammill

Managing Director

713.270.3321

brian.gammill@transwestern.com

The information provided herein was obtained from sources believed reliable; however, Transwestern makes no guarantees, warranties or representations as to the completeness of accuracy thereof. The presentation of this property is submitted subject to errors, omissions, change of price or conditions, prior to sale or lease, or withdrawal without notice. Copyright © 2021 Transwestern.