

North Freeway Business Center

4555 AIRLINE DR | HOUSTON, TX | 77022



16,200 SF
Available

Suite
170

Dock-High
Front-Load

22'
Clear Height

PROPERTY FEATURES

- 16,200 SF Total
- Office: 1,120 SF
- Warehouse: 15,080 SF
- Concrete Tilt Wall Construction
- 22' Clear Height
- Fully Fire Sprinklered
- Easy Access to I-45
- All Concrete Paving
- Ample Parking

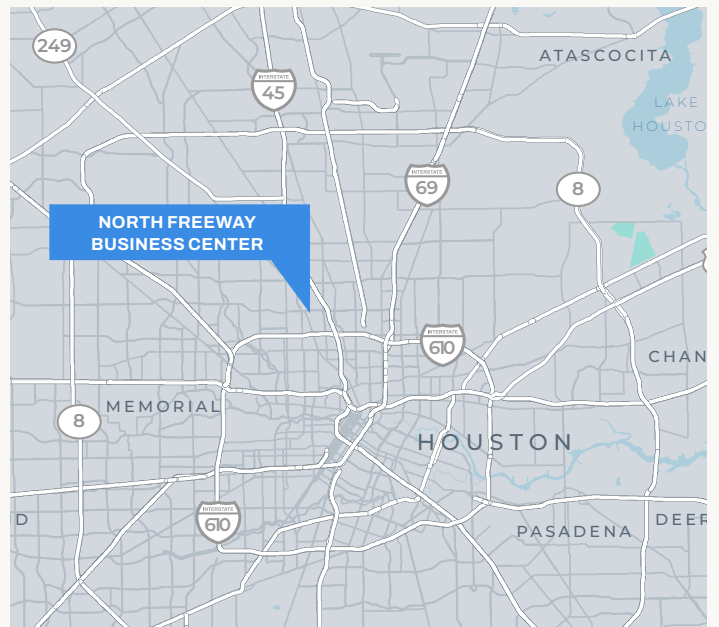

EXCELLENT NORTH HOUSTON LOCATION

Easy Access to I-45 and 610 Loop

Darryl Noon

LIC: # 367933
(713) 270-3325
darryl.noon@transwestern.com

Brian Gammill

LIC: # 393888
(713) 270-3321
brian.gammill@transwestern.com

Floor Plan 16,200 SF

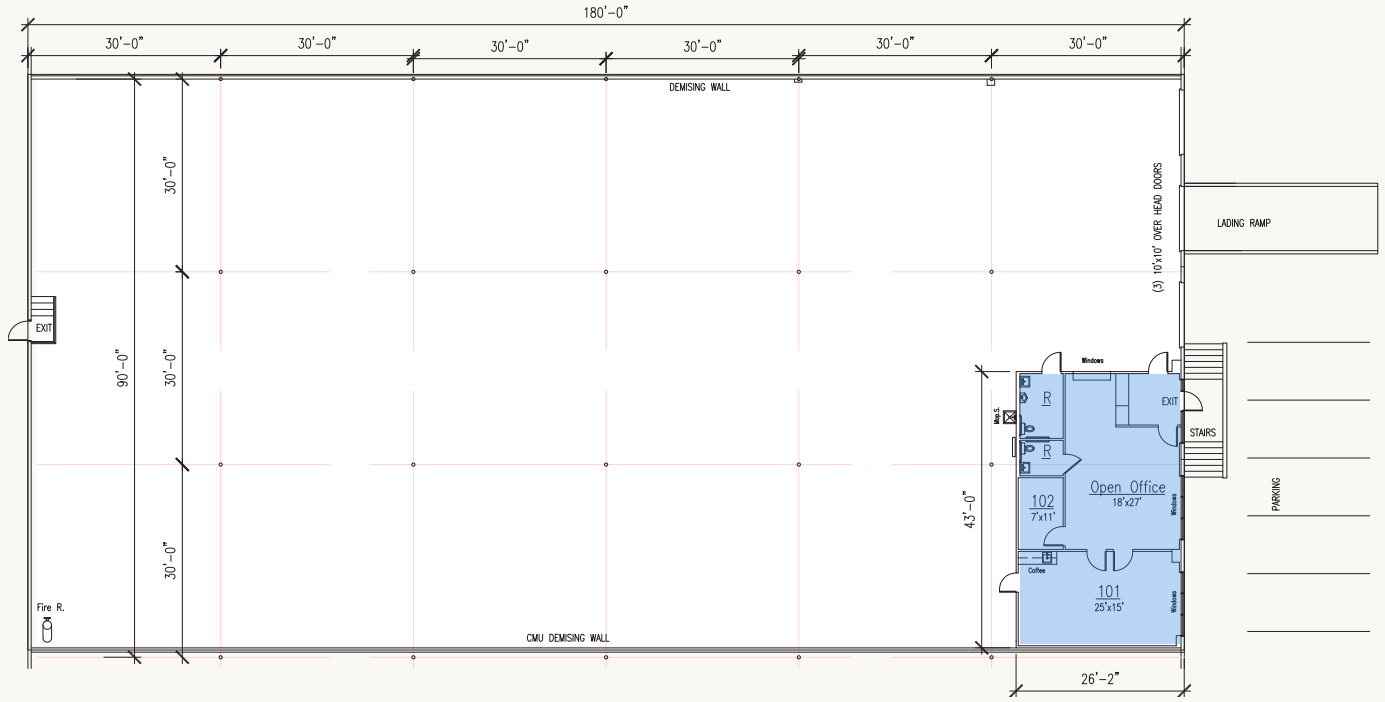

SPACE FEATURES



16,200 SF Total



1,120 SF Office
15,080 SF Warehouse



Dock-High
Front-Load



22'
Clear Height



Fully Fire
Sprinklered



Concrete
Tilt-Wall
Construction



All Concrete
Paving



Ample
Parking

Darryl Noon

LIC: # 367933
(713) 270-3325
darryl.noon@transwestern.com

Brian Gammill

LIC: # 393888
(713) 270-3321
brian.gammill@transwestern.com