

OFFICE & WAREHOUSE FOR LEASE!

62,448 SQ FT OFFICE &
WAREHOUSE



FEATURES & AMENITIES

- 62,448 SF total | 4,622 SF office
- The most preeminent business and industrial park in North Houston
- Strategically located at Beltway 8 and Interstate 45
- Master planned, deed restricted business park
- Outstanding access with eleven (11) ingress/egress points
- Major tenants in the park include Amazon, Sysco, Coca Cola, BNSF Logistics, HD Supply, The Reynolds Co.
- Numerous amenities in close proximity to park

LOCATION MAP

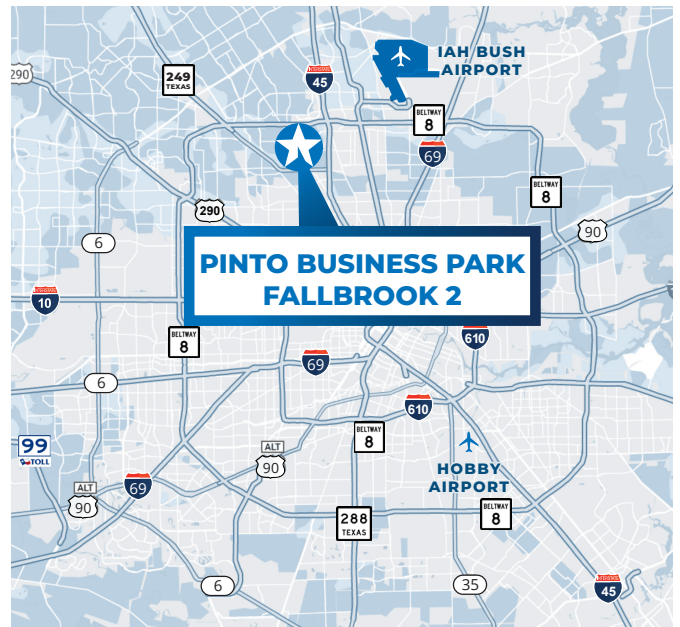

LEASING INFORMATION

Jude Filippone

713.270.3318

Jude.Filippone@transwestern.com

Darryl Noon

713.270.3325

Darryl.Noon@transwestern.com

Brian Gammill

713.270.3321

Brian.Gammill@transwestern.com

T Transwestern

FLOOR PLAN

62,448 SQ FT OFFICE & WAREHOUSE

Office Plan - 4,622 SF

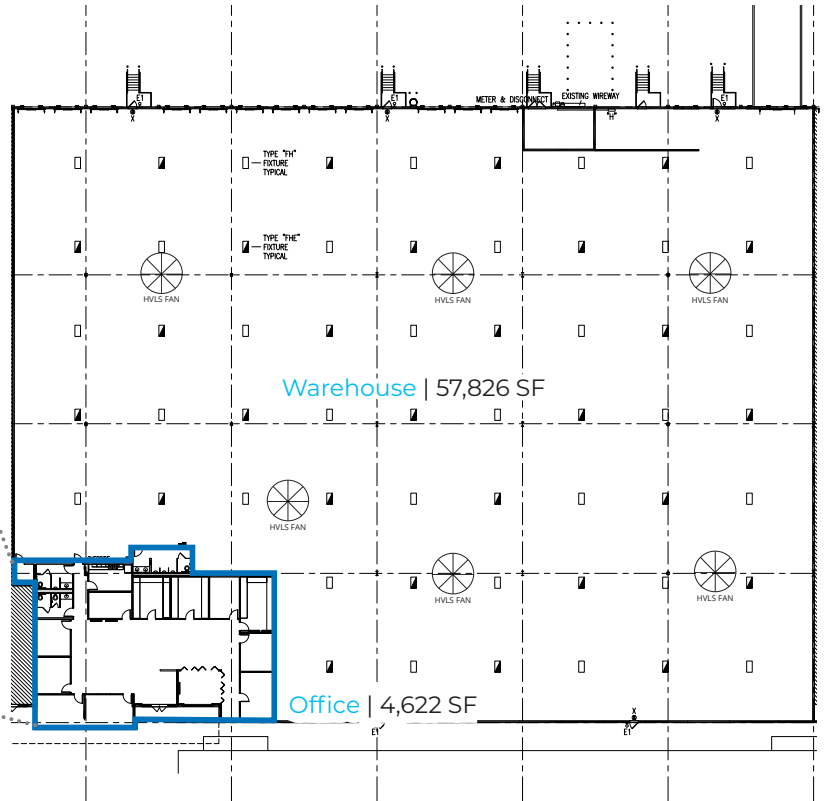
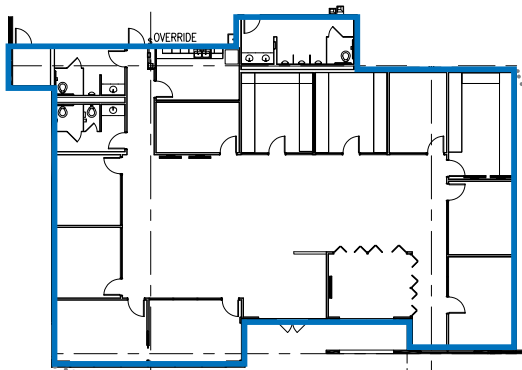

SPACE FEATURES

- 62,448 SF total | 4,622 SF office
- 28' Clear height
- ESFR Sprinklered
- Dock-high/Rear-load
- 260' Shared truck apron
- Six (6) HVLS Fans
- Thirteen (13) dock-high loading doors
- One (1) oversized door and drive-in ramp
- Fenced truck apron
- 52' x 53' Column Spacing
- 800A Electrical Service

LEASING INFORMATION

Jude Filippone
713.270.3318
Jude.Filippone@transwestern.com

Darryl Noon
713.270.3325
Darryl.Noon@transwestern.com

Brian Gammill
713.270.3321
Brian.Gammill@transwestern.com





HOUSTON GALLERIA 20 MILES

DOWNTOWN 15 MILES

PORT OF HOUSTON 22 MILES

MEDICAL CENTER 20 MILES

HOBBY AIRPORT 25 MILES

IAH BUSH AIRPORT 10 MILES

LEASING INFORMATION

Jude Filippone
713.270.3318
Jude.Filippone@transwestern.com

Darryl Noon
713.270.3325
Darryl.Noon@transwestern.com

Brian Gammill
713.270.3321
Brian.Gammill@transwestern.com

