

**MEDICAL/  
RETAIL  
LEASE**

9,000 SF

60%  
LEASED



**TRANSWESTERN**

REAL ESTATE  
SERVICES

# Long Meadow Town Center

7623 West Grand Parkway South - Richmond, TX 77407



## Building Amenities:

- 9,000 SF Medical/Retail Office Building
- Free surface parking spaces
- 4.00/1,000 SF parking ratio
- Building signage and monument signage available
- Immediate visibility from The Grand Parkway
- Located in Fort Bend County, one of the fastest-growing counties in the U.S., just south of Cinco Ranch/Katy.
- 5,400 SF already leased out

## Availability:

- 1,200 - 3,600 SF

## Rate:

- Negotiable

## TI Allowance:

- Negotiable

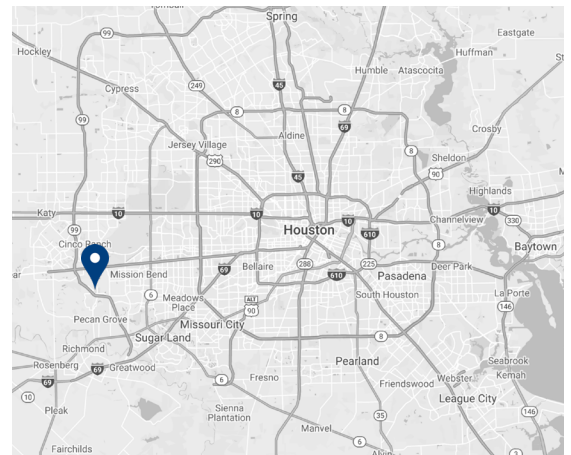

## Leasing Information:

**Christian  
Connell**

713.231.1588

christian.connell@transwestern.com

**Heinrich  
Cronje**

832.408.4067

heinrich.cronje@transwestern.com

The information provided herein was obtained from sources believed reliable; however, Transwestern makes no guarantees, warranties or representations as to the completeness or accuracy thereof. The presentation of this property is submitted subject to errors, omissions, change of price or conditions, prior sale or lease, or withdrawal without notice. Copyright © 2022 Transwestern.

# Long Meadow Town Center

7623 West Grand Parkway South - Richmond, TX 77407



## The Richmond Area

### ONE MILE

14,697

POPULATION

\$127,582

AVERAGE HH INCOME

33

AVERAGE AGE

### THREE MILES

74,074

POPULATION

\$133,345

AVERAGE HH INCOME

34

AVERAGE AGE

### FIVE MILES

195,615

POPULATION

\$134,659

AVERAGE HH INCOME

35

AVERAGE AGE

### Leasing Information:

Christian  
Connell

713.231.1588

christian.connell@transwestern.com

Heinrich  
Cronje

832.408.4067

heinrich.cronje@transwestern.com

The information provided herein was obtained from sources believed reliable; however, Transwestern makes no guarantees, warranties or representations as to the completeness or accuracy thereof. The presentation of this property is submitted subject to errors, omissions, change of price or conditions, prior sale or lease, or withdrawal without notice. Copyright © 2022 Transwestern.

# Long Meadow Town Center

7623 West Grand Parkway South - Richmond, TX 77407



TRANSWESTERN

REAL ESTATE  
SERVICES

1,200 - 3,600 SF

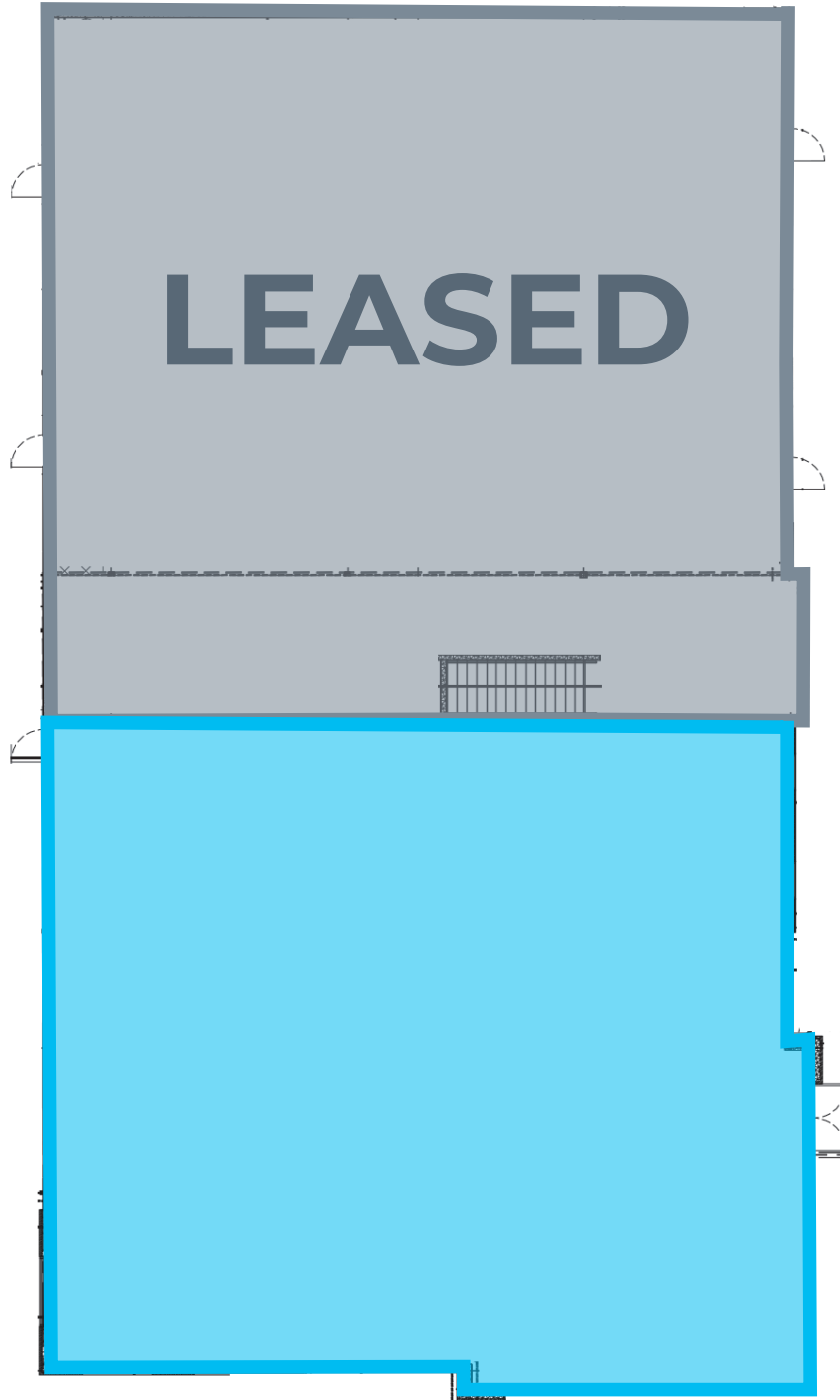

## Leasing Information:

**Christian  
Connell**

713.231.1588

[christian.connell@transwestern.com](mailto:christian.connell@transwestern.com)

**Heinrich  
Cronje**

832.408.4067

[heinrich.cronje@transwestern.com](mailto:heinrich.cronje@transwestern.com)

The information provided herein was obtained from sources believed reliable; however, Transwestern makes no guarantees, warranties or representations as to the completeness or accuracy thereof. The presentation of this property is submitted subject to errors, omissions, change of price or conditions, prior sale or lease, or withdrawal without notice. Copyright © 2022 Transwestern.